

DEAN FOREST.

Dated \_\_\_\_\_ 190 .

EDWARD STAFFORD HOWARD, Esq., C.B.  
a Commissioner of His Majesty's Woods,  
&c.

Permission determined as from 5th April 1915 see FS190 File No 4324

New Forest. F. 1706.

Office of Woods,  
4 June 1907.

Easements. Sir,

New Forest. File 4324.

Emanuel Howells.

Easements. Posts &c. at Lyndhurst.

Permission  
to erect a set  
of small posts  
with chains in  
front of his  
house at  
Lyndhurst.

The Deputy Surveyor of the New Forest has reported to this Office your application for permission to erect a set of small posts with chains in front of your house in High Street Lyndhurst. In reply I am directed by Mr. Stafford Howard to state that he is willing to give you permission to erect and during the pleasure of this Department to maintain the said posts and chains in the position shown by red colour on the enclosed tracing upon the terms and conditions following, viz:-

4 June 1907

Acknowledgment  
1/- 6/- a.

1. An acknowledgment of 1/- per annum is to be paid to the Deputy Surveyor in advance on the 5th April in each future year during the continuance of this permission the first payment in respect of the year to 5th April 1908 to be made on the acceptance of this offer.

In the event of this permission being determined the surface of the soil is to be restored to its original condition to the satisfaction of the Deputy Surveyor.

If this offer is accepted I am to request that you will remit the sum of 1/- to the Hon. G.W. Lascelles, the King's House, Lyndhurst, and return to this office the enclosed letter signed and dated.

I am, &c.

(Sd.) Chas. E. Howlett.

Mr. Howells.

High Street, Lyndhurst  
7 June 1907.

Sir.

New Forest.  
File 4324

I beg to accept the offer contained in your letter of 4th June 1907 of permission to erect and maintain during the pleasure of your Department a set of small posts with chains in front of my house here as shown on the plan that accompanied your letter and I agree to pay the acknowledgment and to observe the conditions therein specified.

E. Stafford Howard. Esq. C.B.

I am &c.

Emanuel Howells.

Easements.  
Dean Forest  
Abbotswood  
Estate.

National Sel  
Co. Ltd.

FOREST L.

Permission determined as from 5th April 1915 see F5190 File No 4324

New Forest. F. 1706.

Office of Woods,  
4 June 1907.

Easements. Sir,

New Forest. File 4324.

Emanuel Howells.

Easements. Posts &c. at Lyndhurst.

Permission  
to erect a set  
of small posts  
with chains in  
front of his  
house at  
Lyndhurst.

The Deputy Surveyor of the New Forest has reported to this Office your application for permission to erect a set of small posts with chains in front of your house in High Street Lyndhurst. In reply I am directed by Mr. Stafford Howard to state that he is willing to give you permission to erect and during the pleasure of this Department to maintain the said posts and chains in the position shown by red colour on the enclosed tracing upon the terms and conditions following, viz:-

4 June 1907

Acknowledgment  
1/- 6d.

1. An acknowledgment of 1/- per annum is to be paid to the Deputy Surveyor in advance on the 5th April in each future year during the continuance of this permission the first payment in respect of the year to 5th April 1908 to be made on the acceptance of this offer.

In the event of this permission being determined the surface of the soil is to be restored to its original condition to the satisfaction of the Deputy Surveyor.

If this offer is accepted I am to request that you will remit the sum of 1/- to the Hon. G.W. Fawcett, the King's House, Lyndhurst and return to this office the enclosed letter.

Mr. Howells.

Sir.

I beg to  
of 4<sup>th</sup> June 1907  
during the plea  
posts with chain  
the plan that ac  
acknowledgmen

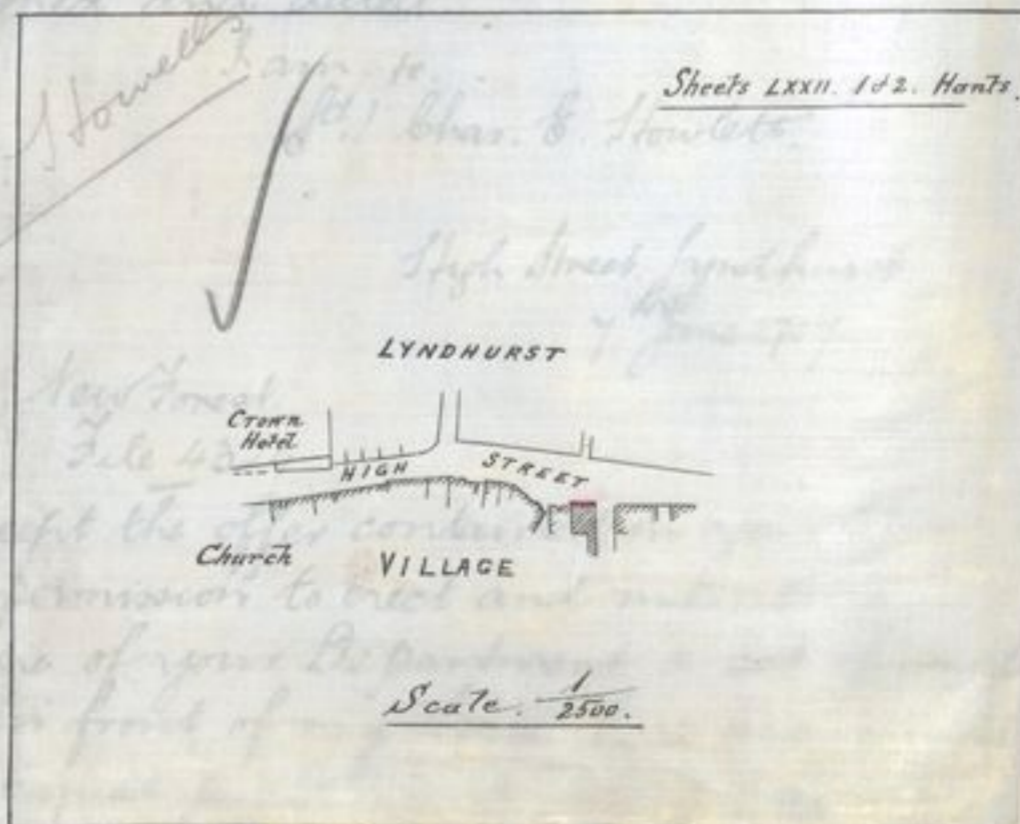

E. Stafford Howard. Esq. CB

Emanuel Howells.

Easements  
Dean Forest  
Abbotswood  
Estate.

National Se  
Co. Ltd.

FOREST L.

Scale - 25 - 0

File No 43214

Office of Woods,  
4 June 1907.

Easements.  
Dean Forest  
Abbotswood  
Estate.

F. 1875.

Sir.

Office of Woods &c.  
13<sup>th</sup> June 1907.

Dean Forest. File 1407.  
Telephones.

National Telephone  
Co. Ltd.

Permission to  
erect 3 telephone  
poles near Abbots-  
wood House.

13<sup>th</sup> June 1907.

Acknowledgment  
3/- per ann.

With reference to your application of the 6<sup>th</sup> inst for permission for the National Telephone Co. Ltd to erect three poles on Crown land near Abbotswood House, I am directed by Mr. Stafford Howard to inform you that he is willing to give the company permission to erect the poles in question in the position shown by red dots on the blue print No. 148 which accompanied your above mentioned letter upon the following terms and conditions viz:-

1. The permission is to be during the pleasure of this Department and to be subject to termination at any time by giving three months notice
2. An acknowledgment of 3/- is to be paid in advance to the Deputy Surveyor, Whitmead Park, Coleford, on the 5<sup>th</sup> April in each future year during the continuance of this permission the first acknowledgment in respect of the period to the 5<sup>th</sup> April next to be made on the acceptance of this offer

If this offer is accepted I am to request that you will remit to Mr. E. P. Popert at Whitmead Park the sum of 3/- and acknowledge the receipt of this letter.

I am etc.

District Manager.  
N. T. Co. Ltd.  
Gloucester.

(Sd.) Morton Evans.

9 Berkeley Street.  
Gloucester. 15 June 1907.

Sir.

Dean Forest Telephones.

I beg to thank you for your letter of the 13<sup>th</sup> inst granting permission to erect 3 poles on Crown land near Abbotswood House and in reply beg to say that I have today remitted cheque for 3/- to Mr. E. P. Popert at Whitmead Park.

Yours faithfully  
D. B. Fulton.

District Manager.

E. Stafford Howard. Esq.

5190 File No 43214

Office of Woods,  
4 June 1907.

Easements  
Dean Forest  
Abbotswood  
Estate.

F. 1875.

Sri.

Office of Woods &c.  
13<sup>th</sup> June 1907.

Dean Forest. File 1407.  
Telephones.

National Telephone  
Co. Ltd.

With reference to your application of the 6<sup>th</sup> inst  
for permission for the National Telephone Co. Ltd to erect  
three poles on Crown land near Abbotswood House, I

have directed by Mr Stafford Howard to inform you  
that he is willing to give the company permission  
to erect the poles in question in the position shown

The National Telephone Company, Limited No. 148 which accom-  
Plan showing Proposed Position for 3 Poles  
on Crown Property Abbots Wood, Near  
Cinderford.



pany letter upon the follow-  
The permission is to be during the pleasure of this  
Department and to be subject to termination  
at any time by giving three months notice

to be paid in advance to the  
Department on the 5<sup>th</sup> April in  
each year during the continuance of this permission  
the first acknowledgment in respect of the period to the 5<sup>th</sup> April  
next to be made on the acceptance of this offer

If the offer is accepted I am to request that you will  
remitt at Whitehead Park the sum of 3/- and  
acknowledge the receipt of this letter.

Sturton Evans.  
Berkeley Street.  
Gloucester. 15 June 1907.

I beg to thank you for your letter of the 13<sup>th</sup> inst granting  
permission to erect three poles on Crown land near Abbotswood  
I beg to say that I have today remitted  
3/- to Mr P. Robert at Whitehead Park.  
Yours faithfully  
D. B. Sturton  
District Manager.

Sheets LXXII. 1 & 2. Hants.

Howells.

New Forest.

File 4173<sup>s</sup>

Easements.

A. Lester

Permission  
to make and  
maintain a  
carruige  
approach road  
and gateway  
at Burley.

19 June 1907

Acknowledgment  
12/6 p.a.

F. 1900.

Sir

New Forest.

File 4173<sup>s</sup>

Easements. Carruige approach road  
at Burley.

The Deputy Surveyor of the New Forest has reported to this office your application for permission to resign the easement granted 30<sup>th</sup> July 1903 of a wicket gate and footpath approach on Crown property adjoining your premises at Burley and instead thereof to make a carruige approach road and gateway at the adjoining spot as shown on the enclosed tracing. In reply I am directed by Mr. Stafford Howard to state that he is willing to give you permission to make and during the pleasure of this Department to maintain the approach road and gateway <sup>above</sup> referred to in lieu of said wicket gate and footpath upon the terms and conditions following viz:-

1. An acknowledgment of 12/6 per annum is to be paid <sup>to the Deputy Surveyor</sup> in advance on the 5<sup>th</sup> July in each future year during the continuance of this permission the first payment in respect of the year to 5<sup>th</sup> July 1908 to be made on the acceptance of this offer.
2. In terms of the easement dated 30<sup>th</sup> July 1903 (now superseded by the present grant) you are to remove the existing gate and restore the fence and the surface of the ground to its original condition to the satisfaction of the Deputy Surveyor. The works of restoration should be done as soon as possible practicable.
3. The amount of this acknowledgment will be reconsidered should the house and premises be rated at more than £28 per annum.
4. This permission is personal to the Grantee and does not attach to the premises. No transfer thereof

Office of Woods &c.  
19<sup>th</sup> June 1907

thereof will be recognised unless previously sanctioned in writing by this Department.

5. In the event of this permission being determined you are to remove the gate and restore the fence and the surface of the soil to its original condition to the satisfaction of the Deputy Surveyor.

If this offer is accepted I am to request that you will remit the sum of £2/6 to the Hon. G. W. Scelles, The Kings House, Lyndhurst and return to this office the enclosed letter signed and dated.

I am &c.

Chas. E. Howlett.

Albert Lester Esq.

£. 1900.

New Forest.  
File 4173<sup>8</sup>

Burley. 1907.

Sir,

I beg to accept the offer contained in your letter of the 19<sup>th</sup> June 1907 of permission to make and during the pleasure of your Department to maintain a carriage road and gateway as shown on the plan that accompanied your letter and I agree to pay the acknowledgment and to observe the conditions therein specified, the said permission being in lieu of that of the wicket gate and footpath approach road granted to me by the easement dated 30<sup>th</sup> July 1903.

I am &c.

(Sd) Albert Lester.

E. Stafford Howard, Esq. C.B.

Office of Woods &c.  
19<sup>th</sup> June 1907

at Forest has  
for permission

1903 of a  
on shown

Burley and  
approach road

shown on  
indicated by

cutting

to be

future

the

1903

you are to

the fence

original

premises be

the Grantee and

transfer  
hereof

Office of Woods &  
19th June 1907

ad  
New Forest has  
for permission  
1903 of a  
on Crown  
Purley and  
approach road  
as shown on  
directed by  
is willing to  
during the  
tain the  
ed to in lieu  
on the terms

num is to be  
ch future year  
ssion the first  
July 1908 to be  
er.  
5th July 1903  
you are to  
the fence  
to original  
Deputy Surveyor,  
done as soon

rent will be  
premises be  
le Grantee and  
is transfer  
thereof

thereof will be recognised unless previously sanctioned in writing by this Department.

- 5. In the event of this permission being determined you are to remove the gate and restore the fence and the surface of the soil to its original condition to the satisfaction of the Deputy Surveyor.

If this offer is accepted I am to request that you will remit the sum of 15/6 to Messrs. G.S. 79-2, the Kings Home, Fyrdhurst and return the enclosed letter signed and dated.

I am  
Alfred Lester Esq.

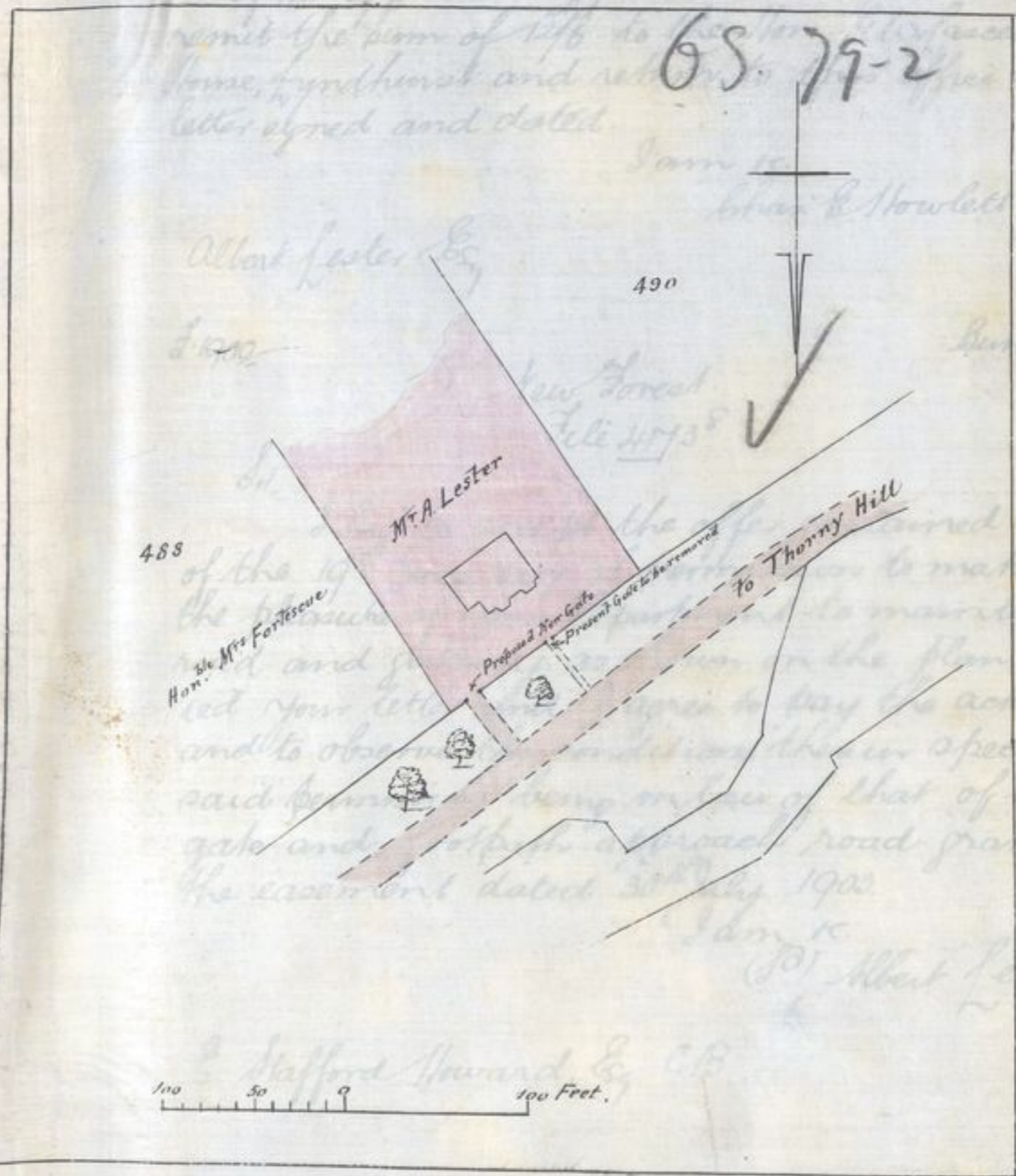

1907.

your letter  
and during  
a carriage  
that accompan  
acknowledgment  
specified, the  
wicket  
road granted to me by  
the agreement dated 30th July 1903.

Stafford Howard Esq. C.B.



New Forest. F. 2365.

Office of Woods &c.  
23 July 1907.

Easements. Gentlemen.

File 4344.

New Forest.

File 4344.

Easements. Well at Lyndhurst.

The Winchester  
Brewery Co. Ltd.  
Permission  
to take water  
from a well  
at Lyndhurst.

23 July 1907

Acknowledgment viz:-

1/- per annum.

The Deputy Surveyor of the New Forest has forwarded to this office your application for permission to take water from a well at Lyndhurst. In reply I am directed to state that he is willing to give you permission during the pleasure of this Department to maintain the line of pipes for conveying water to the Haulmans Arms Public House from the well <sup>situate under the road</sup> outside the Motor Garage at Lyndhurst and to take and use water from the same well shown by pink colour on the enclosed tracing upon the terms and conditions following

(1) An acknowledgment of 1/- per annum is to be paid to the Deputy Surveyor in advance on the 5<sup>th</sup> July in each future year during the continuance of this permission the first payment in respect of the year to 5<sup>th</sup> July 1908 to be made on the acceptance of this offer.

(2) In the event of this permission being ~~ter~~ determined the surface of the soil is to be restored to its original condition to the satisfaction of the Deputy Surveyor.

If this offer is accepted, I am to request that you will remit the sum of 1/- to the Hon. G. W. J. Scelles the King's House, Lyndhurst, and return to this office the enclosed letter signed and dated.

I am &amp;c.

Chas. E. Howlett.

The Winchester Brewery Co. Ltd.

The Brewery  
Winchester

1907.

Sir.

New Forest

I beg to accept the offer contained in your letter of the 23<sup>rd</sup> July 1907 of permission to maintain

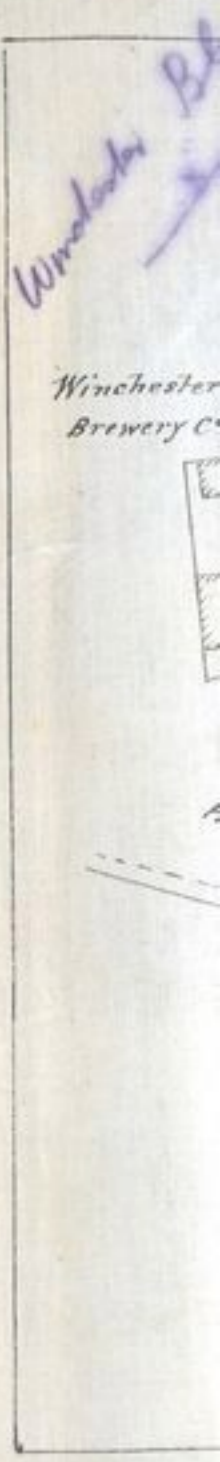

of Woods is.  
23 July 1907.

during the pleasure of your Department a line of pipes conveying water from a well under the road at Fyndhurst to the Naulmans Arms and to take water from the same well as shown on the plan that accompanied your letter and I agree to pay the acknowledgment and to observe the conditions therein specified

I am etc.

The Winchester Brewery Co. Ltd.  
A. Edmeades Jr.  
Secretary.

C. Stafford Howard. Esq. C.B.

and has proposed  
to take water  
am directed  
mission deserv



following  
to the  
of the  
of the  
of the

to the  
of the

request that you

W. J. Scannelles  
to this office

owlett.

Brewery  
Winchester  
1907.

d in your  
on to maintain

of Woods etc.  
3 July 1907.

est has forwarded  
to take water  
am directed  
mission during  
tam the line  
ans Arms  
Motor Garage  
water from  
the enclosed  
following

is to be paid  
the 5th July  
ance of this  
t of the year  
eptance of this

is determined  
to its original  
Deputy Surveyor  
uest that you  
b. W. farcelles  
to this office

owlett.

Brewery  
Winchester  
1907.

d in your  
ion to maintain

during the pleasure of your Department a line of pipes  
conveying water from a well under the road at Lyndhurst  
to the Naulman Arms and to take water from the same well  
as shown on the plans that accompanied your letter and  
I am to pay the actual  
utions therein specified

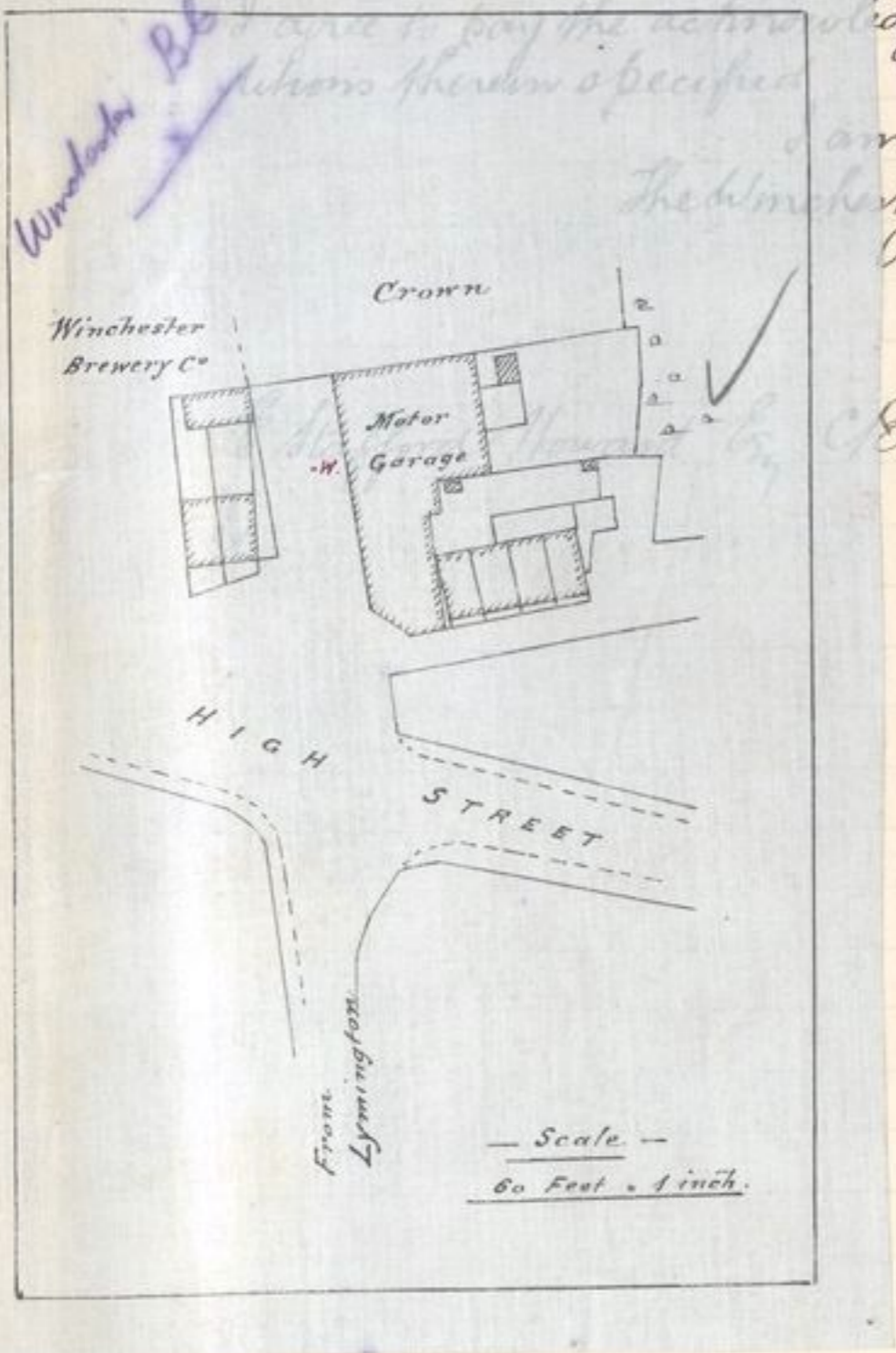

The Winchester Brewery Co. Ltd.  
A. Edmeades Jr.  
Secretary.

C.B.

Ne

Ca

Fl

The

Gre

to ka

from

at

2

Uc

Uc

Uc

Uc

Uc

Uc

Tenan

go

and k

a we

of A

tenants

tempe

such re

Witness

(sgd) John Robert  
Brown



Agreement made this 24<sup>th</sup> \_\_\_\_\_

day of *September* — One Thousand nine hundred  
and *seven* — Between EDWARD STAFFORD  
HOWARD, Esquire, C.B., a Commissioner of Woods of the one  
part, and

of \_\_\_\_\_

(hereinafter called "the Tenant") of the other part.

WHEREBY the said Edward Stafford Howard agrees to let and the  
Tenant agrees to take the Cottage \_\_\_\_\_

*garden and stable at the back* \_\_\_\_\_

and known as *Walnut Cottage* \_\_\_\_\_ on

a weekly tenancy from the date hereof at the clear weekly rent  
of *two shillings* \_\_\_\_\_

THE Tenant to pay the rent and leave the Cottage and premises in  
tenantable condition and deliver the key to the Crown Receiver or Agent.

ALL damage the premises during the tenancy (other than by fire or  
tempest) to be made good by the Tenant or in default the expenses incurred for  
such repair to be paid by the Tenant and be recoverable as liquidated damages.

Witness

(sgd) John Roberts,  
*Brown Lodge, Tintern.*

(sgd) W. G. Bennett.  
(Tenant.)

*Rent  
to £:*

*e  
ni  
M  
ST  
M  
(b*

*as  
to*

*to  
to  
to  
ca  
re*

*to  
to*

Dated 190.

E. STAFFORD HOWARD, Esq., C.B.,  
a Commissioner of Woods,

AND

---

### **Agreement**

---

FOR  
weekly tenancy of  
at Cottage

*Office of Woods.*

Rent increased  
to £20. less 3/6/22  
July 1938

copy

DEAN FOREST.

**Articles of Agreement** made the  
*eleventh* day of *November*. One Thousand  
nine hundred and *seven* ——— Between THE KING'S  
MOST EXCELLENT MAJESTY of the first part EDWARD  
STAFFORD HOWARD Esquire C.B. a Commissioner of His  
Majesty's Woods Forests and Land Revenues of the second part and  
*Edward Phillips (Caulier) of Popes  
Hill near Newnham in the County of Gloucester*  
(hereinafter called "the said Tenant") of the third part

THE said EDWARD STAFFORD HOWARD as such Commissioner  
as aforesaid on behalf of His Majesty hereby agrees to let to the said  
tenant who hereby agrees with His Majesty to take and rent as tenant  
to His Majesty ALL THAT *cottage garden and meadow  
land with the outhouses yard and outbuildings  
known as Chestnut Cottage situate at  
Greenway in the said Forest of Dean in the  
County of Gloucester containing about four  
acres one rood and three perches and coloured  
red on the plan annexed hereto*

————— lately in the  
occupation of *Charles Payne* ———  
together with the fixtures therein TO HOLD the same hereditaments  
to the said tenant from the *5th* day of *April* 190*7*

Dated

190 .

E. STAFFORD HOWARD, Esq., C.B.,  
a Commissioner of Woods,

AND

as tenant from year to year (the tenancy being however determinable  
 as after mentioned) at the yearly rent of *Seventeen pounds eight shillings*  
 to be paid to *The Deputy Surveyor of Dean Forest*—  
 free from all taxes rates and deductions whatsoever (except Landlord's  
 property tax) by equal Quarterly payments on the *5th* ———  
 day of *January* ——— the *5th* ——— day of  
*April* ——— the *5th* ——— day of *July* ———  
 and the *10th* ——— day of *October* ——— in every year  
 the first Quarterly payment to be <sup>made</sup> due on the *5th* ———  
 day of *July 1907*. ——— AND the said tenant  
 hereby agrees that he will pay to the King's Majesty the said yearly  
 rent of *Seventeen pounds eight shillings* on the days  
 and in the manner aforesaid And will also pay the land tax sewer  
 rates and all other rates taxes and assessments whatsoever  
 (except the Landlord's property tax) now or hereafter to be imposed  
 in respect of the said premises Together with a proportionate part  
 thereof for the period which shall elapse between the Quarterly day  
 of payment next preceding the expiration of the said tenancy and the  
 day on which the same shall expire AND also will not do or suffer  
 any damage to the said premises and will at all times well and  
 properly manage and cultivate the said land and keep and leave the  
 same clean and in good heart and condition and will also keep the  
 windows and doors in good repair and the ceilings and interior walls  
 properly cleaned and whitewashed and will on the determination of  
 the tenancy hereby created deliver up the said premises in such repair  
 and condition as aforesaid to the King's Majesty his heirs or  
 successors or to the said EDWARD STAFFORD HOWARD or other the  
 Commissioner or Commissioners for the time being of His Majesty's  
 Woods Forests and Land Revenues having the management of the  
 said premises (hereinafter called "the said Commissioner or Com-  
 missioners") or to whom he or they may appoint AND will permit

1161

Green

Note  
The pEdwa  
in the p  
1894



however determinable  
 been pounds eight shillings  
 Dean Forest—  
 er (except Landlord's  
 the 5th. ———  
 day of  
 July ———  
 in every year  
 the  
 AND the said tenant  
 jesty the said yearly  
 gs on the days  
 the land tax sewer  
 sments whatsoever  
 after to be imposed  
 proportionate part  
 the Quarterly day  
 aid tenancy and the  
 will not do or suffer  
 all times well and  
 keep and leave the  
 l will also keep the  
 and interior walls  
 the determination of  
 nises in such repair  
 esty his heirs or  
 WARD or other the  
 g of His Majesty's  
 management of the  
 mmissioner or Com-  
 AND will permit

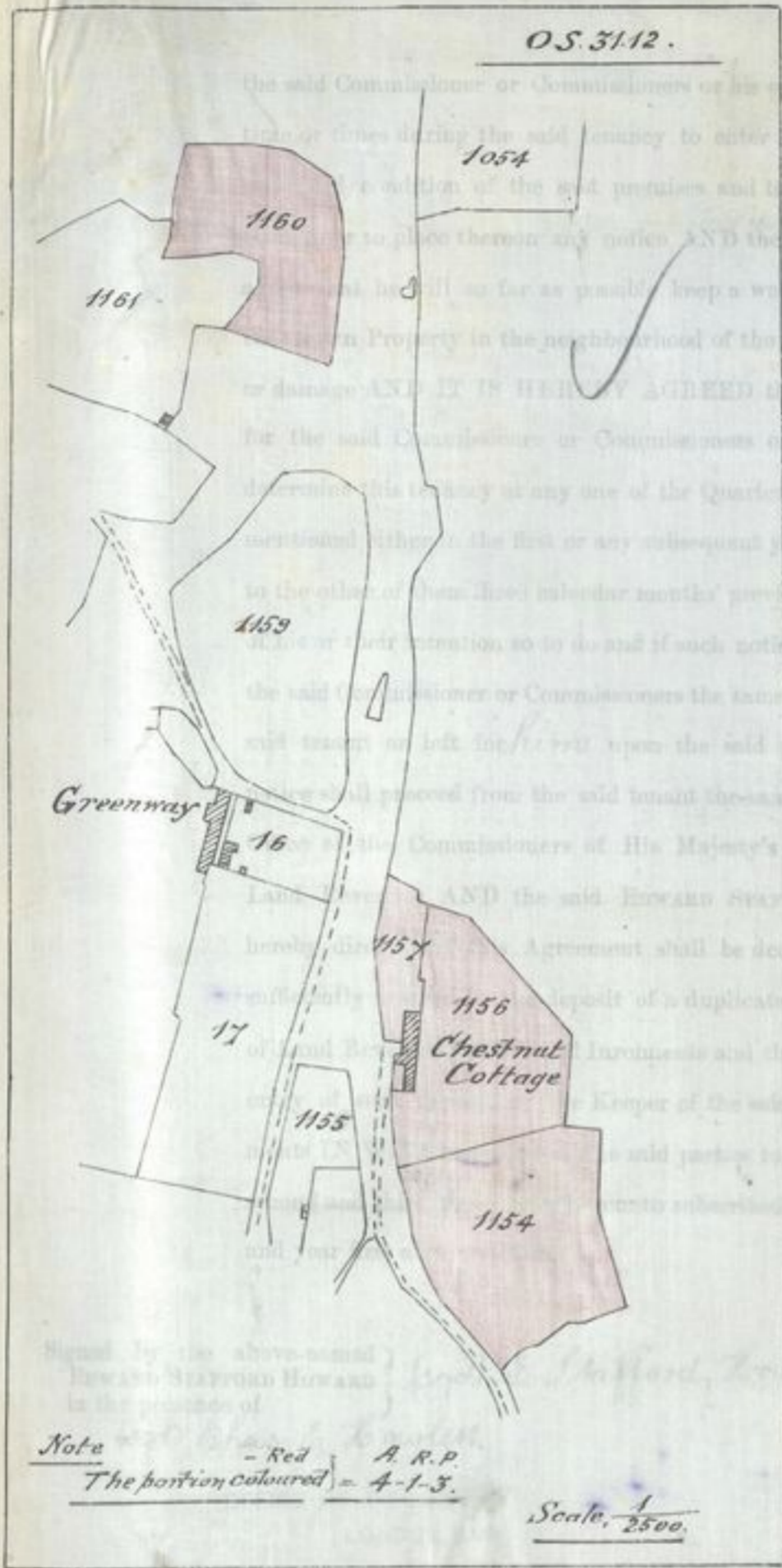

the said Commissioner or Commissioners or his agent at any  
 time or times during the said tenancy to enter into and inspect the  
 premises and to execute any works  
 to place thereon any notices AND the said tenant further  
 shall so far as possible keep a watch over and protect  
 the Property in the neighbourhood of the premises from injury  
 or damage AND IT IS HEREBY AGREED that it shall be lawful  
 for the said Commissioner or Commissioners or the said tenant to  
 determine this tenancy at any one of the Quarterly days hereinbefore  
 mentioned either at the first or any subsequent year thereof by giving  
 to the other of them three calendar months' previous notice in writing  
 of their intention so to do and if such notice shall proceed from  
 the said Commissioner or Commissioners the same may be given to the  
 said tenant or left for him upon the said premises and if such  
 notice shall proceed from the said tenant the same shall be left at the  
 Office of the Commissioners of His Majesty's Woods Forests and  
 Land and the said Edward Stafford HOWARD doth  
 hereby certify that the Agreement shall be deemed to be fully and  
 deposited of a duplicate thereof in the Office  
 of the said Commissioners and the Clerk or making an  
 entry of the said tenancy in the books and Inrol-  
 lments of the said tenancy presents of the  
 names the day

the said Commissioner or Commissioners or his or their agent at any time or times during the said tenancy to enter into and inspect the state and condition of the said premises and to execute any works thereon or to place thereon any notice AND the said tenant further agrees that he will so far as possible keep a watch over and protect the Crown Property in the neighbourhood of the premises from injury or damage AND IT IS HEREBY AGREED that it shall be lawful for the said Commissioner or Commissioners or the said tenant to determine this tenancy at any one of the Quarterly days hereinbefore mentioned either in the first or any subsequent year thereof by giving to the other of them three calendar months' previous notice in writing of his or their intention so to do and if such notice shall proceed from the said Commissioner or Commissioners the same may be given to the said tenant or left for *him* upon the said premises and if such notice shall proceed from the said tenant the same shall be left at the Office of the Commissioners of His Majesty's Woods Forests and Land Revenues AND the said EDWARD STAFFORD HOWARD doth hereby direct that this Agreement shall be deemed to be fully and sufficiently inrolled by the deposit of a duplicate thereof in the Office of Land Revenue Records and Inrolments and the filing or making an entry of such deposit by the Keeper of the said Records and Inrolments IN WITNESS whereof the said parties to these presents of the second and third parts have hereunto subscribed their names the day and year first above written.

Signed by the above-named  
EDWARD STAFFORD HOWARD } (sgd) E. Stafford Howard.  
in the presence of  
(sgd) Chas. E. Rowlett.

OFFICE OF WOODS,  
LONDON, S.W.

Signed by the above-named  
Edward Phillips } (sgd) Edward Phillips.  
in the presence of  
(sgd) Campbell Anderson,  
Edgehills Lodge,  
Brown Woodman.

Inrolled  
15/11/04.

DEAN FOREST.

Dated \_\_\_\_\_ 190 .

EDWARD STAFFORD HOWARD, Esq., C.B.  
a Commissioner of His Majesty's Woods,

&c.,  
AND

\_\_\_\_\_

AGREEMENT for letting

on a Yearly Tenancy from the

\_\_\_\_\_ 190 .

Rent £ \_\_\_\_\_ per Annum.

W. H. & L. (s) - 27720 - 100.12.4

DEAN FOREST.

Dated

190 .

EDWARD STAFFORD HOWARD, Esq., C.B.  
a Commissioner of His Majesty's Woods,

&c.,

AND

File 4163<sup>1</sup>Dated  
9<sup>th</sup> September 1907County  
of  
Southampton.

New Forest.

E. Stafford Howard  
Esq. C.B. a  
Commissioner of  
Woods &c.and  
Mr. Philip James  
Gossling.Memorandum  
of additional  
rents of £2.6.8  
and £7.10.0 in  
respect of outlay  
by the Crown.

Memorandum. It is hereby agreed and declared that as from the first day of September One thousand nine hundred and one an additional rent of Two Pounds six shillings and eight pence per annum has become payable under the terms of the within written Indenture in respect of Forty six pounds seven shillings and nine pence outlay by the Crown in converting a Storehouse into a Dairy and sinking a Well upon the within mentioned premises. And also that as from the first day of May One thousand nine hundred and seven a further additional rent of Seven Pounds ten shillings per annum has in like manner become payable in respect of One hundred and forty nine Pounds five shillings outlay by the Crown in making a new Bathroom converting an old loft into a bedroom and putting a new kitchen range with high pressure boiler upon the within mentioned premises. And Edward Stafford Howard doth hereby direct that this Memorandum shall be deemed to be fully and sufficiently enrolled by the deposit of a duplicate thereof in the Office of Land Revenue Records and Inrolments and the filing or making an entry of such deposit by the Keeper of the said Records and Inrolments.

Dated this ninth day of September One thousand nine hundred and seven.

Signed by the within named  
Philip James Gossling in the  
presence of Louis Edward Mac Iver.  
The Kings House,  
Lyndhurst  
Clerk to Deputy Surveyor of New Forest.

Philip James Gossling.

Signed by the within named  
Edward Stafford Howard  
in the presence of.  
Ralph Campbell Major  
Bawdor Castle,  
Navin.  
Army

E. Stafford Howard.

File  
Dated 2<sup>nd</sup>

Dear

E. Stafford  
C.B. a  
of Woods

Mr. J.

Con

Waste for  
in Park

Consider

I certify that a duplicate of this Memorandum has been deposited in the Office of Land Revenue Records and Involvements and an entry thereof made or filed by me.

Assistant Keeper of the Records

File 897<sup>16</sup>

Dated 2<sup>nd</sup> October 1907.

Dean Forest.

E. Stafford Howard Esq.  
C.B. a Commissioner  
of Woods to

Mr. J. Page.

Conveyance

of  
Waste Land at Parkend  
in Parkend Walk.

Consideration £3. 5. 0

This Indenture made the second day of October One thousand nine hundred and seven Between The King's Most Excellent Majesty of the first part Edward Stafford Howard Esquire C.B. the Commissioner of His Majesty's Woods in charge of the Land Revenues of the Crown in the Forest of Dean on behalf of His Majesty of the second part and James Page of Parkend near Lydney in the County of Gloucester of the third part. Witnesseth that in consideration of the sum of Three Pounds five shillings paid by the said James Page to the said Edward Stafford Howard before the sealing and delivery of these presents of which sum the said Edward Stafford Howard doth hereby acknowledge the receipt. The said Edward Stafford Howard as such Commissioner as

aforesaid and by virtue of the powers of the Crown Lands Act 1829 to 1989 doth by these presents Grant unto the said James Page and his heirs All that piece or parcel of land containing six perches and one half of another perch or thereabouts situate at Parkend in Parkend Walk in the Forest of Dean in the County of Gloucester bounded on the north east by the Cannock brook on the north-west and south east by open Forest and on the south-west by a strip of waste land running alongside the new road leading through Parkend which said land and premises intended to be hereby granted are delineated and coloured red on the plan drawn on these presents except and reserving out of this grant the soil of the bed of the brook running at the rear

of

of the said land and premises hereby conveyed and coloured blue on the said plan and all mines minerals stone and other substrata whether of a metallic or of any other nature within under or upon the said land and premises hereby conveyed with full power from time to time and at all times for ever hereafter to enter upon search for work use raise carry away and enjoy the same as fully and effectually to all intents and purposes as if this grant had not been made And also save and except full power from time to time and at all times hereafter to search for work drain use raise carry away and enjoy any other mines minerals stone or substrata belonging to His Majesty and lying beyond the limits of the land and premises hereby granted through or over the same as fully and effectually to all intents and purposes as if this grant had not been made. To hold the said premises hereby conveyed (subject nevertheless to all the rights powers and privileges of all present and future holders or grantees of any gales leases or licences of or concerning any mines or minerals according to the laws customs and regulations of the Forest of Dean) unto the said James Page his heirs and assigns for ever. And the said James Page hereby for himself his heirs and assigns and to the intent and so as to bind not only himself personally but also as far as practicable all persons claiming title under him to the land and premises hereby assured or any part thereof and to bind such land and premises into whatsoever hands the same may come covenant with the King's Majesty His heirs and Successors that he the said James Page his heirs undertenants and assigns will not at any time hereafter erect any building or erection on any part of the said land and premises without the previous consent in writing of the said Edward Stafford Howard or other the Commissioner or Commissioners for the time being in charge of the said Forest of Dean his or their

successors



successors or assigns and will at all times hereafter maintain and keep the soil of the bed of the said brook opposite the said land and premises hereby conveyed clean and in good order and condition to the satisfaction of such Commissioners or Commissioners as aforesaid. And will upon every conveyance lease or other assurance of the said land and premises or any part thereof give to the purchaser lessee or grantee express notice of such covenants. And the said Edward Stafford Howard doth hereby direct that this Deed shall be deemed to be fully and sufficiently enrolled by the deposit of a duplicate thereof in the Office of Land Revenue Records and Involvements and the filing or making an entry of such deposit by the Keeper of the said Records and Involvements. In witness whereof the said parties to these presents of the second and third parts have hereunto set their hands and seals the day and year first above written.

Signed sealed and delivered  
by the above named Edward  
Stafford Howard in the presence  
of Morton Bram.

E. Stafford Howard. *(L.S.)*

Signed sealed and delivered  
by the above named James  
Page in the presence of

James Page. *(L.S.)*

John Roper,  
Parkend, N. Sydney, Glos.  
Survey Clerk.

I certify that a duplicate of this Deed has been deposited in the Office of Land Revenue Records and Involvements and an entry thereof made or filed by me.

G. F. Handcock.

3<sup>rd</sup> October 1907. Assistant Keeper of the Records.

J



conveyed and  
mines minerals  
allie or of any  
d land and  
from time to  
enter upon  
d enjoy the  
rents and  
made And  
re to time  
work drain  
es mines  
His Majesty  
and premises  
as fully and  
as if this  
e said  
less to all the  
and future  
licences of or  
dring to the  
t of Dean)  
assigns for  
or himself  
and so as  
so as for  
under him  
t. or any part  
mines into  
enant with  
That he the  
and  
ect any  
said land  
nt in writing  
ther the  
time being  
or their  
successors

successors or assigns And will at all times hereafter maintain  
and keep the soil of the bed of the said brook opposite the said  
land and premises hereby conveyed clean and in good order  
and condition to the satisfaction of such Commissioners or  
Commissioners as aforesaid And will upon every conveyance  
lease or other assurance of the said land and premises or any  
part thereof give to the purchaser lessee or grantee express notice  
of such covenants And the said Edward Stafford Howard  
doth hereby declare that this Deed shall be deemed to be  
fully and sufficiently enrolled by the deposit of a duplicate  
of it in the Office of Land Revenue Records and Involvements  
and the filing or making an entry of such deposit by the  
Keeper of the said Records and Involvements. In witness  
whereof the said parties to these presents of the second and  
third parts hereof have hereunto set their hands and seals the  
day and year first above written

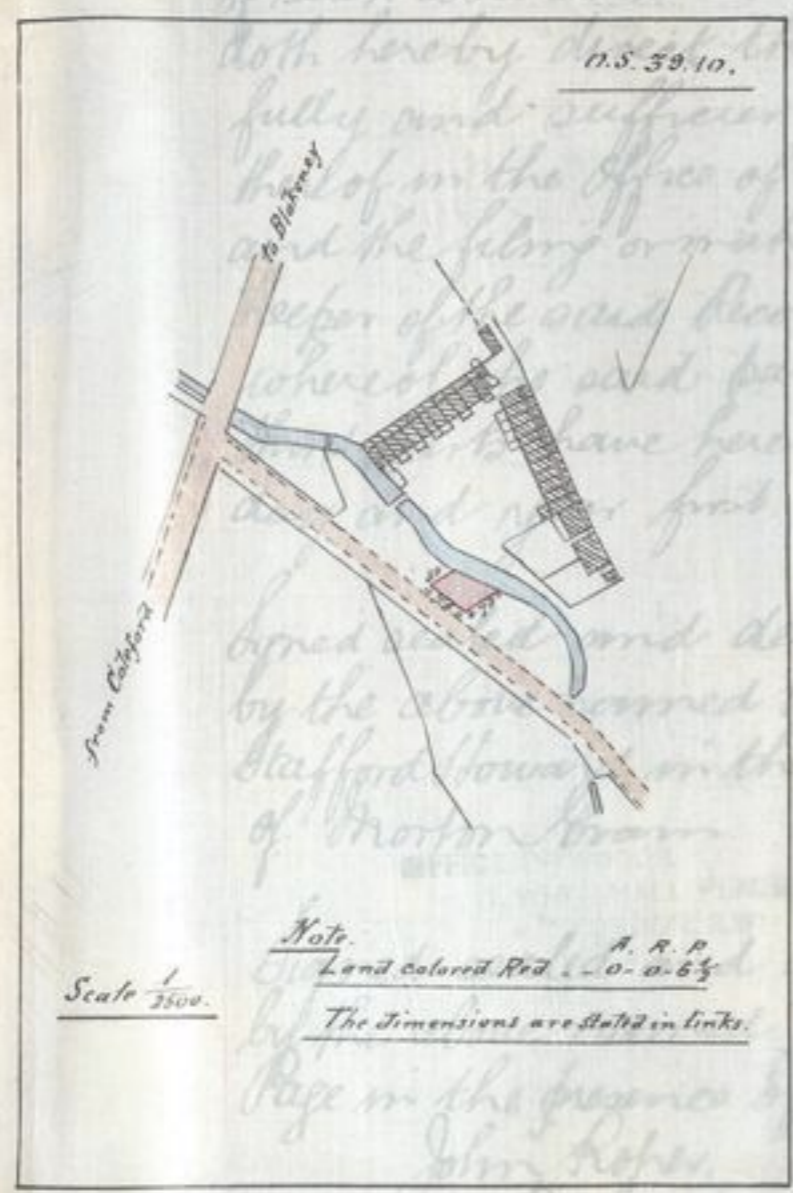

Edward Stafford Howard. L.S.

James Page. L.S.

Hydney Glos.

Survey Clerk.

I certify that a duplicate of this Deed has been  
deposited in the Office of Land Revenue Records and  
Involvements and an entry thereof made or filed by me.  
G. F. Hancock.  
3<sup>rd</sup> October Assistant Keeper of the Records.  
1907.

File 1453

Lched 19078

Dated  
28th. October  
1907.

County of  
Gloucester.

The King's  
Most  
Excellent  
Majesty  
to  
H. E. Goldring  
Esquire and  
another.

Conveyance  
of Homes Royal  
as within.

This Indenture made the twenty eighth day of October One thousand nine hundred and seven Between The King's Most Excellent Majesty of the first part Edward Stafford Howard. Esquire C.B. one of the commissioners of His Majesty's Woods Forests and Land Revenues of the second part and Horace Edward Goldring and William Wallace Hargrove both of to 99 Cannon Street in the City of London Solicitors of the third part Witnesseth that in pursuance of an agreement in this behalf and in consideration of concessions on the part of the said Horace Edward Goldring and William Wallace Hargrove with reference to other matters and in order to carry such mutual arrangements into effect the said Edward Stafford Howard as such Commissioner and on behalf of the King's Most Excellent Majesty in pursuance of the Crown Lands Acts 1829 to 1906 and other powers enabling him in this behalf grants and conveys unto the said Horace Edward Goldring and William Wallace Hargrove and their heirs All and singular the Gold and Gold ore and Silver and Silver ore and all other the Homes Royal under the lands coloured red on the plan hereto annexed which belong to His Majesty in right of His Crown To hold the same unto and to the use of the said Horace Edward Goldring and William Wallace Hargrove their heirs and assigns for all the estate and interest of His Majesty in right of His Crown therein. And the said Edward Stafford Howard doth hereby direct that this Deed shall be deemed to be fully and sufficiently enrolled by the deposit of a duplicate thereof in the Office of Land Revenue Records and Involvements and the filing or making an entry of such deposit by the Keeper of the said Records and Involvements. In witness whereof the said parties to these presents of the second and third parts have hereunto set their

hands and seals the day and year first above written.

Signed sealed and delivered  
by the above named Edward  
Stafford Howard in the presence  
of Algan Howard,  
Thornbury Castle. Glo.  
Barrister-at-Law.

E. Stafford Howard. (L.S.)

Signed sealed and delivered  
by the above named Horace  
Edward Goldring in the presence  
of Charles S. Goldring,  
99 Cannon St.  
London E.C.6.  
Solicitor.

Horace E. Goldring. (L.S.)

Signed sealed and delivered  
by the above named William  
Wallace Hargrove in the  
presence of Charles S. Goldring  
as above.

W. W. Hargrove. (L.S.)

I certify that a duplicate of this Deed has been  
deposited in the Office of Land Revenue Records and  
Involvements and an entry thereof made or filed by me.

G. F. Hancock

Assistant Keeper of the Records.

6 Novem: 1907

tg

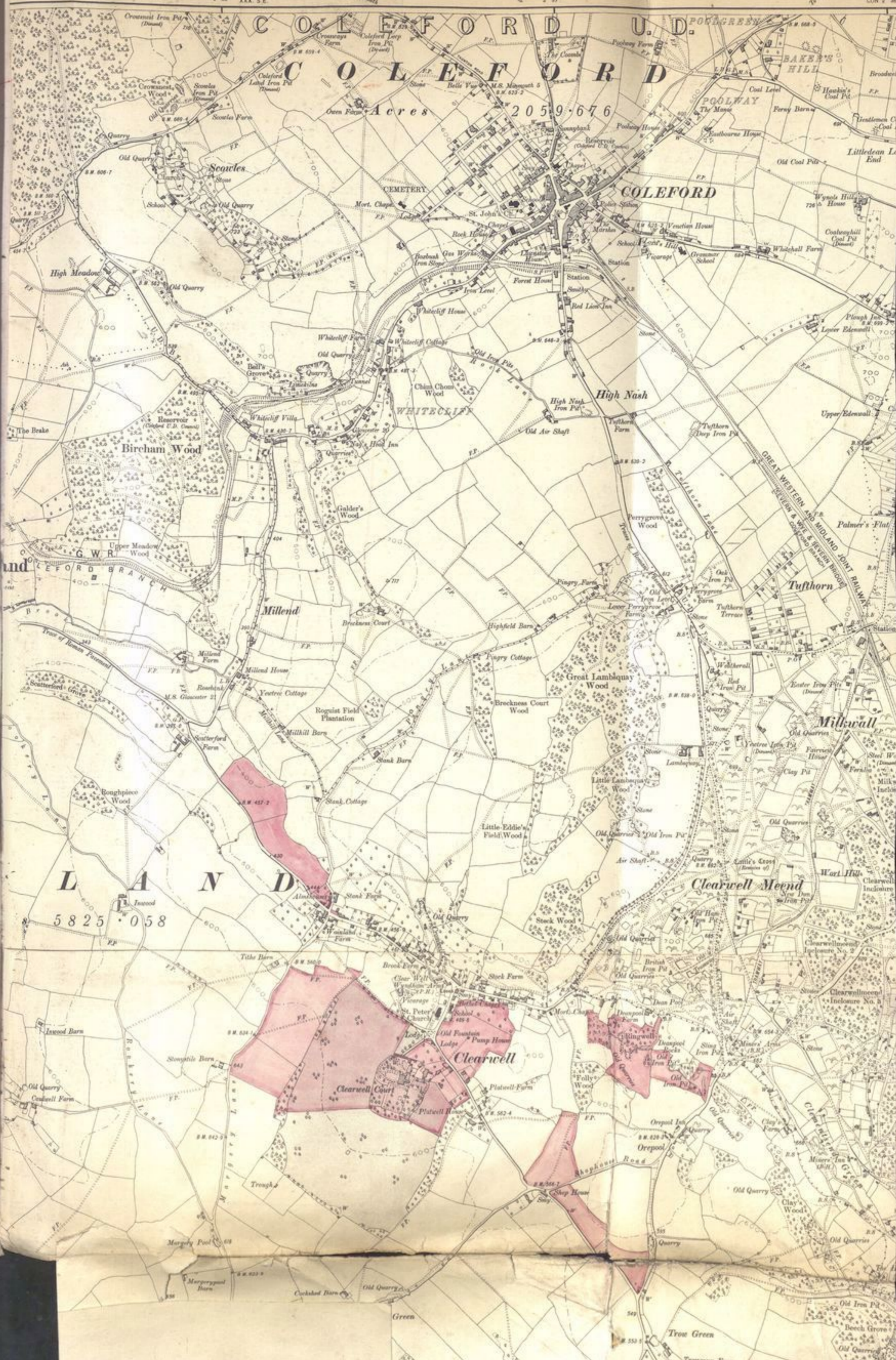

of  
 ty  
 sure  
 and  
 Street  
 t  
 in  
 and  
 the  
 ord  
 the  
 of  
 powers  
 ing  
 is  
 and  
 Royal  
 to  
 of  
 use  
 am  
 all  
 this  
 toward  
 ed  
 land  
 ing  
 Keeper  
 dress  
 ur

File 1453 *Commence Dec 76 + 78*

Dated  
26 October  
1907.

Dean Forest.

Hundred of  
St. Bravels.

Clearwell  
Court Estate.

E. Stafford  
Howard Esquire

CB a  
Commissioner  
of Woods &c.

and  
The Owners of  
the said  
Estate as to  
Minerals &c.

Deed  
of  
Agreement.

This Indenture made the twentysixth day of October One thousand nine hundred and seven Between The Kings Most Excellent Majesty of the first part. Edward Stafford Howard Esquire CB. one of the Commissioners of His Majesty's Woods, Forests and Land Revenues (hereinafter called the Commissioners of which expression shall when the context admits include the Commissioners and Commissioners for the time being) of the second part and Horace Edward Goldring and William Wallace Stargrove both of 1699 Cannon Street in the City of London Solicitors (hereinafter called the Mineral Claimants which expression shall when the context so admits include their predecessors and successors in title) of the third part Whereas the Clearwell Court Estate is situate in the Parishes of Newland and St. Bravels within the Hundred of St. Bravels in the County of Gloucester but with the exception of so much thereof as was enclosed under the Walmore and Bearse Inclosure Act 1866 it is outside the limits of the Forest of Dean and previously to the same being put up for sale by public auction in June One thousand nine hundred and seven it was agreed between the Commissioners and the Mineral Claimants (who were mortgagees thereof and were selling under their statutory powers of sale as Mortgagees) that the claim to minerals under the said Estate made by the Mineral Claimants should be settled upon certain terms the principles of which had been arranged between the Commissioners and the Mineral Claimants and which are embodied in the provisions relating to the same hereinafter contained. And whereas as to such parts of the said Estate other than a strip of land containing two roods and six perches near Inwood Farm marked B and hatched red on the plan hereto annexed as were not included in certain notices given by the Earl of Dunraven in the year One thousand eight hundred and thirty eight under

The 67<sup>th</sup> Section of the Dean Forest Mines Act 1838 the coal and  
 Iron therein are liable to be galed to the Freeholders of the  
 Forest of Dean and the owners of such lands are under Section  
 67 of the said Act entitled to one moiety of the net galeage rent  
 royalty or tonnage duty (after deducting all expenses of  
 collection and recovery) received therefrom by the Crown  
 and also under Section 68 of the said Act to compensation  
 for surface damage done or occasioned to such lands by  
 the working of minerals thereout And whereas such  
 parts of the said Estate as were enclosed under the Walmore  
 and Pearce Inclosure Act 1866 form part of the Forest of  
 Dean and the minerals therein are the property of His  
 Majesty subject to such of the provisions of the Dean Forest  
 Mines Act 1838 as are applicable thereto And whereas the  
 minerals in the said strips of land containing Two roads  
 and six perches near Inwood Farm are the absolute  
 property of His Majesty free from all rights of Freeholders  
 under the said Act of 1838 And whereas questions as  
 to the ownership of the surface of a piece of land at Stow  
 and the Stone in a Quarry thereon marked A on the said  
 plan which had been and was being worked by a tenant  
 of the then owner of the said Estate have arisen between  
 the Commissioners and the Mineral Claimants And it has  
 been agreed between the Commissioners and the Mineral  
 Claimants that such questions shall be settled upon the  
 terms hereinafter expressed concerning the same And  
 whereas questions also have arisen as to the avenue of trees  
 along the road from Breamscross to Trow Green also  
 marked on the said plan and it has been agreed between  
 the Commissioners and the Mineral Claimants that such  
 questions should be settled upon the terms hereinafter expressed  
 concerning the same Now this Indenture witnesseth  
 and it is hereby mutually agreed and  
 declared between and by the parties hereto as follows:-

1. The Crown hereby admits the right of the Mineral Claimants to all Minerals except Mines Royal in the lands hatched green on the said plan.
2. The Mineral Claimants hereby admit the right of the

of  
 esty  
 require  
 forests  
 score  
 include  
 (ing)  
 bring  
 l. 1899  
 remain  
 in  
 air  
 d part  
 the  
 stars  
 as  
 sure  
 dean  
 le by  
 added  
 ories  
 es  
 fowers  
 also  
 amian's  
 bles  
 mission  
 e  
 ame  
 such  
 nd  
 wood  
 on  
 r one  
 dev



**REFERENCE.**

- Green colour edged Green. — Clearwell Court Estate as at present, except the parts sold to the Crown and the portion of Bearse Common north of the Road.
- Green colour edged Blue. — Certain lands now forming part thereof comprised in notice of exemption under Dean Forest Mines Act 1838 given by Lord Dunraven.
- Green hatching. — Lands in which Minerals to be given up by Crown (Crown title to Minerals in all the remaining Lands coloured Green to be admitted) subject to rights of owners or owner respecting such parts of such Lands as are liable to be galed to Freeholders of the forest of Dean.
- Red edging. — Boundary of Dean Forest.

Acres 4809.492

PUBLIC S

Crown to all minerals in so much of the lands coloured green on the said plan as is not hatched and that the Crown shall have full power to work such minerals making compensation in the usual manner in practice in the Forest of Dean for any damage caused to the surface by such workings and also subject as to such parts as are liable to be galed to Her Majesty of the Forest of Dean to the payment to the Mineral Claimants or other or others the owner or owners for the time being of the surface of such lands of one moiety of the net galeage rent royalty or tonnage duty received therefrom by the Commissioners.

3. The Crown shall convey to the Mineral Claimants or their permitted assigns or nominees the Mines Royal in the lands hatched green.

4. The Crown hereby releases all claims to the surface of the said piece of land marked A on the said plan wherein the said Quarry of stone lies and shall when called upon to do so grant a lease of the said stone to the Mineral Claimants or their permitted nominees or nominee for a term of thirty one year from the twenty ninth day of September One thousand nine hundred and six at a certain or dead yearly rent of One pound merging into a royalty of One penny per ton of Two thousand two hundred and forty pounds weight on all stone gotten sold used or otherwise disposed of such lease to be prepared by and at the cost of the Mineral Claimants but to be approved of by the Commissioners and the Crown shall make no claim for past workings thereof.

5. The Crown shall henceforth maintain the said avenue of trees in good condition and when occasion shall require duly lop and trim the trees forming the same and plant other trees from time to time as occasion shall require in the place of decayed or dead or fallen trees and do whatever may be necessary so far as is practicable in order to continue the same as an avenue of ornamental trees.



And the said Edward Stafford Howard doth hereby direct that this Deed shall be deemed to be fully and sufficiently enrolled by the deposit of a duplicate thereof in the Office of Land Revenue Records and Involvements and the filing on or making an entry of such deposit by the Keeper of the said Records and Involvements.

In witness whereof the said parties to these presents of the second and third parts have hereunto set their hands and seals the day and year first above written.

Signed sealed and delivered  
by the above named Edward  
Stafford Howard in the presence  
of Algat Howard,  
Thornbury Castle, Glo.  
Barrister at Law

E. Stafford Howard. 

Signed sealed and delivered by  
the above named Horace Edward  
Goldring in the presence of  
Charles S. Goldring,  
99 Cannon Street,  
Solicitor London. E.C.

Horace E. Goldring 

Signed sealed and delivered  
by the above named William  
Wallace Hargrove in the presence  
of Charles S. Goldring  
as above.

W. W. Hargrove. 

I certify that a duplicate of this Deed has been deposited in the Office of Land Revenue Records and Involvements and an entry thereof made or filed by me.

6<sup>th</sup> Nov. 1907.

G. F. Hancock,  
Assistant Keeper of the Records.

1907