

New Forest. F. 3456.

Easements Sir,

H. St. Barbe,

Permission
to repair Track
and new
approach road
at Vicar's Hill.
New Forest.

2 December
1905.

Transferred
to Lady Gertrude
Crawford 1907

Office of Woods,
1 Whitehall Place, S.W.
2nd December, 1905.

New Forest.
File 4323.

Easements. Repair of Track and new
Approach Road at Vicar's Hill.

The Deputy Surveyor of the New Forest has forwarded to this office your application for permission to (1) repair an existing forest track used by the public and (2) make and maintain a new approach road therefrom to a field belonging to you at Cox Hill.

In reply I am directed by Mr. Stafford Howard to state that he is willing to give you permission during the pleasure of this Department to (1) To repair the existing track (to which you will obtain no exclusive right) as shown by pink colour on the enclosed tracing and (2) to make and maintain a new approach road (from said track to field No. 282) as shown by yellow colour on said tracing upon the terms and conditions following, viz:-

1. In acknowledgment of 5/- per annum for the first mentioned permission and an acknowledgment of 10/- for the second mentioned permission are to be paid to the Deputy Surveyor in advance on the 10th October in each future year during the continuance of this permission the first payment in respect of the year to 10th October 1906 to be made on the acceptance of this offer.
2. In the event of these permissions being determined the surface of the soil is to be restored to its original condition to the satisfaction of the Deputy Surveyor.
3. The permission relating to the track coloured pink will include a right to fence the edge of the gravel pit which is near it.
4. In the event of any part of the field served by said approach road being developed for building purposes the amount of acknowledgment payable for the approach to it would have to be reconsidered.

f

HAMPSHIRE

Sheet LXXX.

M. Barbe

I have the honor to request that you will send the
to the Hon. Mr. Secretary of the Admiralty
to this Office the enclosed letter signed
I am, Sir, your obedient servant
M. Barbe Esq.

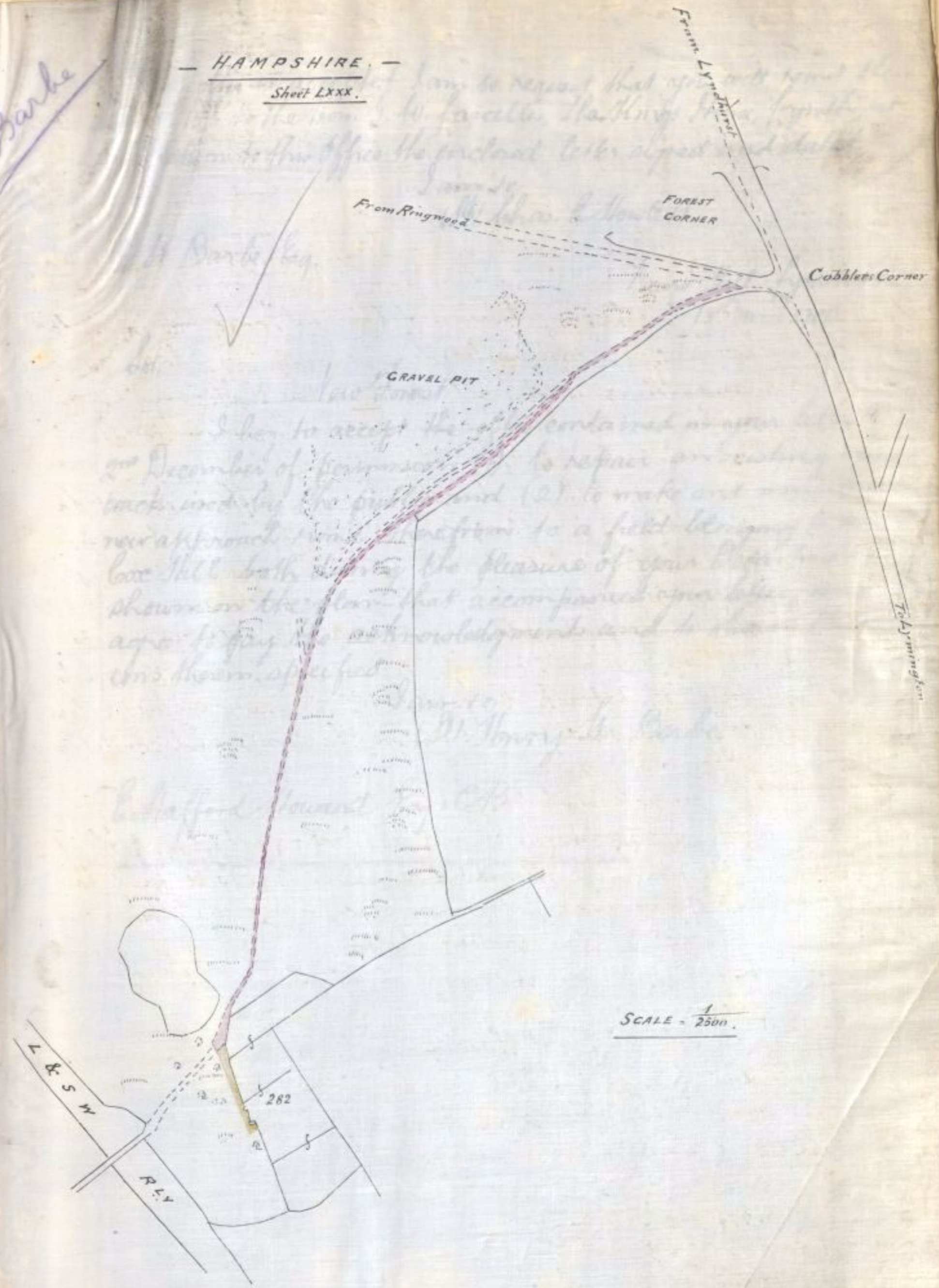

SCALE = 1/2500

M. Henry Barbe

Chafford House Esq.

642
Latham
TS 0/8

S.W.

warded
repair
(2)
from

ad to
ing the
ing
kt) as
and
road
yellow
ditions

the first
of 18
to
er in

permission
ber 1406

ined.
al
eyor.
d pinks
travel

by
uilding
jable
onsidered.

f

If this offer is accepted I am to request that you will remit the sum of 15/- to the Hon. G. W. Fawcett, The Kings House, Lyndhurst and return to this Office the enclosed letter signed and dated

I am, &c.
(Sd) Chas. E. Howlett.

H. St. Barbe, Esq.

Vicars Hill, Lymington
13th Jan: 1906.

Sir,

New Forest.

I beg to accept the offer contained in your letter of the 2nd December of permission (1) to repair an existing forest track used by the public and (2) to make and maintain a new approach road therefrom to a field belonging to me at Cox Hill, both during the pleasure of your Department as shown on the plan that accompanied your letter, and I agree to pay the acknowledgments and to observe the conditions therein specified.

I am, &c.
(Sd) Henry St. Barbe.

E. Stafford Howard, Esq., C.B.

TS

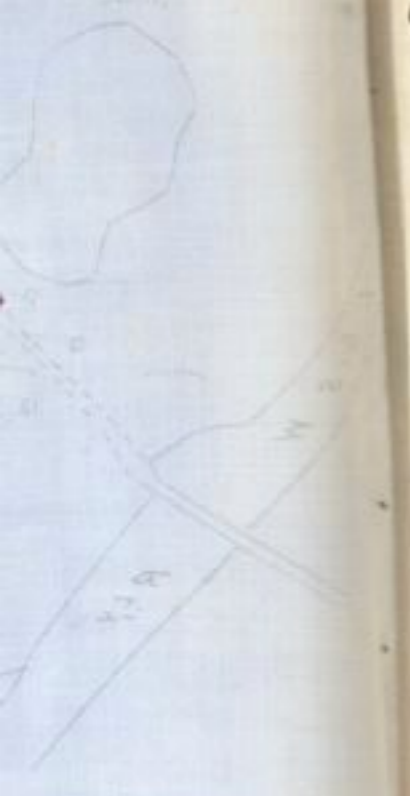

able
considered

f

642
L. Atkinson
TS 0/5

New Forest.

Easements.

Mrs Ward-
Jackson.Permission
to maintain
a wicket gate
at Emery
Down.22nd December
1905.Acknowledgt.
2/6 per ann.

F. 3758.

Madam,

New Forest. File 4323.

Easements. Wicket Gate.

The Deputy Surveyor of the New Forest has forwarded to this Office your application for permission to place a wicket gate in the fence of your orchard at Emery Down.

In reply I am directed by Mr. Stafford Howard to

state that he is willing to give you permission to make and to maintain during the pleasure of this Department to maintain a wicket gate in the fence of your orchard leading to a road which is waste of the Forest, at Emery Down in the position shown by red cross on the enclosed tracing upon the terms and conditions following, viz:-

1. An acknowledgment of 2/6^d per annum is to be paid to the Deputy Surveyor in advance on the 10th October in each future year during the continuance of this permission, the first payment in respect of the year to 10th October, 1906 to be made on the acceptance of this offer.
2. In the event of this permission being determined the opening in the fence is to be closed up and the surface of the soil is to be restored to its original condition to the satisfaction of the Deputy Surveyor. If this offer is accepted I am to request that you will remit the sum of 2/6^d to the Hon. G. W. Jascelles, The King's House, Lyndhurst, and return to this Office the enclosed letter signed and dated.

I am, &c.

(Sd) Chas. E. Howlett.

Mrs. Ward-Jackson,
Emery Down, Lyndhurst.

Sir,

New Forest.

File 4323.

I beg to accept the offer contained in your letter of the

Office of Woods &
22nd December, 1905.Emery Down,
Lyndhurst.
28th December, 1905

Sheet LXXII.1.
Hants.

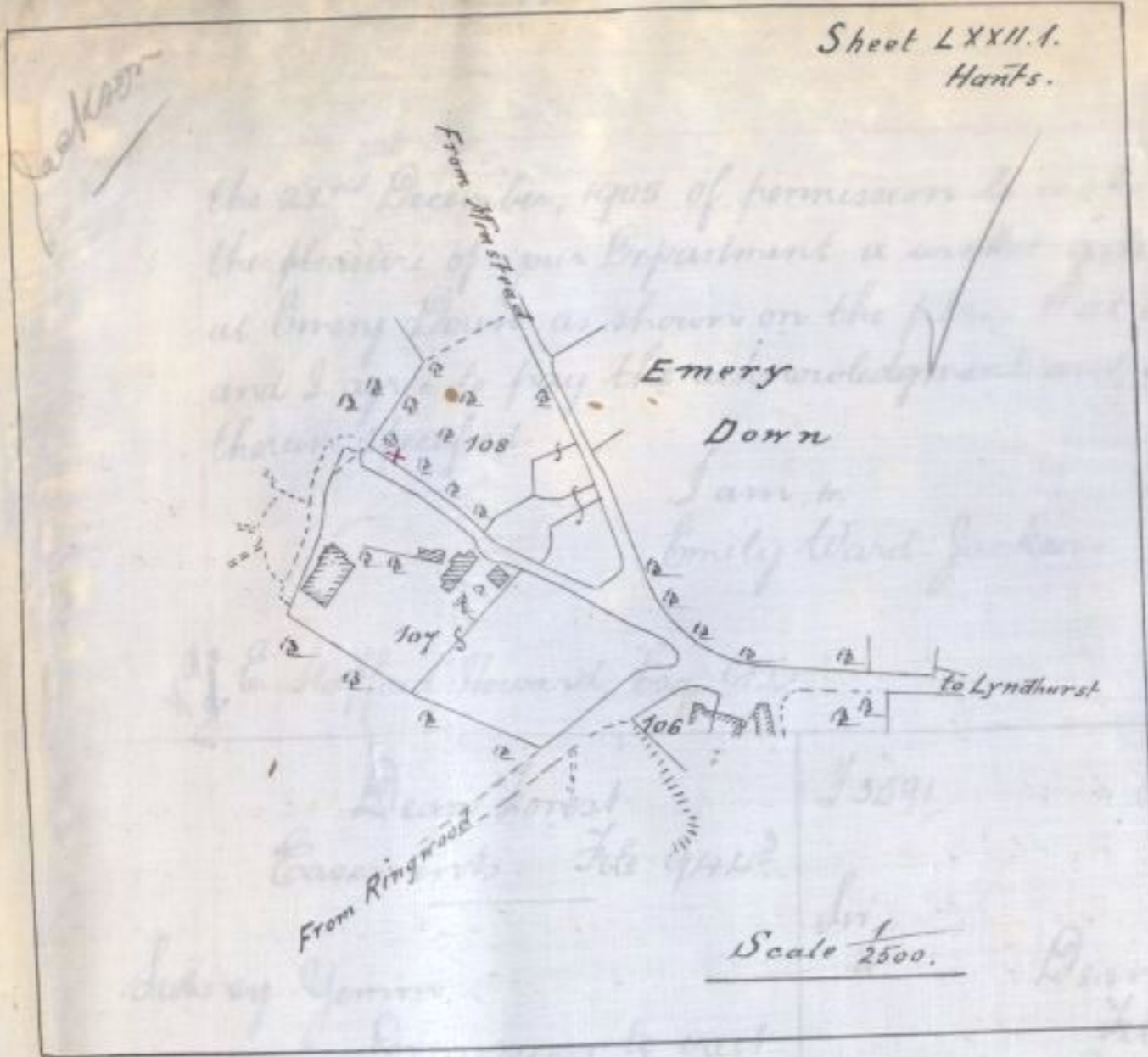

and maintain during
the fence of my orchard
I am to
I have accompanied your letter
to observe the conditions

Office of Woods,
December, 1905.

14 December, 1905.

Mr. Philip Baylis the Deputy
Surveyor has reported to Mr Stafford

Howard your application for leave to erect a shed or hut at
Viney Hill on a piece of the waste of the Forest in the position
shown by pink colour on the enclosed tracing. In reply I

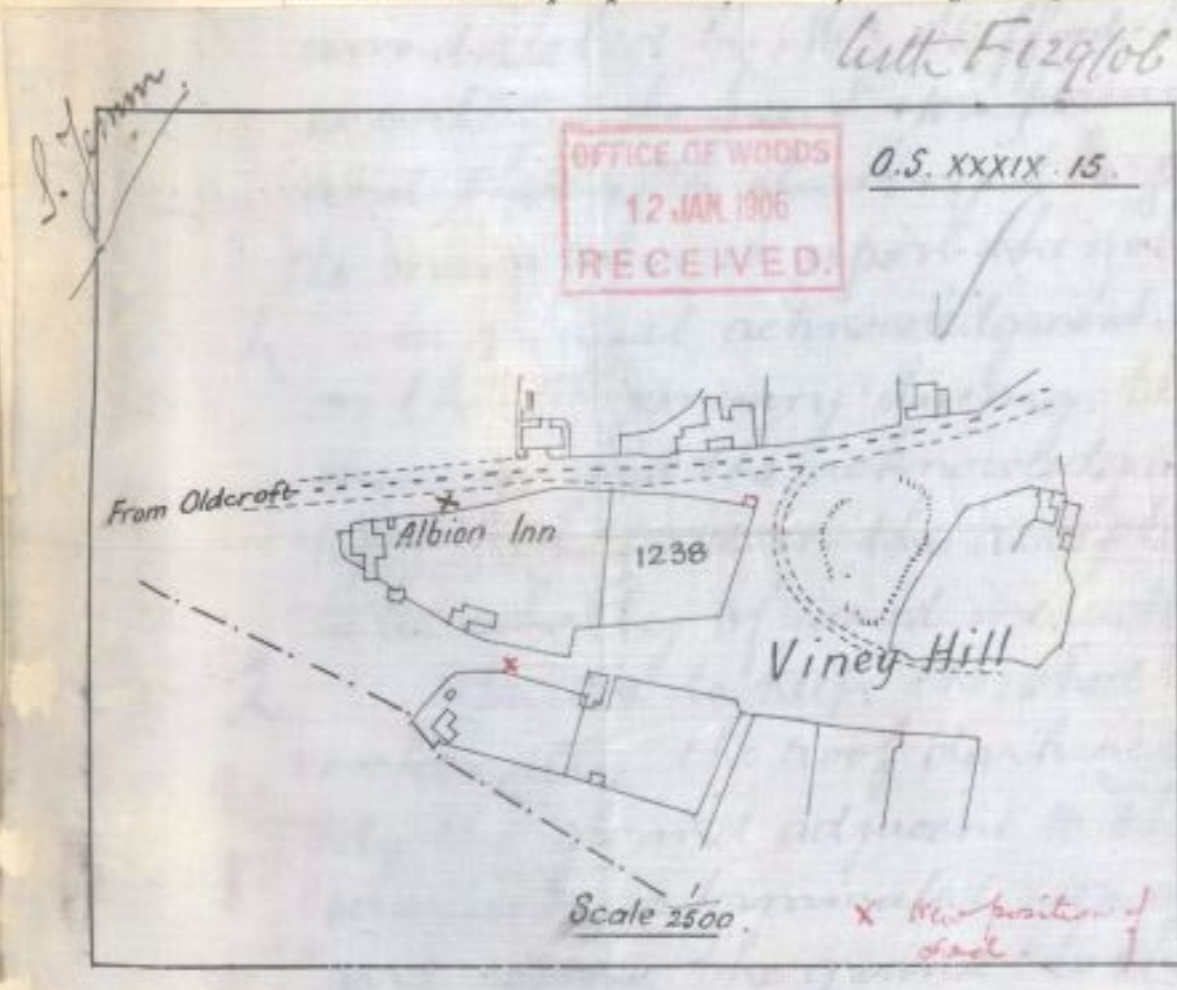

to inform you that he
to erect a shed or hut
of this Department
my terms and conditions:
is to be paid in advance
continuance of this per-
for the year to 5th January
of this offer. The shed is
the roof.

good repair and painted
and the sides green, to keep
bed and whenever this
if required, to remove it
satisfaction of the Deputy

If you desire to accept these terms you will be good
enough

Permission
of shed. In
this position

642
L. 10/10/05
TS O/P

the 22nd December, 1905 of permission to make and maintain during the pleasure of your Department a wicket gate in the fence of my orchard at Emery Down as shown on the plan that accompanied your letter and I agree to pay the acknowledgment and to observe the conditions therein specified.

I am, to
Emily Ward-Jackson.

E. Stafford Howard Esq. CB

Dean Forest
Easements. File 944³

73591.

Office of Woods.

14 December, 1905.

Sidney Gemm,
Permission to erect
a shed at Viney Hill.

Sir,

Dean Forest.
File 944³
Easements.

14 December, 1905.

Mr. Philip Baylis the Deputy Surveyor has reported to Mr. Stafford

Howard your application for leave to erect a shed or hut at Viney Hill on a piece of the waste of the Forest in the position shown by pink colour on the enclosed tracing. In reply I am directed by Mr. Stafford Howard to inform you that he is willing to grant you permission to erect a shed or hut and thereafter during the pleasure of this Department to maintain it upon the following terms and conditions:
1. An annual acknowledgment of it is to be paid in advance on the 5th January during the continuance of this permission and the acknowledgment for the year to 5th January 1907 to be paid on the acceptance of this offer. The shed is to be wholly of wood including the roof.

2. You are to keep the shed in good repair and painted externally the roof dark red and the sides green, to keep tidy the ground adjacent to the shed and whenever this permission is terminated you are, if required, to remove it and restore the ground to the satisfaction of the Deputy Surveyor.

If you desire to accept these terms you will be good

enough

Permission to allow the
of shed. See 11/12/05 21/5/944³
This position shown on tracing

642
Lattimer
T. O. P.

enough to date sign and return to this office the enclosed letter

I am, &c.

(S^d) Chas. E. Howlett.

Mr. Sidney Yemm.

Viney Hill,
1st January, 1906.

Sir,

Dear Forest.

File 944².

I beg to accept your offer dated 14th ult for permission to erect and maintain a shed or hut in the position shown upon the tracing which accompanied the above mentioned letter and I agree to pay the acknowledgment and to observe the conditions therein specified.

I am, &c.

(S^d) Sidney Yemm.

E. Stafford Howard, Esq.

1/1

(Copy)

DEAN FOREST.

Articles of Agreement made the
 ninth day of February One Thousand
 nine hundred and ^{six} ~~five~~ Between THE KING'S
 MOST EXCELLENT MAJESTY of the first part EDWARD
 STAFFORD HOWARD Esquire C.B. a Commissioner of His
 Majesty's Woods Forests and Land Revenues of the second part and
 John Harper of binderford —
 (hereinafter called "the said Tenant") of the third part

THE said EDWARD STAFFORD HOWARD as such Commissioner
 as aforesaid on behalf of His Majesty hereby agrees to let to the said
 tenant who hereby agrees with His Majesty to take and rent as tenant
 to His Majesty ALL THAT cottage and garden
 being No. 5 of a row cottages known
 as Hawkwell cottages situate near
 binderford in the County of Gloucester
 containing about 21 perches and
 coloured red on the plan annexed hereto

_____ lately in the
 occupation of Henry Prothero _____
 together with the fixtures therein TO HOLD the same hereditaments
 to the said tenant from the 10th day of October 1905

642
 Latham
 TS O/P

enough
enclo

Mr.

Sir,

for
in
accom
to pay
therein

E. S.

as tenant from year to year (the tenancy being however determinable as after mentioned) at the yearly rent of £ 4 - 0 - 0 - to be paid to the Deputy Surveyor of Dean Forest free from all taxes rates and deductions whatsoever (except Landlord's property tax) by equal Quarterly payments on the 5th day of January - the 5th day of April - the 5th day of July - and the 10th day of October in every year the first Quarterly payment to be due on the 5th day of January 1906 - AND the said tenant hereby agrees that he will pay to the King's Majesty the said yearly rent of £ 4 - 0 - 0 - on the days and in the manner aforesaid And will also pay the land tax sewer rates and all other rates taxes and assessments whatsoever (except the Landlord's property tax) now or hereafter to be imposed in respect of the said premises Together with a proportionate part thereof for the period which shall elapse between the Quarterly day of payment next preceding the expiration of the said tenancy and the day on which the same shall expire AND also will not do or suffer any damage to the said premises and will at all times well and properly manage and cultivate the said land and keep and leave the same clean and in good heart and condition and will also keep the windows and doors in good repair and the ceilings and interior walls properly cleaned and whitewashed and will on the determination of the tenancy hereby created deliver up the said premises in such repair and condition as aforesaid to the King's Majesty his heirs or successors or to the said EDWARD STAFFORD HOWARD or other the Commissioner or Commissioners for the time being of His Majesty's Woods Forests and Land Revenues having the management of the said premises (hereinafter called "the said Commissioner or Commissioners") or to whom he or they may appoint AND will permit

the said Commissioner or Commissioners or his or their agent at any time or times during the said tenancy to enter into and inspect the state and condition of the said premises and to execute any works

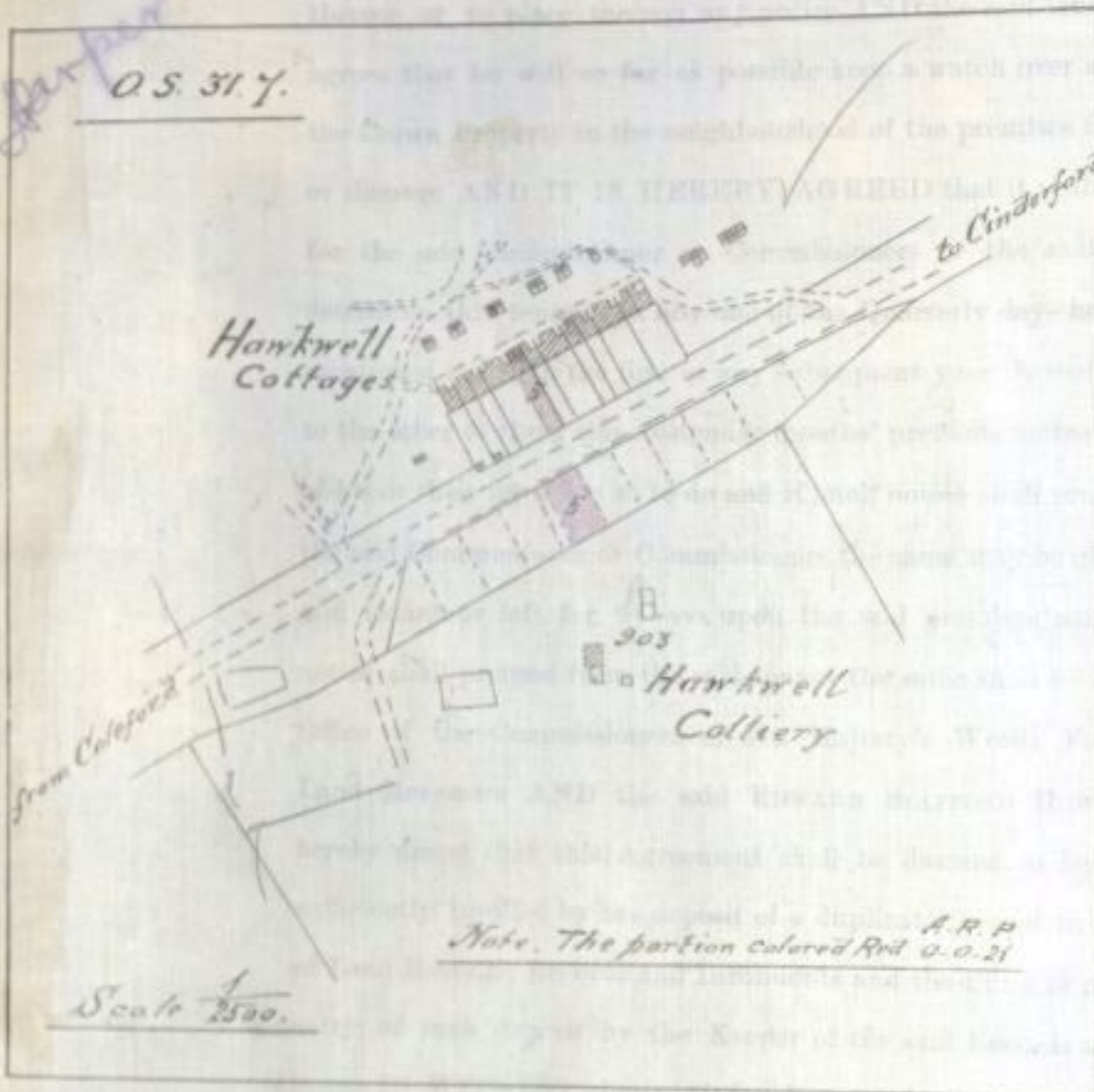

and year first above written.

Signed by the above-named }
 EDWARD STAFFORD HOWARD }
 in the presence of }
 (sgd.) Algas H. S. Howard }
 Thornbury Castle, Glos. }
 Barrister-at-law }

(Sd) E. Stafford Howard

Signed by the above-named }
 John Harper }
 in the presence of }
 (sgd.) Henry Smith }
 Herbert Lodge }
 Brown Keeper }

(Sd) J Harper

Enrolled
13th February, 1906.

642
L. Atkinson
TS O/P

the said Commissioner or Commissioners or his or their agent at any time or times during the said tenancy to enter into and inspect the state and condition of the said premises and to execute any works thereon or to place thereon any notice AND the said tenant further agrees that he will so far as possible keep a watch over and protect the Crown Property in the neighbourhood of the premises from injury or damage AND IT IS HEREBY AGREED that it shall be lawful for the said Commissioner or Commissioners or the said tenant to determine this tenancy at any one of the Quarterly days hereinbefore mentioned either in the first or any subsequent year thereof by giving to the other of them three calendar months' previous notice in writing of his or their intention so to do and if such notice shall proceed from the said Commissioner or Commissioners the same may be given to the said tenant or left for *him* upon the said premises and if such notice shall proceed from the said tenant the same shall be left at the Office of the Commissioners of His Majesty's Woods Forests and Land Revenues AND the said EDWARD STAFFORD HOWARD doth hereby direct that this Agreement shall be deemed to be fully and sufficiently inrolled by the deposit of a duplicate thereof in the Office of Land Revenue Records and Inrolments and the filing or making an entry of such deposit by the Keeper of the said Records and Inrolments IN WITNESS whereof the said parties to these presents of the second and third parts have hereunto subscribed their names the day and year first above written.

Signed by the above-named
EDWARD STAFFORD HOWARD
in the presence of

(sgd.) *Algar H. S. Howard*
Thornbury Castle, Glos.
Barrister-at-law

(Sd.) *E. Stafford Howard*

Signed by the above-named
John Harper
in the presence of

(sgd.) *Henry Smith*
Herbert Lodge
Brown Keeper

(Sd.) *J Harper*

Inrolled
13th February, 1906.

642
Watermark
T.S. O.P.

enough to date

DEAN FOREST.

Dated 9th February 1906.

EDWARD STAFFORD HOWARD, Esq., C.B.
a Commissioner of His Majesty's Woods,

&c.,

AND

John Barber

AGREEMENT for letting
No 5 Woodwell Row containing
21 Perches Kinderford
on a Yearly Tenancy from the
10th October 1905.
Rent £ 4 - 0 - 0 per Annum.



ed P.H.

5

letter

and

out a

the

11

le

ying

05.

06.

has

to

erty

am

long

ore

q

e

payment

642

Customer

TS O/S

DEAN FOREST.

Dated 9th February 1906.

New Forest

F 3556

Office of Woods, &c.
21st December 1905

File 41734

Madam,

New Forest. File 41734

Easements. - Slap Wood, Ringwood.

Easements

Hon. Mr. Arthur
ForbesPermission
to maintain a
gate near Slap
Wood.21st December
1905.

I am directed by Mr. Stafford Howard to acknowledge the receipt of your application of the 17th ult. for permission to maintain a gate in the fence of your property near Slap Wood, Burley, where it abuts on the brown waste with an approach thereto across the waste.

In reply I am directed by Mr. Stafford Howard to state that he is willing to give you permission during the pleasure of this Department to maintain a gate at the point A. on the enclosed tracing with an approach thereto across the waste of the Forest in the direction shown by red dotted lines on the said tracing upon the terms and conditions following viz:-

1. An acknowledgment of 15/- per annum is to be paid to the Deputy Surveyor in advance on the 5th April in each future year during the continuance of this permission the first payment in respect of the year to 5th April 1907 to be made before the 5th April 1906.
2. In the event of this permission being determined the gate is to be removed and the fence to be made good and surface of the soil is to be restored to its original condition to the satisfaction of the Deputy Surveyor.
3. The charge ^{would} ~~will~~ have to be reconsidered in the event of any further buildings being erected on the land served by the gate.

If this offer is accepted I am to request that you will remit the sum of 15/- to The Hon. G. W. Pascellos The Kings House, Lyndhurst in due course and return to this office the enclosed letter signed and dated.

I am &c.

(Sd) Chas. E. Howlett.

The Hon. Mr. Arthur Forbes

79

to
 ber 1905
 acknowledged
 for
 our
 the
 waste
 d to
 ring
 at at
 approach
 tion
 upon
 to be
 5th
 ce of
 he year
 1906.
 med
 made
 d to its
 duty
 he event
 land
 at you
 cellas
 return
 t.

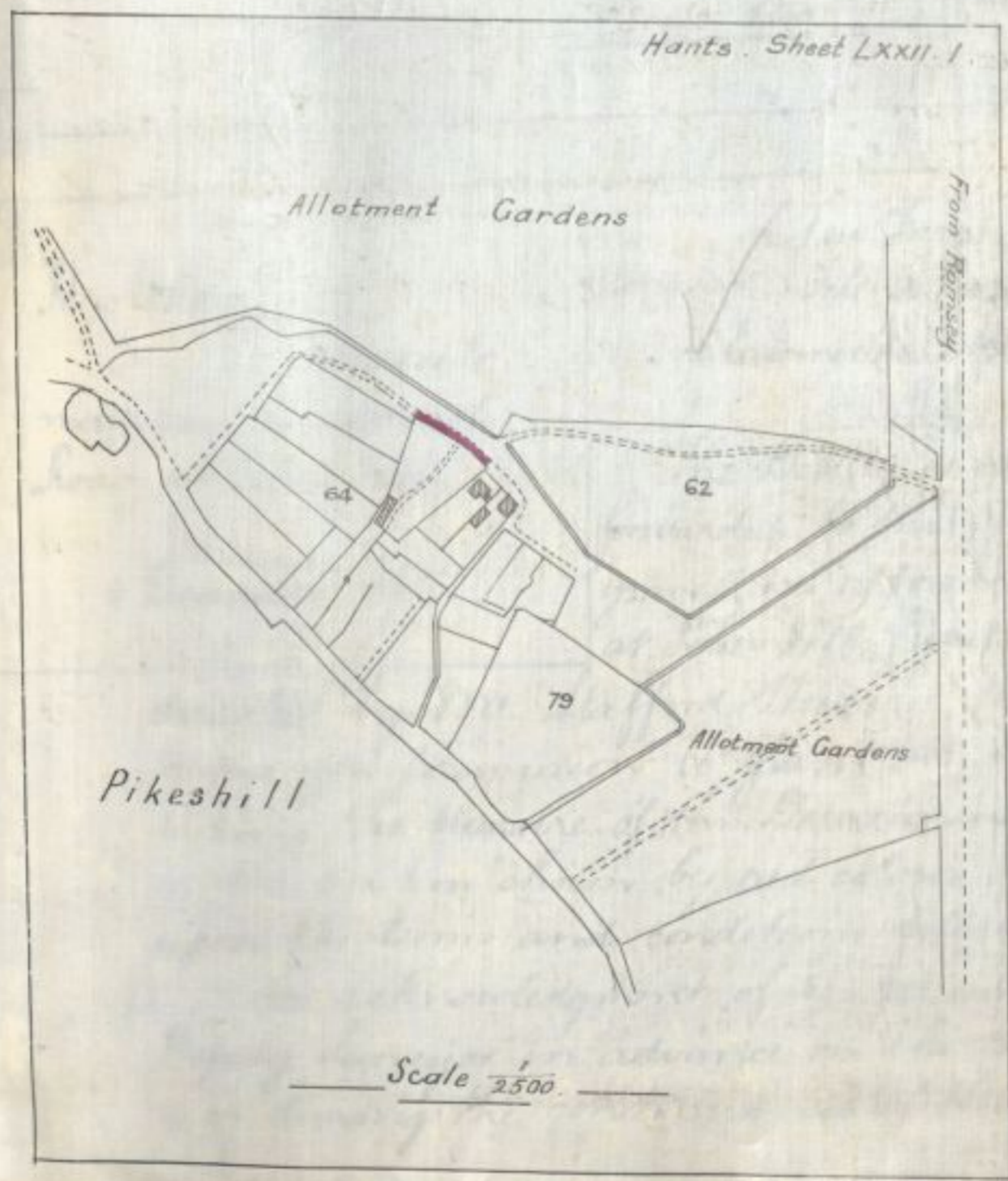
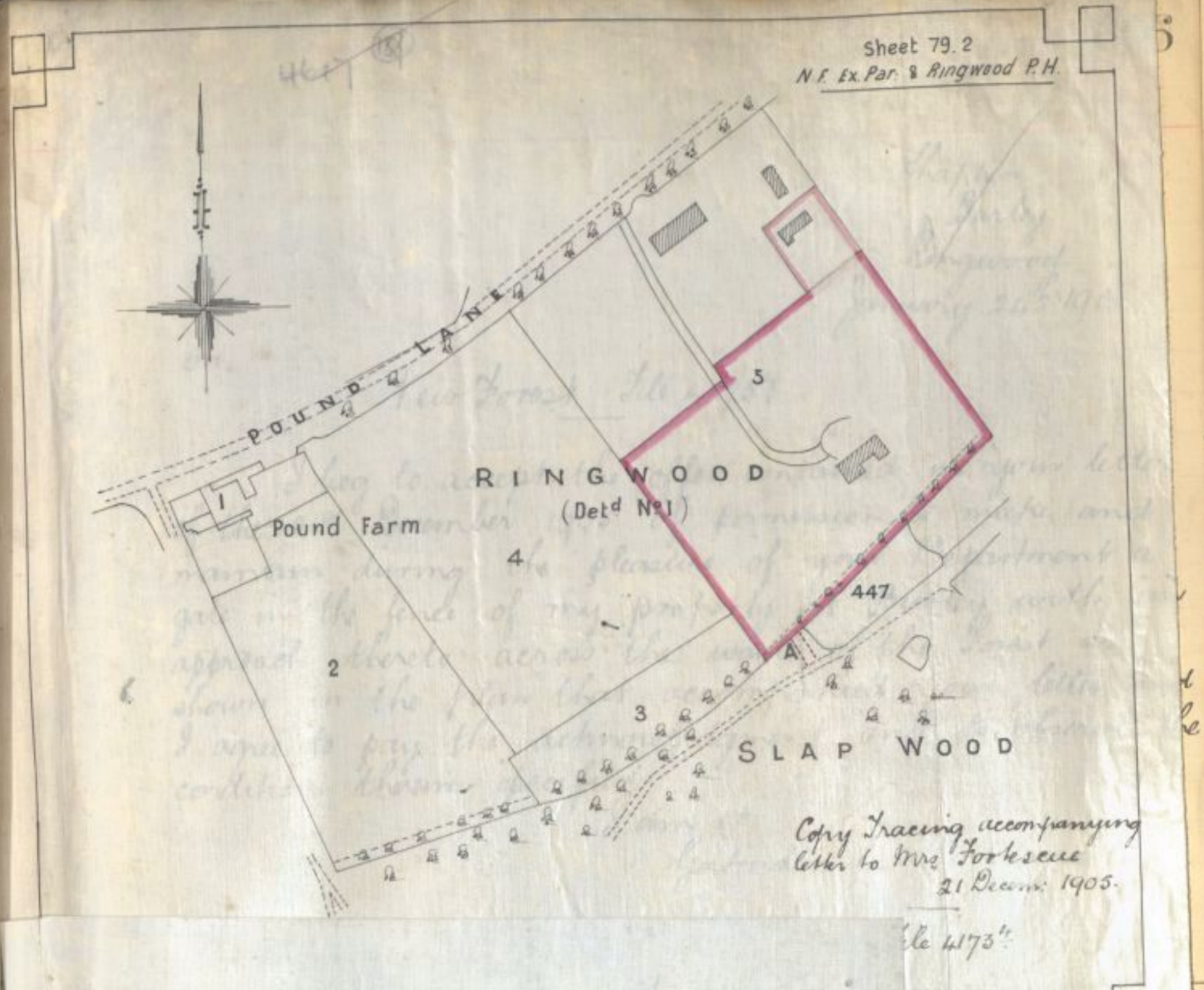

January, 1906.

h Road

of the New Forest has
 for permission
 your application, to
 ad to your property
 t. In reply I am
 te that he is willing
 each road and
 maintain the same
 e enclosed tracing
 viz:-
 is to be paid to the
 oter in each future
 mission, the first
 payment

642
 Latham
 TS O/S

ods. to
 mber 1905
 s acknowledg
 for
 your
 in the
 le waste
 and to
 rmg
 at
 approach
 tion
 upon
 to be

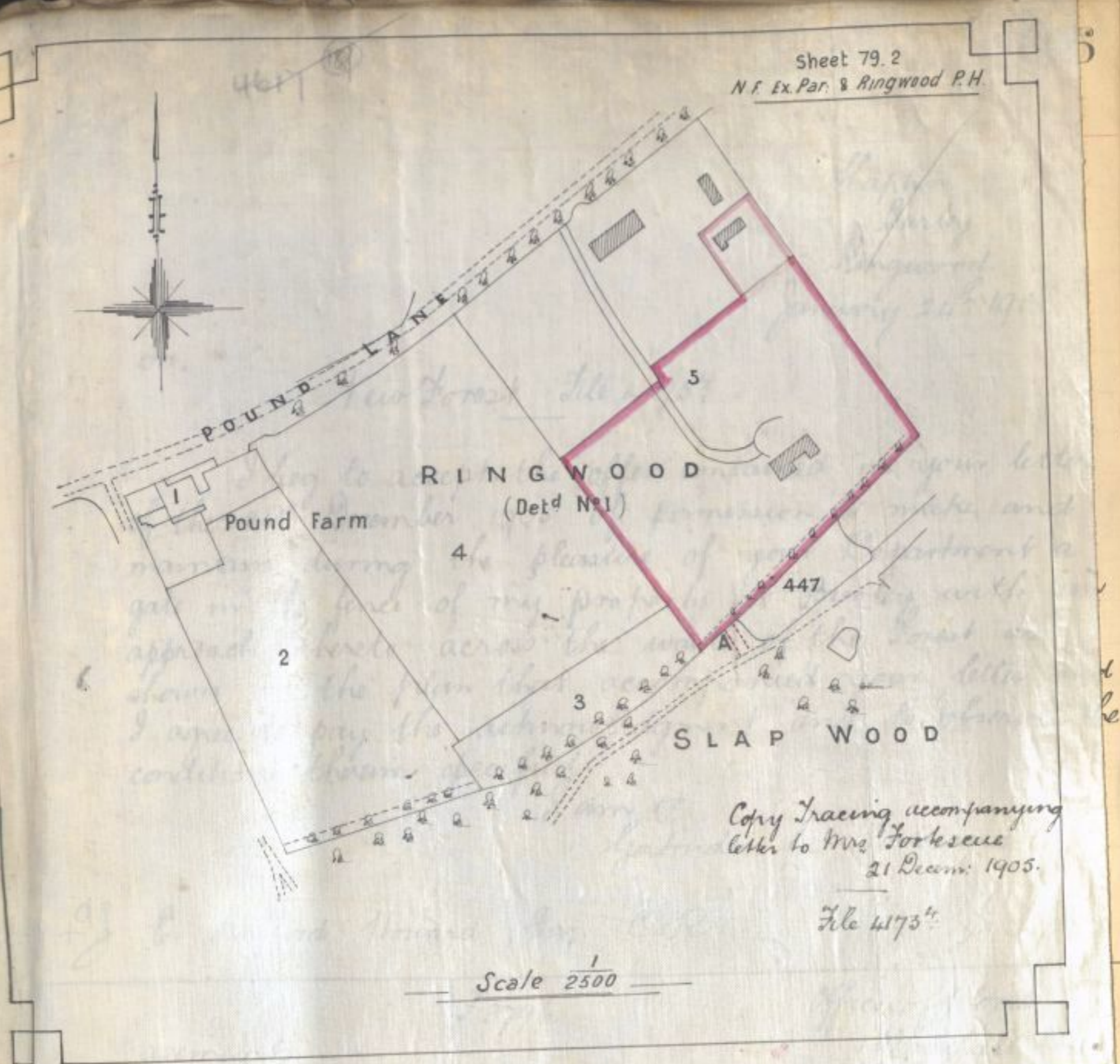

Copy Tracing accompanying
 letter to Mrs. Fortescue
 21 Decem. 1905.
 File 4373

Scale $\frac{1}{2500}$

H. Athey.
 Permission to
 maintain an approach
 Road at Likes Hill.
 6 January, 1906.

New Forest.
 File 4323
 easements. Approach Road
 Likes Hill.

The Deputy Surveyor of the New Forest has forwarded to this Office your application, to gravel an approach road to your property at Likes Hill, Lyndhurst. In reply I am

directed by Mr. Stafford Howard to state that he is willing to give you permission to gravel an approach road and during the pleasure of this Department to maintain the same in the position shown by red colour on the enclosed tracing upon the terms and conditions following, viz:-

In acknowledgment of 5/- per annum is to be paid to the Deputy Surveyor in advance on the 10th October in each future year during the continuance of this permission, the first payment

642
 L Athey
 TS O/S

Shapton.
Burley.
Ringwood.
January 24th 1906.

Sri.
New Forest. File 4173⁴

I beg to accept the offer contained in your letter of the 21st December 1905 of permission to make and maintain during the pleasure of your Department a gate in the fence of my property at Burley with an approach thereto across the waste of the Forest as shown on the plan that accompanied your letter and I agree to pay the acknowledgment and to observe the conditions therein specified.

I am re.

Gertrude L. Fortescue.

dg E. Stafford Howard, Esq. C.B.

Easements.
New Forest.

H. Athey.
Permission to
maintain an approach
Road at Likes Hill.

January
6 December, 1906.

F 3796.

Sri.

New Forest.
File 4323.

Easements. Approach Road
Likes Hill.

The Deputy Surveyor of the New Forest has forwarded to this Office your application, ^{for permission} to gravel an approach road to your property at Likes Hill, Lyndhurst. In reply I am

directed by Mr. Stafford Howard to state that he is willing to give you permission to gravel an approach road and during the pleasure of this Department to maintain the same in the position shown by red colour on the enclosed tracing upon the terms and conditions following, viz:-

An acknowledgment of 5/- per annum is to be paid to the Deputy Surveyor in advance on the 10th October in each future year during the continuance of this permission, the first payment

642
Latham
TS O/P

payment in respect of the year to 10th October 1906 to be made on the acceptance of this offer.

2. In the event of this permission being determined the gravel is to be removed and the surface of the soil is to be restored to its original condition to the satisfaction of the Deputy Surveyor.

If this offer is accepted I am to request that you will remit the sum of £7. to the Hon. G. W. Jaccelles, The King's Home, Lyndhurst, and return to this Office the enclosed letter signed and dated.

I am, &c.

(Sd) Chas. E. Howlett,

Henry Athey. Esq.

Rikes Hill,

Lyndhurst.

10th January 1906.

Sir,

New Forest.

File 4323.

I beg to accept the offer contained in your letter of the 6th January 1906 of permission to make and during the pleasure of your Department to maintain a gravelled approach to my property at Rikes Hill as shown on the plan that accompanied your letter and I agree to pay the acknowledgment and to observe the conditions therein specified.

I am, &c.

(Sd) H. Athey.

E. Stafford Howard. Esq. C.B.

X 99

L. 56.

Office of Woods.
1 Whitehall Place. Sts
16th January 1906.

Art.

Kear



this Office that you have
nor by the erection of a
shed on the side of the roadway leading from the Scowles to
Berry Hill in the position shown
by a red cross on the tracing and I am directed by
the Secretary to grant you
permission to use and maintain the shed during the pleasure
of the Steward upon the following terms and conditions:-

1. To be paid in advance on
the receipt of this permission and
to the 5th January 1907 to be
used for the purpose of
repair, to keep tidy the
shed and whenever this permission
is required, to remove it and restore
the ground to its original condition.

2. You will be good enough to
return the enclosed letter and pay

1/- to the Steward.
Jm. Edward Kear.

I am etc. (sd) Chas. E. Howlett.

The Scowles, Mr. Coleford. Glo.
18th January 1906.

Sir,

I beg to accept your offer dated 16th inst. for permission to
use and maintain a shed in the position shown by a red cross
on the tracing which accompanied the above mentioned
letter and I agree to pay the acknowledgment and to observe
the conditions therein specified.

I am etc.

(sd) Witness to the mark X of
Edward Kear

David Morgan, Coleford
Glos. (Accountant)

ds
E. Stafford Howard, Esq. CB

642
L. 56
TS 0/1

L. 56.

Office of Woods,
1 Whitehall Place, Sts
16th January 1906.

Sir,

Manor of Stannton.
File 1292.

The Steward has reported to this Office that you have encroached on the waste of this Manor by the erection of a shed on the side of the roadway leading from the Scowles to Highmeadow near to the Scowles Quarry in the position shown by a red cross on the enclosed tracing and I am directed by Mr. Stafford Howard to state that he is prepared to grant you permission to use and maintain the shed during the pleasure of this Department upon the following terms and conditions:-

1. An annual acknowledgment of 1/- is to be paid in advance on the 5th January during the continuance of this permission and the acknowledgment for the year to the 5th January 1907 to be paid on the acceptance of this offer.
2. You are to keep the shed in good repair, to keep tidy the ground adjacent to the shed and whenever this permission is terminated you are, if required, to remove it and restore the ground to the satisfaction of the Steward.

If you desire to accept these terms you will be good enough to date sign and return to this office the enclosed letter and pay 1/- to the Steward.

Yrs. Edward Hear.

I am &c. (sd) Chas. E. Howlett.

The Scowles, Mr. Coleford, Glo.
18th January 1906.

Sir,

I beg to accept your offer dated 16th inst. for permission to use and maintain a shed in the position shown by a red cross on the tracing which accompanied the above mentioned letter and I agree to pay the acknowledgment and to observe the conditions therein specified.

I am &c.

(sd) Witness to the mark X of
Edward Hear

David Morgan, Coleford
Glos. (Accountant)

29
E. Stafford Howard, Esq. CB

642

L. 56

TS 0/1

609

(copy)

DEAN FOREST.

Articles of Agreement made the
ninth day of *February* — One Thousand
 nine hundred and *six* — Between THE KING'S
 MOST EXCELLENT MAJESTY of the first part EDWARD
 STAFFORD HOWARD Esquire C.B. a Commissioner of His
 Majesty's Woods Forests and Land Revenues of the second part and
Mrs Emily Bram —
 (hereinafter called "the said Tenant") of the third part

THE said EDWARD STAFFORD HOWARD as such Commissioner
 as aforesaid on behalf of His Majesty hereby agrees to let to the said
 tenant who hereby agrees with His Majesty to take and rent as tenant
 to His Majesty ALL THAT *cottage and garden*
being No 8. of a row of cottages known
as Hawkwell cottages situate near
Winderford in the County of Gloucester
 containing about 21 perches and
 coloured red on the plan annexed hereto

_____ lately in the
 occupation of *Milson Jenkins* _____
 together with the fixtures therein TO HOLD the same hereditaments
 to the said tenant from the *5th* day of *January 1906*

W. A. T. S.

as tenant from year to year (the tenancy being however determinable as after mentioned) at the yearly rent of £4 ——— to be paid to *the Dep. Surveyor of Dean Forest* free from all taxes rates and deductions whatsoever (except Landlord's property tax) by equal Quarterly payments on the 5th ——— day of *January* the 5th ——— day of *April* ——— the 5th ——— day of *July* ——— and the *tenth* ——— day of *October* ——— in every year the first Quarterly payment to be due on the 5th ——— day of *April 1906* ——— AND the said tenant hereby agrees that he will pay to the King's Majesty the said yearly rent of £4. ——— on the days and in the manner aforesaid And will also pay the land tax sewer rates and all other rates taxes and assessments whatsoever (except the Landlord's property tax) now or hereafter to be imposed in respect of the said premises Together with a proportionate part thereof for the period which shall elapse between the Quarterly day of payment next preceding the expiration of the said tenancy and the day on which the same shall expire AND also will not do or suffer any damage to the said premises and will at all times well and properly manage and cultivate the said land and keep and leave the same clean and in good heart and condition and will also keep the windows and doors in good repair and the ceilings and interior walls properly cleaned and whitewashed and will on the determination of the tenancy hereby created deliver up the said premises in such repair and condition as aforesaid to the King's Majesty his heirs or successors or to the said EDWARD STAFFORD HOWARD or other the Commissioner or Commissioners for the time being of His Majesty's Woods Forests and Land Revenues having the management of the said premises (hereinafter called "the said Commissioner or Commissioners") or to whom he or they may appoint AND will permit

the said Commissioner or Commissioners or his or their agent at any time or times during the said tenancy to enter into and inspect the

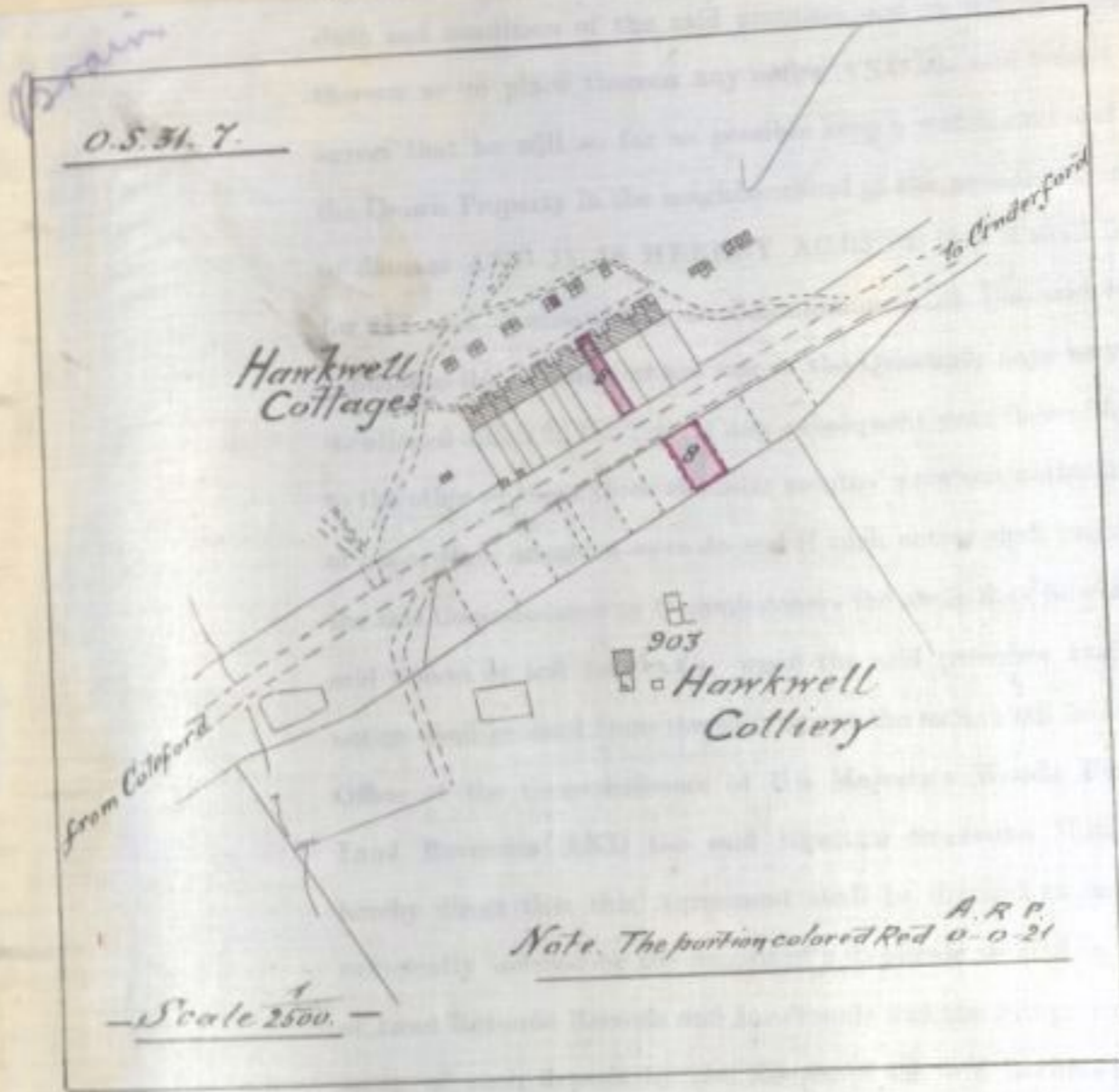

Note. The portion colored Red A.R.P. 0.021

Scale 1/2500

second and third parts have hereunto subscribed their names the day and year first above written.

Signed by the above-named
EDWARD STAFFORD HOWARD
in the presence of

(sgd) Chas. E. Howlett,
Office of Woods,
1 Whitehall Place,
London, S.W.

(Sd) E. Stafford Howard.

Signed by the above-named
Emily Brain
in the presence of

(sgd) Henry Smith,
Herbert Lodge,
Brown Keeper.

(Sd) E. Brain

642
L. Atkinson
TS 0/1

the said Commissioner or Commissioners or his or their agent at any time or times during the said tenancy to enter into and inspect the state and condition of the said premises and to execute any works thereon or to place thereon any notice AND the said tenant further agrees that he will so far as possible keep a watch over and protect the Crown Property in the neighbourhood of the premises from injury or damage AND IT IS HEREBY AGREED that it shall be lawful for the said Commissioner or Commissioners or the said tenant to determine this tenancy at any one of the Quarterly days hereinbefore mentioned either in the first or any subsequent year thereof by giving to the other of them three calendar months' previous notice in writing of his or their intention so to do and if such notice shall proceed from the said Commissioner or Commissioners the same may be given to the said tenant or left for *her* upon the said premises and if such notice shall proceed from the said tenant the same shall be left at the Office of the Commissioners of His Majesty's Woods Forests and Land Revenues AND the said EDWARD STAFFORD HOWARD doth hereby direct that this Agreement shall be deemed to be fully and sufficiently inrolled by the deposit of a duplicate thereof in the Office of Land Revenue Records and Inrolments and the filing or making an entry of such deposit by the Keeper of the said Records and Inrolments IN WITNESS whereof the said parties to these presents of the second and third parts have hereunto subscribed their names the day and year first above written.

Signed by the above-named
EDWARD STAFFORD HOWARD
in the presence of

(sgd) Chas. E. Howlett,
Office of Woods,
1, Whitehall Place,
London, S.W.

(sd) E. Stafford Howard.

Signed by the above-named
Emily Brain
in the presence of

(sgd) Henry Smith,
Herbert Lodge,
Crown Keeper.

(sd) E. Brain

will also keep the
s and interior walls
the determination of
mises in such repair
ajesty his heirs or
OWARD or other the
ing of His Majesty's
management of the
mmissioner or Com-
nt AND will permit

Lot
TS

DEAN FOREST.

Dated 9th February 1906.

EDWARD STAFFORD HOWARD, Esq., C.B.
a Commissioner of His Majesty's Woods,

&c.,

AND

Mr Emily Brown

AGREEMENT for letting

*No 8 Shawbush Hall, containing
21 parcels, Windsor, Gloucesters*

on a Yearly Tenancy from the
5th January 1906.

Rent £ 4 - 0 - 0. per Annum.

Inrolled

15th February, 1906.

610

612

DEAN FOREST.

Dated 9th February 1906.

EDWARD STAFFORD HOWARD, Esq., C.B.

642
Latham
TS O/P

Dec 1905/6

Alice Holt
Woods.

Copy
Certificate
of Redemption
of Tithe Rent
charge on
Goose Green
and Millers
Piece.

30th December
1905.

Extraordinary Tithe Acts 1886 and 1897.

Parish of Binsted. County of Southampton.

Certificate of Redemption.

Whereas under the Extraordinary Tithe Acts 1886 and 1897 the lands situate in the Parish of Binsted in the County of Southampton the particulars whereof are specified in the Schedule hereto are charged with the payment of an annual Rentcharge of Eight pounds seventeen shillings and seven pence in lieu of the Extraordinary charge on the said lands

And whereas it has been proved to the Board of Agriculture and Fisheries that the sum of Two hundred and twenty two pounds being the amount of the capital value of the said Extraordinary charge has been duly paid by the Commissioners of His Majesty's Woods Forests and Land Revenues in respect of the said Rentcharge.

Now therefore the Board of Agriculture and Fisheries pursuant to the powers vested in them by the Board of Agriculture Act 1889 and the Extraordinary Tithe Acts 1886 and 1897 Do hereby certify that the said Rentcharge is redeemed and that the lands described in the Schedule hereto are hereby absolutely freed and discharged from the said Rent charge from the date of the next half yearly payment.

In witness whereof the Board of Agriculture and Fisheries have hereunto set their official Seal this thirtieth day of December One thousand nine hundred and five.

(Sd) P. G. Craigie.

L. D. Assistant Secretary

The

The Schedule above referred to.

Extract from the Certificate of Capital Value or Instrument of altered apportionment.

Landowner.	Description of Farm or parcel of land.	Number on Map.	Area of Farm or Parcel. Acres.	Capital Value of the Charge.	Resulting Annual 4 percent Rentcharge.	Remarks.
Her Majesty the Queen	Mellers Piece. Goose Green.	16 16 ^a	2 ³ / ₄ 5 ¹ / ₄	£222	£8. 17. 7.	The Rentcharge is payable to the Incumbent of the Parish.

1881 G. W. Lloyd
Board of Agriculture & Fisheries
14th January 1906.

642
L. Atkinson
T. O. P.

1881

Dean Forest.

Easements.

D. Williams.

Permission
to use a piece
of land for
the purpose of
a "draw-up"
at Slmgj.

14th October.
1905.

F. 2884.

Sir,

Dean Forest.

File 947²

Easements.

The Deputy Surveyor of the Dean Forest has forwarded to this Office your application for permission to use a piece of brown land as a "draw-up" to your premises at Slmgj near Coleford.

In reply I am directed by Mr. Stafford Howard to state that he is willing to give you permission during the pleasure of this Department to use the piece of brown land lying between the field No. 1200 and the main road leading from Coleford to Lydney and to gravel or cinder the same in the position shown by red colour on the enclosed tracing upon the terms and conditions following, viz.

1. An acknowledgment of 5/- per annum is to be paid to the Deputy Surveyor in advance on the 5th April in each future year during the continuance of this permission the first payment in respect of the year to the 5th April 1906 to be made on the acceptance of this offer.
2. In the event of this permission being determined the gravel cinders or other material would require to be removed and the surface of the soil to be restored to its original condition to the satisfaction of the Deputy Surveyor.

If this offer is accepted I am to request that you will remit the sum of 5/- to Philip Baylis Esq. Whitmead Park, Coleford and return to this office the enclosed letter signed and dated.

I am, &c.

(Sd) Chas. E. Howlett.

Mr. D. Williams.

F. 277.

Sir,

Dean Forest.

With reference to your letter of the 13th inst

Office of Woods &c.

29th January 1906.

I am directed by Mr. Stafford Howard to state that he is informed by the Deputy Surveyor that you are prepared to pay the sum of 1/- per annum for the permission to use a piece of brown land at Slmg as a "draw-up"

Under the circumstances stated in that letter Mr. Howard is prepared to accept the reduced acknowledgment of 1/- in respect of the easement in question, and I am to request that you will pay at once the acknowledgment of 1/- to Mr. Baylis for the year to 5th April next and then add to the last line of the letter enclosed in the one from this office of the 14th October the following words "of date sign and return it to this office."

I am, &c.

(Sd.) Chas. E. Howlett,

Slmg.
H. Soleford.

5th February 1906.

D. Williams:

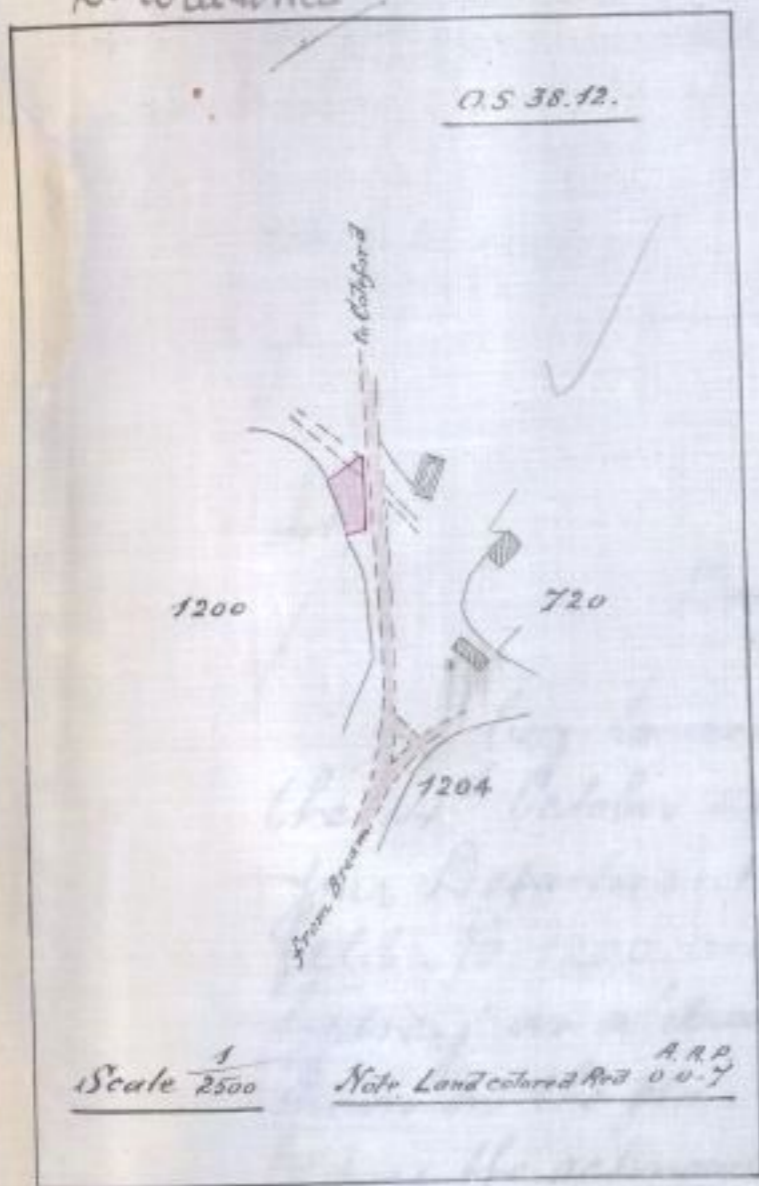

Forest.

947?

at the offer contained in your letter of permission to use during the pleasure of a piece of brown land lying between the main road leading from Coleford to "up" and to cinder or gravel the same as that accompanied your letter and I agree to pay the sum of 1/- per annum and to observe the conditions therein specified.

I am, &c.

(Sd.) D. Williams.

C. Stafford Howard, by C.B.

7/2

642
L. Williams
TS O/P

I am directed by Mr. Stafford Howard to state that he is informed by the Deputy Surveyor that you are prepared to pay ~~the sum of~~ 1/- per annum for the permission to use a piece of brown land at Slmg as a "draw-up"

Under the circumstances stated in that letter Mr. Howard is prepared to accept the reduced acknowledgment of 1/- in respect of the easement in question, and I am to request that you will pay at once the acknowledgment of 1/- to Mr. Baylis for the year to 5th April next and then add to the last line of the letter enclosed in the one from this office of the 14th October last after the word "acknowledgment" the following words "of 1/- per annum" and date sign and return it to this office.

I am, &c.
Wm. Chas. E. Howlett,

Mr. D. Williams.

F.

Slmg.
W. Coleford.
5th February 1906.

Sir,

Dean Forest.
File 947?

I beg to accept the offer contained in your letter of the 14th October 1905 of permission to use during the pleasure of your Department a piece of brown land lying between the field No. 1200 and the main road leading from Coleford to Lydney as a "draw-up" and to cinder or gravel the same as shown on the plan that accompanied your letter and I agree to pay the acknowledgment of 1/- per annum and to observe the conditions therein specified.

I am, &c.
Wm. D. Williams.

E. Stafford Howard. Esq. CB.

Wm.

Foods, &c.
ber. 1905.

forwarded to
a piece of
uses at Slmg

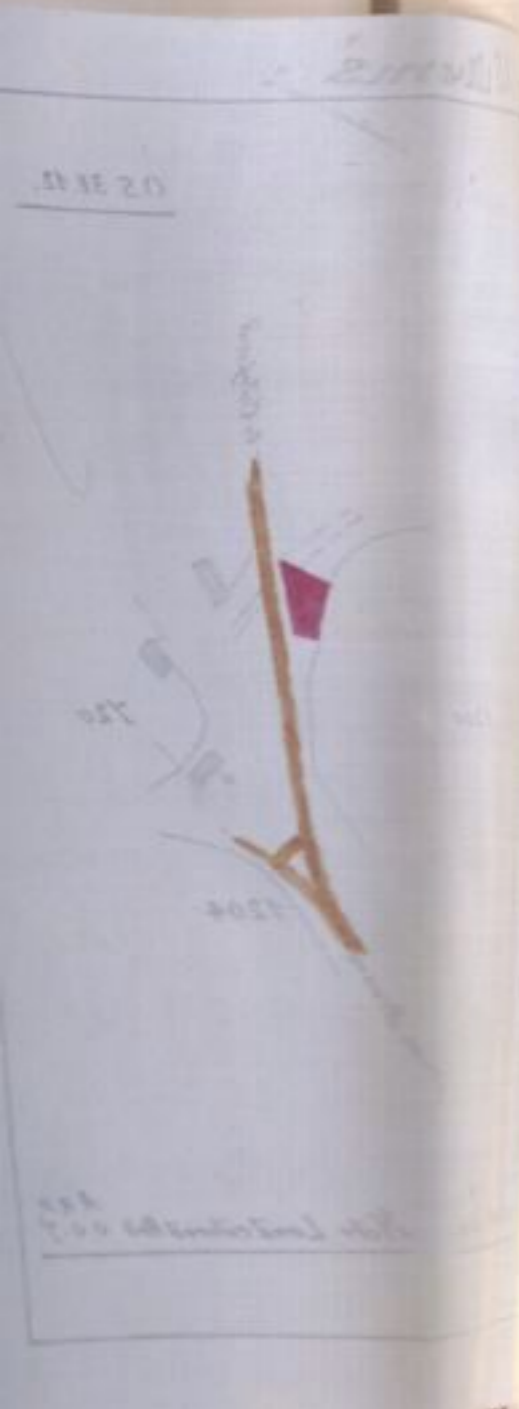

ressed letter

Att.

ds to
uary 1906.

13th mist
&

late
to

615

(copy)

TINTERN ESTATE.

February Agreement made the *16th* day of
 One thousand nine hundred and *six*
 Between the KING'S MOST EXCELLENT MAJESTY
 of the first part EDWARD STAFFORD HOWARD Esquire C.B. a
 Commissioner of Woods (hereinafter called the said Commissioner
 which term shall also include the Commissioner of Woods for the
 time being) of the second part and *Philip Lurcher*
of Barbadoes Green, Tintern, Labaner
 (hereinafter called "the Tenant") of the third part

WHEREBY the said Commissioner agrees to let to the Tenant
 who agrees to take as tenant of His Majesty ALL THAT *cottages*
. pasture pasture orchard and land, being
. Ordnance numbers 102, Pt ¹⁰³ ~~105~~ 105 pt
. 158, 159, 160 and 161, situate in the Parish
. of Tintern and containing 4a 3r 3q b.

Together with the appurtenances which premises are coloured red on
 the plan annexed hereto Except and reserving to His Majesty
 all rights of sporting and all timber and other trees and all mines
 and minerals with free access to cut work and carry away the same
 TO HOLD the said premises to the Tenant from the *29th*
 day of *September 1905* as Tenant from year to year (determinable
 as hereinafter mentioned) at the yearly rent of *£ 8-0-0*

to be paid to the Crown
 Receiver for Tintern free from all deductions whatsoever (except
 Landlord's property tax and Tithe Rent charge) by equal half yearly
 payments on the *25th* day of *March* and the *29th*
 day of *September* in every year the first half yearly
 payment to be due on the *25th* day of *March*
 1906 And the last payment to be made in advance one Calendar
 month before the expiration of the tenancy AND the Tenant hereby
 agrees with the King's Majesty His Heirs and Successors

1. To pay to the King's Majesty the said yearly rent of
Eight Pounds on the days and in the manner
 aforesaid.

642
 Latham
 TS O/P

2. To pay the land tax sewer rates and all other rates taxes assessments and outgoings whatsoever (except as aforesaid) now or hereafter to be imposed in respect of the said premises Together with a proportionate part thereof for the period which shall elapse between the half yearly day of payment next preceding the expiration of the said tenancy and the day on which the same shall expire.

3. To keep the gates fences ditches and drains on the said premises in good repair and condition and not to do or suffer to be done any waste or damage to the said premises and at all times well and properly to manage and cultivate the said land and keep and leave the same clean and in good heart and condition and also to keep the inside of the said premises in good repair and condition and the windows properly glazed and mended and on the determination of the tenancy hereby created to deliver up the said premises in such good repair and condition as aforesaid to the said Commissioner.

4. Not to assign underlet or part with the possession of the said premises or any part thereof without the previous consent in writing of the said Commissioner.

5. To permit the said Commissioner or his Agent at any time or times during the said tenancy to enter into and inspect the state and condition of the said premises and to execute any works thereon or to place thereon any notice.

6. And it is hereby further agreed that six months' notice to quit ^{sent} ~~received~~ on or before the 25th day of March to terminate on the 29th day of September in any year may be given by the said Commissioner or by the Tenant and if such notice shall proceed from the said Commissioner the same may be given to or left for the Tenant on the said premises or sent to him by registered post and if such notice shall proceed from the Tenant the same shall be sent by registered post to or left either at the Office in London or at the Local Office of the said Commissioner.

7. And it is hereby further agreed that the said Commissioner shall have a right of re-entry on non-payment of the rent for 21 days whether legally demanded or not or on breach or non-observance of any of the Tenant's agreements.

AND the said Commissioner doth hereby direct that this Agreement shall be deemed to be fully and sufficiently inrolled by the deposit of a duplicate thereof in the Office of Land Revenue Records and Inrolments and the filing or making an entry of such deposit by the Keeper of the said Records and Inrolments IN WITNESS whereof the said parties to these presents of the second and third parts have

subscribed their names the day and year first above written.

*Mon: XXI. 13.
1901 Edition.*

Note, Nos in green 1881 Edition.

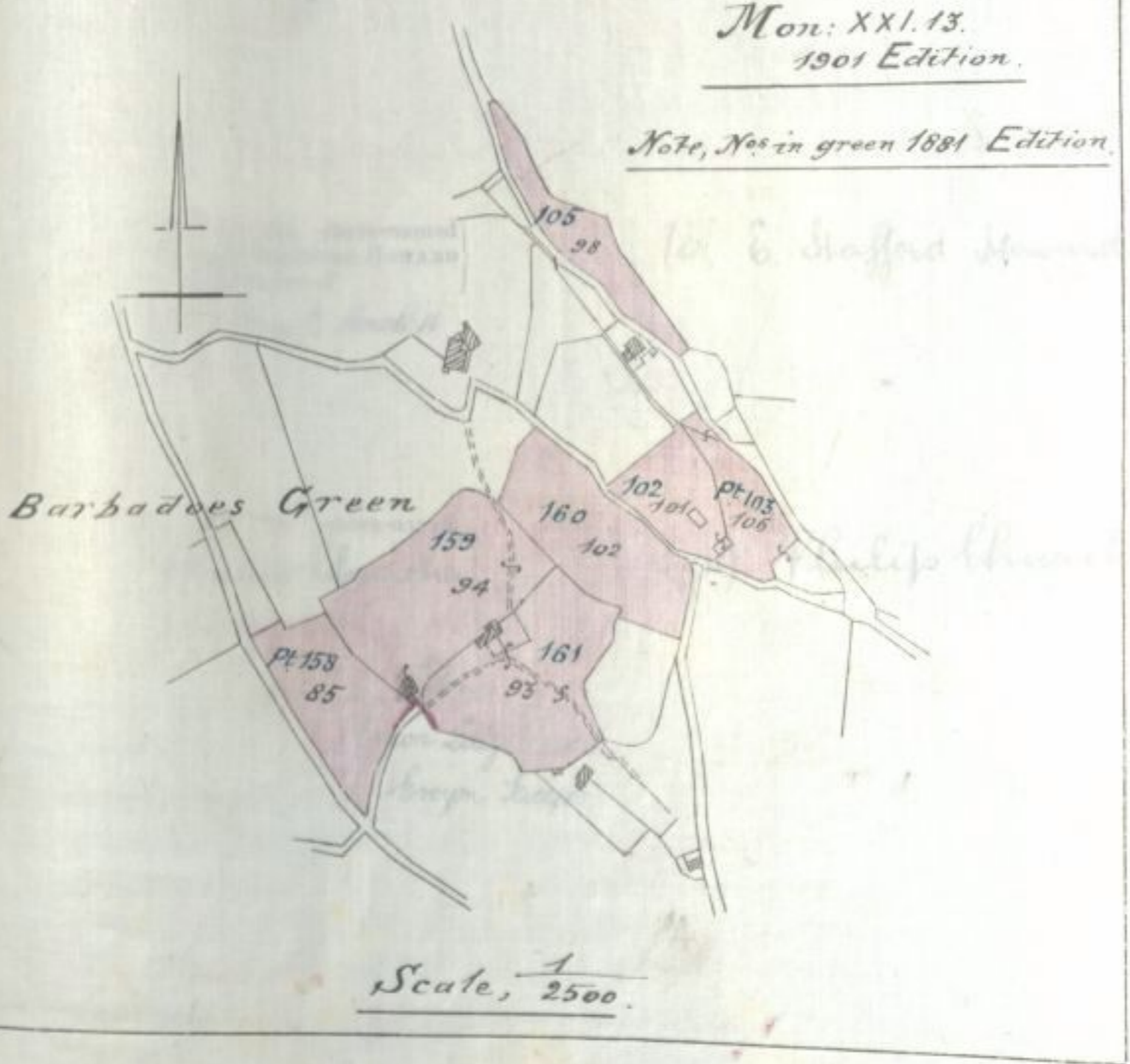

*Inrolled
21st February, 1906*

*Lot
TS*

AND the said Commissioner doth hereby direct that this Agreement shall be deemed to be fully and sufficiently inrolled by the deposit of a duplicate thereof in the Office of Land Revenue Records and Inrolments and the filing or making an entry of such deposit by the Keeper of the said Records and Inrolments IN WITNESS whereof the said parties to these presents of the second and third parts have hereunto subscribed their names the day and year first above written.

Signed by the above-named
EDWARD STAFFORD HOWARD
in the presence of
(sgd) Chas. E. Howlett

(sd) E. Stafford Howard

Signed by the above-named
Philip Churcher
in the presence of

(sd) Philip Churcher

*(sgd) John Roberts
Brown Lodge, Interm.
Brown Tcepter.*

*Inrolled
21st February, 1906*

*616
TS*

WESTERN ESTATE
Dated 16th February 1906.

E. STAFFORD HOWARD, Esq., C.B.,
a Commissioner of His Majesty's Woods,

&c.,
AND

Philip Churcher,

AGREEMENT for letting *Cottage*
& Land

on a Yearly Tenancy from the

Rent £ 0 - 0
per Annum.

W B & L (S) - 34129 - 350-5-5



TINTERN ESTATE.

Dated 16th February 1906.

E. STAFFORD HOWARD, Esq., C.B.,
a Commissioner of His Majesty's Woods,

&c.,

AND

Lot
TS