

this cond
shall be in
shall not
on the
enter into
of the prem
effectually
had not b

13. Provided
may be de
the sever
giving six m
purpose such
of the commu
the expuratio
cease and d
rights or reme
of covenant p

14. Provided
and agreed
the Kings Ho
or so long as
is vested in
or other the pe
entitled by la
thereof and
the fees and
the leasehold
enjoyed observe
in whom such
vested.

15. And the ad
direct that this
sufficiently en
thereof in the b
Involments an
such deposit b
Involments

New ForestCopy.

Articles of Agreement made the
 28th day of May ——— One thousand
 and three ——— Between the ~~QUEEN'S~~ ^{Kings}
 nine hundred ———
 MOST EXCELLENT MAJESTY of the first part EDWARD
 STAFFORD HOWARD Esquire C.B. a Commissioner of Her
 Majesty's Woods Forests and Land Revenues of the second part and
 Mrs. Mary A. Pingo, widow. ———

(hereinafter called "the said Tenant") of the third part ———

THE said EDWARD STAFFORD HOWARD as such Commissioner
 as aforesaid on behalf of Her Majesty hereby agrees to let to the said
 tenant who hereby agrees with Her Majesty to take and rent as tenant
 to Her Majesty ALL ~~THAT~~ those two pieces or
 parcels of land situate at Syndhurst
 in the County of Hants known as
 Cranmoor and Cranmoor Ham
 containing together about 6a 3r. 32h.
 and shewn by pink colour on the
 enclosed tracing ———

————— lately in the
 occupation of the said tenant ———
 together with the fixtures therein TO HOLD the same hereditaments
 to the said tenant ———

Inrolled 2 June 1903

from the 25th day of March 1903
 as tenant from year to year (the tenancy being however determinable
 as after mentioned) at the yearly rent of £26
 to be paid to the Deputy Surveyor of the New Forest
 free from all taxes rates and deductions whatsoever (except Landlord's
 property tax) by equal Quarterly payments on the 26th
 day of June the 29th day of
 September the 25th day of December
 and the 25th day of March in every year
 the first Quarterly payment to be due on the 26th
 day of June 1903 AND the said tenant
 hereby agrees that he will pay to the King's Majesty the said yearly
 rent of Twenty seven pounds 10/6 on the days
 and in the manner aforesaid And will also pay the land tax sewer
 rates and all other rates taxes and assessments whatsoever
 (except the Landlord's property tax) now or hereafter to be imposed
 in respect of the said premises Together with a proportionate part
 thereof for the period which shall elapse between the Quarterly day
 of payment next preceding the expiration of the said tenancy and the
 day on which the same shall expire AND also will keep the said
 premises and any fences and gates thereon in good repair and
 condition and will not do or suffer any waste or damage to the said
 premises and will at all times well and properly manage and
 cultivate the said land and keep and leave the same clean and in good
 heart and condition and will also keep the windows properly glazed
 and mended and will on the determination of the tenancy hereby
 created deliver up the said premises in good repair and condition to
 the King's Majesty his heirs or successors or to the said EDWARD
 STAFFORD HOWARD or other the Commissioner or Commissioners for
 the time being of His Majesty's Woods Forests and Land Revenues
 having the Management of the said premises (hereinafter called "the
 said Commissioner or Commissioners") or to whom he or they may

memo
 signed to the
 attestation of
 £27.10.0
 W.M.A. Pink

Mrs Pink



Witnessed by the above
 in the presence of
 Mr Chas & Ho
 Office of
 10/11
 Lond

Signed by the above-
 Mary A. Pink
 in the presence of
 Arthur S. G.
 Syddhur
 Clerk, the

Sheet 72.2.P^h of Lyndhurst

Mrs Pink

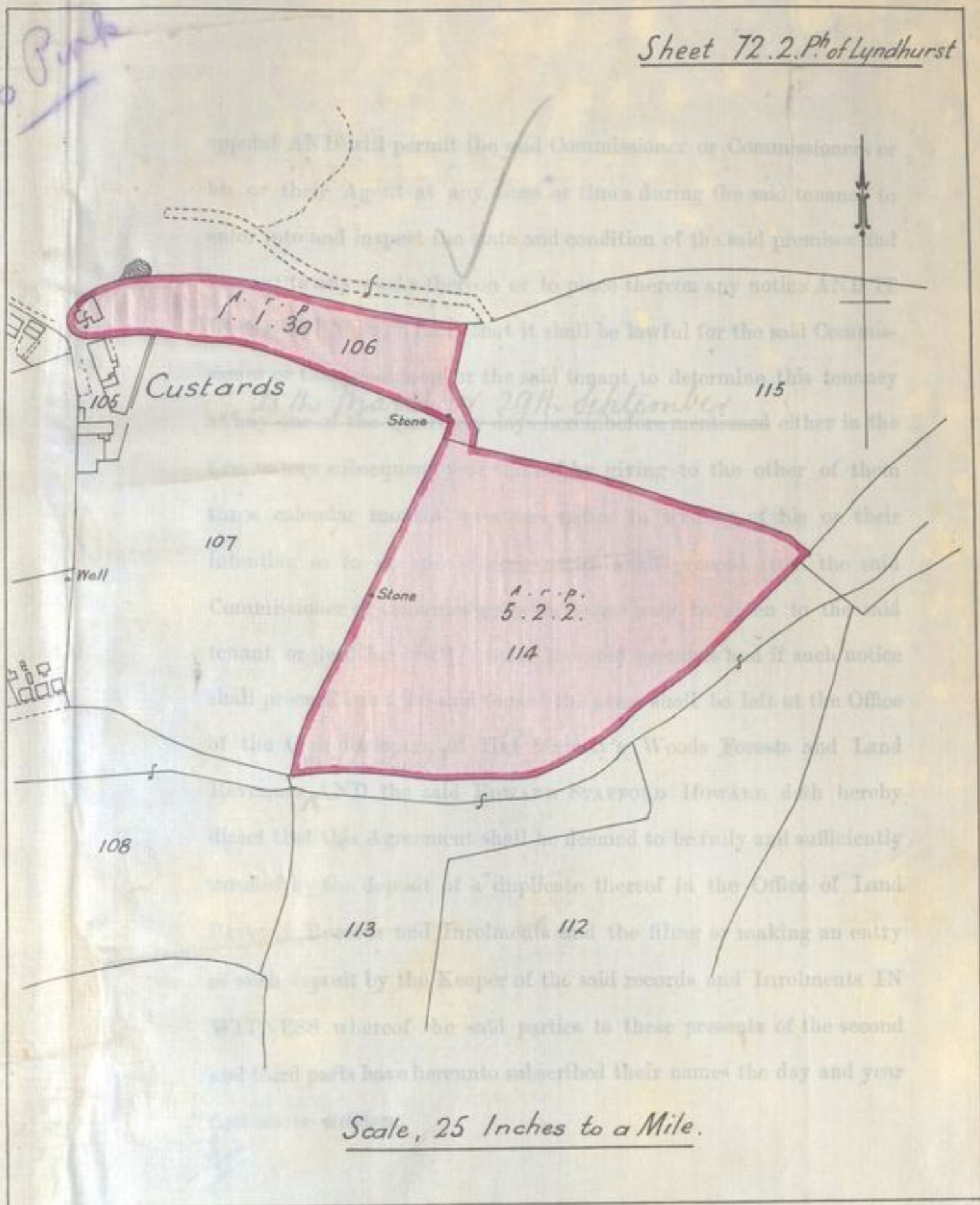

Scale, 25 Inches to a Mile.

Signed by the above-named
 EDWARD STAFFORD HOWARD
 in the presence of
 (Sd) Chas & Howlett
 Office of Woods
 110 Whitehall Place
 London S.W.

(Sd) E. Stafford Howard

Signed by the above-named
 Mary A. Pink
 in the presence of
 Arthur S. Grace
 Lyndhurst
 Clerk, The Kings House

(Sd) Mary A. Pink

appoint AND will permit the said Commissioner or Commissioners or his or their Agent at any time or times during the said tenancy to enter into and inspect the state and condition of the said premises and to execute any works thereon or to place thereon any notice AND IT IS HEREBY AGREED that it shall be lawful for the said Commissioner or Commissioners or the said tenant to determine this tenancy at any one of the Quarterly days herebefore mentioned either in the first or any subsequent year thereof by giving to the other of them three calendar months' previous notice in writing of his or their intention so to do and if such notice shall proceed from the said Commissioner or Commissioners the same may be given to the said tenant or left for *her* upon the said premises and if such notice shall proceed from the said tenant the same shall be left at the Office of the Commissioners of His Majesty's Woods Forests and Land Revenues ^(see back) AND the said EDWARD STAFFORD HOWARD doth hereby direct that this Agreement shall be deemed to be fully and sufficiently inrolled by the deposit of a duplicate thereof in the Office of Land Revenue Records and Inrolments and the filing or making an entry of such deposit by the Keeper of the said records and Inrolments IN WITNESS whereof the said parties to these presents of the second and third parts have hereunto subscribed their names the day and year first above written.

[Handwritten signature]

by the above-named EDWARD STAFFORD HOWARD in the presence of

*(sd) Chas E Howlett
Office of Woods
110 Whitehall Place
London S.W.*

(sd) E. Stafford Howard

Signed by the above-named

Mary A. Pink

(sd) Mary A. Pink

in the presence of

*Arthur G. Grace
Lyndhurst
Clerk, The Kings House*



6.7

Perma

W B & L (s) - 25534 - 1.0.7.1000

Rent £ _____ per Annum.

on a Yearly Tenancy from the

AGREEMENT for letting

AND
&c.,EDWARD STAFFORD HOWARD, Esq., C.B.
a Commissioner of Her Majesty's Woods,

Dated

190

And it is hereby also agreed that the tenancy may be determined by the said Commissioner or Commissioners at any time of the year as to any land that may be required for the Lyndhurst Light Railway and Electric Lighting Company by giving one month's previous notice as aforesaid but in that case a proportionate abatement shall be made from the rent and compensation paid for all damage to a growing crop, the amount of such abatement and compensation to be settled in cases of dispute by the Deputy Surveyor of the New Forest.

To all t

STAFFORD HOW

charge of the Land

on behalf of the Kin

WHEREAS the w

particularly describ

His Majesty in righ

in the Paris

at the Cot rent of

said EDWARD STAF

bath contracted wit

for the sale to *her*

NOW KNOW YE

by the said *Ja*

paid to the said E

aforesaid before th

the said EDWARD

said EDWARD STAF

the powers of th

presents grant and

Sintern Estate.

Copy *John 03-04*
No 11

To all to whom these presents shall come EDWARD STAFFORD HOWARD Esquire C.B. the Commissioner of Woods in charge of the Land Revenues of the Crown in the County of Monmouth on behalf of the King's Most Excellent Majesty SENDETH GREETING

WHEREAS the *messuage* lands and hereditaments hereinafter more particularly described and intended to be hereby conveyed are held of His Majesty in right of His Crown by *Jane Suff of the Whitelye in the Parish of Trellech in the County of Monmouth widow* at the Cot rent of £ / .. 0 : 0 per annum AND WHEREAS the said EDWARD STAFFORD HOWARD as such Commissioner as aforesaid hath contracted with the said *Jane Suff* _____ for the sale to *her* of the said premises for the sum of £ 100 : 0 : 0

NOW KNOW YE that in consideration of the sum of £ 100 : 0 : 0 by the said *Jane Suff* _____ paid to the said EDWARD STAFFORD HOWARD as such Commissioner as aforesaid before the execution of these presents (the receipt whereof the said EDWARD STAFFORD HOWARD doth hereby acknowledge) the said EDWARD STAFFORD HOWARD on behalf of His Majesty and under the powers of the Crown Lands Acts 1829 to 1894 doth by these presents grant and convey unto the said *Jane Suff* _____ and *her* heirs All that piece or parcel of

6. 2

Parra

*y
er
to*

vious

*or
unt
be*

land *and premises* — containing *8a. 3r. 38p.* or
 thereabouts situate at *the Whitelye* in the County of Monmouth
aforsaid —
 together with the messuage erected thereon which said land and
 premises are delineated and coloured red on the plan to these
 presents save and except out of this Grant all mines minerals stone
 and other substrata whether of a metallic or of any other nature within
 under or upon the said land and premises with full power from time to
 time and at all times for ever hereafter to enter upon search for work
 use raise carry away and enjoy the same as fully and effectually to all
 intents and purposes as if this Grant had not been made AND ALSO
 save and except full power from time to time and at all times hereafter
 to search for work dress use raise carry away and enjoy any other mines
 minerals stone or substrata belonging to His Majesty and lying beyond
 the limits of the land and premises hereby granted through or over the
 same as fully and effectually to all intents and purposes as if this Grant
 had not been made AND ALSO save and except out of this Grant (but
 subject to the provisions of the Ground Game Act 1880) all Game Wild
 Fowl Rabbits and Fish with the exclusive right for His Majesty His
 Heirs Successors and Assigns and all persons authorised by him or them
 at all times to preserve the same and of hunting shooting fishing coursing
 and sporting over and on the said land and premises TO HOLD the said
 premises unto and to the use of the said *Jane Luff* —

W B & L (S) 3084-100 2/1000

*in
cess
ly*

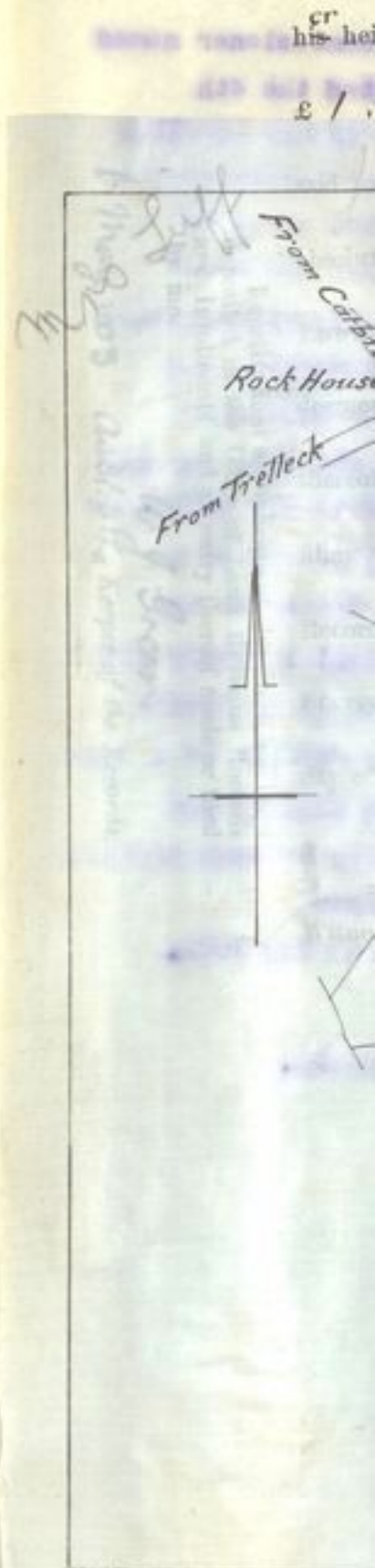

his heirs and assigns for ever and to the intent that the said rent of
£ 1 : 0 : 0 shall cease and be extinguished and that the

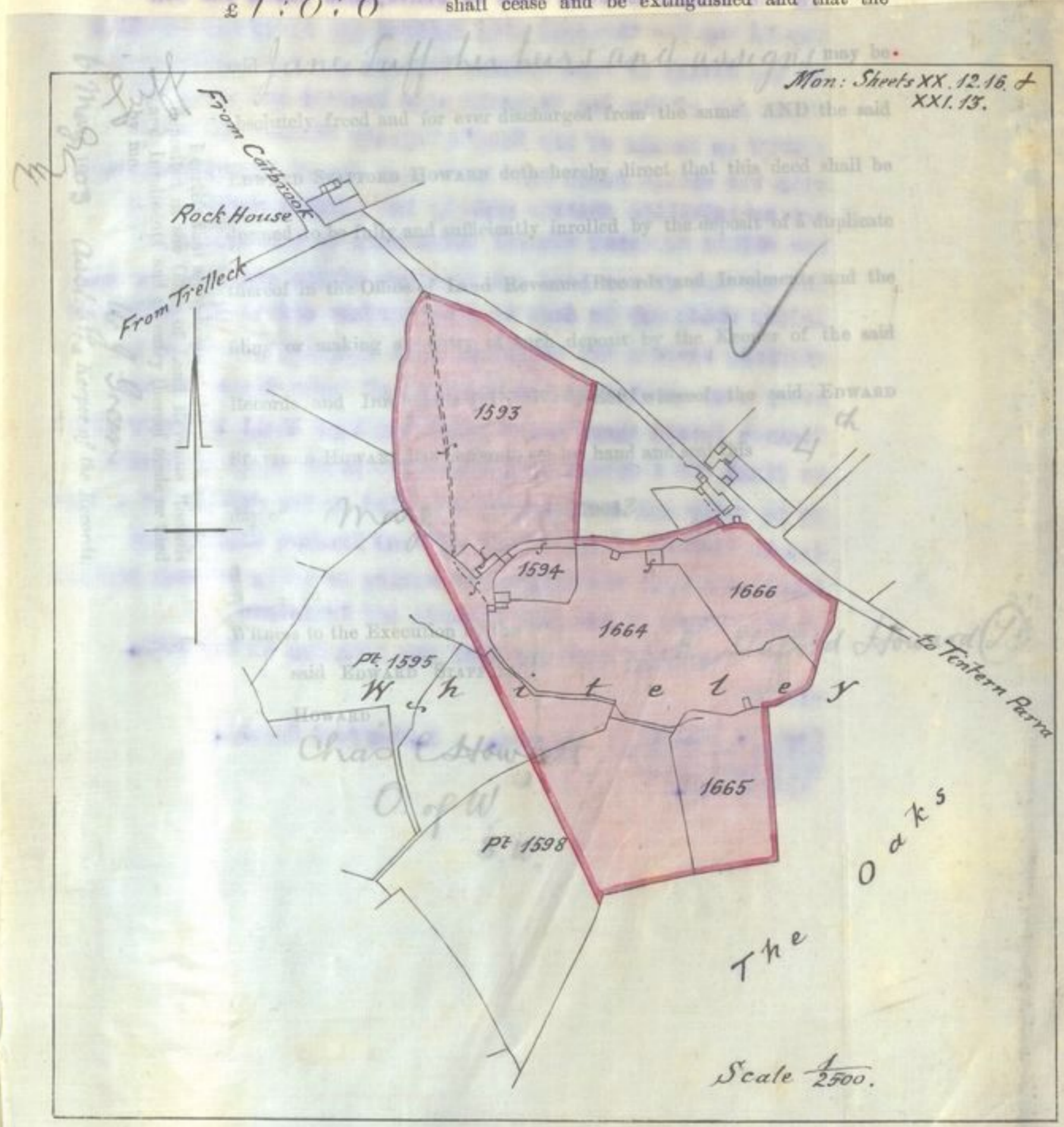

Mon: Sheets XX. 12. 16. & XXI. 13.

Handwritten notes:
From Cathecock
From Trelleck
Whitley
The Oaks

...entirely freed and for ever discharged from the same. AND the said
...HOWARD doth hereby direct that this deed shall be
...and sufficiently inrolled by the deposit of a duplicate
...in the Office of the Revenue, Boards and Inland Revenue and the
...deposit by the Agent of the said
...the said EDWARD
...4 ch
...Pt 1595
...Pt 1598
...Scale 1/2500.

his heirs and assigns for ever and to the intent that the said rent of

£ 1 : 0 : 0 shall cease and be extinguished and that the

said *Jane Luff* her heirs and assigns may be absolutely freed and for ever discharged from the same AND the said

EDWARD STAFFORD HOWARD doth hereby direct that this deed shall be deemed to be fully and sufficiently inrolled by the deposit of a duplicate thereof in the Office of Land Revenue Records and Inrolments and the filing or making an entry of such deposit by the Keeper of the said Records and Inrolments IN WITNESS whereof the said EDWARD STAFFORD HOWARD has hereunto set his hand and seal this

day of *May* 19013

Witness to the Execution by the said EDWARD STAFFORD

HOWARD

Chas E Stowlett

*O. of W.
S. W.*

E. Stafford Howard (L.S.)

I certify that a duplicate of this Deed has been deposited in the Office of Land Revenue Records and Inrolments and an entry thereof made or filed by me.

W. J. Green
6 May 1903
Asst. to the Keeper of the Records.

Inrolled 2nd June 1903.

TINTERN ESTATE.

MEMORANDUM. I EDWARD STAFFORD HOWARD the Commissioner named in the within written Deed of conveyance dated the 4th day of May One thousand nine hundred and three and inrolled in the Office of Land Revenue Records and Inrolments on the Sixth day of May One thousand nine hundred and three DO HEREBY on behalf of the King's Majesty DECLARE AND AGREE with the within named JANE LUFF that reasonable compensation and satisfaction shall be made by the persons working the the within expected mineral substances to the Owners of the surface of the land and premises within conveyed for any injury which may be done to such surface and to any buildings standing thereon the amount of such compensation to be in every case settled by the Receiver of Crown Rents for the Tintern Estate whose award under his hand shall in every case be final AND I direct that this Memorandum shall be deemed to be fully and sufficiently enrolled by the deposit of a duplicate thereof in the Office of Land Revenue Records and Inrolments and the filing and making an entry of such deposit by the Keeper of the said Records and Inrolments

AS witness my hand and seal the 29th day of May 1903.

WITNESS.

Chas E. Howlett
Office of Woods,
Whitehall Place
London S.W.

Signed. E. Stafford Howard.

LP

*in
cc
ly
in*

ner named
th
nrolled
s on the
DO
AGREE
ensation
the
of
for any
buildings
be in
r the
very case
deemed
of a dup-
and
sh deposit
903.

LP

129

*in
ce
ly*

ned
ore
Edw
1 in
Che



E. R.

FISHERY

By EDWARD STAFFORD HOWARD, Esquire, C.B., a Commissioner
of His Majesty's Woods, Forests and Land Revenues.

I, Edward Stafford Howard, a Commissioner of His Majesty's Woods, Forests and Land Revenues, do hereby, in consideration of the payment of £5.0.0. grant to Mr. H.C. Baumgarte of the Royal Hotel, Symond's Yat, or any person staying at the said Hotel and authorised by him in writing the exclusive license to fish for Salmon and all other fish with rod and line in so much of the south or left half of the River Eye as lies between Potter's Orchard and the County Bounday Stone, subject to the Rules and Regulations printed at the back hereof: Provided that this license shall only be used by one person at a time and so far as it relates to salmon fishing shall endure only from the 2nd February to the 15th October 1903, both days inclusive, and as regards trout fishing from the 2nd March to the 1st September 1903, both days inclusive, and as regards other fish for such period as they may legally be taken. In witness whereof I have hereunto set my hand and seal this 24th day of April 1903.

and sealed and
signed by the above-
Edward Stafford
in the presence of

Chas. E. Howlett,
Office of Woods.

Edw. Stafford Howard



1. Rules for persons taking out a License from the Crown to angle for Salmon in the River Wye.

1. The License is granted over the left or south half of that part of the River which lies between Potter's Orchard and the County Boundary stone (see plan above).
2. The Salmon includes the right to angle for other kinds of fish in their proper seasons, and by legal methods.
3. No fishing except fair rod and line angling, no night line or night loptom fishing is allowed for any kind of fish.
4. The season for angling for Salmon begins on the 2nd February and ends on the 15th October; for Trout it begins on the 2nd March and ends on the 1st ~~October~~ ^{September}, all dates inclusive.
5. No gaff shall be used as an auxiliary to the rod and line before the 15th day of March. Licensees must provide themselves with landing nets instead.
6. All fish measuring less than six inches in length from the point of the nose to the fork of the tail are to be returned to the

water

30 NE

Gloucestershire. Sheet
Herefordshire. Part of Sheet.
Monmouthshire. Part of Sheet.

GOODRICH

Here. LIV. N.E.

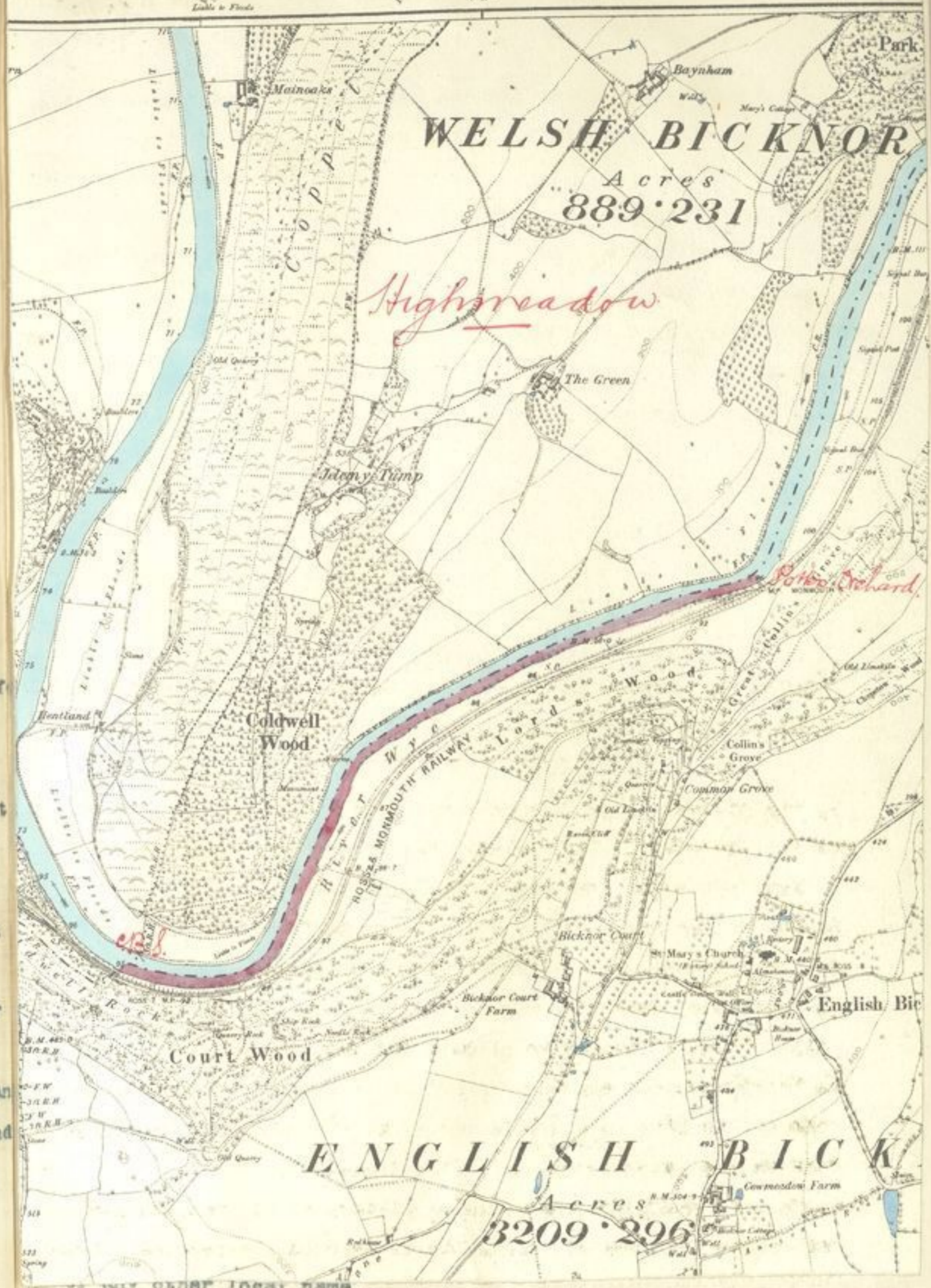

"Young of Salmon" shall include all young of the salmon species
whether

to angle f
that part
County
is of fish
nt line or
February an
d March and
d line
mselves
om the poin
to the
water



1. Rules for persons taking out a License from the Crown to angle Salmon in the River Wye.

1. The License is granted over the left or south half of that part of the River which lies between Potter's Orchard and the County Boundary stone (see plan above).
2. The Salmon includes the right to angle for other kinds of fish in their proper seasons, and by legal methods.
3. No fishing except fair rod and line angling, no night line or night lobster fishing is allowed for any kind of fish.
4. The season for angling for Salmon begins on the 2nd February and ends on the 15th October; for Trout it begins on the 2nd March and ends on the 1st ^{September} October, all dates inclusive.
5. No gaff shall be used as an auxiliary to the rod and line before the 15th day of March. Licensees must provide themselves with landing nets instead.
6. All fish measuring less than six inches in length from the point of the nose to the fork of the tail are to be returned to the

*in
ce
ly
in*

water in
7. Fish
allowed
8. The
License
9. The
send an
Whiteme
place
fish.
10. The
Rules or
or any b
conducti
liable t
Commis
11. No
12. The
Fishery
Sa
"Sal
whether
salmon, c
cock, blu
peal, har
guined,
whitling
or skarli
travelling
or by any
"Young

- water immediately after they are caught, except...
7. Fishing for Trout, otherwise than by artificial fly, is not allowed before the 1st June.
 8. The Licensee must shew his Crown License and Conservancy Board License when requested to do so by any water Bailiff or Crown Official.
 9. The Licensee shall within a week after the 15th October 1903 send an accurate report to the Deputy Surveyor of the Forest of Dean, Whitemead Park, Coleford, of all salmon caught giving the date and place and the state of the water as well as particulars of the fish.
 10. The Licensee selling his fish, or acting contrary to these Rules or violating any Act of Parliament for the preservation of fish or any bye-law of the Board of Conservators of the district, or conducting himself in a manner unbecoming a gentleman, shall be liable to forfeit his license at once at the discretion of the Commissioner of Woods.
 11. No fishing is permitted on Sundays.
 12. The word "Salmon" is to be interpreted as in the Salmon Fishery Acts, 1861 to 1873.

Salmon Fishery Acts, 1861, 24 & 25 Vic., Cap. 109, Sec. 4.

"Salmon" shall include all migratory fish of the genus Salmon, whether known by the names hereinafter mentioned, that is to say, salmon, cock or kipper, kelt, laural, girling, grilse, botch, blue cock, blue pole, fork tail, mort peal, herring peal, may peal, pug peal, harvest cock, sea trout, white trout, sewin, buntling, guinied, tubs, yellow fin, spred, herling, whiting, bull trout, whitling, scurf, burn tail, fry, samlet, smolt, smelt, skirling or skarling, parr, spawn, pink, last spring, hepper, last brood, gravelling, shed, scad, black tip, fingerling, brandling, broodling, or by any other local name.

"Young of Salmon" shall include all young of the salmon species whether



whether known by the names of fry, saulor, smolt, smelt, skirling
or skarling, parr, spawn, pink, last spring, hepper, last brood,
gravelling, shed, scad, blue fin, black tip, fingerling,
brandling, brondling, or by any other name, local or otherwise.

N.B. Holders of Trout Tickets and Trout Licenses are prohibited
from fishing for or taking any of the above fish.

clh.

*er
in
ce
ly
n*

New Forest.
File 4173^d.

7.12.98

Office of Woods.
27th April 1903.

Easement to
Approach Road
at Burley.

Sr,

New Forest.
File 4173^d.

Easement, Approach road at Burley.

Major H.B.
Strange.

Permission
to make and
maintain
the above.

27 April 1903

The Hon. G.W. Fawcetts, the Deputy Surveyor has reported to this office your application for permission to make a short approach road across the waste of the forest to a property at Burley upon which you are about to build a house and I am directed by Mr. Stafford Howard to inform you that he is willing to give you permission to make and during the pleasure of this Department to maintain an approach road in the position shown by red colour on the enclosed tracing upon the following terms and conditions:-

1. An acknowledgment of 5/- per annum is to be paid in advance to the Deputy Surveyor of the New Forest on the fifth of April in each future year during the continuance of this permission the first payment for the period to the 5th April 1904 to be made on the acceptance of this offer.

The amount of this acknowledgment will be subject to revision as soon as the proposed house is completed.

2. In the event of this permission being determined the ground is to be restored to its original condition to the satisfaction of the Deputy Surveyor.

If this offer is accepted I am to request that you will pay the sum of 5/- to the Hon. G.W. Fawcetts the King's House, Lyndhurst and return to this office the enclosed letter signed and dated.

I am, &c.

(Sd.) Chas. E. Howlett.

Major H.B. Strange.

F. 1238

1903.

New Forest
File 4173^s

Sir,

I beg to accept the offer contained in your letter of 27th April 1903. of permission to make and maintain an approach road in the position shown on the plan that accompanied your letter, and I agree to pay the acknowledgment and to observe the conditions therein specified.

I am, &c.

(Sd.) N. Bland Strange.
Major R. E.

E. Stafford Howard, Esq. C.B.

1903

F. 1238

1903

New Forest
File 4173^s

Sir,

I beg to accept the offer contained in your letter of 27th April 1903. of permission to make and maintain an approach road in the position shown on the plan that accompanied your letter, and I agree to pay the
acknowledgment to observe the conditions therein specified.

131.

