

Sched 1901-02

Dated
15 Novem 1901

County
of Gloucester

Manor of
English Bicknor.

Mrs Anne
Davis & ors

The Kings
Most
Excellent
Majesty

Conveyance
of

premises known
as The Rockley
Hotel, Symonds
Yat,

Consideration
£3,000

This Indenture made the 15th day of November 1901
Between Anne Davis of the Parish of Whitechurch in the County
of Hereford Thomas Brace of the town of Monmouth ^{Geo Granage} and James
Hayward House of the town of Monmouth aforesaid Saddler
hereinafter called the Vendors of the first part Edward Stafford
Howard Esquire B.B. a Commissioner of His Majesty's Woods in
charge of the Land Revenues of the Crown in the County of Gloucester
of the second part and The Kings Most Excellent Majesty of the
third part Whereas by an Indenture dated the 8th day of
May 1873 made between John Endell Bowles and the Reverend
Henry Charles Bowles of the first part George Prosser of the second
part and Thomas Davis of the third part for the consideration therein
mentioned they the said John Endell Bowles and Henry Charles
Bowles by the direction of the said George Prosser did thereby assign
surrender and release and the said George Prosser did thereby
release ratify and confirm unto the said Thomas Davis All those
the several messuages land and hereditaments therein
described and set forth in the first part of the Schedule hereunder
written To hold the same unto and to the use of the said Thomas
Davis his heirs and assigns for ever And whereas by an
Indenture dated the seventh day of July 1873 and made between
Thomas Jones of the one part and the said Thomas Davis of the other
part for the consideration therein mentioned the said Thomas
Jones conveyed unto the said Thomas Davis All those the several
lands and premises therein described and set forth in the second
part of the schedule hereunder written To hold the same unto
and to the use of the said Thomas Davis his heirs and assigns
for ever And whereas by an Indenture dated the 6th day of
April 1874 and made between Edward Jones of the one part
and the said Thomas Davis of the other part the said Edward
Jones for the considerations therein mentioned conveyed unto
the said Thomas Davis All those pieces or parcels of land therein
described and set forth in the third part of the schedule hereunder
written To hold the same unto and to the use of the said Thomas
Davis his heirs and assigns for ever And whereas on or about
the 3rd day of July 1878 the said Thomas Davis purchased from
the Here and Monmouth Railway Company a further piece of
land near Symonds Yat Station containing about eleven perches

of His
d doth
to be fully
duplicate
d Involments
posit by
In witness
e first and
and seals

th (S)

ard (S)

in deposited
olments

Records

The Bath, 2 Berths

as set forth in the fourth part of the schedule hereunder written but no deed of conveyance of such land was ever executed to the said Thomas Davis And whereas by an Indenture dated the 14th day of September 1893 and made between William Ward, Henry Ward and Eleanor ^{Baker} Ward of the one part and the said Thomas Davis of the other part for the considerations therein mentioned they the said William Ward, Henry Ward, and Eleanor Baker Ward did thereby convey unto the said Thomas Davis and his heirs All those four fifth shares of and in the messuages land and premises therein described and set forth in the fifth part of the schedule hereunder written To hold the said four fifth shares and interest of the said William Ward, Henry Ward and Eleanor Baker Ward unto and to the use of the said Thomas Davis his heirs and assigns for ever. And whereas by an Indenture dated the 4th day of September 1897 made between Bertha Ward of the one part and the said Thomas Davis of the other part for the consideration therein mentioned the said Bertha Ward conveyed unto and to the use of the said Thomas Davis his heirs and assigns an undivided moiety of and in the one fifth remaining part or share in the messuages hereditaments and premises described in and comprised in the lastly recited Indenture of the 14th day of September 1893 And whereas by his Will dated the 7th day of July 1892 the said Thomas Davis therein described as of the Rocklea Hotel Symonds Yat appointed the Executors and Trustees of his said Will and gave devised and bequeathed unto them all his real and personal estate and effects Upon trust after payment or making provision out of his personal Estate if the same would allow it and if not then out of his real estate for any deficiency for payment of his just debts funeral and testamentary expenses to pay out of such estate unto his Wife or permit her to retain therefrom for her sole use and benefit the legacy or sum of £100 and at the same time to pay thereout to each of his two children Thomas Moses Davis and Elizabeth Davis the legacy or sum of £50 a piece And upon trust as to his said real estate to sell and

dispose

dispose of the same at their discretion by Public Auction and to convey and assure the same to the Purchaser thereof in the usual way and to give good valid and sufficient discharges and receipts for the Purchase money and he directed his Trustees to include in such sale the goodwill of the business and furniture stock in trade and effects then on the premises And whereas the Testator died on the 4th day of January 1898 and his said Will was duly proved in the District Registry at Gloucester on the 21st day of November 1898 by all the Executors therein mentioned named. And whereas by an Indenture dated the 2nd day of September 1899 made between Amy Ward of the one part and the Vendors of the other part the said Amy Ward in pursuance of an Agreement entered into with the said Thomas Davis prior to his death and for the considerations therein mentioned conveyed unto and to the use of the Vendors as Executors and Trustees of the Will of the said Thomas Davis All her estate share and interest being the other undivided moiety of and in the remaining one fifth part or share of and in All and singular the messuage and premises comprized in and described in the hereinbefore recited Indenture of the 14th day of September 1898. And whereas by the direction of the Vendors the hereditaments hereby assured consisting of the Rocklea Hotel Symonds Yat and premises and comprising the messuages lands and premises described in the several hereinbefore recited Indentures of conveyance were on the 13th day of August 1901 put up for sale by Public Auction and at such sale the Crown was the highest bidder and was declared the Purchaser of the same for the sum of £3,000 And whereas the said Edward Stafford Howard as such Commissioners as aforesaid has agreed with the Vendors for the purchase of the goodwill of the business carried on together with the Furniture Bar fixtures and fittings stock in trade articles and effects upon the said premises at the valuation thereof made by arrangement between the Vendors and the Purchaser at the price or sum of £1,121 "11" 9. ~ ~ And whereas the debts funeral and testamentary expenses and the legacies bequeathed by the Will of the said Thomas Davis have been duly paid or accounted for Now this Indenture witnesseth that in pursuance of the said Agreement and in consideration of the said sum of £3,000 on or before the

execution

dispose

execution of these Presents paid by the said Edward Stafford
 Howard on behalf of the Kings Majesty the receipt whereof the
 Vendors do hereby acknowledge The Vendors as Trustees hereby
 convey unto the Kings Majesty His Heirs and Successors
 All that the messuage and premises called the Rocklea Hotel
 with the cottage lawns gardens woodlands and orchards
 thereto belonging and adjoining situate at Symonds Yat in
 the Parish of English Bicknor in the County of Gloucester
 Together with the appurtenances thereto all which said premises
 are bounded on the west by a Public Footpath on the east
 and south by land forming part of the Manor of English
 Bicknor and belonging to His Majesty the King and on the
 North by land belonging to Matthew Jones and the area
 and position whereof is approximately shewn on the
 Ordnance Survey Map of the said Parish of English Bicknor
 and which premises were comprised in and conveyed
 by the several hereinbefore recited Indentures by the several
 descriptions therein contained and are more particularly
 set forth in the schedule hereunder written To hold the
 said messuage and premises unto His Majesty his heirs
 and Successors in right of His Crown And this
 Indenture further witnesseth that in consideration
 of the said Agreement and of the sum of £1,121, "11" "9 so
 paid as aforesaid the receipt whereof the Vendors do hereby
 acknowledge The Vendor as such Trustees do hereby
 assign unto the Kings Majesty His Heirs and Successors
 All that the goodwill interest and connection of them the
 said Vendors and each of them if any in and concerning
 the said business of an Hotel Proprietor carried on at the
 Rocklea Hotel aforesaid and also all stocks in trade goods
 chattels and fixtures in or about the said premises To hold
 the same unto the Kings Majesty His Heirs and Successors
 in right of His Crown And the said Edward Stafford
 Howard doth hereby direct that this Deed shall be
 deemed to be fully and sufficiently enrolled by the
 deposit of a duplicate thereof in the Office of Land
 Revenue Records and Involvements and the filing
 or making an entry of such deposit by the Keeper of

the

the said
 parties
 there

All the
 messuag
 belong
 the said
 Emanu
 Dargerr
 And
 former
 some y
 at New
 of glou
 a house
 then
 Robert
 Tiscou
 part-
 An
 conta
 situa
 lead
 above
 land
 Jones
 Railw
 smal
 and
 Railw
 First
 12 per
 Thoma
 at or

1-0-0
1-0-12
3-8-11

the said Records and Involment. In witness whereof the said parties hereto of the first and second parts have hereunto set their hands and seals the day and year first above written.

Schedule.

Part. I.

All these ^{two} messuages tenements or dwellinghouses (formerly one messuage) with the garden orchard and appurtenances thereto belonging and adjoining containing by estimation one acre (be the same more or less) formerly in the successive occupations of Emanuel Hughes William Love James Hopkins and William Hughes Dargmann and then in the occupation of

And also all that the site of another messuage or dwellinghouse formerly in the occupation of Mary Hughes but then and for some years past in ruins. All which said premises were situated at New Weir aforesaid in the Parish of English Bicknor in the County of Gloucester having the road leading from New Weir to Coleford a house and garden formerly belonging to William Ward but then of garden ground and premises formerly of Robert Wall but then of and lands formerly of Viscount Ege and then of Her Majesty the Queen on all or most parts and sides thereof.

And also all that piece or parcel of Orchard land containing by estimation a quarter of an acre (more or less) situate lying and being on the left hand side of the road leading from New Weir aforesaid to Symonds Rock and above the said firstly described dwellinghouses and adjoining lands formerly of William Jones deceased afterwards of Mary Jones and then or late of and the Ross and Monmouth Railway (save and except out of the aforesaid premises the small quantity of land which had been taken by the Ross and Monmouth Railway company for the purposes of their Railway)

Part 2.

Firstly All that close or parcel of orchard land containing 12 perches or thereabouts then in the occupation of the said Thomas Jones and situate near to Symonds Yat aforesaid and at or near a place there called the New Weir in the Parish of

English

Stafford
of the
es hereby
2012
cklea Hotel
orchards
ds Yat in
estes
id premises
he east
English
nd on the
the area
the
Bicknor
rveyed
the several
rticularly
hold the
his heirs
this ~
consideration
11th 9th 20
do hereby
ereby
uccessors
thom the
concerning
n at the
trade goods
ies To hold
uccessors
Stafford
all be
by the
of and
filing
Keeper of
the

The Bath, 2 Bicknor

English Bicknor in the County of Gloucester and bounded by the Ross and Monmouth Railway by a road leading to Symonds Yat aforesaid by other land belonging to and in the occupation of the said Thomas Jones and by unenclosed land part of the Royal Forest of Dean on all or the most parts and sides thereof.

And secondly all that close piece or parcel of Orchard land containing 8 perches or thereabouts then in the occupation of the said Thomas Jones and situate at or near the said place there called the New Weir near to Symonds Yat aforesaid in the Parish of English Bicknor in the County of Gloucester and bounded by the said Ross and Monmouth Railway land lately purchased by the said Thomas Davis and by a road and orchard land in the occupation of Edward Jones brother of the said Thomas Jones or all or most parts and sides thereof

Part 3.

All that piece or parcel of land or orchard ground containing by estimation $\frac{3}{4}$ acre more or less situate at the New Weir aforesaid in the said Parish of English Bicknor and adjoining property formerly belonging to one Robert Parry deceased and then to the said Thomas Davis which said piece or parcel of land and orchard ground was more particularly delineated and described in the title map of the said Parish as do.

Part 4.

A small piece of land near Symonds Yat Station which the said Thomas Davis has fenced in (about 11 perches)

Part 5.

All that messuage or dwellinghouse with the outbuildings garden and premises ^{and} with two pieces or parcels of rough land and orcharding interspersed with underwood (the latter pieces being divided from each other by a slide or stile) thereto belonging and appertaining situate at New Weir aforesaid formerly in the occupation of

William

William Ward then of Edward Ward afterwards of the said Lydia
 Hannah Ward his Widow and then in the occupation of William J.
 Lumrey as tenant thereof to William Ward, Henry Ward and
 Eleanor Baker Ward the parties thereto and Amy and Bertha Ward
 And all which premises were bounded by lands formerly belonging
 to one William Hughes and the brow and then of the said
 Thomas Davis Lands of the Ross and Monmouth Railway Company
 the Great Western Railway Company and the brow and the
 Market road leading from Symonds Yat to Monmouth on
 all or most parts and sides thereof and are delineated in the
 Ordnance Map of the said Parish of English Bicknor but are not
 numbered thereon and are therein stated to contain by
 admeasurement

Thomas Brace Esq.

Anne Davis. Esq. James Hayward Esq. Howse E. Stafford Esq. Howard

Signed sealed and delivered by the within named Anne Davis
 in the presence of

Walter G Hill.

Solicitor, Monmouth.

Signed sealed and delivered by the within named Thomas
 Brace in the presence of

Walter G Hill.

Solicitor, Monmouth.

Signed sealed and delivered by the within named James Hayward
 Howse in the presence of

Walter G Hill.

Solicitor, Monmouth.

Signed sealed and delivered by the within named Edward Stafford
 Howard in the presence of

Morton Evans.

Office of Woods.

Whitehall

I certify that a duplicate of this Deed has been deposited in
 the Office of Land Revenue Records and Involvements and an entry
 thereof made or filed by me.

W. J. Green.

Assistant to the Keeper of the Records

24 February, 1902.

Thirteen
 nine hundred
 MOST EX
 STAFFOR
 Majesty's
George
Mos
 (hereinafte

TH
 as aforesai
 tenant wh
 to His Ma
grow
there
Blat
in t
more
Plan
colo

occupatio
 together
 to the sai

Copy

DEAN FOREST.

Articles of Agreement made the

Thirteenth day of *February*. One Thousand
nine hundred and *two* Between THE KING'S

MOST EXCELLENT MAJESTY of the first part EDWARD
STAFFORD HOWARD Esquire C.B. a Commissioner of His
Majesty's Woods Forests and Land Revenues of the second part and

*George Hawkins (collier) of the Barracks,
Mosley Green.*
(hereinafter called "the said Tenant") of the third part

THE said EDWARD STAFFORD HOWARD as such Commissioner
as aforesaid on behalf of His Majesty hereby agrees to let to the said
tenant who hereby agrees with His Majesty to take and rent as tenant
to His Majesty ALL THAT *Cottage and garden
ground containing 13 perches or
thereabouts situate at Howbeach in
Blakeney Walk in the Forest of Dean
in the County of Gloucester and
more particularly delineated on the
Plan annexed hereto and thereon
coloured red.*

_____ lately in the
occupation of *John Watkins*
together with the fixtures therein TO HOLD the same hereditaments
to the said tenant _____

Inrolled 18th February 1902.

from the *twenty third* day of *September 1901*
~~for the period to the 10th October 1901 & thereafter~~
 as tenant from year to year (the tenancy being however determinable
~~1/11 for the period to 10th October 1901 & thereafter~~ at the yearly rent of
 as after mentioned) at the yearly rent of *Five Pounds.*

to be paid to *the Deputy Surveyor of Dean Forest.*

free from all taxes rates and deductions whatsoever (except Landlord's
 property tax) by equal Quarterly payments on the *fifth*

day of *July* the *tenth* day of

October the *fifth* day of *January*

and the *fifth* day of *April* in every year

the first Quarterly payment ~~is~~ ^{*of 1/11 having become*} due on the *tenth*

day of *October 1901*

AND the said tenant

rent of 4/11 & the

hereby agrees that he will pay to the King's Majesty the said yearly

rent of *Five Pounds.* on the days

and in the manner aforesaid And will also pay the land tax sewer

rates and all other rates taxes and assessments whatsoever

(except the Landlord's property tax) now or hereafter to be imposed

in respect of the said premises Together with a proportionate part

thereof for the period which shall elapse between the Quarterly day

of payment next preceding the expiration of the said tenancy and the

day on which the same shall expire AND also will not do or suffer

any damage to the said premises and will at all times well and

properly manage and cultivate the said land and keep and leave the

same clean and in good heart and condition and will also keep the

windows and doors in good repair and the ceilings and interior walls

properly cleaned and whitewashed and will on the determination of

the tenancy hereby created deliver up the said premises in such repair

and condition as aforesaid to the King's Majesty his heirs or

successors or to the said EDWARD STAFFORD HOWARD or other the

Commissioner or Commissioners for the time being of His Majesty's

Woods Forests and Land Revenues having the Management of the

said premises (hereinafter called "the said Commissioner or Com-

missioners") or to whom he or they may appoint AND will permit

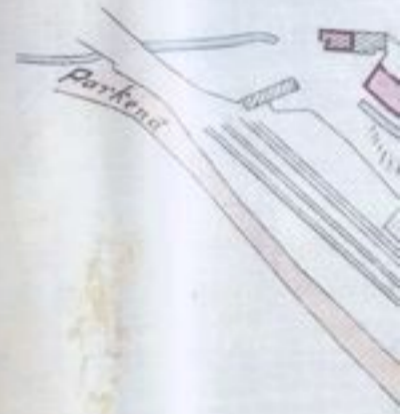

Note. The portion colored Red

Scale 25

Signed by the a

George Haw

in the presence

W

Forest King

the said Commissioner or Commissioners or his or their agent at any time or times during the said tenancy to enter into and inspect the state and condition of the said premises and to execute any works thereon or to place thereon any notice AND the said tenant further agrees that he will so far as possible keep a watch over and protect the Crown Property in the neighbourhood of the premises from injury or damage AND IT IS HEREBY AGREED that it shall be lawful

for the said Commissioner or Commissioners or the said tenant to enter upon the said premises at any one of the Quarterly days hereinbefore mentioned on the first or any subsequent year thereof by giving to the other of them three calendar months' previous notice in writing of his or their intention to do so and if such notice shall proceed from the said Commissioner or Commissioners the same may be given to the said tenant or left upon the said premises and if such notice shall proceed from the said tenant the same shall be left at the office of the Commissioner or Commissioners at His Majesty's Woods Forests and Parks in the City of London and the said EDWARD STAFFORD HOWARD doth hereby certify that this agreement shall be deemed to be fully and sufficiently performed by the deposit of a duplicate thereof in the Office of the said Commissioner or Commissioners and the filing or making an enrolment of the same in the Office of the said Keeper of the said Records and Inrolments and the said parties to these presents of the day hereunto subscribed their names the day

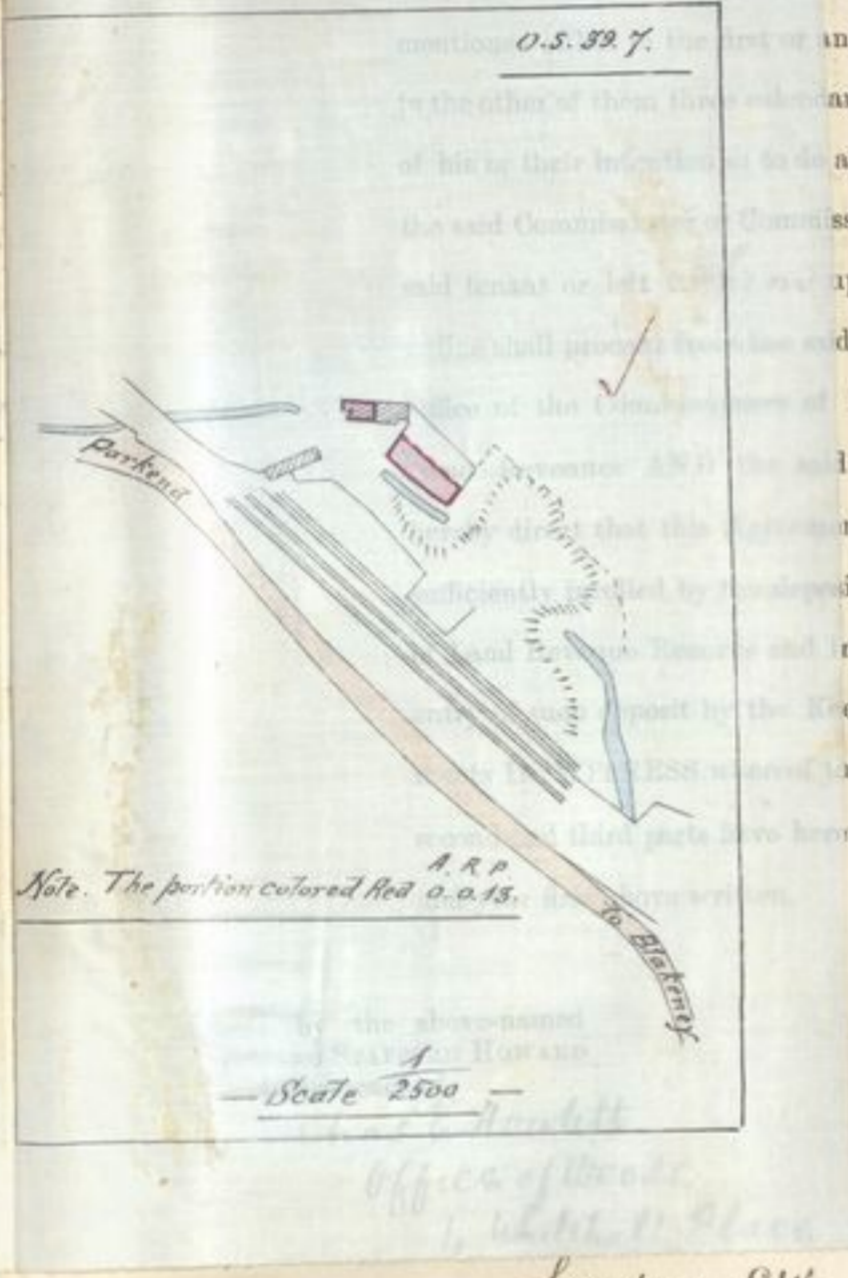

(sgd.) E. Stafford Howard.

Signed by the above-named
George Hawkins
in the presence of

(sgd.) George Watkins

William H. Morris.
Danby Lodge.
Dean Forest

Forest Keeper

the said Commissioner or Commissioners or his or their agent at any time or times during the said tenancy to enter into and inspect the state and condition of the said premises and to execute any works thereon or to place thereon any notice AND the said tenant further agrees that he will so far as possible keep a watch over and protect the Crown Property in the neighbourhood of the premises from injury or damage AND IT IS HEREBY AGREED that it shall be lawful for the said Commissioner or Commissioners or the said tenant to determine this tenancy at any one of the Quarterly days hereinbefore mentioned either in the first or any subsequent year thereof by giving to the other of them three calendar months' previous notice in writing of his or their intention so to do and if such notice shall proceed from the said Commissioner or Commissioners the same may be given to the said tenant or left for *him* upon the said premises and if such notice shall proceed from the said tenant the same shall be left at the Office of the Commissioners of His Majesty's Woods Forests and Land Revenues AND the said EDWARD STAFFORD HOWARD doth hereby direct that this Agreement shall be deemed to be fully and sufficiently inrolled by the deposit of a duplicate thereof in the Office of Land Revenue Records and Inrolments and the filing or making an entry of such deposit by the Keeper of the said Records and Inrolments IN WITNESS whereof the said parties to these presents of the second and third parts have hereunto subscribed their names the day and year first above written.

Signed by the above-named
EDWARD STAFFORD HOWARD
in the presence of

Chas. E. Howlett
Office of Woods,
1, Whitehall Place
London S.W.

(sgd.) *E. Stafford Howard.*

Signed by the above-named

George Watkins.
in the presence of

William H. Morris.
Danby Lodge.
Dean Forest

(sgd.) *George Watkins*

Forest Keeper

DEAN FOREST.

Dated _____ 19__

EDWARD STAFFORD HOWARD, Esq., C.B.,
a Commissioner of His Majesty's Woods, &c.,

AND

AGREEMENT for letting

on a Yearly Tenancy from the

Rent £ _____ per Annum.

W B & L (s) - 33753 - 500.9.1000
428793 - 100.4.01

their
nine hu
MOST
STAFF
Majesty
John
the
(herein

as afor
tenant
to His
gro
the
in
of
a
on
th

occup
togeth
to the

copy
DEAN FOREST.

Articles of Agreement made the
thirteenth day of *February* ~ ~ ~ One Thousand
nine hundred and *two* ~ ~ ~ Between THE KING'S
MOST EXCELLENT MAJESTY of the first part EDWARD
STAFFORD HOWARD Esquire C.B. a Commissioner of His
Majesty's Woods Forests and Land Revenues of the second part and
John Watkins (collier) of Blakeney
Hill in the County of Gloucester
(hereinafter called "the said Tenant") of the third part

THE said EDWARD STAFFORD HOWARD as such Commissioner
as aforesaid on behalf of His Majesty hereby agrees to let to the said
tenant who hereby agrees with His Majesty to take and rent as tenant
to His Majesty ALL THAT *cottage and garden*
ground containing 13 Perches or
thereabouts situate at Howbeach
in Blakeney Walk in the Forest
of Dean in the County of Gloucester
and more particularly delineated
on the Plan annexed hereto and
thereon coloured red.

_____ lately in the
occupation of *The Wallsend Colliery Company*
together with the fixtures therein TO HOLD the same hereditaments
to the said tenant

Enrolled 18th February 1902

from the *23rd* day of *September, 1901*
 for the period to the *10th October, 1901 & thereafter*
 as tenant from year to year (the tenancy being however determinable
4/11 for the period to 10th October, 1901 & thereafter at the
 as after mentioned) at the yearly rent of *Five Pounds*. Yearly rent of
 to be paid to the Deputy Surveyor of Dean Forest.

free from all taxes rates and deductions whatsoever (except Landlord's
 property tax) by equal Quarterly payments on the *5th*

day of *July* the *10th* day of

October the *5th* day of *January*

and the *5th* day of *April* in every year

the first Quarterly payment ~~to be~~ due on the *10th*

day of *October, 1901* AND the said tenant

hereby agrees that he will pay to the King's Majesty the said yearly
rent of 4/11 & the

rent of *Five Pounds* on the days

and in the manner aforesaid And will also pay the land tax sewer
 rates and all other rates taxes and assessments whatsoever

(except the Landlord's property tax) now or hereafter to be imposed
 in respect of the said premises Together with a proportionate part

thereof for the period which shall elapse between the Quarterly day
 of payment next preceding the expiration of the said tenancy and the

day on which the same shall expire AND also will not do or suffer
 any damage to the said premises and will at all times well and

properly manage and cultivate the said land and keep and leave the
 same clean and in good heart and condition and will also keep the

windows and doors in good repair and the ceilings and interior walls
 properly cleaned and whitewashed and will on the determination of

the tenancy hereby created deliver up the said premises in such repair
 and condition as aforesaid to the King's Majesty his heirs or

successors or to the said EDWARD STAFFORD HOWARD or other the
 Commissioner or Commissioners for the time being of His Majesty's

Woods Forests and Land Revenues having the Management of the
 said premises (hereinafter called "the said Commissioner or Com-

missioners") or to whom he or they may appoint AND will permit

Note: The portion colored

Scate

Signed by the
 EDWARD STAFFORD HOWARD
 in the presence

Chas. B.

6/11

Signed by the

John W.

in the presence

Willis

Forest-keeper

the said Commissioner or Commissioners or his or their agent at any time or times during the said tenancy to enter into and inspect the state and condition of the said premises and to execute any works thereon or to place thereon any notice AND the said tenant further agrees that he will so far as possible keep a watch over and protect the Crown Property in the neighbourhood of the premises from injury or damage AND IT IS HEREBY AGREED that it shall be lawful for the said Commissioner or Commissioners or the said tenant to determine this tenancy at any one of the Quarterly days hereinbefore

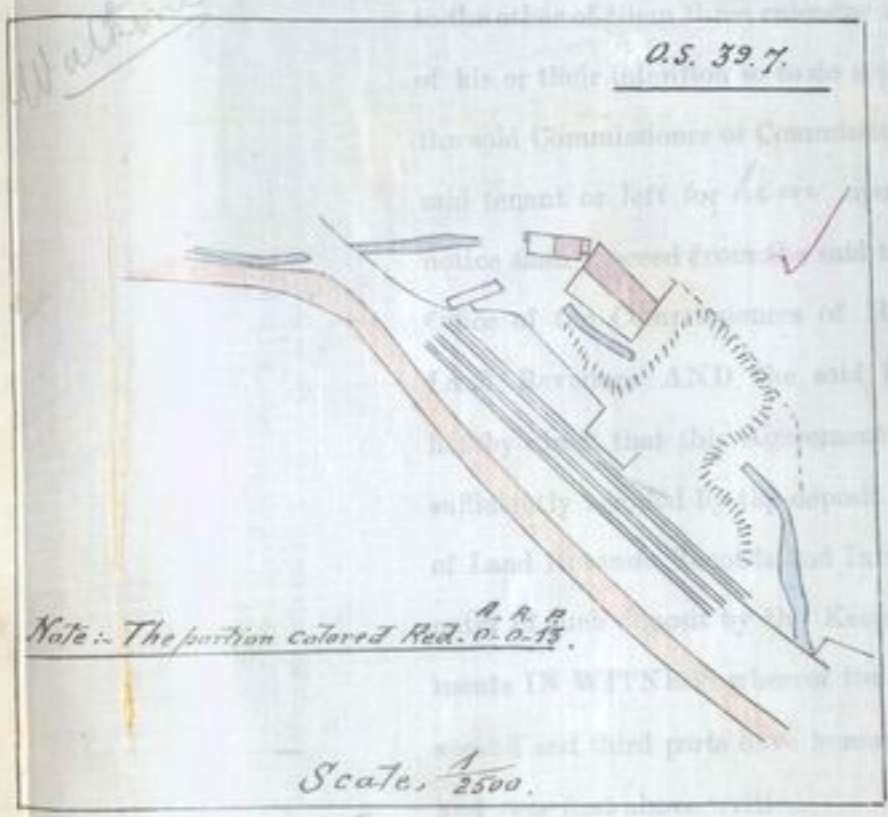

mentioned either in the first or any subsequent year thereof by giving the said tenant or left by him or her notice in writing the same may be given to the said premises and if such the same shall be left at the Majesty's Woods Forests and EDWARD STAFFORD HOWARD doth be deemed to be fully and duplicate thereof in the Office of Land and the filing or making an of the said Records and Inrol- parties to these presents of the subscribed their names the day

Signed by the above-named
EDWARD STAFFORD HOWARD
in the presence of
Chas E. Howlett.
Office of Woods,
1, Whitehall Place,
London S.W.

(sgd.) E. Stafford Howard.

Signed by the above-named
John Watkins
in the presence of
William H. Morris.
Danby Lodge,
Dean Forest.
Forest Keeper.

(sgd.) John Watkins.

1901
hereafter
hereafter at the
Yearly rent of

lord's
day of
ry
y year

tenant
the
yearly

the days
sewer
soever
posed
part
ly day
and the
r suffer
ell and
ave the
ep the
or walls
ation of
h repair
eirs or
her the
ajesty's
t of the
r Com-
l permit

the said Commissioner or Commissioners or his or their agent at any time or times during the said tenancy to enter into and inspect the state and condition of the said premises and to execute any works thereon or to place thereon any notice AND the said tenant further agrees that he will so far as possible keep a watch over and protect the Crown Property in the neighbourhood of the premises from injury or damage AND IT IS HEREBY AGREED that it shall be lawful for the said Commissioner or Commissioners or the said tenant to determine this tenancy at any one of the Quarterly days hereinbefore mentioned either in the first or any subsequent year thereof by giving to the other of them three calendar months' previous notice in writing of his or their intention so to do and if such notice shall proceed from the said Commissioner or Commissioners the same may be given to the said tenant or left for *him* upon the said premises and if such notice shall proceed from the said tenant the same shall be left at the Office of the Commissioners of His Majesty's Woods Forests and Land Revenues AND the said EDWARD STAFFORD HOWARD doth hereby direct that this Agreement shall be deemed to be fully and sufficiently inrolled by the deposit of a duplicate thereof in the Office of Land Revenue Records and Inrolments and the filing or making an entry of such deposit by the Keeper of the said Records and Inrolments IN WITNESS whereof the said parties to these presents of the second and third parts have hereunto subscribed their names the day and year first above written.

Signed by the above-named
EDWARD STAFFORD HOWARD
in the presence of

Chas E. Howlett.
Office of Woods,
1, Whitehall Place,
London, S.W.

(sgd.) E. Stafford Howard.

Signed by the above-named
John Watkins
in the presence of

William H. Morris.
Danby Lodge,
Dean Forest.

(sgd.) John Watkins.

Forest Keeper.

1901
hereafter
able
hereafter at the
Yearly rent of

Lord's

day of

ry

year

sum
yearly
days
part
day
and the
transfer
the
the

ation of
ch repair
heirs or
ther the
Majesty's
nt of the
or Com-
ll permit

from the
for the
 as tenant
1/11
 as after n
 to be paid
 free from
 property t
 day of
Octo
 and the
of 11
 the first Q
 day of
 hereby agre
 rent of
 and in the
 rates and
 (except the
 in respect o
 thereof for t
 of payment
 day or: whic
 any damage
 properly ma
 same clean ar
 windows and
 properly clear
 the tenancy h
 and condition
 successors or
 Commissioner
 Woods Forests
 said premises
 missioners") o

W B A L (1)-32733-300-9-1900
 42828-100-4-01

Rent £ _____
 per Annum.

on a Yearly Tenancy from the

AGREEMENT for letting

AND

EDWARD STAFFORD HOWARD, Esq., C.B.,
 a Commissioner of His Majesty's Woods, &c.,

Dated _____ 19__

Dated 19

EDWARD STAFFORD HOWARD, Esq., C.B.,
a Commissioner of His Majesty's Woods, &c.,

AND

AGREEMENT for letting

133.8:

26th

nine hund

MOST F

STAFFOR

Majesty's

Fr

(hereinaft

TH

as aforese

tenant w

to His M

situ

on t

on

belo

occ

Wa

ope

23

occupati

together

to the s

the

the

Sched 1907

1314

Copy

DEAN FOREST.

26th Articles of Agreement made the
 day of *February* One Thousand
 nine hundred and *two* Between THE KING'S
 MOST EXCELLENT MAJESTY of the first part EDWARD
 STAFFORD HOWARD Esquire C.B. a Commissioner of His
 Majesty's Woods Forests and Land Revenues of the second part and
Frederick Watkins
 (hereinafter called "the said Tenant") of the third part

THE said EDWARD STAFFORD HOWARD as such Commissioner
 as aforesaid on behalf of His Majesty hereby agrees to let to the said
 tenant who hereby agrees with His Majesty to take and rent as tenant
 to His Majesty ALL THAT *Piece or parcel of land*
situata at Bream Eaves and bounded
on the east by Parkhill Enclosure
on the South and West by land
belonging to or formerly in the
occupation of the late Richard
Watkins and on the North by
open forest containing about
23 perches.

_____ lately in the
 occupation of *Richard Watkins*
 together with the fixtures therein TO HOLD the same hereditaments
 to the said tenant _____

thereabouts and "The Lintern Estate" containing 5,338 2/4 or
 thereabouts both situate in the county of Monmouth the particulars
 of

1907
 on Fitzroy
 (the Duke)
 hess of
 cord part
 commissioners
 third part
 fourth part
 d to the Manors
 and heredit-
 eby conveyed
 e a less estate
 d subject only
 to the Duchess on
 age in the year
 d whereas
 of the Act
 cloria chapter
 of His Majesty's
 twenty first day
 purchase on
 vovsons farms
 rple and
 the price of
 the purpose of
 ese Presents in
 re witnesseth
 sale and in
 execution of
 ard on behalf
 1907 the Duke
 ial Owner hereby
 s and releases
 rors and
 ns and right
 to respectively
 2 3/4 or
 a 7/8 or

from the 10th day of October 1901
 as tenant from year to year (the tenancy being however determinable
 as after mentioned) at the yearly rent of *Eleven shillings & six pence*
 to be paid to *the Deputy Surveyor of the Forest of Dean for the*
 free from all taxes rates and deductions whatsoever (except Landlord's *time being*
 property tax) by equal ~~Quarterly~~ ^{half yearly} payments on the 6th
 day of *April* the 10th day of
~~October in~~ ^{every year} the day of
 and the day of in every year
 the first ~~Quarterly~~ ^{half yearly} payment to be due on the *fifth*
 day of *April 1902*. AND the said tenant
 hereby agrees that he will pay to the King's Majesty the said yearly
 rent of *Eleven Shillings & six Pence* on the days
 and in the manner aforesaid And will also pay the land tax sewer
 rates and all other rates taxes and assessments whatsoever
 (except the Landlord's property tax) now or hereafter to be imposed
 in respect of the said premises Together with a proportionate part
 thereof for the period which shall elapse between the ~~Quarterly~~ ^{half yearly} day
 of payment next preceding the expiration of the said tenancy and the
 day on which the same shall expire AND also will not do or suffer
 any damage to the said premises and will at all times well and
 properly manage and cultivate the said land and keep and leave the
 same clean and in good heart and condition and will also ~~keep the~~
~~windows and doors in good repair and the ceilings and interior walls~~
~~properly cleaned and whitewashed and will on the determination of~~
 the tenancy hereby created deliver up the said premises in such ~~repair~~
 and condition as aforesaid to the King's Majesty his heirs or
 successors or to the said EDWARD STAFFORD HOWARD or other the
 Commissioner or Commissioners for the time being of His Majesty's
 Woods Forests and Land Revenues having the Management of the
 said premises (hereinafter called "the said Commissioner or Com-
 missioners") or to whom he or they may appoint AND will permit



Signed by the
 EDWARD STAFFORD
 in the presence

Chas

Signed by the
 Frederic
 in the presence

then
 then

Sched 1901

134

the said Commissioner or Commissioners or his or their agent at any time or times during the said tenancy to enter into and inspect the state and condition of the said premises and to execute any works thereon or to place thereon any notice AND the said tenant further agrees that he will so far as possible keep a watch over and protect the Crown Property in the neighbourhood of the premises from injury

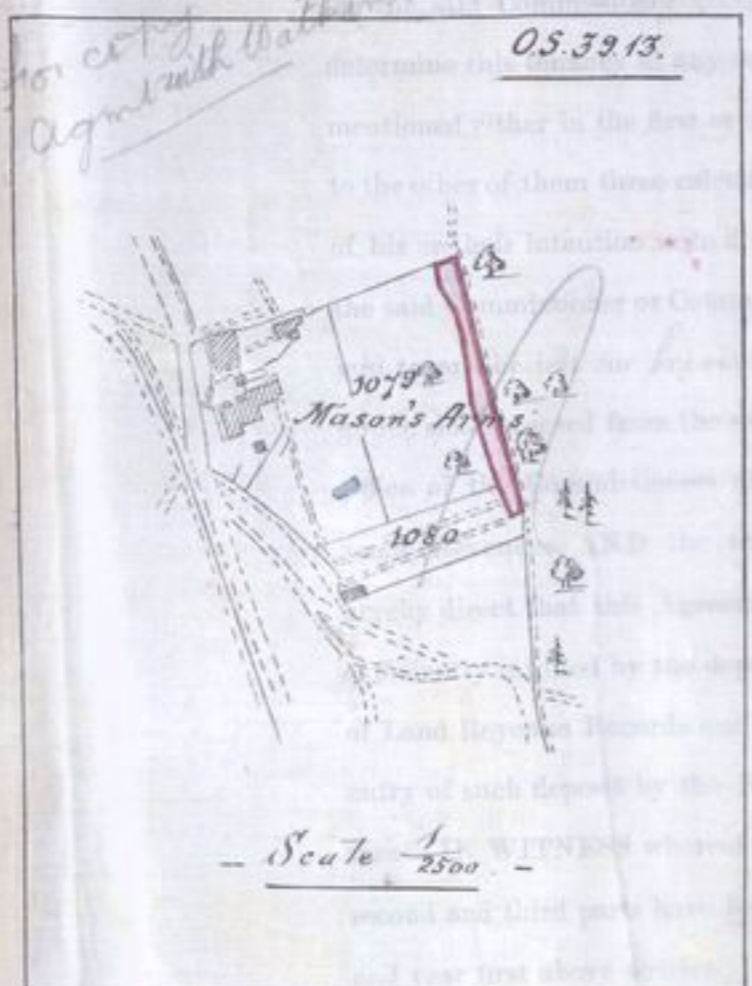

GREED that it shall be lawful assignors or the said tenant to the ^{half-yearly} Quarterly days hereinafter mentioned in the first part of the subsequent year thereof by giving months' previous notice in writing if such notice shall proceed from the said premises and if such want the same shall be left at the Majesty's Woods Forests and EDWARD STAFFORD HOWARD doth shall be deemed to be fully and a duplicate thereof in the Office of the said Records and Inrolments and the filing or making an of the said Records and Inrolments subscribed their names the day

Signed by the above-named
EDWARD STAFFORD HOWARD
in the presence of
Chas. E. Howlett
Office of Woods
1, Whitehall Place
London. S.W.

(sgd.) E. Stafford Howard.

Signed by the above-named
Frederick Watkins
in the presence of
Thomas Morgan
Parkhill Lodge
Crown Woodman.

(sgd.) Fred Watkins.

ry 1901
ton Fitzroy
as the Duke)
hess of
second part
Commissioners
third part
fourth part
id to the Honors
and heredit-
by conveyed
re a less estate
d subject only
to the Duchess on
age in the year
d whereas
rs of the Acto
cloria Chapter
of His Majesty's
twenty first day
purchase on
vowsons farms
rple and
the price of
the purpose of
ese Presents in
re witnesseth
sale and in
execution of
ard on behalf
190170 the Duke
ial Owner hereby
s and releases
rors and
ns and right
to respectively
2. 34 or
a 7. 4 or

thereabouts and "The Tintern Estate" containing 5,338 2. 7 or thereabouts both situate in the County of Monmouth the particulars of

Sched 1907

134

the said Commissioner or Commissioners or his or their agent at any time or times during the said tenancy to enter into and inspect the state and condition of the said premises and to execute any works thereon or to place thereon any notice AND the said tenant further agrees that he will so far as possible keep a watch over and protect the Crown Property in the neighbourhood of the premises from injury or damage AND IT IS HEREBY AGREED that it shall be lawful for the said Commissioner or Commissioners or the said tenant to determine this tenancy at any one of the ^{half yearly} Quarterly days hereinbefore mentioned either in the first or any subsequent year thereof by giving to the other of them three calendar months' previous notice in writing of his or their intention so to do and if such notice shall proceed from the said Commissioner or Commissioners the same may be given to the said tenant or left for him upon the said premises and if such notice shall proceed from the said tenant the same shall be left at the Office of the Commissioners of His Majesty's Woods Forests and Land Revenues AND the said EDWARD STAFFORD HOWARD doth hereby direct that this Agreement shall be deemed to be fully and sufficiently inrolled by the deposit of a duplicate thereof in the Office of Land Revenue Records and Inrolments and the filing or making an entry of such deposit by the Keeper of the said Records and Inrolments IN WITNESS whereof the said parties to these presents of the second and third parts have hereunto subscribed their names the day and year first above written.

Signed by the above-named
EDWARD STAFFORD HOWARD
in the presence of

Chas. E. Howlett
Offices of Woods
1, Whitehall Place
London. S.W.

Signed by the above-named
Frederick Watkins
in the presence of

Thomas Morgan
Parkhill Lodge
Crown Woodman.

(sgd.) E. Stafford Howard.

(sgd.) Fred Watkins.

ry 1907
ton Fitzroy
as the Duke)
hess of
second part
Commissioners
third part
fourth part
id to the Honors
and heredit-
ely conveyed
re a less estate
nd subject only
to the Duchess on
age in the year
nd whereas
rs of the Acts
clonia Chapter
of His Majesty's
twenty first day
purchase on
vowsons farms
rple and
the price of
the purpose of
ese Presents in
re witnesseth
sale and in
execution of
ard on behalf
1907 of the Duke
ial Acres forty
s and releases
vrs and
ns and right
to respectively
2. 3/4 or
a 1/2 of
thereabouts and "The Lintern Estate" containing 5,330 2. 7/8 or
thereabouts both situate in the County of Monmouth the particulars
of

1901
able
957 six pence
of Dean for the
lord's time being

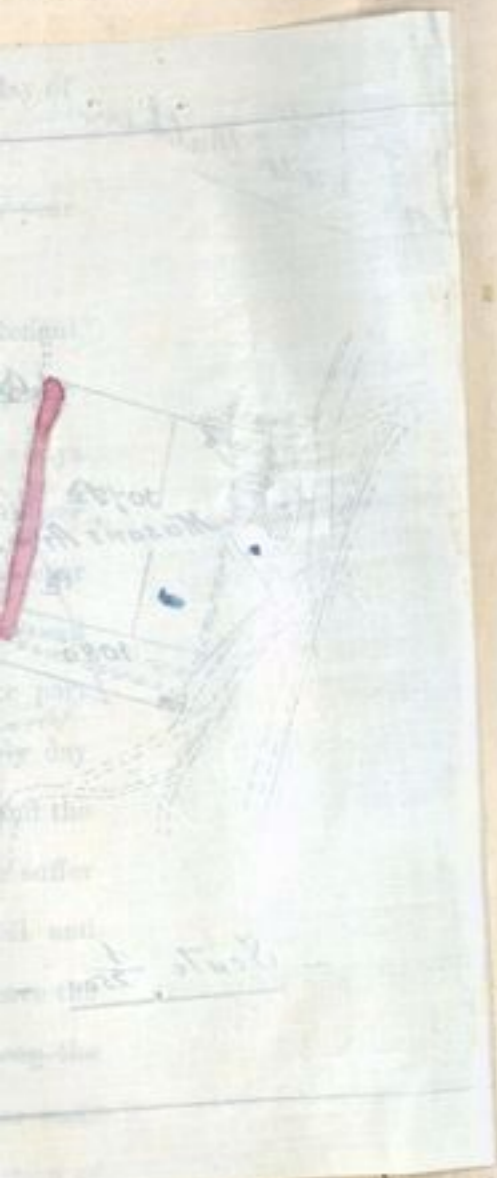

ch repair
heirs or
ther the
Majesty's
nt of the
or Com-
ll permit

thereabouts and "The Lintern Estate" containing 5,330 2. 7/8 or
thereabouts both situate in the County of Monmouth the particulars
of

1338:

W B A L (A) - 38720 - 500.0.1000
42858 - 100.4.01

Rent £ _____ per Annum.

on a Yearly Tenancy from the

AGREEMENT for letting

AND

EDWARD STAFFORD HOWARD, Esq., C.B.,
a Commissioner of His Majesty's Woods, &c.,

Dated _____ 19

DEAN FOREST.

Dated
15 February
1901.

County of
Berkshire

The Most Noble
the Duke and
Duchess of
Beaufort

to
The King's
Majesty.

This
Between
Kings

of the
Beau

Whe
lordsh

for a
in an

1895
the
conveyance
of the Raglan
Estate and the
Tintern Estate.

10th of
142
of
land
in
1901
releas

mar
that
con

thes
of
here
CON

unl
lord
of
kn
ther
thes