

The Commissioners of His Majesty's Woods & Forests to Mr. Joseph Durdle

Conveyance of a piece of Waste Land at Lyndhurst £28.10.0

Conveyance sent to Mr. Turner in Letter dated 6th June 1826.

Stamp £1

These are to witness That in Consideration of the Sum of Twenty eight pounds and ten Shillings paid by Joseph Durdle of Lyndhurst in the County of Southampton to the Commissioners of His Majesty's Woods Forests and Land Revenues for and on account of His said Majesty William Dacres Adams and Henry Dawkins Esquires two of the said Commissioners being duly Authorized by the Lords Commissioners of His Majesty's Treasury by a Letter from their Secretary William Hill Esquire dated 27. April 1826 Do for and on behalf of His said Majesty by these presents Grant bargain and sell unto the said Joseph Durdle His Heirs and assigns

All that piece or parcel of Land part of the Waste of His Majesty's New Forest in the said County of Southampton containing by Admeasurement One Acre one Rod and eighteen perches bounded on the North West by Land belonging to George Grant on the North East by Forest Lands on the South East by a Road or Drift way leading into Ingrams Lane and on the South West by Land belonging to the said Joseph Durdle which said piece or parcel of Land is described and coloured Green in the Map or Plan

Sheet LXXII. 2

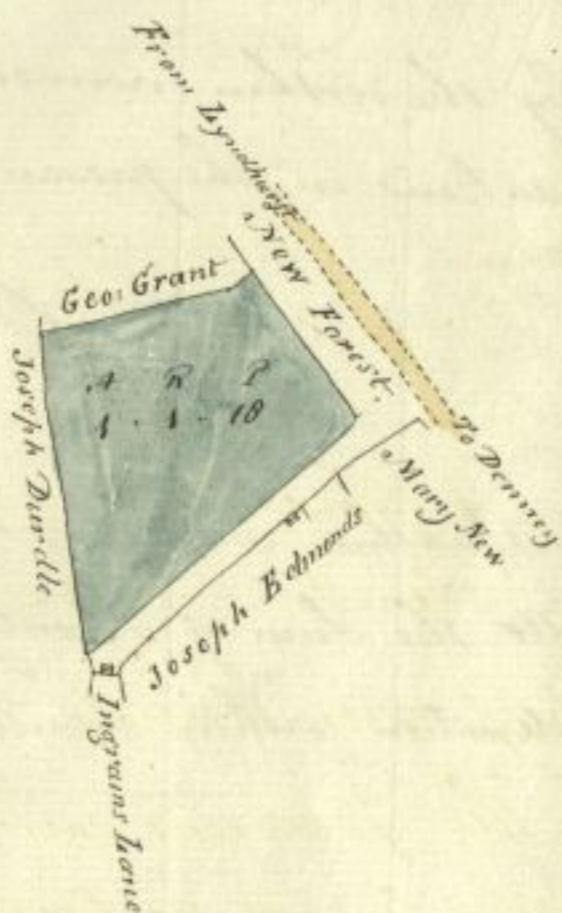

Scale of Chains

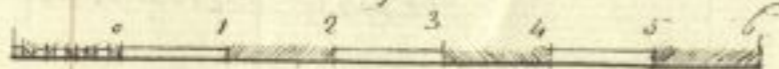

thereof delineated in the Margin of these presents and has been Surveyed Measured and Valued by Robert Turner Deputy Surveyor of His Majesty's said New Forest and Certified by him agreeably

to the provisions of an Act passed in the fifty second year of the
 Reign of His late Majesty King George the Third Cap: 16th Section 6
 to be of the Value in Fee Simple of Twenty eight Pounds and ten
 Shillings To have and to hold the said piece or parcel of
 Land hereby Bargained and Sold or expressed and intended so
 to be and all benefit and advantage thereto belonging unto and
 to the use of him the said Joseph Durdle his Heirs and assigns
 for ever In witness whereof the said William Dacres Adams -
 and Henry Dawkins have hereunto set their hands and seals
 this twentieth day of May in the year of our Lord One thousand
 eight hundred and twenty six.

Wm Dacres Adams

Henry Dawkins

Signed Sealed and delivered by the within named William
 Dacres Adams and Henry Dawkins in the presence of

A. Milne

Received the day and year first within written of and from
 the within named Joseph Durdle the Sum of Twenty eight Pounds
 and ten shillings being the consideration within mentioned to be
 paid by him to us -

Witness

Wm Dacres Adams
 Henry Dawkins

Enrolled the 31st day of May 1826
 before
 G. J. Christianas
 D. Aud^r

The Commissioners of His Majesty's Woods &c. to Mr. Richard Bromfield

Conveyance of two pieces of Waste Land at Lyndhurst.

£12.5.0

Conveyance sent to Mr. Turner in Letter dated 6th June 1826.

Stamp 10/-

These are to Witness that in consideration of the Sum of Twelve pounds and five shillings paid by Richard Bromfield of Lyndhurst in the County of Southampton to the Commissioners of His Majesty's Woods Forests and Land Revenues for and on account of His said Majesty William Dacres Adams and Henry Dawkins two of the said Commissioners being duly authorized by the Lords Commissioners of His Majesty's Treasury by Letter from their Secretary William Hill Esquire dated 27th April 1826 DO for and on behalf of His said Majesty by these presents grant bargain and sell unto the said Richard Bromfield his Heirs and assigns All that piece or parcel

of Land part of the Waste of His Majesty's New Forest in the said County of Southampton numbered 1 and coloured Green in the Map or Plan thereof delineated in the Margin of these presents containing by Admeasurement nineteen perches bounded on the North West by Lands belonging to Mary New, on the North East by Forest Land and the Road leading from Lyndhurst to Denny and on the South East, and South West by Lands belonging to the said Richard Bromfield

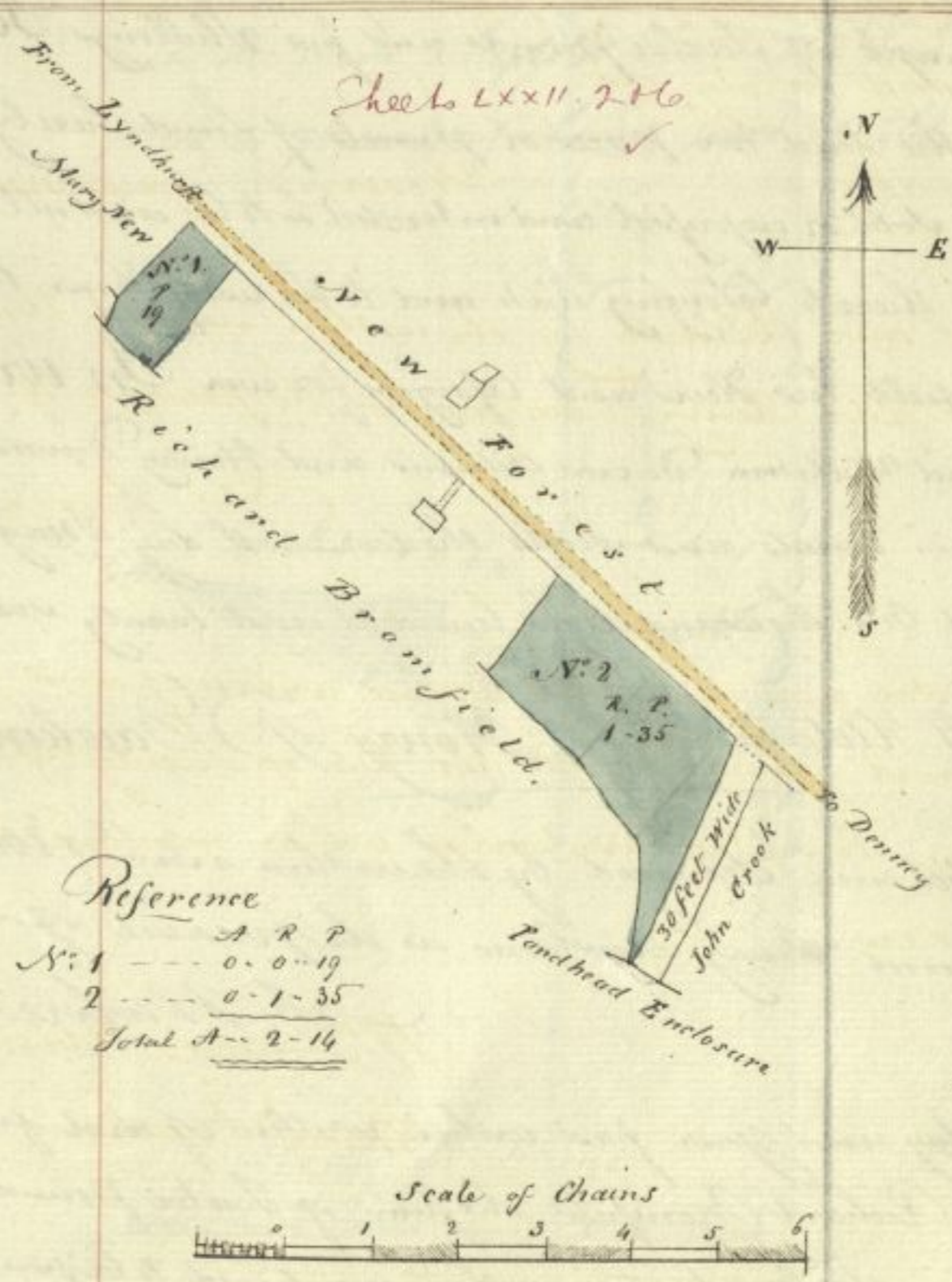

Reference

	A	R	P
N:o 1	0	0	19
2	0	1	35
Total A	0	2	14

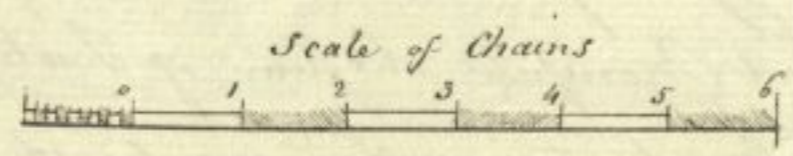

And also all that piece or parcel of Land other part of the Waste of the said Forest numbered 2 and coloured Green in the said Map or Plan containing by Admeasurement One Rood and thirty

thirty five perches bounded on the North East by Forest Land and
 the aforesaid Road leading from Lyndhurst to Denney on the
 South East by a Road or Driftway leading into Paidhead Inclosure
 and on the other sides thereof by Lands belonging to the said Richard
 Bromfield, which said two pieces or parcels of Land containing
 two Roods and fourteen perches, have been surveyed measured
 and valued by Robert Turner Deputy Surveyor of His Majesty's
 said New Forest and certified by him agreeably to the provisions
 of an Act passed in the fifty second year of the Reign of His late
 Majesty King George the Third Cap: 165, Section 6. to be of the
 value in fee simple of Twelve pounds and five Shillings To have
 and to hold the said two pieces or parcels of Land hereby
 bargained and sold or expressed and intended so to be and all bene fit
 and advantage thereto belonging unto and to the use of him the said
 Richard Bromfield his Heirs and Assigns for ever In witness
 whereof the said William Dacres Adams and Henry Dawkins have
 hereunto set their hands and Seals the twentieth day May in the
 year of our Lord one thousand eight hundred and twenty six.

Wm Dacres Adams Henry Dawkins

Signed Sealed and delivered by the within named William
 Dacres Adams and Henry Dawkins in the presence of
 A. Mable

Received the day and year first within written of and from the
 within named Richard Bromfield the sum of Twelve pounds and
 five shillings being the consideration within mentioned to be paid by
 him to us.

Witness

Wm Dacres Adams
 Henry Dawkins

Enrolled the 1st day of June 1826
 before C. G. Christmas Esq.

Commissioners of Woods &
Stephen Lancaster Esq.

New Forest

In N. O. 1827.

Conveyance of two pieces of Waste Land at Boldre
£10.5.0

Stamp 10/

These are to Witness, that in Consideration of the Sum of Ten Pounds and five Shillings paid by Stephen Lancaster of Warborne House in the Parish of Boldre in the County of Southampton Esquire to the Commissioners of His Majesty's Woods Forests and Land Revenues for and on account of His said Majesty, William Dacres Adams and Henry Dawkins Esquires two of the said Commissioners being duly Authorized by Warrant from the Lords Commissioners of His Majesty's Treasury dated "17th May 1826" Do for and on behalf of His said Majesty by these presents grant bargain and sell unto the said Stephen Lancaster his Heirs and Assigns All that Piece or parcel of Land part of the Waste of His Majesty's New

Sheet LXXX. 15.

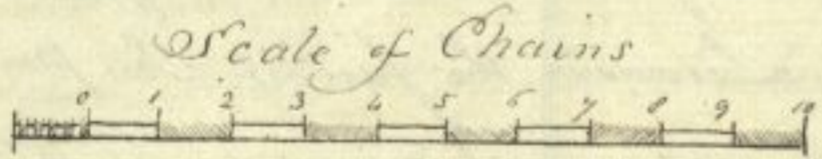
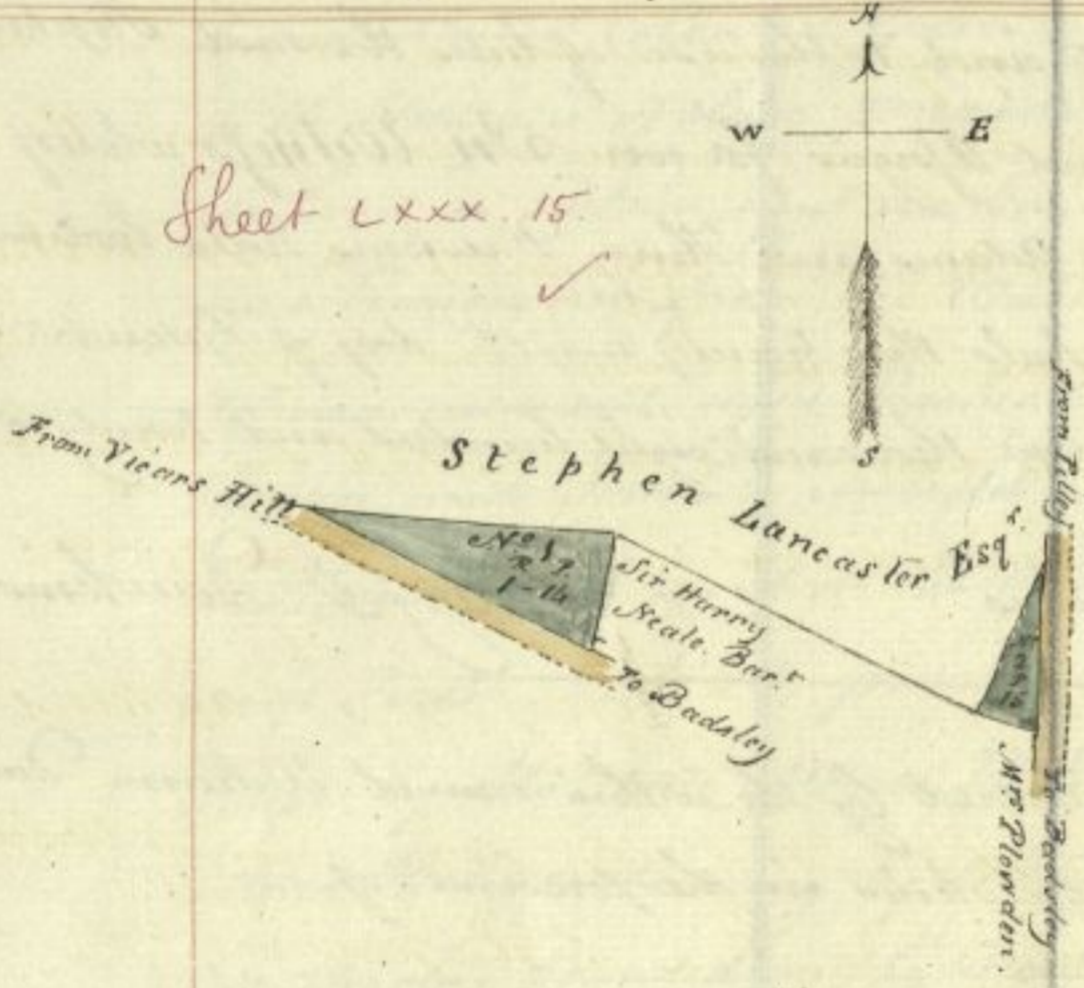

Forest in the said County of Southampton numbered 1, and coloured Green in the Map or plan thereof drawn in the Margin of these presents — containing by Admeasurement One Rood and fourteen perches bounded on the North by Lands belonging to the said Stephen Lancaster on the East by Lands belonging to Sir Harry Meale, Baronet, and on the South and South West by the Road leading from Vicars Hill to Baddeley And also all that Piece or

Parcel of Land other part of the Waste of the said Forest numbered 2, and coloured Green on the said Map or plan, containing by

Admeasurement

Mel.
Cha.

L3

Admeasurement fifteen Perches, bounded on the East by the Road leading from Pilly to Rudsey on the South by Land belonging to Mrs. Plowden and on the West by Land belonging to the said Stephen Lancaster which said two pieces or parcels of Land, containing together one Acre and twenty nine Perches have been Surveyed Measured and Valued by Robert Turner Deputy Surveyor of His Majesty's said New Forest and certified by him agreeably to the provisions of an Act passed in the fifty second year of the Reign of His late Majesty King George the Third Cap. 161, Sect. 6 to be of the Value in Fee simple of Ten pounds and five shillings To have and to hold the said two pieces or parcels of Land hereby bargained and sold or expressed and intended so to be and all benefit and advantage thereto belonging unto and to the use of him the said Stephen Lancaster his Heirs and Assigns for ever In Witness whereof the said William Dares Adams and Henry Dawkins have hereunto set their Hands and Seals this twenty ninth day of September in the year of Our Lord One thousand eight hundred and twenty six.

W^m Dares Adams

Henry Dawkins

Signed Sealed and Delivered by the within named William Dares Adams and Henry Dawkins in the presence of

Received the day and year first within written of and from the within named Stephen Lancaster the sum of Ten pounds and five shillings being the consideration within mentioned to be paid by him to us.

Witness

W^m Dares Adams
Henry Dawkins

Enrolled the 7th day of October 1826
Before C^h Christmas J. A. D.

The Commissioners of His Majesty's Woods &c.
to
Chas. William Michel Esq.

New Forest

In N.º. 1827

Conveyance of 8 pieces of Waste Lands

£406.0.5

£3 stamp

These are to Witness that in consideration of the Sum of Four hundred and Six pounds and Five pence paid by Charles William Michel of Northwood in the Parish of Lyndhurst in the County of Southampton Esquire to the Commissioners of His Majesty's Woods Forests and Land Revenues for and on account of His said Majesty, William Dacres Adams and Henry Dawkins Esquires two of the said Commissioners being duly authorized by Warrant from the Lords Commissioners of His Majesty's Treasury dated 22nd May 1826 DO for and on behalf of His said Majesty by these presents grant bargain and sell unto the said Charles William Michel his Heirs and assigns All those pieces or parcels of Land part of His Majesty's New Forest in the County of Southampton described and coloured Green in the map or plan thereof delineated in the Margin of these presents, and which said Pieces or parcels of Land do contain and are bounded as follows - N^o. 1, some time since encroached from the Waste of the said Forest containing by Admeasurement eight Perches bounded on the North by a Road, on the East and South by inclosed Lands belonging to the said Charles William Michel and on the West by other part of the Waste of the said Forest. - N^o. 2, formerly encroached from the Waste of the said Forest by Matthew Morris William Flurl, John Tickenor and Moses Flurl, containing by Admeasurement One Acre and twenty one perches bounded on the North West by an Enclosure made for the growth and preservation of Timber called the Northwood Enclosure on the South East by inclosed Lands belonging to the said Charles William Michel and on the South by the Road - referred to in the description of Parcel N^o. 1 - N^o. 3 formerly encroached from the Waste of the said Forest by Robert Ballard Esq. containing by Admeasurement - Three Acres and ten perches bounded on the West and North West by the Northwood Enclosure

above

Sale of Waste Lands to *New*

above referred to in the description of Parcel N^o 2 on the North East in one part by the parcel N^o 4 next hereinafter described and in another part by Copyhold Lands belonging to the said Charles William Michel and on the South and South East by the said Copyhold Lands and other Lands belonging to the said Charles William Michel - N^o 4 formerly encroached from the Waste of the said Forest by the said Robert Ballard, containing by Admeasurement One acre two Roods and twenty five Perches bounded on the North East by the Parcel N^o 5 next hereinafter described on the South West by inclosed Lands belonging to the said Charles William Michel and the Parcel N^o 3 hereinbefore described and on the North West by the Northerwood Enclosure herein above referred to - N^o 5 some time since encroached from the Waste of the said Forest by the said Charles William Michel -

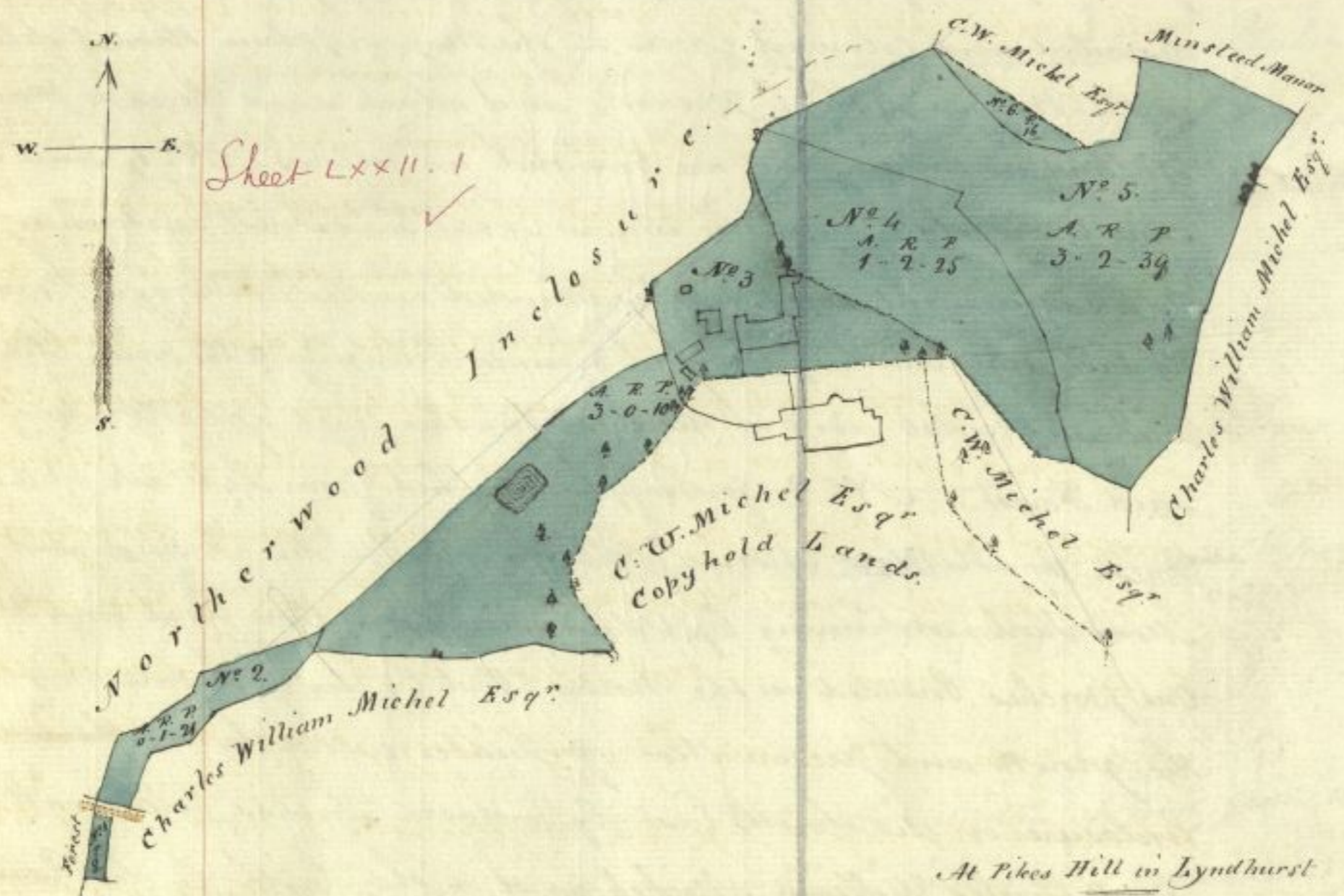

Sheet LXXII. 1

At Pikes Hill in Lyndhurst

Reference		A.	R.	P.
N ^o 1.	-----	0	0	8
" 2.	-----	1	1	21
" 3.	-----	3	0	10
" 4.	-----	1	2	25
" 5.	-----	3	2	39
" 6.	-----	---	---	16
" 7.	-----	---	---	1/2
" 8.	-----	---	---	1/2
Total A.	-----	9	0	1



Position of the
Minsted Manor
to which it
belongs

Scale of Chains.

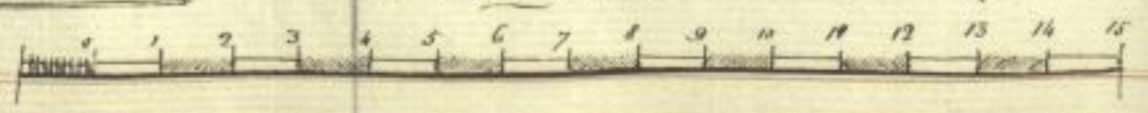

Charles William Michel Esq^r.

containing by Admeasurement Nine Acres two Roods and thirty nine Perches bounded on the North East by the parcel N^o 6, hereinafter described and Minsted Manor, on the East and West by inclosed Lands belonging to the said Charles William Michel, on the South West by other Lands belonging to the said Charles William Michel and the parcel N^o 4 before described and on the North West by the Northerwood Enclosure hereinabove referred to. — N^o 6 formerly encroached from the Waste of the said Forest by John Wolfe containing by admeasurement sixteen Perches, bounded on the North East by inclosed Lands belonging to the said Charles William Michel and on the South West by the parcel N^o 5 hereinbefore described. — N^o 7 part of the Waste of His Majesty's said Forest being the site of part of a Cart House at Pikes Hill containing by Admeasurement One Perch and a half, bounded on the North, East, and South by other part of the said Waste, and on the West by the remainder of the Cart House belonging to the said Charles William Michel, And N^o 8 a Piece or parcel of Land situated at Pikes Hill containing by Admeasurement half a Perch of Land bounded on the East by inclosed Land belonging to the said Charles William Michel and on the West by the Road leading from Lyndhurst to Minsted All which said eight Pieces or parcels of Land have been Surveyed Measured and Valued by Robert Turner, Deputy Surveyor of His Majesty's said New Forest and Certified by him agreeably to the provisions of an Act passed in the fifty second year of the Reign of His late Majesty King George the Third Cap: 16. Sect: 6 to contain together the quantity of nine Acres and one Perch, and to be, with the Timber and Underwood growing thereon, of the Value in Fee Simple of Four hundred and six pounds and Five Pence To have and to hold the said eight Pieces or parcels of Land hereby bargained and sold or expressed and intended so to be and all benefit and advantage

advantage thereto belonging unto and to the use of him the said -
 Charles William Michel his Heirs and assigns for ever In Witness
 whereof the said William Dacres Adams and Henry Dawkins have
 hereunto set their hands and seals this eleventh day of December
 in the year of Our Lord One thousand eight hundred and twenty -
 six.

Wm Dacres Adams Henry Dawkins

Signed Sealed and delivered by the within named William
 Dacres Adams and Henry Dawkins in the presence of
 W. D. White Office of Woods &
 Whitehall

Received the day and year within written of and from the within
 named Charles William Michel the sum of Four hundred and
 six pounds and five Pence being the consideration money within
 mentioned to be paid by him to us.

Witness

Wm Dacres Adams
 Henry Dawkins

I Enrolled the 11th day of December 1826
 before G. Christmas Dep. Act.

The Commissioners of His Majesty's Woods &c. -
with James Hutchinson Esq^r.

Exchange of Lands. -

Stamp £¹⁰⁰ 1. 15. 0

Be it known That William Dacres Adams and Henry Dawkins Esquires two of the Commissioners of His Majesty's Woods Forests and Land Revenues in exercise of the powers given by an Act passed in the Fifty second year of the Reign of His late Majesty George the Third Cap: 161 DO by these Presents on the behalf of His present Majesty His Heirs and Successors give grant and convey to James Hutchinson of Sheriff Hill Esquire his Heirs and assigns All that piece or parcel of Land part of an Estate of His Majesty called Chopwell Woods in the County of Durham containing by Admeasurement One Rood and six perches marked N^o 1, and coloured red in the Map or Plan delineated in the Margin of these

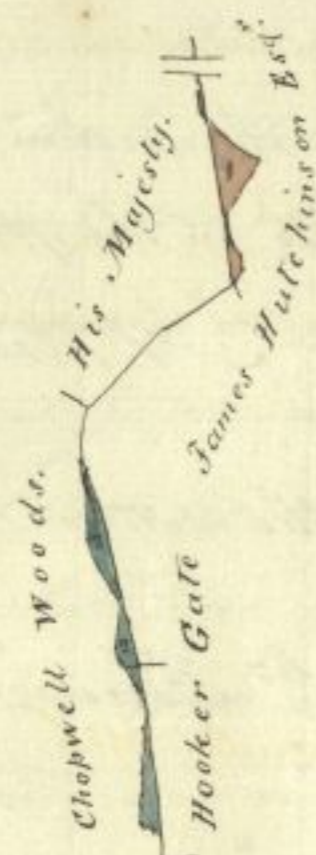

Presents And the said James Hutchinson Doth by these presents for himself and his Heirs give grant and convey unto his said Present Majesty his Heirs and Successors - All that piece or parcel of Land / part of an Estate belonging to him the said James Hutchinson marked N^o 2 and coloured Green in the said Map or plan and containing by Admeasurement one Rood and six perches In Exchange for the said piece or parcel of Land distinguished by a red colour in the said Map or plan - and which said last mentioned piece or parcel of Land has been surveyed measured

and valued by William Fryer of Newcastle Esquire and Certified by him agreeably to the Provisions of the Act herein above referred to be of equal value with the first mentioned piece or parcel of Land N^o 1. Provided always That if His said Majesty His Heirs and

Successors

Successors or the said James Hutchinson his Heirs or Assigns - shall at any time without his or their respective wilful default be evicted of the same or of any or either of the same pieces or parcels of Land hereby given granted and conveyed to him or them respectively as aforesaid, It shall be lawful for the party or Parties so evicted to enter into the piece or parcel or pieces or parcels of Land contracted by him or them to be given in Exchange as aforesaid and to hold and enjoy the same in his or their former state in the same manner as if the Exchange hereby made had not been made In witness whereof the said Parties to these Presents have hereunto set their hands and seals this thirteenth day of May in the year of our Lord one thousand eight hundred and twenty six.

Wm. Dacres J. Adams - Henry J. Dawkins - James J. Hutchinson

Signed, Sealed and Delivered by the within named William Dacres Adams and Henry Dawkins in the presence of
A. Melne

Signed Sealed and Delivered by the within named James Hutchinson in the presence of
Ben^{ts} Fenwick

Inrolled the 28th day of July 1826
 before - C. G. Christmas
 J. aud^r

Licence to Edw^d Protheroe Esq^r to erect, construct and continue certain Engines and Railways at and connected with Coal works belonging to him near Park End. -

no Rent rec^d in 1827

Whereas Licences, as under, have been granted at different times to Edward Protheroe of Harley Street in the Parish of Marylebone in the County of Middlesex Esquire and Thomas Waters Junior, late of the Town of Cammerton but then residing in the County of Gloucester Esquire or have been assigned over to them by others to whom the same had been granted for erecting Fire or Steam Engines and inclosing small pieces of Land in His Majesty's Forest of Dean in the County of Gloucester - viz^t - 20th July 1805 to complete and continue a Fire or Steam Engine at a Coal work called "Catch Can" in lieu of one at a place called Brookland Ditches. - 20th July 1813, to continue Two Fire or Steam Engines at a place called Dry Moor head. - 27th January 1817, to erect and continue an auxiliary Engine at the above place, and to inclose Two Roods and one Perch of Land. - 2nd January 1815, to continue a Fire or Steam Engine at a place called "Birches Wells" and to inclose one Rood of Land - 26th January 1818 to erect and continue a small winding Engine as an appendage to the above - and 31st January 1820 to erect and continue a Fire or Steam Engine at a Coal work called the "Union". And whereas the whole of the Interest in and derivable from the Works carried on under the said Licences is at present vested in the said Edward Protheroe now of Great Gaddesden in the County of Herts and he has relinquished and given up the same with the view and on the condition that he shall have granted to him one Licence comprehending all the Engines now necessary for the works carrying on by him with leave to form and lay down a Branch of Railway as hereinafter described

Now it is hereby Witnessed that in consideration of the Annual Rent or sum of Thirty five pounds hereinafter reserved to be paid by the said Edward Protheroe The Right Honorable Charles Arbuthnot and William Dacres Adams Esquire two of the Commissioners of His Majesty's Woods Forests and Land Revenues by and with the authority of the Lords Commissioners of His Majesty's Treasury testified by their Warrant bearing date the 21st day of

March

314
358
33

96

Dean

License to E. Protheroe Esq: to construct

March 1827 DO for and on behalf of His said Majesty by these presents give and grant their leave and licence to the said Edward Protheroe his Executors Administrators and assigns to erect and continue the following Steam or Fire Engines at his Coalworks & situated near Parkend in His said Majesty's Forest of Dean vizt.

- A. One Pumping Engine at Joy Moor Head ----- } 6-0-0
- B. One Winding Engine at ----- } -----
- C. One Pumping Engine at Parkend Main ----- } 6-0-0
- D. One Winding Engine at ----- } -----
- E. One Winding Engine at Parkend Royal Pits ----- } 2-0-0
- F. One Pumping Engine at the Birches Well ----- } 6-0-0
- G. One Winding Engine at ----- } -----

which said Engines are more particularly described and marked with the Letters A.B.C.D.E.F and G, in the Map or plan drawn in the Margin of these presents, & also to form and lay down a branch of Railway leading from the Royal Pits Letter E, to join the Severn and Wye Railway South of Parkend Bridge with proper turns out, being of the length of fifteen hundred yards or thereabouts and more particularly described by a red line in the same Map or plan drawn in the Margin of these presents ----- 15-0-0

£35-0-0

And also to continue the enclosed yard for Timber &c. marked I in the same Map or plan - Such leave and licence to be continued to the said Edward Protheroe his Executors Administrators and assigns for thirty one years from the twenty ninth day of September one thousand eight hundred and twenty five upon the terms and conditions following - that is to say -

First - That the land to be occupied shall not exceed the quantity necessary for the purposes of such Fire or steam Engines and shall not be viewed without the consent and approbation of the Commissioners of His Majesty's Woods Forests and Land Revenues or of the Surveyor General of His Majesty's Woods and Forests for the time being and that no dwelling House, Stable or any building other than such as

has

& continue sundry Steam Engines & Railway near Parkend.

has been usual and is required to be used with such Fire or Steam Engines shall be erected on the Land so to be occupied. -

Second. - That the Land to be used for the said Railway shall not exceed seven feet in width, and that proper crossings shall be made where any Road passes over it, and that the said Edward Protheroe shall if required by the Commissioners of His Majesty's Woods Forests and Land Revenues or by the Surveyor General of His Majesty's Woods and Forests for the time being fence it off from the other parts of the Forest. -

Third. - That the said Edward Protheroe doth agree for himself and his Executors Administrators and assigns to be answerable for and to make good whatever damage may be done or occasioned to His Majesty's Timber Wood Plantations Fences or Enclosures by or on account of the said Fire or Steam Engines and Railway so to be erected made and continued under or by virtue of this Licence the amount of such damage to be ascertained by the Valuation upon oath of the Deputy Surveyor of His Majesty's said Forest of Dean for the time being. -

Fourth. - That the said Edward Protheroe his Executors Administrators and assigns shall for the Licence hereby granted, pay or cause to be paid to the said Commissioners of His Majesty's Woods Forests & Land Revenues or to the Surveyor General of His Majesty's Woods and Forests for the time being, or to such person as shall be duly authorized by them to receive the same the Sum of Thirty five Pounds for the use of his said Majesty on Michaelmas day in each year subsequent to September the twenty ninth one thousand eight hundred and twenty five, that is to say twenty Pounds for the Rent of the Engines and fifteen Pounds for the Rent of the Railway. -

Fifth. - That if the said Edward Protheroe his Executors Administrators or assigns shall be desirous of relinquishing the said Fire or Steam Engines and Railway and of surrendering this Licence at any time within the space of the thirty one years hereinbefore mentioned, Six Months Notice of such their intention shall be given to the

Deputy

... 100 per cent on behalf of the said ...
 ... and grant these lands and ...
 ... the ... and ...
 ... the ... at ...
 ... in the ...

- A. One Pumping Engine at ...
- B. One Winding Engine at ...
- C. One Pumping Engine at ...
- D. One Winding Engine at ...
- E. One Winding Engine at ...
- F. One Pumping Engine at ...
- G. One Winding Engine at ...

which ...
 ... A B C D E F
 ...
 ...
 ...

Referen

- A Pumping Engine at ...
- B Winding Engine at ...
- C Pumping Engine at ...
- D Winding Engine at ...
- E Winding Engine at ...
- F Pumping Engine at ...
- G Winding Engine at ...
- H Union Pumping Eng. dismounted
- I Timber Yard and Balance
- K Ground for deposit of ...
- L Five Acres Tolly - Grate
- M Scale for Engine for ...

The Line coloured Red ...
 The Royal Pit and other ...
 The present ...

referred to in ...
 The ...

Scale of Chains

...

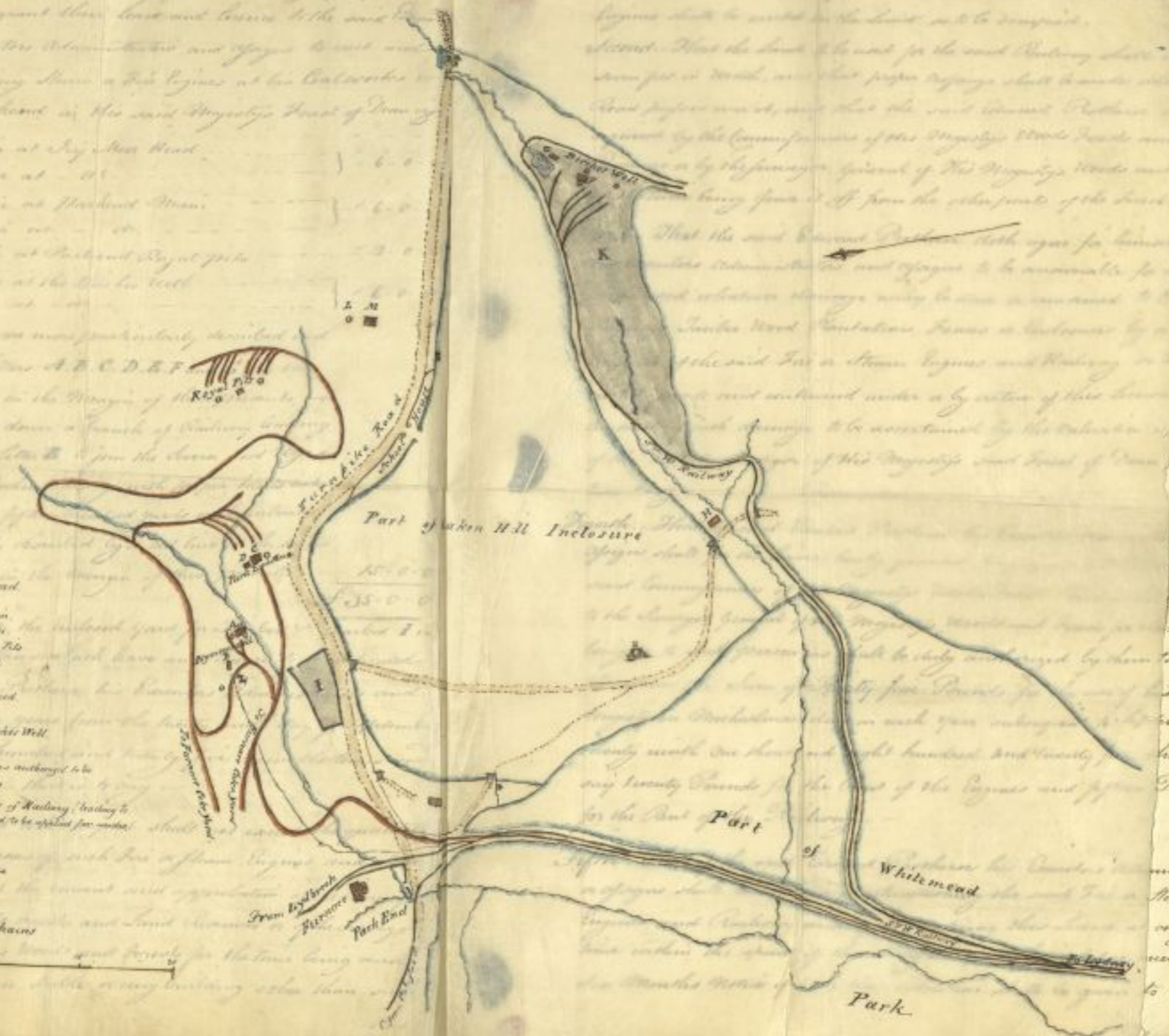

...
 ...
 ...
 ...
 ...

...
 ...
 ...
 ...
 ...

...
 ...
 ...
 ...
 ...

...
 ...
 ...
 ...
 ...

...
 ...
 ...
 ...
 ...

...
 ...
 ...
 ...
 ...

Deputy Surveyor of the said Forest for the time being, and if at the end of six Months after such Notice shall have been so given, the said Edward Protheroe his Executors Administrators or Assigns shall actually relinquish and cease to make use of the said Fire or Steam Engines and Railway and shall level and restore the ground which shall have been broken up raised or lowered in constructing erecting or joining the same or in the construction of any works relating thereto, they shall no longer be subject liable to the said Payment. -

Sixth - That this Licence shall be enrolled in the Office of the Auditor of His Majesty's Land Revenue at the cost and charge of him the said Edward Protheroe and that the same and all and any Assignment or Assignments thereof shall be entered in the Office of the Commissioners of His Majesty's Woods Forests and Land Revenues or in the Office of the Surveyor General of His Majesty's Woods and Forests for the time being within twenty one days from the date of the said Licence or of any such Assignment or Assignments thereof. -

Seventh - That in default of due compliance with all or any of the foregoing conditions by the said Edward Protheroe his Executors Administrators or Assigns this Licence shall be void and of no effect. -

In Witness whereof the said Charles Arbuthnot and William Dacres Adams and Edward Protheroe have hereunto set their hands and seals this fifth day of April in the year of our Lord One thousand eight hundred and twenty seven.

C. Arbuthnot

W^m Dacres Adams

Edw. Protheroe

Signed Sealed and Delivered by the within named Charles Arbuthnot and William Dacres Adams in the presence of

W. D. White, Office of Woods &
Whitehall

Signed Sealed and Delivered by the within named Edward Protheroe in the presence of

John Thornborough
Office of Woods &

Part of
Enclosure
Ru (S. & U's)

Dean Forest

Licence to Edw. Protheroe Esq. to erect and continue two Fire or Steam Engines at a place called "The ^{Free} Miners Folly". —

no Rent reserved in 1827

Whereas by a Letter from George Harrison Esquire, Secretary to the Lords Commissioners of His Majesty's Treasury dated the 26th day of May 1825, the Commissioners of His Majesty's Woods Forests and Land Revenues were authorized to grant their Licence to George and John Jenkins of Breemes Caves in the Forest of Dean and Hundred of St. Briavels in the County of Gloucester Coal Miners and Free Miners, to erect and continue a Fire or Steam Engine at a Coal work of theirs — called "The Freeminers Folly", situated near Punk End in His Majesty's said Forest of Dean as more particularly described in the Map or Plan drawn in the Margin of these presents and the said George and John Jenkins had previously to the completion of such Licence agreed

to convey and assign to Edward Protheroe of Great-Gaddesdon in the County of Herts Esquire his Heirs — and assigns or otherwise as he or they shall direct or appoint, all that their said Coal work, with all the rights privileges advantages numbers, and appurtenances therunto belonging, and to transfer and assure to him his Heirs or assigns the Licence authorized to be granted to them as hereinbefore above set forth And whereas by a Letter from William Hill Esquire dated 20th March 1827 the said Commissioners were authorized to grant their Licence to the said Edward Protheroe to erect a small winding Engine at the same place, Now These are to Witness that in consideration of the annual Rent or Sum of Six Pounds hereinafter reserved to be paid or caused to be paid by the said Edward Protheroe The Right Honorable Charles Arbuthnot and William Dacres Adams two of the said Commissioners by and with the authorities — hereinabove referred to Do for and on behalf of His said Majesty by these presents give and grant their leave and Licence to the said Edward Protheroe his Executors

Admiral

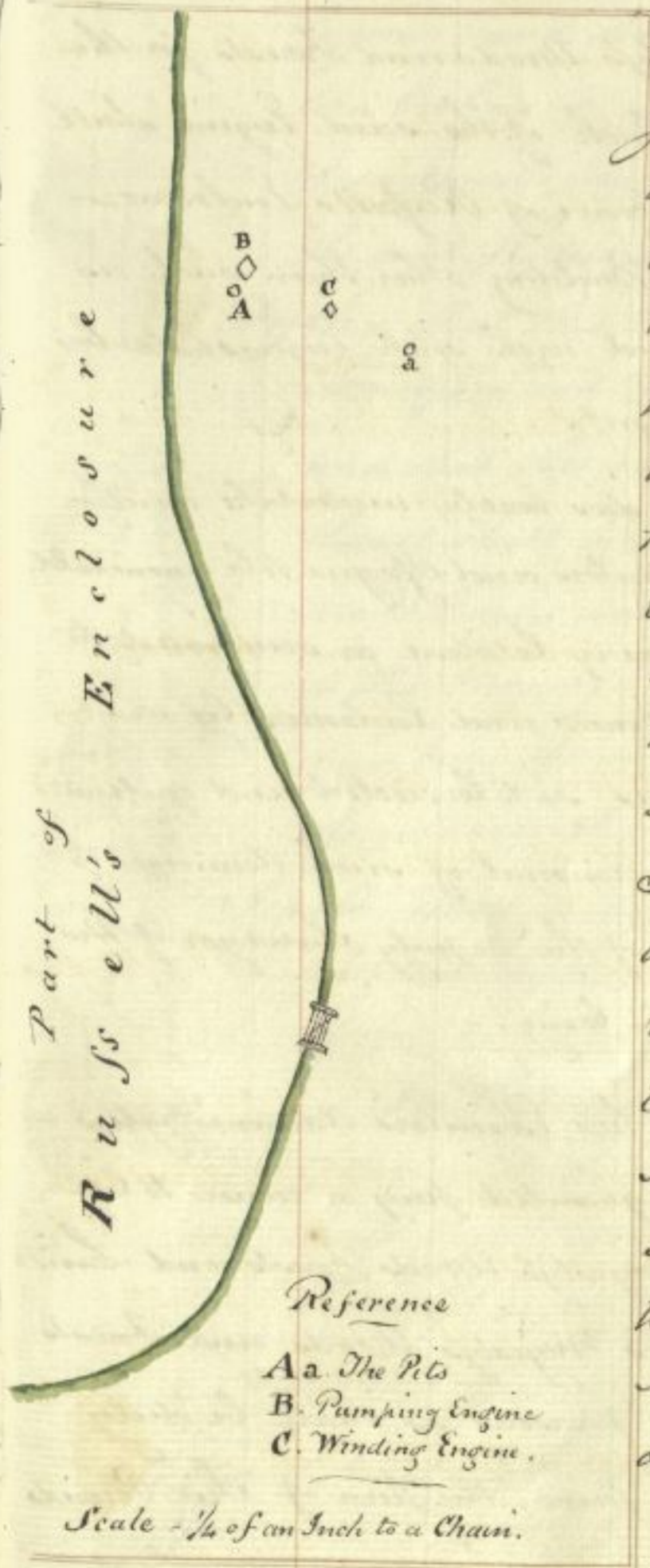

- Reference
 Aa The Pits
 B. Pumping Engine
 C. Winding Engine.

Scale - 1/4 of an Inch to a Chain.

Licence to Edward Protheroe Esq. to erect & continue

Administrators and Assigns to erect and continue such Fire or Steam Engines at the said Coalwork called 'The Free Miners Dolly' such leave and Licence to be continued to the said Edward Protheroe his Executors — Administrators and Assigns for Thirty one years from the Twenty ninth day of September 1825 upon the Terms and Conditions following (that is to say). —

First the Land to be occupied under and by virtue of this Licence shall not exceed the quantity necessary for the purposes of such Fire or Steam Engines and that the same shall be marked out by or on the view and with the concurrence of the Deputy Surveyor of His Majesty's said Forest of Dean and shall not be varied without the consent and approbation of the Commissioners of His Majesty's Woods Forests and Land Revenues or of the Surveyor General of His Majesty's Woods and Forests for the time being and that the Chimney or Stack of the said Engine shall (60 yds) — be at least Sixty yards distant from the fence of Rusell's Enclosure and that no Dwelling House, Stable or Building other than such as has been usual and is required to be used with such Engines shall be erected upon the Land so to be marked out. —

Second. That the said Edward Protheroe does hereby undertake and agree for himself his Executors Administrators and Assigns to be answerable for and to make good whatever damage may be done or occasioned to His Majesty's Timber Woods Plantations Fences and Enclosures by or on account of the said Fire or Steam Engines so to be erected and continued under and by virtue of this Licence, the amount of such damage to be ascertained by the Valuation on oath of the Deputy Surveyor of His Majesty's said Forest of Dean for the time being. —

Third. That the said Edward Protheroe his Executors Administrators — and Assigns shall for the Licence hereby granted pay or cause to be paid to the said Commissioners of His Majesty's Woods Forests and Land Revenues or to the Surveyor General of His Majesty's Woods and Forests for the time being or to such person or persons as shall be duly authorized by them or him to receive the same, the sum of Six Pounds
for

Forest

two Fire or Steam Engines at 'The Miners Folly'

for the use and on the behalf of His Majesty on Michaelmas Day in each year subsequent to the twenty ninth of September One thousand eight hundred and twenty seven.

Fourth. That if the said Edward Protheroe his Executors Administrators or Assigns shall be desirous of relinquishing the said Engines and of surrendering this Licence at any time within the space of the thirty one years hereinafore mentioned Six Months notice of such their intention shall be given to the Deputy Surveyor of the said Forest for the time being, and if at the end of six months after such notice shall have been so given the said Edward Protheroe his Executors Administrators or Assigns shall actually relinquish and cease to make use of the said Engines, and shall level and restore the ground which shall have been broken up in erecting and constructing the same or in the construction of any works relating thereto they shall be no longer subject or liable to the said payment.

Fifth. That this Licence shall be enrolled in the office of the Auditor of His Majesty's Land Revenue at the cost and charge of the said Edward Protheroe and that the same and any and all assignment or assignments thereof shall be entered in the office of the Commissioners of His Majesty's Woods Forests and Land Revenues or in the office of the Surveyor General of His Majesty's Woods and Forests for the time being within twenty one days from the date of the said Licence or of any such assignment or assignments thereof.

Sixth. That in default of due compliance with all or any of the aforesaid conditions by the said Edward Protheroe his Executors Administrators or Assigns this Licence shall be void and of no effect.

In witness whereof the said Charles Arbuthnot and William Dacres Adams and the said Edward Protheroe have hereunto set their hands and Seals this fifth day of April in the year of our Lord One thousand eight hundred and twenty seven.

C. Arbuthnot & Wm Dacres Adams - Edu. Protheroe

Signed Sealed and Delivered by the within named Charles Arbuthnot and William Dacres Adams in the presence of W. D. White - Office of Woods & Whitehall

Signed Sealed and Delivered by the within named Edward Protheroe in the presence of John Thornborough Office of Woods &

Enrolled the 6th day of June 1827 before C. J. Martinus Esq.

New Forest

Conveyance of three pieces of Waste Land to Mr W. Gardiner

£16.5.0

not recd in 1827

Stamp 10^s/k

These are to Witness that in Consideration of the Sum of Sixteen Pounds and Five Shillings paid by William Gardiner of Bewley Rails in the Parish of Boldre in the County of Southampton to The Commissioners of His Majesty's Woods Forests and Land Revenue for and on Account of His said Majesty The Right Honorable Charles Arbuthnot and William Davies Adams Esquire two of the said Commys^{rs} being duly authorized by the Lords Commissioners of His Majesty's Treasury by Letter from their Secretary George Harrison Esquire dated 20th February 1821 Do for and on behalf of His said Majesty by these presents grant bargain and sell unto the said William Gardiner his Heirs and assigns All that piece or parcel of Land part of the Waste of His Majesty's New Forest in the said County of Southampton numbered 1 and coloured Green on the Map or Plan thereof delineated in the Margin of these Presents containing by Admeasurement One Rood and One Perch bounded on the North by other part of the



Sheet LXXX. 16

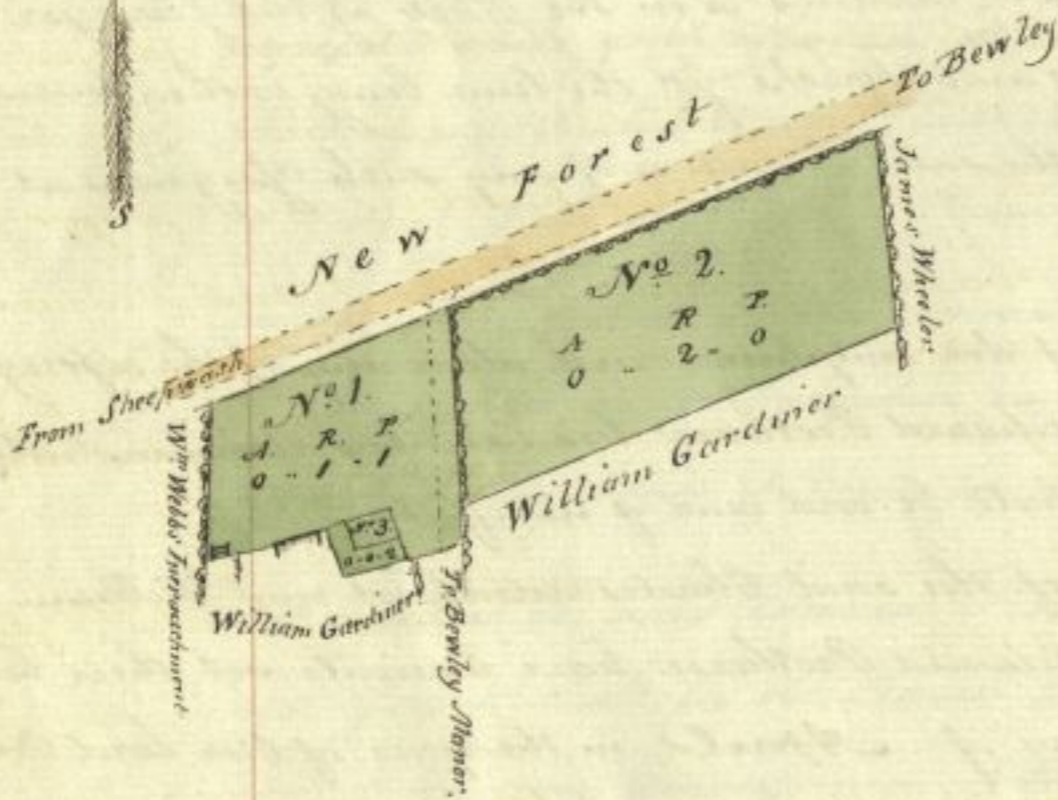

Scale of Chains

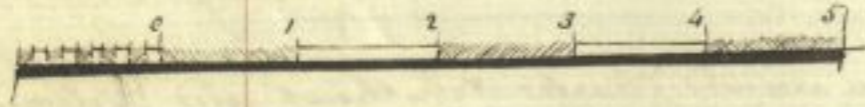

Waste of the said Forest and the Road leading from Sheepwash to Bewley on the East by the piece or parcel of Land numbered 2 on the said Map or Plan and next hereinafter described on the South by the hereinafter described piece of Land No 3, and by Land belonging to the said William Gardiner and on the West by an Incroachment from the Waste of the said Forest in the Occupation of William Webb, which said piece or parcel of Land is now subject and shall hereafter continue subject to a Road in and over

the

the East End thereof to the Gate leading into Bewley Manor And also all that piece or parcel of Land numbered 2, and also coloured Green in the said Map or plan heretofore Incroached from the waste of the said Forest containing by Admeasurement two Roods bounded on the North by other part of the waste of the said Forest, and the aforesaid Road leading from Sheepwash to Bewley on the East by Land belonging to James Wheeler on the South by Lands belonging to the said William Gardiner and on the West by the piece of Land N^o 1 heretofore described And also all that piece or parcel of Land numbered 3, and also coloured Green on the said Map or plan heretofore Incroached from the waste of the said Forest containing by Admeasurement two perches bounded on the North and East by the hereinafore described piece of Land N^o 1, and on the South and West by Lands belonging to the said William Gardiner Which said three pieces or parcels of Land containing together three Roods and three perches have been surveyed measured and valued by Robert Turner Deputy Surveyor of His Majesty's said New Forest and certified by him agreeably to the provisions of an Act passed in the fifty second year of the Reign of His late Majesty King George the Third Cap: 161 Sect: 6, to be of the value in the simple of sixteen pounds and five Shillings To have and to hold the said three pieces or parcels of Land hereby bargained and sold or expressed and intended so to be and all benefit and advantage there to belonging unto and to the use of him the said William Gardiner his Heirs and Assigns for ever In witness whereof the said Charles Arbuthnot and William Davies Adams have hereunto set their hands and seals this twelfth day of April in the year of Our Lord One thousand eight hundred and twenty seven.

Witness the 14th day of April 1827
 before
 C. G. Lambton Esq^r

(Charles Arbuthnot)

W^m Davies Adams

Signed sealed and delivered by the within named Charles Arbuthnot and William Davies Adams in the presence of

W. D. White - Office of Woods & Whitehall

Received the day and year within written of and from the within named William Gardiner the sum of sixteen pounds and five shillings being the consideration within mentioned & he paid by him to us

Witness W. D. White

C. Arbuthnot
W. Davies Adams

Sum
diner
imp
Reverend
Charles
m
s
dates
these
his
e
ton
dinated
me
the
the
to
ce or
on
next
with
piece
to -
ms
an
sto of
tion of
piece
subject
me
over
the

Conveyance of two pieces of Waste Land to Miss Mary Tate

£18-15-0

These are to Witness that in Consideration of the Sum of Eighteen Pounds and fifteen Shillings paid by Mary Tate of Langdown in the Parish of Dibden in the County of Southampton to The Commissioners of His Majesty's Woods Forests and Land-Revenues for and on account of His said Majesty The Right Honorable Charles Arbuthnot and William Dacres Adams Esquire two of the said Commissioners being duly authorized by the Lords Commissioners of His Majesty's Treasury by Letter from their Secretary William Hill Esquire dated "13th October 1826" Do for and on behalf of His said Majesty by these presents grant bargain and sell unto the said Mary Tate her Heirs and Assigns All that piece or parcel of Land part of the

Stamp 10/-

Waste of His Majesty's New Forest in the said County of Southampton numbered 1, and coloured Green in the Map or plan thereof delineated in the Margin of these presents containing by Admeasurement Fourteen Perches bounded on the North and North West by Lands belonging to the said Mary Tate and on the East by other part of the Waste of the said Forest adjoining the Southampton River And also all that piece or parcel of Land other part of the Waste of the said Forest numbered 2, and coloured Green in the said Map or plan containing by Admeasurement Three Roods bounded on the North West and West by Lands belonging to the said Mary Tate and to the Corporation of Southampton on the East by other part of the Waste of the said Forest adjoining the Southampton River and on the

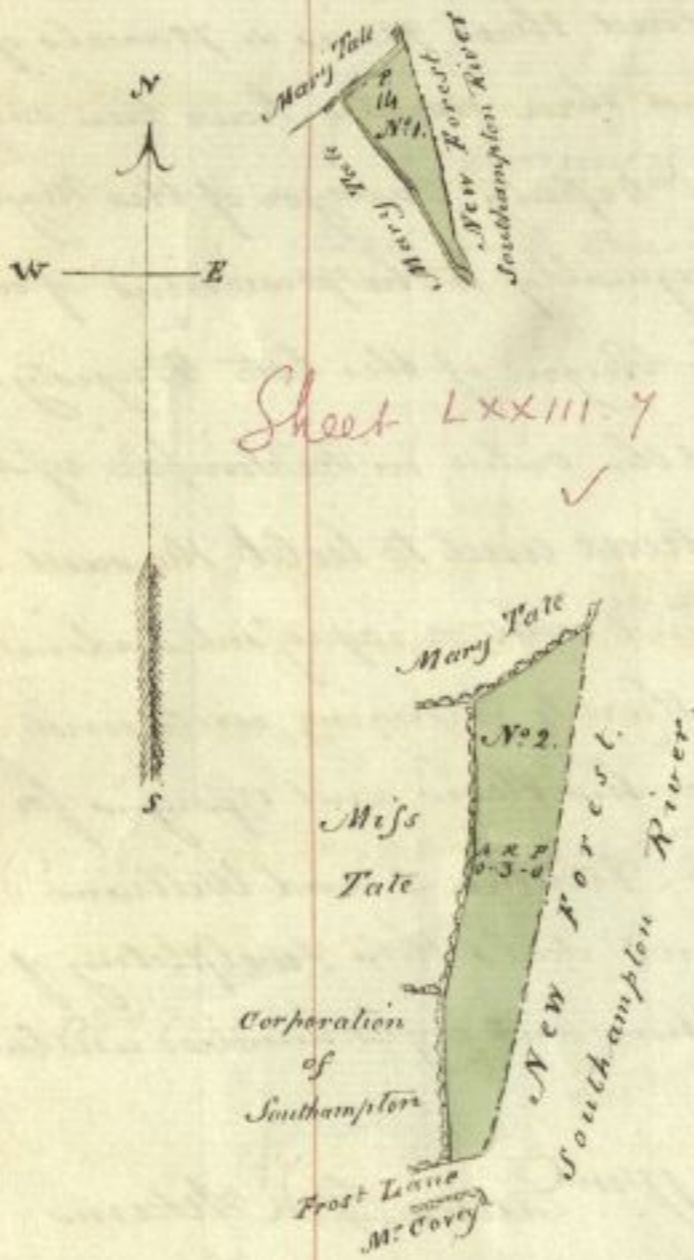

Sheet LXXIII 7

Scale of Chains.

South by a Lane called Frost Lane Which said two pieces or parcels of Land containing together Three Roods and fourteen Perches have been Surveyed Measured and Valued by Robert Turner Deputy

Surveyor

Surveyor of His Majesty's said New Forest and testified by him agreeably
 to the provisions of an Act passed in the fifty second year of the Reign of His
 late Majesty King George the Third Cap: 161 Sect: 6 to be of the value in Fee
 Simple of Eighteen Pounds and Fifteen Shillings To have and to hold
 the said two pieces or parcels of Land hereby bargained and sold or expressed
 and intended so to be and all benefit and advantage thereto belonging unto
 and to the use of her the said Mary Tate her Heirs and Assigns for
 ever In Witness whereof the said Charles Arbutnot and William
 Dacres Adams have hereunto set their hands and seals this twelfth
 day of April in the year of our Lord One thousand eight hundred and
 twenty seven.

Chas. Arbutnot *[Signature]*

Wm Dacres *[Signature]* Adams.

Signed Sealed and Delivered by the within named Charles Arbutnot
 and William Dacres Adams in the presence of - - - - -

W. D. White, Office of Woods &
 Whitehall

Received the day and year within written of and from the within
 named Mary Tate the Sum of Eighteen Pounds and fifteen Shillings
 being the consideration within mentioned to be paid by her to us.

Witness
 W. D. White

C. Arbutnot
 W. Dacres Adams

Enrolled the 14th day of April 1827
 before -

C. G. Christmas
 J. and

New Forest

Conveyance to Mr. John Payne of a piece of Waste Land £19-15-0

not paid in 1827

Stamp 10/-

These are to Witness that in consideration of the sum of Nineteen Pounds and fifteen Shillings paid by John Payne of Bowley Pails in the Parish of Boldre in the County of Southampton to the Commissioners of His Majesty's Woods, Forests and Land Revenues for and on account of His said Majesty The Right Honorable Charles Arbuthnot and William Dacres Adams Esquire two of the said Commissioners being duly authorized by the Lords Commissioners of His Majesty's Treasury by a Letter from their Secretary William Hill Esquire dated 13th February 1827 Do for and on behalf of His said Majesty by these presents grant bargain and sell unto the said John Payne his Heirs and Assigns All that piece or parcel of land part of the waste of His Majesty's New Forest in the said County of Southampton containing by Admeasurement

Three Roods and Twelve perches bounded on the North by Land in the Occupation of John Cops on the East and South by other part of the waste of the said Forest and on the West and North West by Lands belonging to the said John Payne which said piece or parcel of Land is described and coloured Green in the Map or Plan thereof delineated in the Margin of these presents and has been surveyed Measured and Valued by Robert Turner Deputy Surveyor of His Majesty's said New Forest and certified by him agreeably to the provisions of an Act passed in the fifty second Year of the Reign of his late Majesty King George

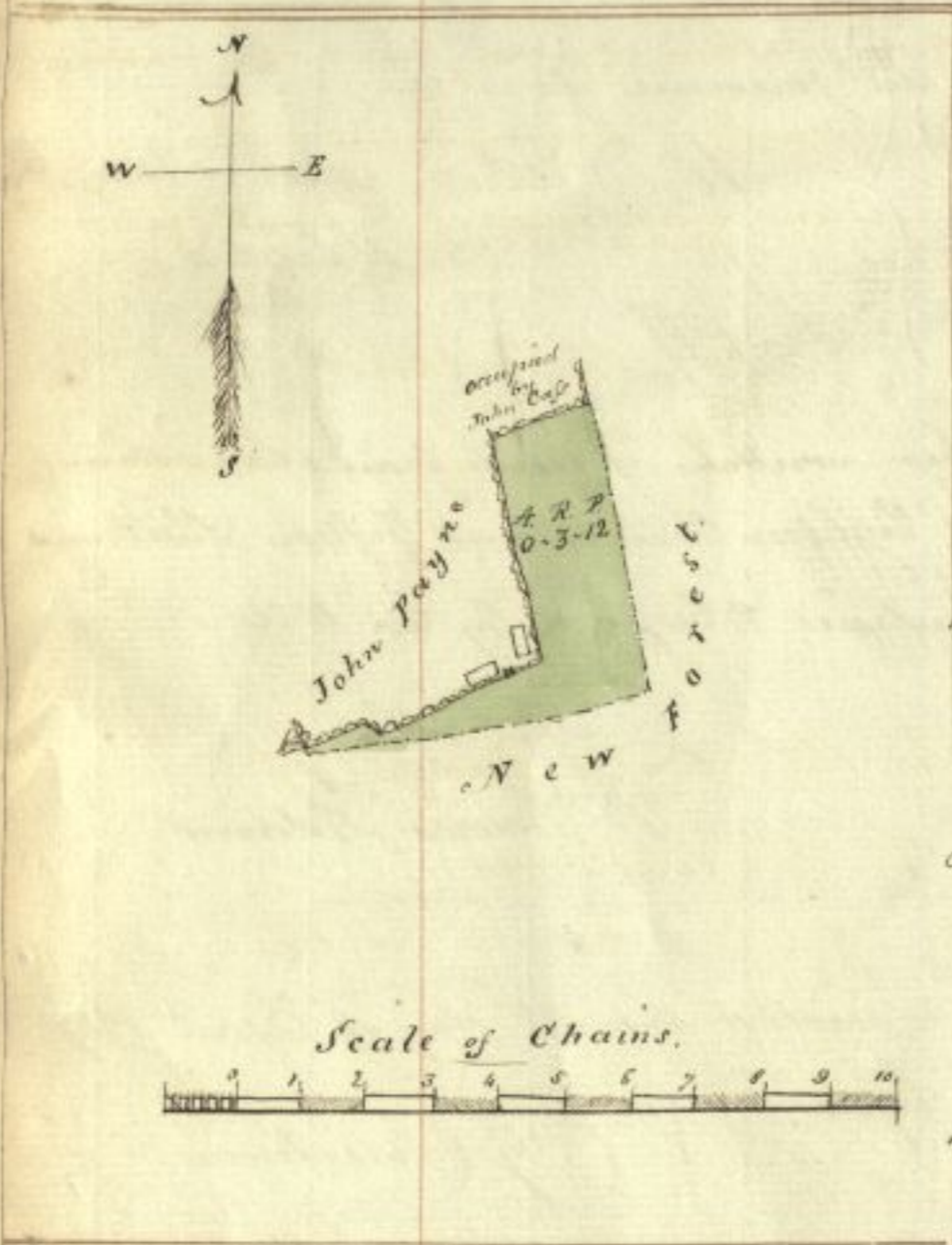

the Third Cap: 161. Sect: 6, to be of the value in fee Simple of Nineteen Pounds and fifteen Shillings To have and to hold the said piece or parcel of Land hereby bargained and sold or expressed and

intended

intended so to be and all benefit and advantage thereto belonging unto and to the use of him the said John Payne his Heirs and assigns for ever In witness whereof the said Charles Arbutnot and William Dacres Adams have hereunto set their hands and seals this twelfth day of April in the year of our Lord one thousand eight hundred and twenty seven.

C. Arbutnot J

Wm Dacres J. Adams

Signed Sealed and Delivered by the within named Charles Arbutnot and William Dacres Adams in the presence of

W. D. White, Office of Woods & Whitehall

Received the day and year within written of and from the within named John Payne the Sum of Nineteen Pounds and fifteen Shillings being the consideration within mentioned to be paid by him to us -

Witness

W. D. White

C. Arbutnot

Wm Dacres Adams

Enrolled the 14th day of April 1827

before -

L. G. Christmas

J. Aud.