

R

Dean Forest
Easements.

1109.

Sir,

FILED

Office of Woods, &c
26th August 1893.Drain at Ruardean
Hill Board
SchoolRuardean Dean Forest
Hill Board SchoolDean Forest
Easements
Ruardean
Hill School
(Drainage)

To
Clerk to Forest application of the 28th Ult^o made through the
of Dean U D School Deputy Surveyor for permission to lay down
Board a drain through the waste land of the Forest
Permission and in reply I have to inform you that.
to lay down drain I am willing to allow the Forest of Dean
conditions stated U D School Board to lay down a drain
from Ruardean Hill Board School under
the waste land of the Forest as shown
by the red dotted line between the points
A and B on the accompanying tracing.

The permission to be during pleasure only
and the School Board to undertake to lay the
drain to the satisfaction of the Crown's Deputy
Surveyor to so use it as to prevent its becoming
a nuisance to make good any damage caused
by the putting down repair or taking up of
the drain and to pay an acknowledgment of 2⁰/₆
on the 1st September in each year during the
continuance of the permission.

You will be good enough to acknowledge
the receipt of this letter and undertake on behalf
of the Board that the conditions shall be observed
and that the sum of 2⁰/₆ shall be paid to Mr
Baylis, the Deputy Surveyor of Dean Forest on the
1st Nov^r.

G. S. Bradstock Esq:
Clerk to the Forest of
Dean U D School Board
Lunderford Glos:

I am, &c
Geo. Talley.

Traces

Astonbri

The
gra
tan

Dean Forest
Enclosures.
Ruardean
Hill School
page

The Office of the Forest of Dean U. D. School Board.
Ludersford, Gloucestershire
6th September 1893

Dean Forest 1109
Ruardean Hill Board School.

Sir,

Referring to my application of the 28th July last made through the Deputy Surveyor for permission to lay down a drain through the waste land of the Forest I have to acknowledge the receipt of your letter of the 24th ultimo stating that you are willing to allow the Forest of Dean U. D. School Board to lay down a drain from Ruardean Hill Board School under the waste land of the Forest as shown by the red line between the points A and B on the tracing which accompanied your letter and upon the condition stated in such letter.

I am directed by my Board to undertake on their behalf that the conditions named by you shall be observed and I am forwarding the sum of 2/6 to Mr Baylis, the Deputy Surveyor of Dean Forest by this post.

George Culley Esq.
Commissioner of Woods &
Office of Woods, Whitehall
London W

I am, &c
(sd) J S Bradstock
Clerk

of your
the
down
Forest
that
of Dean
drain
under
own
points
only
my the
only
omitting
could
H
edge
delay
owed
Mr
part of the
on ad

The
part of the
of the

1893

Dean Forest
Enclosures.
Ruardean
Hill School
Drainage

The Office of the Forest of Dean U.D. School Board.
Ludersford Gloucestershire
6th September 1893

Dean Forest 1109

Ruardean Hill Board School

Sir,

Referring to my application of the 25th July last made through the Deputy Surveyor for permission to lay down a drain through the waste land of the Forest I have to acknowledge the receipt of your letter of the 21st ultimo stating that you are willing to allow the Forest of Dean U.D. School Board to lay down a drain from Ruardean Hill Board School under the waste land of the Forest as shown by the red line between the points A and B on the tracing which accompanied your letter and upon the condition stated in such letter.

Traced from Ordnance Sheet XXXI.2.

I am directed by my Board to undertake on their behalf that the conditions named by you shall be observed. I am forwarding the sum of 2/6 to Mr. Bayles, the Deputy Surveyor of Dean Forest by the post.

George C. Bayles Esq
Commissioner of Woods
Office of Woods
London W

J. S. Bradstock Esq
Ruardean Hill Inclosure

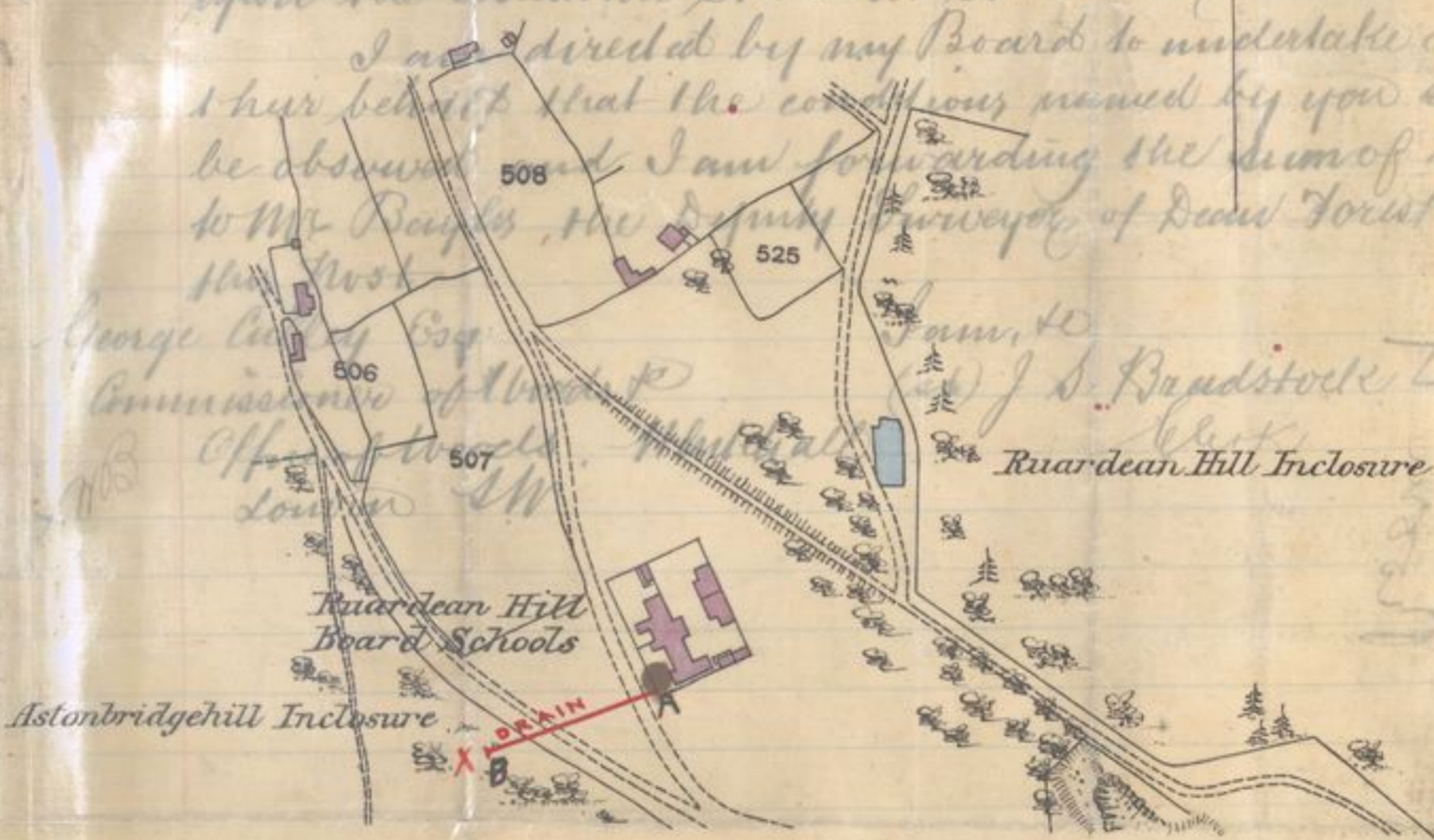

The Glos. Education Committee have been granted permission to maintain a septic tank at the spot marked X. with the payment of additional acknowledgment.
See F 621/10 File 948

Scale

Links 100 5 10 Chains

[Handwritten signature]
16/9/93

How
Enrols 2002. Dublin 1856

Crown Plan	Description of Land inclosed	Quantity			Name of Occupier	Yearly Rent			Purchase Money			Cost of Agreement and Conveyance
		A.	R.	P.		£	s.	d.	£	s.	d.	
Ribbin 1856	2002 An Enroachment in the Meadean tract in Dean Forest	—	—	5	John Meade	—	26	—	210	—	—	£100

By the Commissioner of Woods, Forests, and Land Revenues, in charge of Her Majesty's Forest of Dean.

I, the undersigned, do hereby give you notice either to attorn Tenant to Her Majesty in respect of the Lands specified in the Schedule to this Notice (which have been inclosed from the Wastes of the Forest of Dean in the County of Gloucester) at the yearly rent in the said Schedule mentioned, or else to purchase Her Majesty's interest in the said Lands at the price also mentioned in such Schedule.

This Notice does not apply to the right to the mines, minerals and substrata within, under, and upon such lands, which right is reserved to Her Majesty with full power for all persons lawfully entitled so to do, to enter upon the said lands and to work the said mines, minerals and substrata; and there is also reserved the right to work through or by means of the said lands any other mines, minerals and substrata belonging to Her Majesty, beyond the limits of the same lands.

The letting or sale will also be subject to the rights of the free miners of the Forest of Dean, and to the provisions of the Acts of Parliament relating thereto.

In the event of your not returning this Notice to me with one or other of the forms of Agreement hereunto annexed for renting or purchasing Her Majesty's interest in the said Lands, signed, within a month from the date of this Notice, I shall place the matter in the hands of the Solicitor to this Department.

The Conveyance, and the reservations therein of the minerals and substrata, with the rights of working, will be in the customary form adopted in the office of Woods, Forests and Land Revenues.

Geo Fulley
Commissioner of Woods, Forests,
and Land Revenues

17th October 1892

John Henrichs
Greenbottom
near Little Dean

3376-250-2-90

Schedule 2002. 27th Nov 1856

16a

Form of A

right of H
annexed, a
to the rese
as yearly
time on a
And I her
said Land
usually ad

ie Culley, E
Commis

Form of

as Her Cr
and I her
(subject t
which I t
Revenues
Agreeme
hereby fu
lands (su

P
A
-R

Culley,
Commis

N.E
tion of t

Crown Plan	Description of Land inclosed	Quantity			Name of Occupier	Yearly Rent			Purchase Money			Cost of Agreement and Conveyance	
		A.	R.	P.		£	s.	d.	£	s.	d.		
Rebbin 1856													
2002	An Encroachment in the Dean Wack in Dean Forest			5	John Stembly			26			210		£1000

By the Commissioner of Woods,
Forests, and Land Revenues, in
charge of Her Majesty's Forest
of Dean.

give you notice either to attorn Tenant to
ified in the Schedule to this Notice (which
Forest of Dean in the County of Gloucester)
mentioned, or else to purchase Her Majesty's
mentioned in such Schedule.

the right to the mines, minerals and substrata
which right is reserved to Her Majesty with full
so to do, to enter upon the said lands and to
strata; and there is also to be reserved the right
of the said lands any other mines, minerals and
beyond the limits of the same lands.

be subject to the rights of the free miners of the
of the Acts of Parliament relating thereto.

returning this Notice to me with one or other of the
for renting or purchasing Her Majesty's interest
month from the date of this Notice, I shall place
or to this Department.

reservations therein of the minerals and substrata,
in the customary form adopted in the office of

Stidell
Ditch
underford
Glos

Stapleton
Commissioner of Woods, Forests,
and Land Revenues

17th October 1892

Form of Agreement to be dated and signed if the person in possession desires to rent his encroachment.



I, the undersigned, do hereby acknowledge and admit that Her Majesty, in right of Her Crown, is seized of and entitled to the Lands specified in the Schedule hereunto annexed, and I do hereby attorn Tenant to Her Majesty in respect of the same Lands (subject to the reservations mentioned in the notice hereunto annexed), and I agree to hold the same as yearly Tenant from the Tenth day of October 1892 (determinable at any time on a three months' notice), at the annual rent of £ 2.0 which I agree to pay. And I hereby further agree to execute, if required, an agreement in duplicate for renting the said Lands (subject to the reservations aforesaid) at the aforesaid annual rent, in the form usually adopted by you in similar cases.

Dated this 24 day of November 1892

Enclosed is 2/6 the rent for Oct

John Culley, Esq.,
Commissioner of Woods.

Signed John Herms

Form of Agreement to be dated and signed if the person in possession desires to purchase Her Majesty's Interest in the encroachment.

I, the undersigned, do hereby acknowledge and admit that Her Majesty, in right of Her Crown, is seized of and entitled to the Lands specified in the Schedule hereunto annexed, and I hereby agree to purchase the Estate and Interest of Her Majesty in the same Lands (subject to the reservations mentioned in the annexed notice) for the sum of £ 2.10. which I undertake to pay to the Commissioners of Her Majesty's Woods, Forests, and Land Revenues, with £ for arrears of Rent, and £ 1. for the cost of the Agreement and Conveyance to me, on or before the 21st day of Nov 92. And I hereby further agree to accept and, if required, to execute a conveyance in duplicate of the said lands (subject to the aforesaid reservations) in the form usually adopted by you in similar cases.

Dated this 22nd day of November 1892

Purchase Money . . . £ 2 10 =
Agreement & Conveyance £ 1 = =
-Rent- £
TOTAL £ 3 10 =

John Culley, Esq.,
Commissioner of Woods.

Edith Herms
House Keeper
Newland Vicarage
Worcester

N.B.—It is requested that the Christian names, the address, and the profession or occupation of the person to whom the conveyance is to be made, may be given in full.

Woods,
Forest

tenant to
(which
Gloucester)
Majesty's

substrata
with full
and to
the right
erals and

s of the
hereto.

ther of the
s interest
hall place
substrata,
office of

John Culley

Woods, Forests,
ues

1892

John Kendal
 Attorney General
 October 2/6 1851
 P.S. P. 14 11/2
 Nov: 24/92
 London

Refer to Sir James Campbell
 request him to be good
 enough send a receipt
 for this amt. of shillings
 the amount in the
 of account receivable
 by the
 26/10/92
 26/10/92
 Receipt to cash accordingly
 R. M. 28/92
 To the order
 J. P. 10/11/92

OFFICE
 OF THE
 COMMISSIONER
 OF THE
 WOODS,
 &c.

On Her Majesty's Service.

George Colley, Esq.,
 Commissioner of Woods, &c.,
 Office of Woods, &c.

Encl: 2002. Within 1856

How

Mrs Elizabeth Frindle
Stroms Street

S.W.
Nw:10/92

Post
London
18/11/92

Refer to Ref: S.W. 10/92

Office of Woods, &c.,
Commissioner of Woods, &c.,
George Valley, Esq.,

George Valley, Esq.,

**By the Commissioner of Woods,
Forests, and Land Revenues, in
charge of Her Majesty's Forest
of Dean.**

I, the undersigned, do hereby give you notice either to attorn Tenant to Her Majesty in respect of the Lands specified in the Schedule to this Notice (which have been inclosed from the Wastes of the Forest of Dean in the County of Gloucester) at the yearly rent in the said Schedule mentioned, or else to purchase Her Majesty's interest in the said Lands at the price also mentioned in such Schedule.

This Notice does not apply to the right to the mines, minerals and substrata within, under, and upon such lands, which right is reserved to Her Majesty with full power for all persons lawfully entitled so to do, to enter upon the said lands and to work the said mines, minerals and substrata; and there is also to be reserved the right to work through or by means of the said lands any other mines, minerals and substrata belonging to Her Majesty, beyond the limits of the same lands.

The letting or sale will also be subject to the rights of the free miners of the Forest of Dean, and to the provisions of the Acts of Parliament relating thereto.

In the event of your not returning this Notice to me with one or other of the forms of Agreement hereunto annexed for renting or purchasing Her Majesty's interest in the said Lands, signed, within a month from the date of this Notice, I shall place the matter in the hands of the Solicitor to this Department.

The Conveyance, and the reservations therein of the minerals and substrata, with the rights of working, will be in the customary form adopted in the office of Woods, Forests and Land Revenues.

Handwritten initials

To

*Mrs Elizabeth Gaudell
Trow Ditch
near Cinderford
Glos*

Handwritten signature: J. Fuller
Commissioner of Woods, Forests,
and Land Revenues

17th October 1892

*John Gaudell
Attorn Tenant*

Enrolle 2002. Dublin 1856

How

THE SCHEDULE referred to in the foregoing Notice.

No. on Crown Plan	Description of Land inclosed	Quantity			Name of Occupier	Yearly Rent			Purchase Money			Cost of Agreement and Conveyance
		A.	R.	P.		£	s.	d.	£	s.	d.	
Dublin 1856	The Encroachment in Littledean Walk in Dean Street				Elizabeth Grindle	5	5	5	5			£1. 4. 8
1974					I have agreed to pay a year rent for it until I can purchase it yours Truly Elizabeth Grindle Collow Field							



Form of Agreement to be dated and signed if the person in possession desires to rent his encroachment.

I, the undersigned, do hereby acknowledge and admit that Her Majesty, in right of Her Crown, is seized of and entitled to the Lands specified in the Schedule hereunto annexed, and I do hereby attorn Tenant to Her Majesty in respect of the same Lands (subject to the reservations mentioned in the notice hereunto annexed), and I agree to hold the same as yearly Tenant from the Tenth day of October 1892 (determinable at any time on a three months' notice), at the annual rent of £ 5, which I agree to pay. And I hereby further agree to execute, if required, an agreement in duplicate for renting the said Lands (subject to the reservations aforesaid) at the aforesaid annual rent, in the form usually adopted by you in similar cases.

Dated this 10 day of Nov 1892

To George Culley, Esq.,
Commissioner of Woods.

Mrs Elizabeth Grindle
Callowfield Little Dean
St Newham

Form of Agreement to be dated and signed if the person in possession desires to purchase Her Majesty's Interest in the encroachment.

I, the undersigned, do hereby acknowledge and admit that Her Majesty, in right as Her Crown, is seized of and entitled to the Lands specified in the Schedule hereunto annexed, and I hereby agree to purchase the Estate and Interest of Her Majesty in the same Lands (subject to the reservations mentioned in the annexed notice) for the sum of £ 5, which I undertake to pay to the Commissioners of Her Majesty's Woods, Forests, and Land Revenues, with £ for arrears of Rent, and £ 1 for the cost of the Agreement and Conveyance to me, on or before the 21st day of Nov 1892. And I hereby further agree to accept and, if required, to execute a conveyance in duplicate of the said lands (subject to the aforesaid reservations) in the form usually adopted by you in similar cases.

Dated this day of 189 .

Purchase Money . . .	£ 5 = =
Agreement & Conveyance	£ 1 = =
Rent	£
TOTAL	£ 6 = =

To George Culley, Esq.,
Commissioner of Woods.

N.B.—It is requested that the Christian names, the address, and the profession or occupation of the person to whom the conveyance is to be made, may be given in full.

Mrs Elizabeth Frindle
 Atholmount
 S.W.
 Nw 10/92
 London,

Received of the
 Office of Woods, &c.,
 Commissioner of Woods, &c.,
 Office of Woods, &c.,
 London,

1819
 On Her Majesty's Service.
 Received of the
 Office of Woods, &c.,
 Commissioner of Woods, &c.,
 Office of Woods, &c.,
 London,

1814
 Received of the
 Office of Woods, &c.,
 Commissioner of Woods, &c.,
 Office of Woods, &c.,
 London,

To the credit
 of the
 Office of Woods, &c.,
 Commissioner of Woods, &c.,
 Office of Woods, &c.,
 London,

Encl: 2002. within 1856

[Faded handwritten text, possibly a list or ledger entry, mostly illegible due to fading and bleed-through.]

How

Dean Forest

Advertisement

Board near

Cinderford

Re & Pro

Deputy Surveyor

Declining

needs to apply

to extend term

acknowledged

of 5th year

before for

present board

Encroachments

No 239 House

Mrs Slingsby

Stroms Lane

Printed on Paper

1819

London

192

Report to the

Commissioner of Woods, &c.,

Office of Woods, &c.,

B

Dean
Advocate
Board
Cinderford
Re & J
Deputy
Decline
wade
to attend
Facknoss
of 5th year
be paid
present bo

By the Commissioner of Woods,
Forests, and Land Revenues, in
charge of Her Majesty's Forest
of Dean.

I, the undersigned, do hereby give you notice either to attorn Tenant to Her Majesty in respect of the Lands specified in the Schedule to this Notice (which have been inclosed from the Wastes of the Forest of Dean in the County of Gloucester) at the yearly rent in the said Schedule mentioned, or else to purchase Her Majesty's interest in the said Lands at the price also mentioned in such Schedule.

This Notice does not apply to the right to the mines, minerals and substrata within, under, and upon such lands, which right is reserved to Her Majesty with full power for all persons lawfully entitled so to do, to enter upon the said lands and to work the said mines, minerals and substrata; and there is also to be reserved the right to work through or by means of the said lands any other mines, minerals and substrata belonging to Her Majesty, beyond the limits of the same lands.

The letting or sale will also be subject to the rights of the free miners of the Forest of Dean, and to the provisions of the Acts of Parliament relating thereto.

In the event of your not returning this Notice to me with one or other of the forms of Agreement hereunto annexed for renting or purchasing Her Majesty's interest in the said Lands, signed, within a month from the date of this Notice, I shall place the matter in the hands of the Solicitor to this Department.

The Conveyance, and the reservations therein of the minerals and substrata, with the rights of working, will be in the customary form adopted in the office of Woods, Forests and Land Revenues.

K.W.

To

Mr S Brain
Bateocks Bailey
near Little Dean

Joseph Alley
Commissioner of Woods, Forests,
and Land Revenues

17th October 1892

3.
in to
to
in Crown
Poe
of 10%
any
icate
ford.
1893.
that I
in
of

THE SCHEDULE referred to in the foregoing Notice.

No. on Crown Plan	Description of Land inclosed	Quantity			Name of Occupier	Yearly Rent			Purchase Money			Cost of Agreement and Conveyance
		A.	R.	P.		£	s.	d.	£	s.	d.	
1834	An Encroachment											
239	in Little Dean Walk			22	Mr Brain			11				
1126	in Dean Forest											£1. 10. 25

Dean Forest
 Advertisement
 Board near
 Underford
 Re & F. Roe.
 Deputy Surveyor
 Declining
 need to apply
 to extend board
 Acknowledged
 of 5^s a year shall
 be paid for
 present board

[Handwritten signature]



Form of Agreement to be dated and signed if the person in possession desires to rent his encroachment.

I, the undersigned, do hereby acknowledge and admit that Her Majesty, in right of Her Crown, is seized of and entitled to the Lands specified in the Schedule hereunto annexed, and I do hereby attorn Tenant to Her Majesty in respect of the same Lands (subject to the reservations mentioned in the notice hereunto annexed), and I agree to hold the same as yearly Tenant from the Tenth day of October 1892 (determinable at any time on a three months' notice), at the annual rent of £ = " 11 " = which I agree to pay. And I hereby further agree to execute, if required, an agreement in duplicate for renting the said Lands (subject to the reservations aforesaid) at the aforesaid annual rent, in the form usually adopted by you in similar cases.

Eliza Brain

Dated this 14 day of November 1892

To George Culley, Esq., Commissioner of Woods.

Form of Agreement to be dated and signed if the person in possession desires to purchase Her Majesty's Interest in the encroachment.

I, the undersigned, do hereby acknowledge and admit that Her Majesty, in right as Her Crown, is seized of and entitled to the Lands specified in the Schedule hereunto annexed, and I hereby agree to purchase the Estate and Interest of Her Majesty in the same Lands (subject to the reservations mentioned in the annexed notice) for the sum of £ 11 " = which I undertake to pay to the Commissioners of Her Majesty's Woods, Forests, and Land Revenues, with £ " " for arrears of Rent, and £ 1 " 10 " for the cost of the Agreement and Conveyance to me, on or before the 21st day of Nov 1892. And I hereby further agree to accept and, if required, to execute a conveyance in duplicate of the said lands (subject to the aforesaid reservations) in the form usually adopted by you in similar cases.

Dated this day of 189

Purchase Money	£ 11	= =
Agreement & Conveyance	£ 1 10	=
Rent	£	
TOTAL	£ 12 10	=

To George Culley, Esq., Commissioner of Woods.

N.B.—It is requested that the Christian names, the address, and the profession or occupation of the person to whom the conveyance is to be made, may be given in full.

Dean J. Advertiser Board n Underfor Re & T Deputy S. Declin needs to ay to attend fact know of 5 a ye beyond present bo

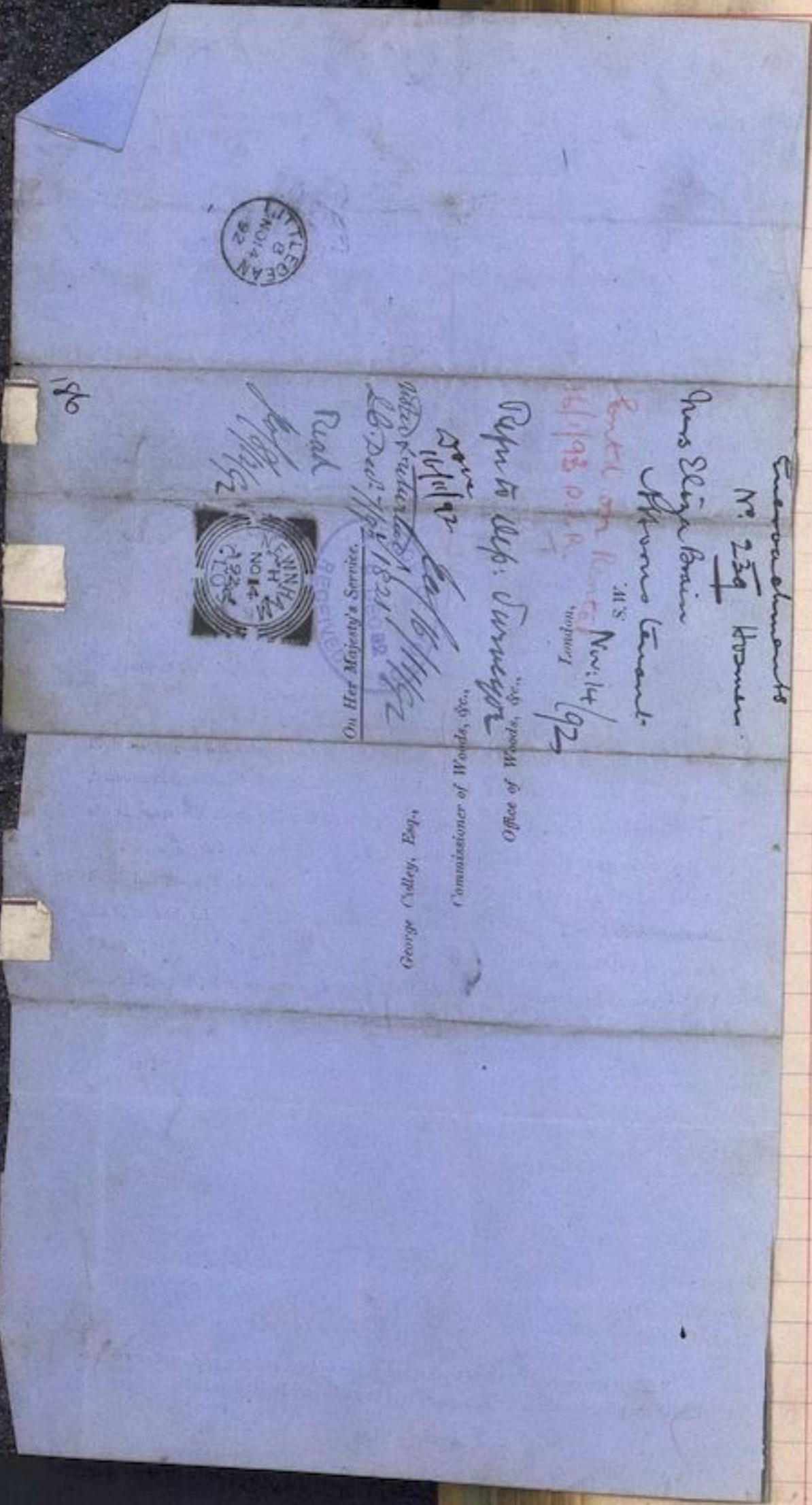

Dear
 Board
 Underfo
 Re: 6
 Deputy
 Dele
 made
 to calen
 Yachm
 of 5^o
 hepen
 presom

R

Dean Forest.

Advertisement

Board near

Cinderford

Re E. F. Roe.

Deputy Surveyor

Declining to

accept applicatⁿ

to extend board

acknowledgm^tof 5^s a year should

be paid for

present board

To The Deputy Surveyor,

By direction of Mr George Sulley I am to

inform you that he does not feel it desirable to

accede to E. F. Roe's request to extend the

advertisement board which he has erected on Crown

land. With regard to the existing board Roe

should pay an annual acknowledgment of 10^s/

and undertake in writing to remove it at any

time on one month's notice.

You will be good enough to communicate

accordingly with Roe and report the result.

J Russell Surveyor.

High Street, Cinderford.

Gloucestershire.

Aug: 21st 1893.

Dear Sir,

In reply to your letter I beg to state that I will accept the conditions stated therein in reference to my advertising station at foot of Mount, High Street, Cinderford.

Yours obediently
Edwin F. Roe.

Philip Baylis Esq.
Whitehead Park,
Parkend.

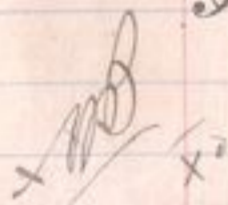

R

Dean Forest 1248
 Casements
 Recreation Ground
 at Oldcroft.

Office of Woods &c
 27th September 1893

Mess^{rs} Elsom
 & Morse.

Permission to
 use piece of
 ground.

Gentlemen,
 Dean Forest
 In reply to ^{the} Memorial signed by
 inhabitants of Yorkley Viney Hill and Oldcroft I
 have to inform you that this Department is
 willing to grant to you on behalf of the
 inhabitants of the above district, permission for
 such inhabitants to use the piece of land coloured
 pink on the annexed tracing for the purposes of
 Cricket, football and other recreation and also to
 fence in a portion of such ground for a cricket
 pitch subject to the payment of an annual
 acknowledgment of 5^s in advance on the 1st
 October in each year during which the permission
 continues.

The permission will be during pleasure
 and may be put an end to at any time.

I have to request that you will be
 good enough to sign and return the enclosed letter
 accepting the permission on the above terms.

Yours
 J. M. Duncan

J. M. Duncan
 Chief Forester

Mess^{rs} Sydney J. Elsom
 & Wm. Morse.
 of Revd. S. J. Elsom & Co.
 Yorkley.

Sir,

Yorkley.
 Sept. 30th 1893.

We beg to accept your offer of permission
 for the Inhabitants of Yorkley Viney Hill, and Oldcroft
 to use the piece of land shown on the tracing annexed
 to your letter for the purposes of cricket, football and
 other recreation on the conditions therein specified and
 we undertake to pay the annual acknowledgment of 5^s
 during the continuance of such permission.

Your obedient Servants.

Sydney Elsom
 William Morse &

To
 Col. Sir R. N. Kingscote K.C.B.

Dear Sir

Little Dean

11/11/1893

Scale 3 1/4" Chains to an Inch

Dean Forest

Littledean W^{ts}

W^m Walding
Attorning
Tenant

10th Sept 92

File 969 3/3

I the undersigned William Walding do hereby acknowledge and admit that Her Majesty in right of Her Crown is seized of or entitled to the Messuage Tenement or Dwelling House Buildings and premises now in my occupation at Broadmoor in Littledean Walk in the Forest of Dean and County of Gloucester And I do hereby attorn Tenant to Her Majesty in respect of the same premises and I agree to hold the same under a Lease or to purchase a piece of land elsewhere at such price as may be agreed on, instead of taking a lease

William Walding

Witness *William Christie*
Forest Keeper

Herbert Lodge

Dated this 10th day
of September 1892

Dean Forest

Littledean W^{ts}

11m 11/11/11
11/11/11

File 969 3/3

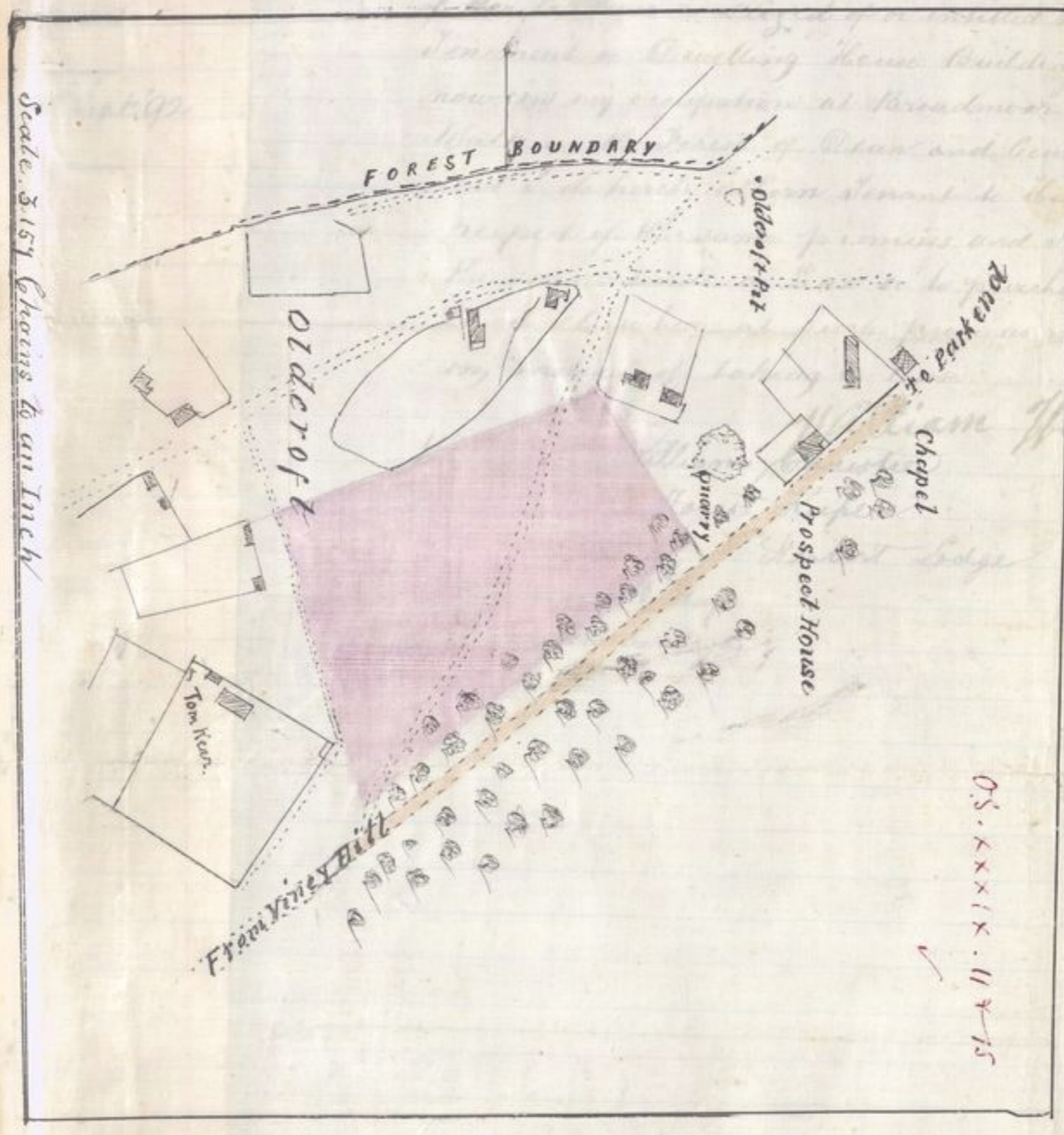

Copy of the plan sent to the Office on the 17th of June 1848 dated 27 April 1845

OS. XXXIX. 117-75

1893
 I
 es
 for
 lowed
 uses of
 d lbo to
 cricket
 1st
 mission
 aware
 ll be
 sed letter
 5.
 93.
 mission
 Oldcroft
 annuad
 ll and
 fied and
 out of 5%

Dean Forest

Littledean W^o

Ch^s Boynton
Attorning
tenant

10th Sept 1892

314.

Bv File 969

I the undersigned Charles Boynton do hereby acknowledge and admit that Her Majesty in right of Her Crown is seized of or entitled to the Messuage Tenement or Dwelling House Buildings and Premises now in my occupation at Broadmoor in Littledean Walk in the Forest of Dean and County of Gloucester And I do hereby attorn tenant to Her Majesty in respect of the same premises.

And I agree to hold the same premises under a Lease from the Commissioner of Woods for a term of fifteen years from the 24th day of June 1892 at the Annual rent of Ten shillings,

Which I hereby agree to pay half yearly on the 25th day of December and the 24th day of June in each year, the first half yearly payment to be made on the 25th day of December 1892

And I do hereby further agree to execute any Lease or document based upon the terms of this attornment, when called upon.

Mark of

Charles + Boynton

Witness William Christie

Forest Keeper Herbert Lodge

Dated this 10th day
of September 1892

x MB

For Lucia to Russell see page 15th ante.

3/5

Forest

Instrument of License granted to
by Indenture dated 23rd July

Indenture dated the 25th day of
between Alfred James Russell (herein
the one part and Richard Thomas Esq
Office is at Sydney in the County of
the other part.

the Lessor demises unto the Lessees
at Lydbrook known as Waterloo
License and authority granted unto
dated the 23rd day of July 1892
Her Majesty of the
Esquire the Commissioner of the
of the third part to use and
with and for the purposes of the
purpose the waters of the ponds
Watercourses in the said Forest of
water to the said Mill as delineated
on the plan drawn in the margin
use Together also with the use of
laid down for the purpose of
at Mill from the said Ponds and
indicated and shown by blue lines
for the term of 21 years from
holding and paying the annual
for payment of rent and to
entry on breach
said Alfred James Russell and

Attest
1892
Wm. 1892

1892
Wm. 1892

Dean Forest

Docquet of Assignment of License granted to Alfred James Russell by Indenture dated 23rd July 1892.

Whereas by an Indenture dated the 25th day of February 1893 made between Alfred James Russell (therein described) the lessor of the one part and Richard Thomas & Co Limited, whose registered Office is at Sydney in the County of Gloucester the lessee of the other part.

It is witnessed that the Lessor demises unto the Lessee All that Flax Mill at Lydbrook known as Waterloo Mill together with the license and authority granted unto the Lessor by an Indenture dated the 23rd day of July 1892 and made between the Queen's Most Excellent Majesty of the first part George Leyley Esquire the Commissioner of the second part and the Lessor of the third part to use and appropriate in connection with and for the purposes of the said Mill but for no other purpose the waters of the ponds or pools and Streams and Watercourses in the said Forest of Dean which now supply water to the said Mill as delineated and shown by a blue colour on the plan drawn in the margin of such Indenture of License together also with the use of the siphon or pipe as now laid down for the purpose of conveying water to the said Mill from the said Ponds and Watercourses and as also indicated and shown by blue on the said plan To hold & for the term of 21 years from 15th February 1893. Yielding and paying the annual rent of £25. - Covenants for payment of rent and to repair. Proviso for reentry on breach

Duly Executed by the said Alfred James Russell and attested.

xmb