

Dated 31st October 1867.

His Indenture made the thirty first day of October One thousand eight hundred and sixty seven **Between Samuel James Parkhurst Nicoll** of Devonport in the County of Devon Esquire of the first part **Phillis Nicoll** of Begnor in the County of Sussex Widow and Relict of the late Samuel John Nicoll Esquire of Lynnhurst in the County of Southampton of the second part **The Honorable James Kenneth Howard** (the Commissioner of Her Majesty's Woods Forests and Land Revenues to whom the management and direction of certain parts of the Land Revenues of the Crown including among other parts thereof the New Forest in the County of Southampton with the duties and powers appertaining thereto have been assigned by an Order under the hands of two of the Commissioners of Her Majesty's Treasury) of the third part and **The Queen's Most Excellent Majesty** of the fourth part **Whereas** the said Samuel John Nicoll was in his lifetime seized for an estate in fee simple of the freehold Land and hereditaments hereinafter described and intended to be hereby conveyed and by an Indenture of Lease dated the twenty first day of April One thousand eight hundred and twenty one and made between the said Samuel John Nicoll of the one part and Edward Gilbert of Lynnhurst aforesaid Esquire of the other part the said Samuel John Nicoll for the considerations therein mentioned demised part thereof containing Three acres and eight perches hereinafter particularly mentioned to the said Edward Gilbert for the term of thirty nine years if the said Edward Gilbert should so long live at a rent of a pepper corn **And whereas** under and by virtue of the Will of the said Samuel John Nicoll dated the ninth day of February One thousand eight hundred and forty nine and proved in the Prerogative Court of Canterbury on the second day of December One thousand eight hundred and fifty the said Samuel James Parkhurst Nicoll is now entitled for an estate in fee simple to the said freehold land and hereditaments subject to the right or title to dower of the said Phillis Nicoll in or out of the same **And whereas** the said James Kenneth Howard for and on behalf of Her Majesty and with the consent of the Lords Commissioners of Her Majesty's Treasury signified by a Warrant under the hands of two of them dated the thirty first day of July One thousand eight hundred and sixty seven has agreed with the said Samuel James Parkhurst Nicoll for the purchase of the said freehold lands and hereditaments subject to the Lease aforesaid for the sum of Two hundred and ninety nine pounds **And whereas** the said Phillis Nicoll has agreed to join in these Presents for the purpose of releasing all her claim or title to dower in or out of the said freehold hereditaments **Now this Indenture witnesseth** that for effectuating the said agreement and in consideration of the sum of Two hundred and ninety nine pounds

New Forest

Samuel J^r

Parkhurst

Nicoll Esq^r

and another

to

Her Majesty

Conveyance

of freehold lands

at Lynnhurst in

the County of

Southampton

unto

the

of

at or before the execution of these presents paid by the said James & Kenneth Howard to the said Samuel James Parkhurst Nicoll (the receipt of which said sum of Two hundred and ninety nine pounds the said Samuel James Parkhurst Nicoll doth hereby acknowledge and from the same doth hereby release and for ever discharge the said James Kenneth Howard his heirs executors and admors and also the Queens Majesty her heirs and successors The said James Samuel Parkhurst Nicoll Doth by these Presents Grant and Convey And the said Phillis Nicoll Doth hereby grant and release unto the Queen Most Excellent Majesty her heirs and successors **All these** freehold lands and hereditaments containing altogether three acres three roods and four perches situate at or near Lydhurst in the County of Southampton particularly described in the Schedule to these presents and also delineated on the Plan drawn in the margin of these presents and thereon colored Red Together with all buildings yards gardens trees woods underwoods mines minerals quarries walls fences hedges ditches commons ways watercourses drains rights privileges easements and appurtenances whatsoever to the said Lands and hereditaments belonging or with the same or any part thereof now or at any time heretofore demised held or enjoyed or reputed as parcel thereof or appurtenant thereto And all the estate right title possibility claim and demand whatsoever both at law and in equity of the said Samuel James Parkhurst Nicoll and Phillis Nicoll respectively in to or out of the said lands and hereditaments To have and to hold the said Lands and hereditaments (subject nevertheless as regards that portion of the said Lands and hereditaments containing together three acres and eight perches described in the said Schedule as pt. 157 and part of pt. 159 to the aforesaid Lease thereof for a term of Ninety nine years if the said Edward Gilbert should so long live at a peppercorn rent granted by the said Indenture of the twenty first day of April One thousand eight hundred and twenty one) unto Her said Majesty her heirs and successors for ever in right of Her Crown And the said Samuel James Parkhurst Nicoll doth hereby for himself his heirs executors and admors covenant with the Queen's Majesty her heirs and successors that notwithstanding any act deed or thing by him the said Samuel James Parkhurst Nicoll or by the said Samuel John Nicoll deceased done or executed or knowingly or willingly suffered to the contrary He the said Samuel James Parkhurst Nicoll now is seized of for an estate in fee simple in possession or otherwise sufficiently entitled to the said freehold lands and hereditaments hereinbefore conveyed or expressed and intended so to be and every part thereof and now hath full power to convey the same and every part thereof in manner aforesaid free from all incumbrances except the said Lease thereof hereinbefore mentioned And further that he the said Samuel James

M. H.
MCE.
— Ref
Part of 149 on 1
— " 146 —
157 & part of 1

Parkhurst Nicoll his heirs executors and admors and all other persons lawfully claiming or to claim through from or under the said Samuel John Nicoll deceased shall and will at all times hereafter upon the request and at the costs of Her said Majesty her heirs or successors make do and execute or procure to be made done & executed all such further acts deeds conveyances and assurances for the better and more absolutely conveying and assuring the said freehold lands and hereditis hereinbefore conveyed or expressed and intended so to be or any part thereof unto Her said Majesty her heirs and successors as shall by her them or any of them be reasonably required. And the said James Kenneth Howard doth hereby direct that this Deed shall be deemed to be sufficiently enrolled by the deposit of a duplicate thereof in the Office of Land Revenue Records and Inrolments and the filing or making an entry of such deposit by the Keeper of the said Records and Inrolments. *IN WITNESS* whereof the said parties to these presents have hereunto set their hands and seals the day and year first above written.

The Schedule above referred to.

N ^o on map	Description	Quantity		
		A	R	P
157 and part of 157	Freehold Meadow	3	0	8
part of 149	Shrubbery	"	"	16
part of 116	Pasture	"	2	20
		3	3	4

J. J. P. Nicoll (S) Phillis (S) Nicoll. James K (S) Howard

Signed sealed and delivered by the within named Samuel James Parkhurst Nicoll in the presence of - George H. Russell, Solicitor, Devonport.

Signed sealed and delivered by the within named Phillis Nicoll in the presence of - William H. J. Nicoll - Brighton.

Signed sealed and delivered by the within named James Kenneth Howard in the presence of - George H. Bedford - Office of Woods &c

Received the day and year first within written of and from the within named James Kenneth Howard the sum of Two hundred and ninety nine pounds being the consideration money within expressed to be paid by him to me. L.S.

Witness - George H. Russell

J. J. P. Nicoll

I Certify that a duplicate of this deed has been deposited in the Office of Land Revenue Records and Inrolments and an entry thereof made or filed by me. H. G. Hewlett
Keeper of the Records.

10th January 1868

Parkhurst Nicoll his heirs executors and admors and all other persons lawfully claiming or to claim through from or under the said Samuel John Nicoll deceased shall and will at all times hereafter upon the request and at the costs of Her said Majesty her heirs or successors make do and execute or procure to be made done & executed all such further acts deeds conveyances and assurances for the better and more absolutely conveying and assuring the said freehold lands and hereditis hereinbefore conveyed or expressed and intended so to be or any part thereof unto Her said Majesty her heirs and successors as shall by her them or any of them be lawfully required.

Part of the Fleet LXXII. 2
 Manor of Lyndhurst
 M^r. R. Stride
 M^r. W.D. Taylor
 M^r. E.S. Ashby
 C^h. Egerston
 M^r. W.B. BUDGEN
 C. Castleman Esq^r
 Rev^d. R. Patteney

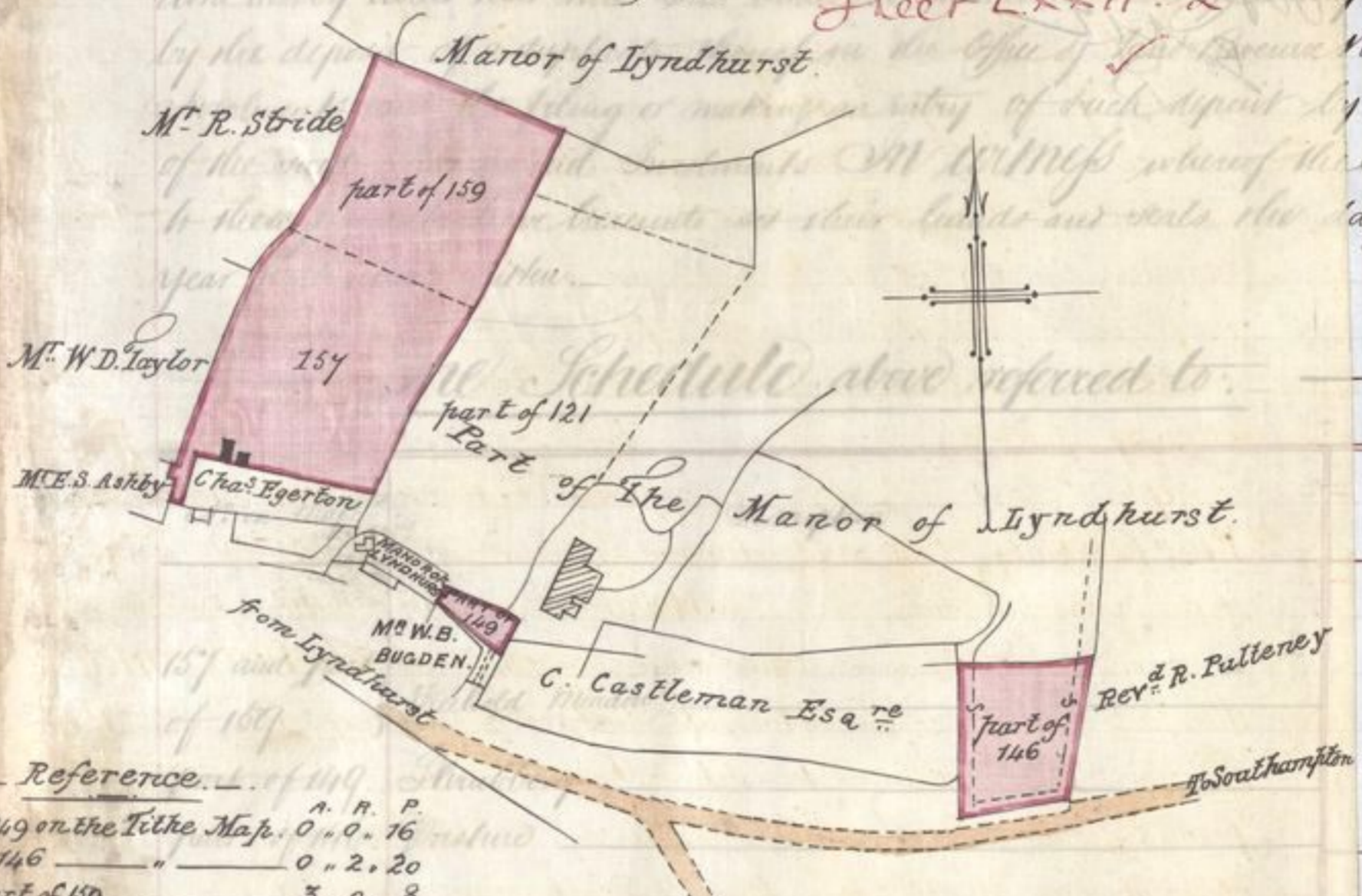

Quantity		
A	R	P
3	0	8
"	"	16
"	2	20
3	3	4

Reference

	A.	R.	P.
Part of 149 on the Tithe Map	0	0	76
" 146	0	2	20
157 & part of 159	3	0	8
Acres 3. 3. 4			

Scale, 3 Chains to an Inch.

Signed sealed and delivered by the within named Samuel James Parkhurst Nicoll in the presence of - George H. Russell, Solicitor, Devonport
 Signed sealed and delivered by the within named Phillis Nicoll in the presence of - William H. J. Nicoll - Brighton.
 Signed sealed and delivered by the within named James Kenneth Howard in the presence of - Geo. J. Bedford - Office of Woods &c

Received the day and year first within written of and from the within named James Kenneth Howard the sum of Two hundred and ninety nine pounds being the consideration money within expressed to be paid by him to me
 Witness - George H. Russell
 J. J. Nicoll

I Certify that a duplicate of this deed has been deposited in the Office of Land Revenue Records and Documents and an entry thereof made or filed by me.
 10th January 1863
 H. G. Newell
 Keeper of the Records.

Dated 4th
May 1868.

New Forest

The Hon^{ble}
J. K. Howard
a Commis^r of Her
Majesty's Woods &c

— and —

M^r. Aaron
Withers —

Agreement
for letting Bramore
Mead on a yearly
tenancy from 25th
March 1867. —

Memorandum of Agreement
made the 4th day of May 1868 Between The
Queen's Most Excellent Majesty of the first
part The Honorable James Kenneth Howard
a Commissioner of Her Majesty's Woods Forests and
Land Revenues of the second part and Aaron
Withers of Lyndhurst in the Parish of Lyndhurst
in the County of Southampton Brewer of the third
part.

The said James Kenneth Howard as such Commissioner as
aforesaid agrees to let to the said Aaron Withers who agrees to
take as yearly Tenant to Her Majesty from the twenty fifth day
of March One thousand eight hundred and sixty seven All that
piece or parcel of Meadow-land known as Bramore Mead situate at
Lyndhurst in the Parish of Lyndhurst in Her Majesty's New Forest
in the County of Southampton containing by admeasurement 5. 2. 2
and more particularly described in the plan drawn in the margin
of these presents reserving to the Crown all Timber and other trees
upon the said premises At the yearly rent of £20 payable half
yearly on the 25th day of March and the 29th day of September
in every year clear of all taxes and deductions And the said Aaron
Withers agrees to pay to Her Majesty the said yearly rent of £20 in
manner aforesaid and to pay all rates and taxes charges assessments
and outgoings in respect of the said premises (except income or
property tax) To keep and also to give up at the end of the Tenancy
the said piece or parcel of Meadow-land with all Landlords fixtures
in the said premises and all fences belonging to the said premises
in good and repairable repair And the said Aaron Withers agrees
to execute if required such further Agreement to be enrolled in the
Office of Land Revenue Records and Involvements as may be necessary for
confirming this Agreement and in the meantime to hold the said
premises as a yearly Tenant to Her Majesty upon the terms above mentioned
In witness whereof the said parties of the second and third
parts have hereunto subscribed their names.

Aaron Withers.

Witness

James Harold Roberts

Clerk to Deputy Surveyor

Dated 5th
May 1868
New Forest
The Hon^{ble}
J. K. Howard
Comm^r of Her
Majesty's Woods
and

Order
of
the
Crown
in
right
of
Her
Majesty
the
Queen
in
Parliament
assembled
under
the
great
Seal
of
Great
Britain
bearing
witness
that
the
said
Aaron
Withers
is
a
yearly
tenant
of
the
said
piece
or
parcel
of
Meadow-land
known
as
Bramore
Mead
situate
at
Lyndhurst
in
the
Parish
of
Lyndhurst
in
Her
Majesty's
New
Forest
in
the
County
of
Southampton
containing
by
admeasurement
5. 2. 2
and
more
particularly
described
in
the
plan
drawn
in
the
margin
of
these
presents
reserving
to
the
Crown
all
Timber
and
other
trees
upon
the
said
premises
At
the
yearly
rent
of
£20
payable
half
yearly
on
the
25th
day
of
March
and
the
29th
day
of
September
in
every
year
clear
of
all
taxes
and
deductions
And
the
said
Aaron
Withers
agrees
to
pay
to
Her
Majesty
the
said
yearly
rent
of
£20
in
manner
aforesaid
and
to
pay
all
rates
and
taxes
charges
assessments
and
outgoings
in
respect
of
the
said
premises
(except
income
or
property
tax)
To
keep
and
also
to
give
up
at
the
end
of
the
Tenancy
the
said
piece
or
parcel
of
Meadow-land
with
all
Landlords
fixtures
in
the
said
premises
and
all
fences
belonging
to
the
said
premises
in
good
and
repairable
repair
And
the
said
Aaron
Withers
agrees
to
execute
if
required
such
further
Agreement
to
be
enrolled
in
the
Office
of
Land
Revenue
Records
and
Involvements
as
may
be
necessary
for
confirming
this
Agreement
and
in
the
meantime
to
hold
the
said
premises
as
a
yearly
Tenant
to
Her
Majesty
upon
the
terms
above
mentioned
In
witness
whereof
the
said
parties
of
the
second
and
third
parts
have
hereunto
subscribed
their
names.

Dated 14th
May 1868.

New Forest

The Honble
J. K. Howard
a Commis^r of Her
Majesty's Woods &c

and

M^r. Aaron
Withers

Agreement
for letting Bramore
Mead on a yearly
tenancy from 25th
March 1867.

Memorandum of Agreement
made the 14th day of May 1868 Between The
Queen's Most Excellent Majesty of the first
part The Honorable James Kenneth Howard
a Commissioner of Her Majesty's Woods Forests and
Land Revenues of the second part and Aaron
Withers of Lyndhurst in the Parish of Lyndhurst
in the County of Southampton Brewer of the third
part.

The said James Kenneth Howard as such Commissioner as
aforesaid agrees to let to the said Aaron Withers who agrees to
take as yearly Tenant to Her Majesty from the twenty fifth day
of March One thousand eight hundred and sixty seven All that
piece or parcel of Meadow land situate in the Parish of Lyndhurst
in the County of Southampton containing by estimation 5 A. 2 R. 2
and more particularly described in the plan drawn in the margin
of these presents resting to the Crown and the said Aaron Withers
upon the said premises yearly on the 25th day of March 1867
in every year clear of all taxes and charges (except such as
Withers agrees to pay to Her Majesty the said yearly rent of 10/- in
manner aforesaid and to pay all rates and taxes charges assessments
and outgoings in respect of the said premises (except such as
property tax) To keep and also to give up in the end of the Term
the said piece or parcel of Meadow land with all Landlords fish
in the said premises and all fences belonging to the said premises
in good and tenurable repair And the said Aaron Withers agrees
to execute if required such further Agreement to be enrolled in the
Office of Land Revenue Records and Involvements as may be necessary for
confirming this Agreement and in the meantime to hold the said
premises as a yearly Tenant to Her Majesty upon the terms abovementioned
In witness whereof the said parties of the second and third
parts have hereunto subscribed their names.

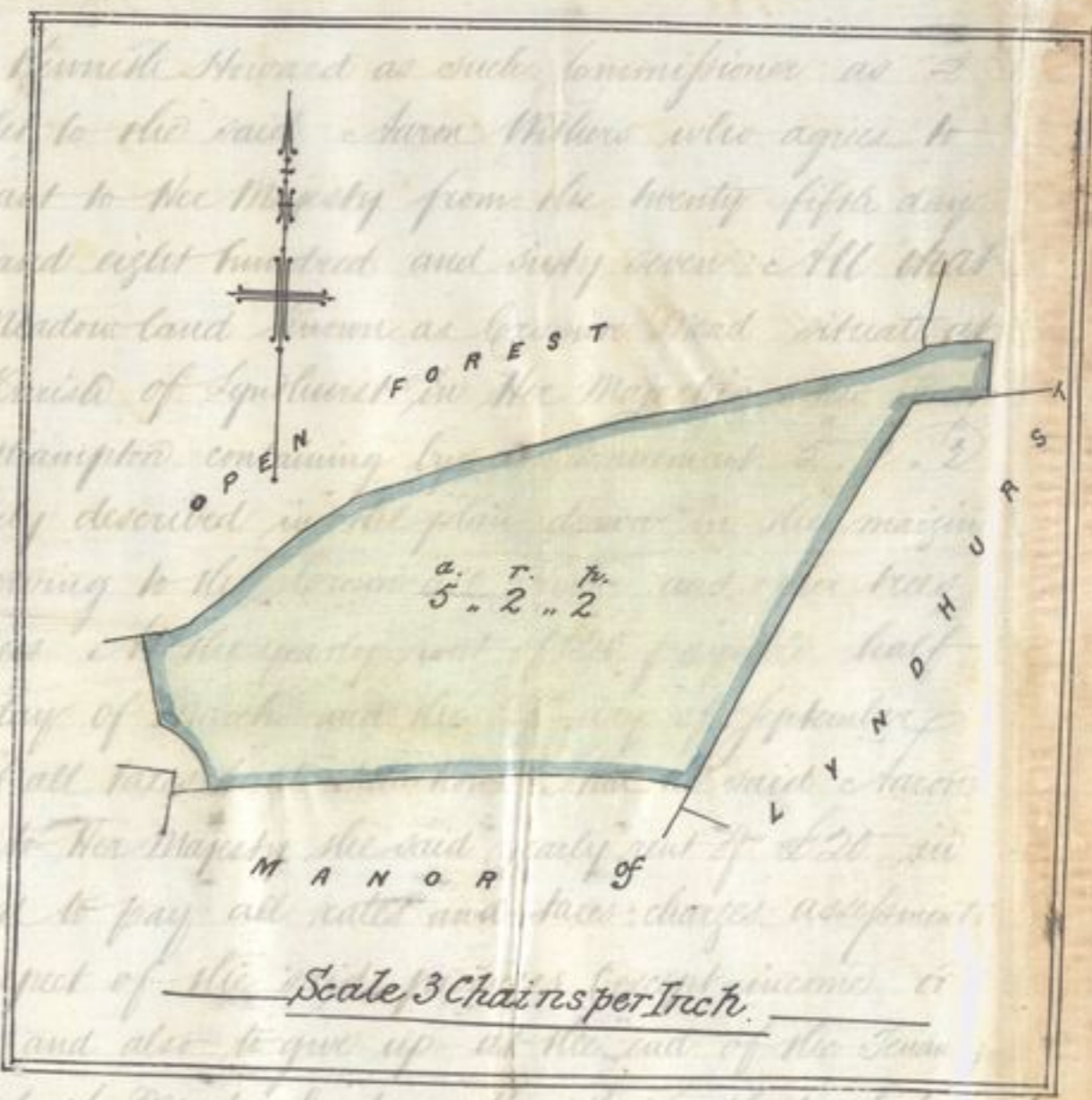

Aaron Withers

Witness
James Harold Roberts
Clerk to Deputy Surveyor

Dated 5th
May 1868
New Forest
The Honble
J. K. Howard
Comm^r of Her
Majesty's Woods
and

The Honble
Agreement
for letting
and premises
Lyndhurst on
yearly tenancy

Dated 5th
May 1868.
New Forest
The Honble J.
H. Howard @
Comm^r of Her
Majesty's Woods &c.

and
Thos. Cordery.
Agreement
for letting House
and premises at
Frittham on @
yearly tenancy.

Memorandum of Agreement made
the fifth day of May 1868 Between The Queen's
Most Excellent Majesty of the first part The
Honorable James Kenneth Howard of
Commissioner of Her Majesty's Woods Forests and Land
Revenues of the second part and Thomas Cordery
of Frittham in the Parish of Bramshaw in the County
of Southampton of the third part.

The said James Kenneth Howard as such Commissioner as aforesaid agrees to let to the said Thomas Cordery who agrees to take as yearly tenant to Her Majesty from the 25th day of March 1867 All that messuage tenement or dwelling house with the Land garden and premises situate at Frittham in the Parish of Bramshaw in Her Majesty's New Forest in the County of Southampton containing by admeasurement 7. 1. 3 and more particularly described in the plan drawn in the margin of these presents reserving to the Crown all timber and other Trees upon the said premises At the yearly rent of £20 payable half yearly on the 25th day of March and the 29th day of September in every year clear of all taxes and deductions And the said Thomas Cordery agrees to pay to Her Majesty the said yearly rent of £20 in manner aforesaid and to pay all rates and taxes charges assessments and outgoings in respect of the said premises (except income or property tax) To keep and also to give up at the end of the Tenancy the said Messuage tenement dwelling house with the land garden and premises with all Landlord's fixtures in the said premises and all fences belonging to the said premises in good and tenantable repair To insure and keep the premises insured from loss or damage by fire in some respectable Insurance Office And the said Thomas Cordery agrees to execute if required such further Agreement to be enrolled in the Office of Lands Revenue Records and Involvements as may be necessary for confirming this Agreement and in the meantime to hold the said premises as a yearly tenant to Her Majesty upon the terms above mentioned In witness whereof the said parties of the second and third parts have hereunto subscribed their names.

Thomas Cordery

Thomas Couchman Assistant to the Deputy
Surveyor of the New Forest

the
first
ward
and
my
first
third



Dated 5th
 May 1868.
 New Forest
 The Honble J.
 K. Howard a
 Commr of Her
 Majesty's Woods &c.

Memorandum of Agreement made
 the fifth day of May 1868 Between The Queen's
 Most Excellent Majesty of the first part The
 Honorable James Kenneth Howard of
 Commissioner of Her Majesty's Woods Forests and Land
 Revenues of the second part and Thomas Cordery
 of Fitham in the Parish of Bramshaw in the County
 of Southampton of the third part.

and
 Tho. Cordery
 Agreement
 for letting house
 and premises at
 Fitham on a
 yearly tenancy

The said James Kenneth Howard as such Commissioner as aforesaid
 agrees to let to the said Thomas Cordery who agrees to take as yearly tenant
 to Her Majesty from the 25th day of March 1867 All that messuage
 tenement or dwelling house with the Land garden and premises situate at
 Fitham in the Parish of Bramshaw in Her Majesty's New Forest in
 the County of Southampton containing by admeasurement 7. 1. 3 and
 more particularly described in the plan drawn in the margin of these
 presents reserving to the Crown all timber and other Trees upon the
 said premises At the yearly rent of £20 payable half yearly on the

25th day of September in every year clear of
 all taxes and duties and the said Thomas Cordery agrees to pay to
 Her Majesty yearly rent of £10 in summer aforesaid and to pay
 all rates and outgoings in respect of the said
 premises (including property tax) To keep and also to give up at the
 end of the term of years therein expressed the said messuage tenement dwelling house with the land
 garden and premises in the said premises and
 all fixtures in good and repairable repair To
 insure and keep insured from loss or damage by fire in some
 reputable Insurance Office And the said Thomas Cordery agrees to execute
 the agreement to be made by the Office of Lands
 and Tenures in Southampton in pursuance of this
 agreement and to pay the yearly
 rent of £20 as aforesaid in witness
 whereof the said James Kenneth Howard
 Commissioner of Her Majesty's Woods Forests and Land
 Revenues of the second part and Thomas Cordery
 of Fitham in the Parish of Bramshaw in the County
 of Southampton of the third part have hereunto
 set their hands and seals the fifth day of May 1868

MR G. E. EYRE'S PROPERTY.
 SCHEDULE

NO.	DESCRIPTION	QUANTITY
1	Yard	0 0 19
244	Meadow	1 0 17
248	Arable	1 1 31
249	House &c	0 1 0
250	Orchard	0 2 23
261	Meadow	0 2 27
263	Arable	3 0 6
Total ACRES		7. 1. 3



Scale, 3 Chains to an Inch

Thomas Cordery
 Deputy
 New Forest

Dated 5th
May 1868.

New Forest

The Honorable
Jas^r Howard
a Commissioner of
Her Majesty's Woods
&c.

— and —

Charles Brown

Agreement
for letting a piece
of pasture land on
a yearly tenancy.

Memorandum of Agreement

made the fifth day of May 1868 between
The Queen's Most Excellent Majesty of the
first part The Honorable James Kenneth
Howard a Commissioner of Her Majesty's Woods
Forests and Land Revenues of the second part and
Charles Brown of Hobley Extra parochial in
the County of Southampton of the third part.

The said James Kenneth Howard as such Commissioner as aforesaid
agrees to let to the said Charles Brown who agrees to take as
yearly Tenant to Her Majesty from the 29th day of September 1867
All that piece or parcel of Pasture Land situate at Hobley
Extra parochial in Her Majesty's New Forest in the County of Southampton
containing by admeasurement and more particularly described
in the plan drawn in the margin of these presents reserving to
the Crown all Timber and other Trees upon the said premises
At the yearly rent of £1 payable half yearly on the 25th day
of March and the 29th day of September in every year clear
of all taxes and deductions And the said Charles Brown agrees
to pay to Her Majesty the said yearly rent of £1 in manner
aforesaid and to pay all rates and taxes charges assessments and
outgoings in respect of the said premises (except income or property
tax) To keep and also to give up at the end of the Tenancy the
said piece or parcel of Pasture Land and premises with all
Landlord's fixtures in the said premises and all fences belonging
to the said premises in good and tenantable repair And the
said Charles Brown agrees to execute if required such further
Agreement to be enrolled in the Office of Land Revenue Records
and Inrolments as may be necessary for confirming this Agreement
and in the meantime to hold the said premises as a yearly Tenant
to Her Majesty upon the terms above mentioned In witness whereof
the said parties of the 2nd and 3rd parts have hereunto subscribed
their names.

The mark of + Charles Brown } Witness
Thomas Couchman

Thomas Couchman } Assistant to the Deputy
Sawyer of the New Forest

Dated 5th
May 1868.

New Forest

The Honorable
Jas^r Howard
a Commissioner of
Her Majesty's Woods
&c.

and

Charles Brown

Agreement
for letting a piece
of pasture land on
a yearly tenancy.

Memorandum of Agreement

made the fifth day of May 1868 between
The Queen's Most Excellent Majesty of the
first part The Honorable James Kenneth
Howard a Commissioner of Her Majesty's Woods
Forests and Land Revenues of the second part and
Charles Brown of Stobley Extra parochial in
the County of Southampton of the third part.

The said James Kenneth Howard as such Commissioner as aforesaid
agrees to let to the said Charles Brown who agrees to take as a
yearly Tenant to Her Majesty's Woods &c.

All that piece or parcel of pasture land situate at Stobley
Extra parochial in Her Majesty's New Forest in the County of Southampton
containing by admeasurement and more particularly described
in the plan drawn in the margin of these presents purporting to
the Crown all Timber and other Trees upon the said premises

At the yearly rent of £1 payable half yearly on the 25th day
of March and the 25th day of September in every year that
of all taxes and deductions the said yearly rent shall be paid in manner
aforesaid and to pay all rates and taxes and outgoings in respect
of the said premises (save and except such as may be levied on property
pay) To keep and repair the said premises in good and tenantable repair and the
said piece or parcel of pasture land and premises with all
Landlord's fixtures in the said premises in good and tenantable repair and the
said Charles Brown agrees to execute if required such further
Agreement to be enrolled in the Office of Land Revenue Records
and Instruments as may be necessary for confirming this Agreement
and in the meantime to hold the said premises as a yearly Tenant
to Her Majesty upon the terms above mentioned In witness whereof
the said parties of the 2nd and 3rd parts have hereunto subscribed
their names.

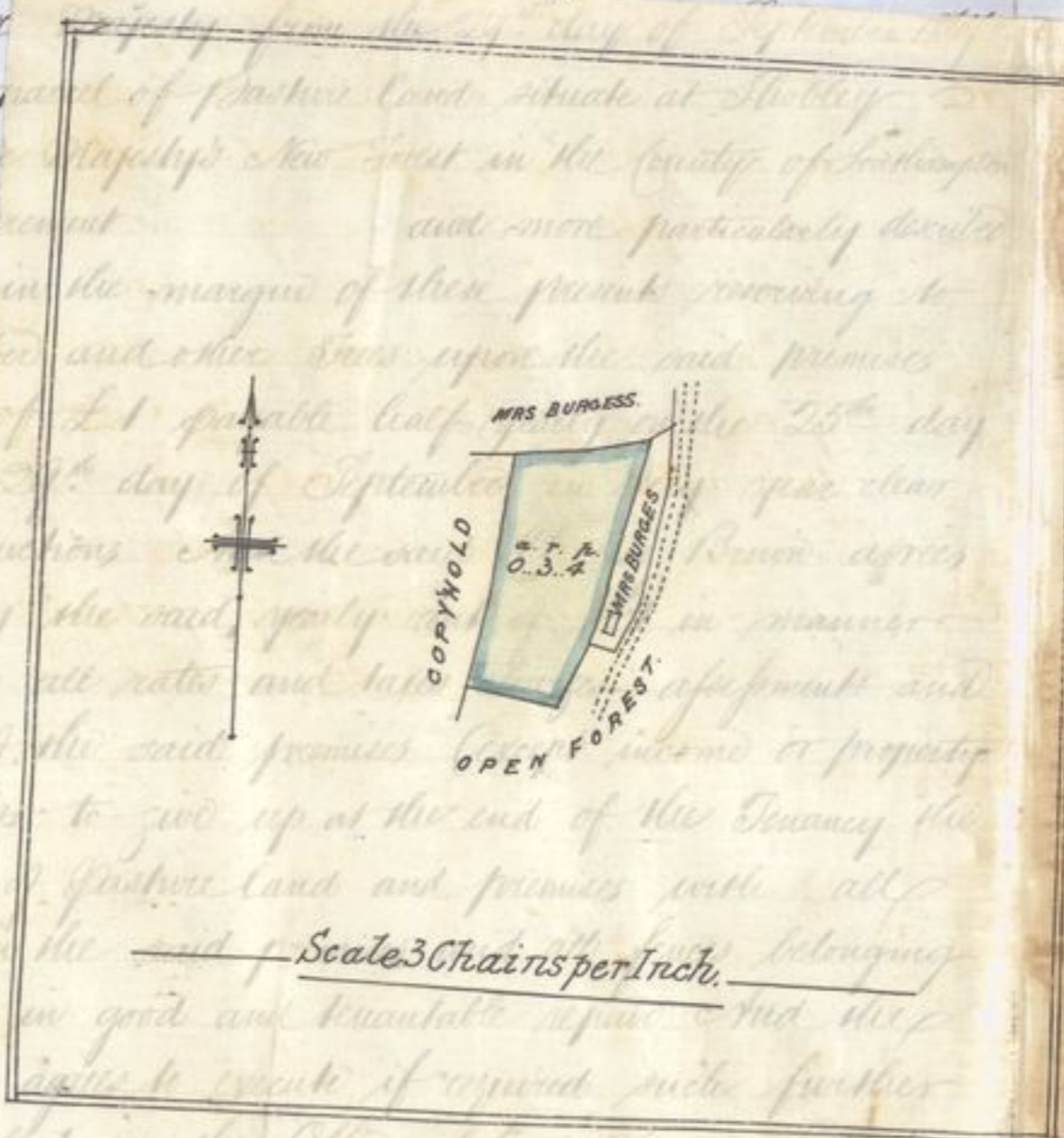

The mark of + Charles Brown } Witness
Thomas Couchman

Thomas Couchman } Assistant to the Deputy
Surveyor of the New Forest

Dated 11th
May 1868

New Forest

The Honorable
Jas^r Howard
a Commissioner of
Her Majesty's
Woods &c.

and

James
Milkshie

Agreement
for letting Hou
and land o
a yearly tena

Dated 11th
May 1868.

New Forest

The Hon^{ble}
J^r K Howard
a Commissioner of
Her Majesty's
Woods &c.

and
James
Wiltshire

Agreement
for letting House
and land on
a yearly tenancy

Memorandum of Agreement made the
eleventh day of May 1868 Between The Queen's Most
Excellent Majesty of the first part The Honorable
James Kenneth Howard a Commissioner of Her
Majesty's Woods Forests and Land Revenues of the second
part and James Wiltshire of Lyndhurst in the
Parish of Lyndhurst in the County of Southampton of
the third part.

The said James Kenneth Howard as such Commissioner as aforesaid agrees
to let to the said James Wiltshire who agrees to take as yearly Tenant to
Her Majesty from the 25th day of March 1868 All that messuage tenement
or dwellinghouse with the Land garden and premises situate at Lyndhurst
in the Parish of Lyndhurst in Her Majesty's New Forest in the County of
Southampton containing by armeasurement 2 . 1 . 31 and more particularly
described in the plan drawn in the margin of these presents payable half yearly
on the 25th day of March and the 29th day of September in every year clear
of all taxes and deductions And the said James Wiltshire agrees to pay to
Her Majesty the said yearly rent of £16 in manner aforesaid and to pay
all rates and taxes charges apointments and outgoings in respect of the said
premises (except income or property tax) To keep and also to give up at the
end of the Tenancy the said Messuage tenement and dwellinghouse with
the Land Garden and premises with all Landlords fixtures in the said
premises and all fences belonging to the said premises in good and tenurable
repair To insure and keep the premises insured from loss or damage by
fire in some respectable Insurance Office ^{the said J^r Wiltshire} agrees to execute if required such
further Agreement to be enrolled in the Office of Land Revenue Records and
Inrolments as may be necessary for confirming this Agreement and in
the meantime to hold the said premises as a yearly Tenant to Her Majesty
upon the terms above mentioned In Witness whereof the said parties of
the second and third parts have hereunto subscribed their names.

Witness
J. H. Roberts
Clerk to Deputy Surveyor

James Wiltshire



Scale 1/2

Dated 11th
May 1868.

New Forest

The Hon^{ble}
Sir K Howard
a Commissioner of
Her Majesty's
Woods &c

and
James
Wiltshire

Agreement
for letting House
and land on
a yearly tenancy

Memorandum of Agreement made the
eleventh day of May 1868 Between The Queen's Most
Excellent Majesty of the first part The Honorable
James Kenneth Howard a Commissioner of Her
Majesty's Woods Forests and Land Revenues of the second
part and James Wiltshire of Lyndhurst in the
Parish of Lyndhurst in the County of Southampton of
the third part.

The said James Kenneth Howard as such Commissioner as aforesaid agrees
to let to the said James Wiltshire who agrees to take as yearly Tenant to
Her Majesty from the 25th day of March 1868 All that Messuage tenement
or dwellinghouse with the Land garden and premises situate at Lyndhurst
in the Parish of Lyndhurst in Her Majesty's New Forest in the County of
Southampton containing by admeasurement 2 . 1 . 31 and more particularly
described in the plan drawn in the margin of these presents payable half yearly
on the 25th day of March and the 29th day of September in every year clear
of all taxes and deductions And the said James Wiltshire agrees to pay to
Her Majesty the said yearly rent of £10 in manner aforesaid and to pay
all rates and taxes charges assessments and outgoings in respect of the said
premises (except income or property tax) To keep and also to give up at the
end of the Tenancy the said Messuage tenement and dwellinghouse with
the Land garden and premises with all fixtures in the said
premises in good and tenantable
repair To insure and keep the premises
free in some respectable Insurance Office
to execute if required such
of Land Revenue Records and
for confirming this Agreement and in
as a yearly Tenant to Her Majesty
whereof the said parties of
subscribed their names.

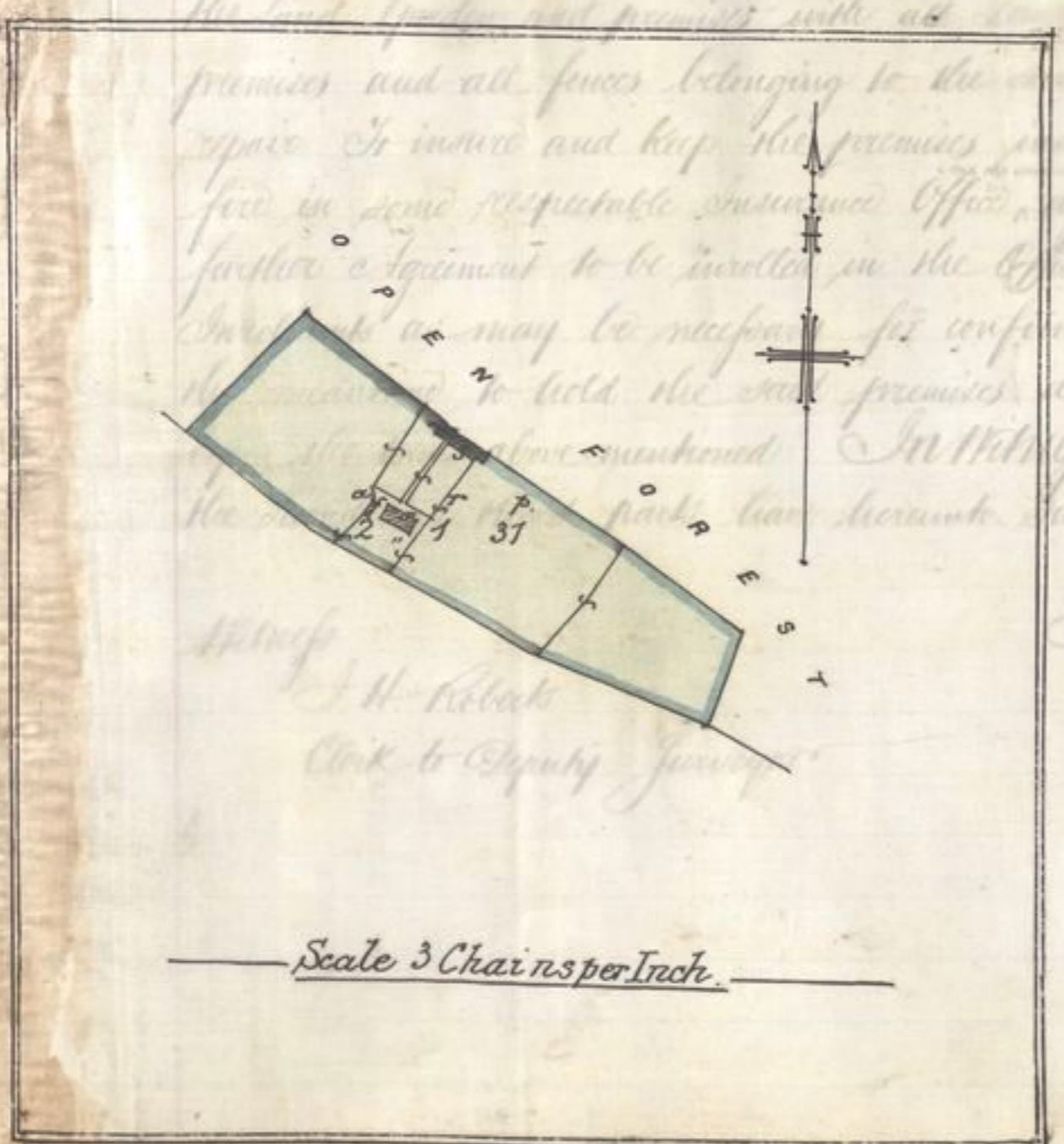

James Wiltshire

Scale 3 Chains per Inch

Dated 11th
May 1868.

New Forest

The Hon^{ble}
Genl. K. Howard
a Commissioner of
Her Majesty's Woods &c.

— and —

Charles Henry
Dyett.

Agreement
for letting 3. 0. 14
of meadow land on
a yearly tenancy.

Memorandum of Agreement made the
11th day of May 1868 Between The Queen's Most
Excellent Majesty of the first part The Honorable
James Kenneth Howard a Commissioner of Her
Majesty's Woods Forests and Land Revenues of the second
part and Charles Henry Dyett of Totton in the
Parish of Tling in the County of Southampton Innkeeper
of the third part.

The said James Kenneth Howard as such Commissioner as aforesaid
agrees to let to the said Charles Henry Dyett who agrees to take as yearly
Tenant to Her Majesty from the 29th day of September 1868
All that piece or parcel of Meadow Land known as Queenham
Meadow in the County of Southampton and containing by dimension
3. 0. 14 and more particularly described in the plan drawn
in the margin of these presents reserving to the Crown all Timber
and other Trees upon the said premises At the yearly rent of
£4. payable half yearly on the 25th day of March and the
29th day of September in every year clear of all taxes and
deductions and the said Charles Henry Dyett agrees to pay to Her
Majesty the said yearly rent of £4 in manner aforesaid and to
pay all rates and taxes charges assessments and outgoings in respect
of the said premises (except Income or property tax) To Keep and
also to give up at the end of the Tenancy the said piece or parcel
of meadow land with all Landlords fixtures in the said premises
and all fences belonging to the said premises in good & tenurable
repair And the said Charles Henry Dyett agrees to execute if
required such further Agreement to be enrolled in the Office of
Land Revenue Records and Involvements as may be necessary for
confirming this Agreement and in the meantime to hold the
said premises as a yearly Tenant to Her Majesty upon the terms
above mentioned In witness whereof the said parties of the
second and third parts have hereunto subscribed their names.

Charles Henry Dyett

Witness.

William Reed

Assistant to the Deputy Surveyor

Dated
June

Dean

License

Millm

to make

Tramroad

broad across

open Forest,

to be used

connection

the Old

Dated 11th
May 1868.

New Forest

The Hon^{ble}
Jas^r K Howard
a Commissioner of
Her Majesty's Woods &c.

— and —

Charles Henry
Dyett.

Agreement
for letting 3. 0. 14
of Meadow Land on
a yearly Tenancy.

Memorandum of Agreement made the
11th day of May 1868 Between The Queen's Most
Excellent Majesty of the first part The Honorable
James Kenneth Howard a Commissioner of Her
Majesty's Woods Forests and Land Revenues of the second
part and Charles Henry Dyett of Totton in the
Parish of Cling in the County of Southampton Junkeper
of the third part.

The said James Kenneth Howard as such Commissioner as aforesaid
agrees to let to the said Charles Henry Dyett who agrees to take as yearly
Tenant to Her Majesty from the 29th day of September 1868
All that piece or parcel of Meadow Land known as Queenham
Meadow in the County of Southampton and containing by admeasurement
3. 0. 14 and more particularly described in the plan
in the margin of these presents and the yearly rent of
£4. payable half yearly on the 29th day of September
deductions and the said Charles Henry Dyett agrees to pay to Her
Majesty the said yearly rent and to pay all rates and taxes
of the said premises (except the said yearly rent) and to
also to give up at the end of the said tenancy all the
of Meadow Land with all the fences and all fences belonging
and all fences belonging to the said premises and to repair
repair and the said Charles Henry Dyett agrees to pay for
required such further and other conditions as may be
Land Revenue Records and to confirm this Agreement
said premises as a yearly Tenancy on the above mentioned
above mentioned In witness whereof the said James Kenneth
second and third parts



Witness.
William Reed
Assistant to the Deputy Jurveger

Dated
June
Dean
License
Mill
to make
Railroad
road across
open Forest
be used
connection
the Old
Sit Iron

Scale

made the
Most
Honorable
of the second
Hon in the
Inkeeper
aforeaid
yearly
of

Dated 5th
June 1868.
Dean Forest
License to
Wm. Talbot
to make a
tramroad 12 feet
broad across the
open Forest, to
be used in
connection with
the Old Bow
Pit Iron Mine.

Whereas William Talbot of Kidderminster in the County of
Worcester now holds a Gale of an Iron Mine within the Forest of Dean
and Hundred of Saint Briavels in the County of Gloucester called the Old
Bow Pit Iron Mine and has requested Thomas Forster Brown the Deputy
Chaveller of the said Forest of Dean to grant to him the said William
Talbot the License or right of make and form the tramroad aftermentioned
and to have the use and enjoyment thereof as aftermentioned and The Honorable
James Kenneth Howard the Commissioner of Her Majesty's Woods Forests and
Land Revenues to whom the management and direction of the Royal Forests
with the duties and powers appertaining thereto have been assigned by Order
under the hands of the Lords Commissioners of Her Majesty's Treasury hath
signified his consent by a writing under his hand that such License should
be granted Now therefore I the said Thomas Forster Brown as such
Deputy Chaveller as aforesaid in pursuance of all powers vested in me in
this behalf and with such consent as aforesaid do grant unto the said
William Talbot and all other persons or person for the time being Owners
or Owner of the said Gale called Old Bow Pit Iron Mine a License
to make a tramroad of 12 feet broad across the open Forest commencing
at a point marked A near to the Old Bow Pit and extending in a
Northwardly direction and then in a South and Southwardly
direction across the open waste of the Forest to a junction with the tramway
licensed to the New Bow Pit Iron Mine at a point marked B as
shewn upon the plan drawn in the margin of these presents and
thereon colored Red for the purpose of carrying on the Work or works
opened and to be opened by virtue of the said Gale and to use and
occupy the said Road or tramroad for the purpose aforesaid but for
no other purpose whatsoever; subject nevertheless to the Rules and
Regulations set forth in the second schedule to the Award of the Dean
Forest Mining Commissioners relating to the working the Gales, Pits,
Levels and Works of Iron Mines within the said Hundred.

Dated this fifth day of June 1868.

T. Forster Brown Deputy Chaveller



Dated 5th June 1868.
 Dean Forest
 License to
 Willm. Talbot
 to make a
 Tramroad 12 feet
 broad across the
 open Forest, to
 be used in
 connection with
 the Old Bow
 Pit Iron Mine.

Whereas William Talbot of Kidderminster in the County of Worcester now holds a Lease of an Iron Mine within the Forest of Dean and Hundred of Saint Briavels in the County of Gloucester called the Old Bow Pit Iron Mine and has requested Thomas Forster Brown the Deputy Gavellee of the said Forest of Dean to grant to him the said William Talbot the License or right of make and form the tramroad aftermentioned and to have the use and enjoyment thereof as aftermentioned and the Honorable James Kenneth Howard the Commissioner of Her Majesty's Woods Forests and Land Revenues to whom the management and direction of the Royal Forests with the duties and powers appertaining thereto have been assigned by Order under the hands of the Lords Commissioners of Her Majesty's Treasury hath signified his consent by a writing under his hand that such License should be granted Now therefore I the said Thomas Forster Brown as such Deputy Gavellee as aforesaid in pursuance of all powers vested in me in this behalf and with such consent as aforesaid do grant unto the said William Talbot and all other persons or persons for the time being Owners

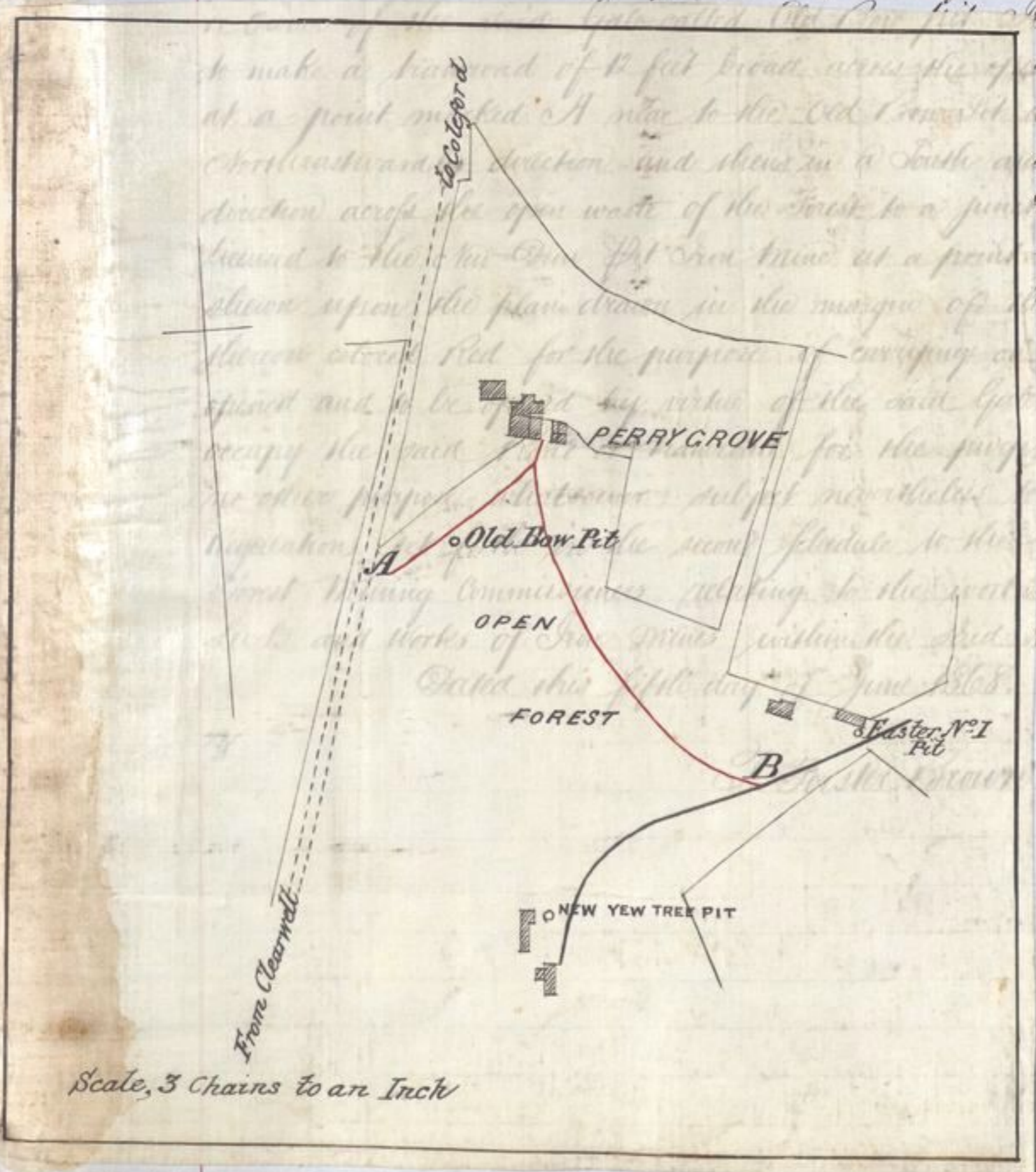

to make a tramroad of 12 feet broad across the open Forest commencing at a point marked A near to the Old Bow Pit and extending in a northward and then in a South and Southeastwardly direction across the open waste of the Forest to a junction with the tramway bound to the Old Bow Pit Iron Mine at a point marked B as shown upon the plan drawn in the margin of these presents and the Work or works to be done and to use and enjoy the same for the purpose aforesaid but for the Rules and Orders of the Dean and Forestward of the Dean Hundred.

Thomas Forster Brown
 Deputy Gavellee

Dated 5th
June 1868.

Dean Forest

License to

Osman Barrett

and Henry Crawshaw

to make a

12 feet broad across

the open Forest, to be

used in connection

with the Foxes

Bridge Colliery.

Whereas Osman Barrett of Mitcheldean in the County of Gloucester and Henry Crawshaw of Oaklands Park near Tewkesham in the County of Gloucester now hold a Gate of Coal in the Forest of Dean in the said County of Gloucester called Foxes Bridge Colliery and have requested Thomas Forster Brown the Deputy Gaveler of the said Forest of Dean to grant to them the said Osman Barrett and Henry Crawshaw the License or right to make and form the road after mentioned to make a Tramroad and the Honorable James Kenneth Howard the Commissioner of Her Majesty's Woods Forests and Land Revenues to whom the management and direction of the Royal Forests with the duties used in connection and powers appertaining thereto have been assigned by Order under the hands of the Lords Commissioners of Her Majesty's Treasury hath signified his assent by a writing under his hand that such License should be granted Now therefore the said Thomas Forster Brown as such Deputy Gaveler as aforesaid in pursuance of all powers vested in him in this behalf and with such consent as aforesaid doth grant unto the said Osman Barrett and Henry Crawshaw and all other persons or person for the time being Owners or Owner of the said Colliery a License to make a road or tramway of 12 feet broad across the open Forest commencing at a point near to the Broad Gauge Railway held in connection with this Colliery marked A and extending in a northern and north eastern direction across the open Forest to a point marked B at a junction with the Crump Meadow Colliery tramway as shown upon the plan drawn in the margin of these presents and thereon colored red for the purpose of carrying on the work or works opened or to be opened by virtue of the said Colliery and to use and occupy the said tramway for the purpose aforesaid but for no other purpose whatsoever Subject nevertheless to the Rules and Regulations set forth in the second schedule to the Award of the Dean Forest Mining Commissioners relating to the working of the Collieries in the said Forest.

Dated this fifth day of June 1868

T. Forster Brown - Deputy Gaveler

Dated 2nd
July 1868

Dean Forest

License

Dated 5th
June 1868.
Dean Forest
License to

Whereas Osman Barrett of Mitcheldean in
the County of Gloucester and Henry Crawshaw of Oaklands
Park near Tewkesham in the County of Gloucester now hold a
Gate of Coal in the Forest of Dean in the said County of
Gloucester called Foxes Bridge Colliery and have requested Thomas
Forster Brown the Deputy Gavellet of the said Forest of Dean

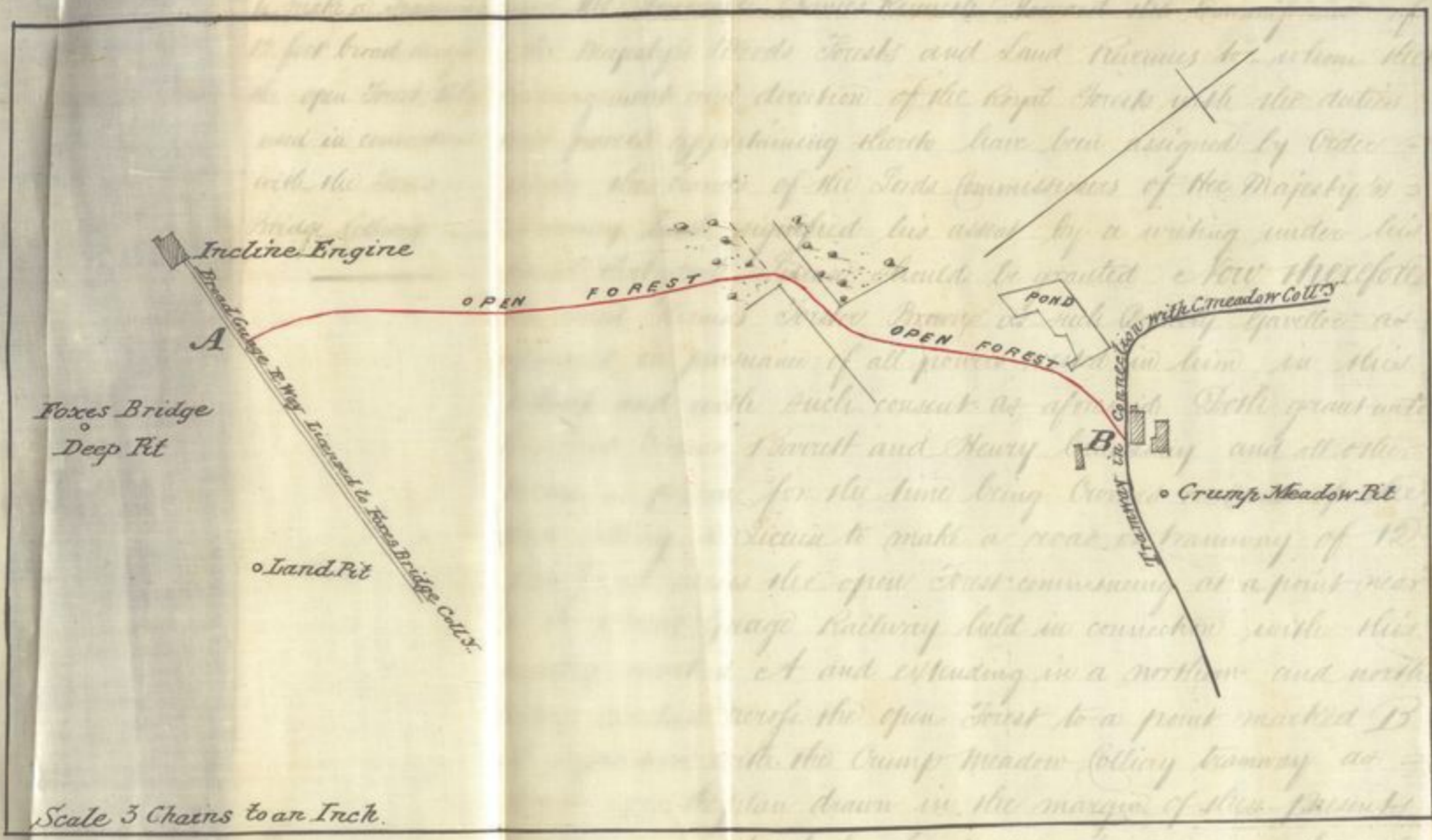

...but for no other purpose whatsoever Subject nevertheless
to the Rules and Regulations set forth in the second schedule to
the Award of the Dean Forest Mining Commissioners relating to the
working of the collieries in the said Forest.

Dated this fifth day of June 1868

T. Forster Brown - Deputy Gavellet

Dated 24th
July 1868.

Dean Forest

License

to Alfred
Gold & others
to make a
tramroad across
the open Forest
to be used in
connection with
the Crump Meadow
Colliery. —

Whereas Alfred Gold of Newnham in the County of Gloucester Tom Gold of the same place and the Representatives of the late Frederick W. Gold of Cinderford John Heyworth of Littledean in the said County and William P. Price of Gloucester now hold a Gale of a Coal Mine within the Forest of Dean and Hundred of St. Briavels in the said County of Gloucester called the Crump Meadow Colliery and have requested Thomas Forster Brown the Deputy Gavelled of the said Forest of Dean to grant to them the said A. Gold, Tom Gold, the Representatives of the late Fredk W Gold & Heyworth and W^m P. Price the license or right to have the use and enjoyment of the Tramroad as aforementioned and the Hon^{ble} James Kenneth Howard the Commis^r of Her Majesty's Woods, Forests and Land Revenues to whom the management and direction of the Royal Forests with the duties and powers appertaining thereto have been assigned by Order under the hands of the Lords Commissioners of Her Majesty's Treasury hath signified his consent by a writing under his hand that such License should be granted Now therefore I the said Thomas Forster Brown as such Deputy Gavelled as aforesaid in pursuance of all powers vested in me in this behalf and with such consent as aforesaid do grant unto the said Alfred Gold, Tom Gold, the Rep^s of the late Fredk W. Gold, John Heyworth and W^m P. Price and all other persons or person for the time being owners or owner of the said Gale called Crump Meadow Colliery a License to use the existing tramroad across the open Forest commencing at a point marked A near to the Crump Meadow Pits and extending in a Southern direction, and then in a South Eastwardly & Eastern direction to near the Prospect Pit and then Southwardly across the open Waste of the Forest to a junction with the Bullo Pill Railway at a point marked B as shown upon the plan drawn in the margin of these presents and thereon colored Red for the purpose of carrying on the Work or Works opened and to be opened by virtue of the said Gale and to use and occupy the said Road or tramroad for the purpose aforesaid but for no other purpose whatsoever; Subject nevertheless to the Rules and Regulations set forth in the second Schedule to the Award of the Dean Forest Mining Commissioners relating to the working the Gales Pits Levels and Works of Coal Mines within the said Hundred. —

Dated this 24th day of July 1868.

T. Forster Brown E. W. Gavelled

Dated 24th July 1868.
New Forest
Licence
to Alfred Gold
Gold & others
to make a
new road
to be used in
connection with
the Camp Meadow
Colliery.

Whereas Alfred Gold of Newnham in the County of Gloucester John Gold of the same place and the representatives of the late Frederick W. Gold of Cinderford John Hayworth of Littleham in the said County and William J. Rice of Gloucester now hold a Sale of a Coal Mine within the Forest of Dean and Hundred of St. Andrews in the said County of Gloucester called the Camp Meadow Colliery and have requested Thomas Foster Bowen the Deputy Quarter of the said Forest of Dean to grant to them the said A. Gold, John Gold, the representatives of the late Frederick W. Gold J. Hayworth and W^o J. Rice the licence or right to have the use and enjoyment of the Stramiread as aftermentioned and the Head James Kenneth Howard the Comptroller of Her Majesty's Woods, Forests and Land Revenues to whom the management and direction of the Royal Forests with the duties and powers appertaining thereto have been assigned by Order under the hands of the Lords Commissioners of Her Majesty's Treasury hath signified his consent by a writing under his hand that such Licence should be granted Now therefore I the said Thomas

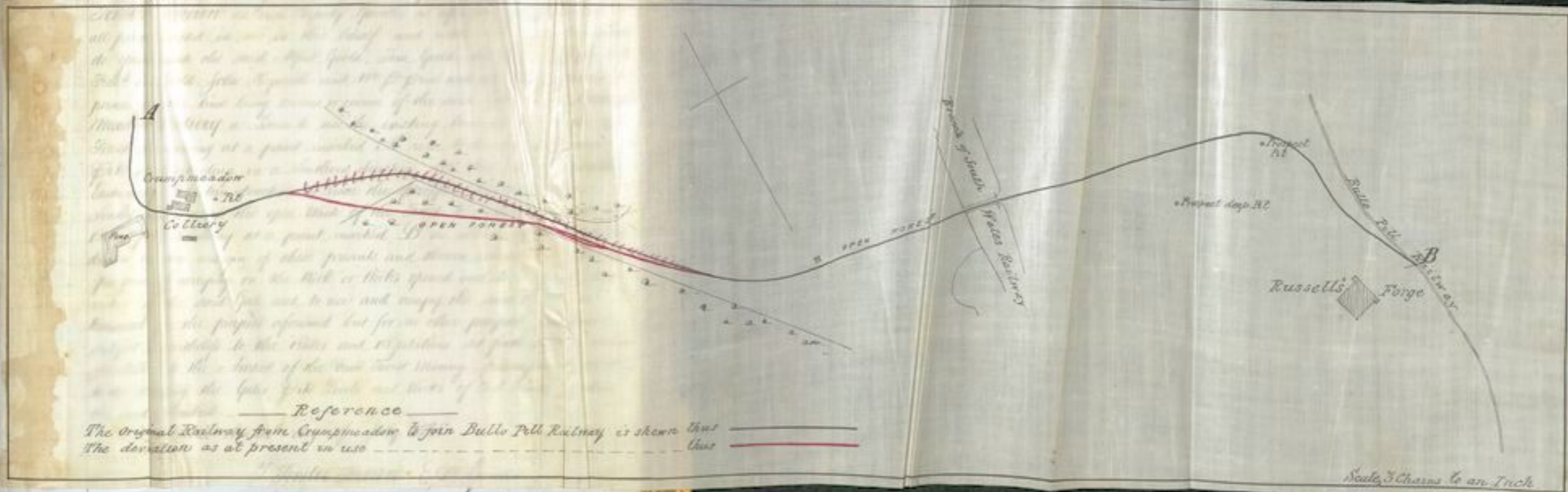

Reference
The original Railway from Camp Meadow to join Bull's Hill Railway is shown thus ————
The deviation as at present in use ————

Dated 29th
June 1868.

Delamere Woods
County of Chester

The Hon^{ble}
James K.
Howard a
Commissioner of
Woods &

— and —
M^r. Samuel
Wright —

Agreement
for letting on a
yearly tenancy

Memorandum of Agreement
made the twenty ninth day of June One thousand
eight hundred and sixty eight Between The
Queen's Most Excellent Majesty of the
first part The Honorable James
Kenneth Howard a Commissioner of Her
Majesty's Woods Forests and Land Revenues of the
second part and Samuel Wright of the third
part.

The said James Kenneth Howard as such Commissioner as aforesaid
agrees to let to the said Samuel Wright who agrees to take as yearly
Tenant to Her Majesty from the twenty fifth day of March One
thousand eight hundred and sixty eight All that piece of Land
containing about two acres and one rood situate near to Eddisbury
Lodge in the Delamere Woods in the County of Chester which said
piece of land is more particularly described on the plan drawn in the
margin of these Presents and is thereon colored red Together with the
appurtenances thereto reserving to Her Majesty all mineral substances stone
coal and other substrata with liberty to enter upon the said premises
and to get up work and carry away the same and also the right and
privilege for Her Majesty her heirs and successors and her or their
Grantees Lessees and Servants or Agents of hunting shooting and sporting
upon and over the said premises and also subject to all such rights
of way and other rights as are or may be legally exercisable over the
said premises at the yearly rent of Four pounds payable on the
twenty fifth of March in every year clear of all taxes and deductions
And the said Samuel Wright hereby agrees to pay to Her Majesty
her heirs and successors the said yearly rent of Four pounds in manner
aforesaid and to pay the said Tax and all other taxes rates and assessments
in respect of the said premises except income or property tax to keep and
maintain during the said tenancy the said premises and the fences thereof
in good and repairable repair and to deliver up the same to Her Majesty
her heirs and successors in a good and repairable state of repair
And it is agreed that this tenancy may be determined at any time
of the year on giving six calendar months previous notice in writing
for that purpose And the said James Kenneth Howard doth hereby
direct that this Agreement shall be deemed to be fully and sufficiently
enrolled by the deposit of a duplicate thereof in the Office of Land &
Revenue Records and Inrolments and the filing or making an entry

Lu

ok copy
20th Jan

of such deposit by the Keeper of the said Records and Inrolments In witness whereof the said parties of the second and third parts have hereunto subscribed their names.

James K Howard

Samuel Wright

Witness to the signature of the said James Kenneth Howard

J Russell Souray
Office of Woods P

Mitchell place

Witness to the signature of the said Samuel Wright

Robert Gleave

Labourer

Eddisbury

changed under
20th June 1888

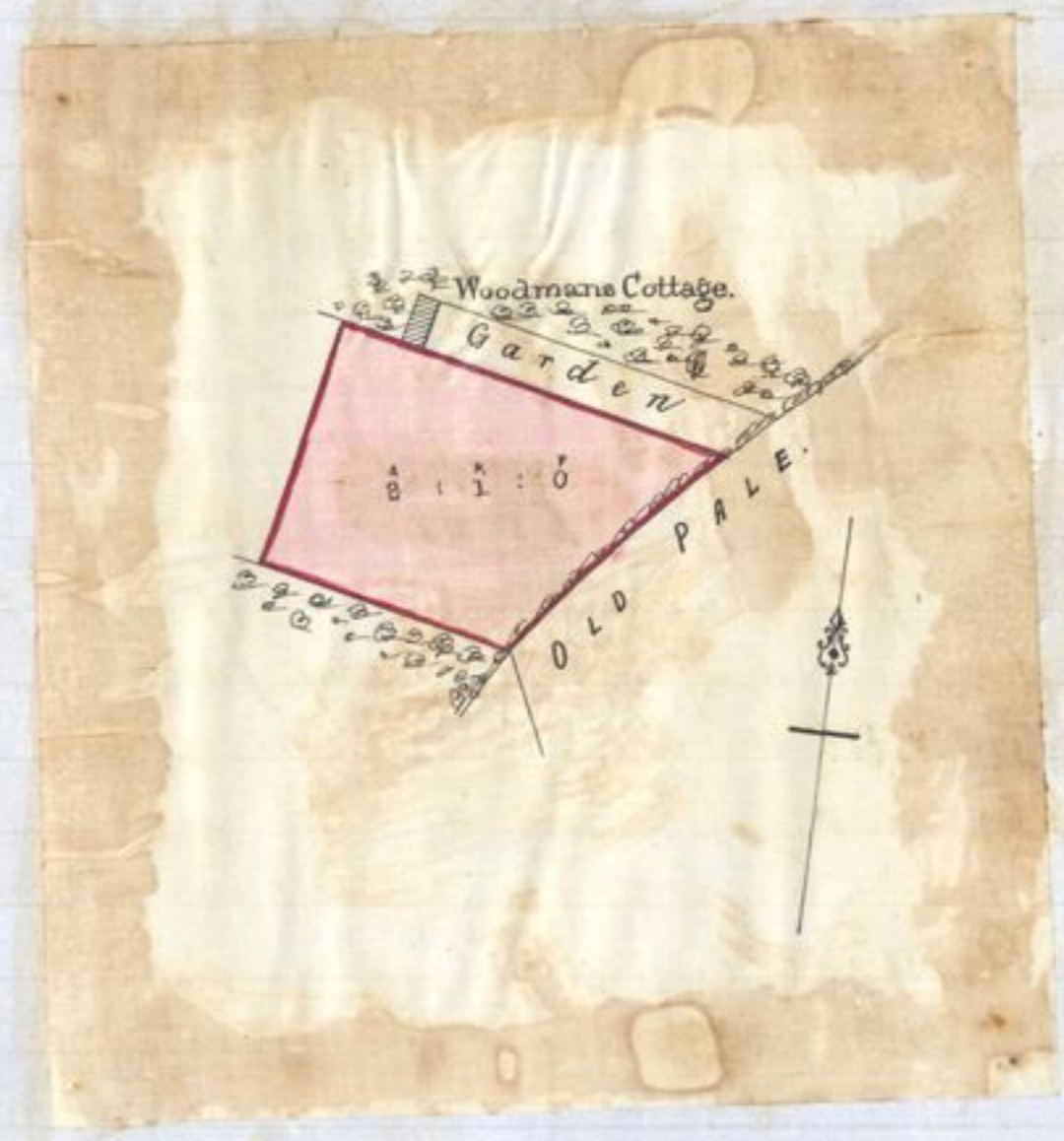

Dated 16th
July 1868.

Forest of Dean

Mr Richard
Loveridge

to

The Queen's
Most Excellent
Majesty.

Conveyance
(by way of Exchange)
of a piece or parcel
of Land at Hangerbury
in Worcester Walk
in the Forest of
Dean and County
of Gloucester.

His Indenture made the sixteenth day of July one thousand eight hundred and sixty eight Between Richard Loveridge of Ruardean Hill in the Township of East Dean in the County of Gloucester Grocer and Draper and Elizabeth Morgard of Myrhall Hill in the Forest of Dean in the said County Widow of William Morgard late of the same place Coalmaster deceased of the first part The Queen's Most Excellent Majesty of the second part and The Honorable James Kenneth Howard the Commissioner of Her Majesty's Woods Forests and Land Revenues to whom the management and direction of certain of the Woods Forests and Land Revenues of the Crown including therein the Royal Forest of Dean with the duties and powers appertaining thereto have been assigned by Order under the hands of the Lords Commissioners of Her Majesty's Treasury made in pursuance of the Act 14th and 15th Victoria Chap: 42 of the third part Whereas by an Indenture or Deed of Conveyance bearing date on or about the thirteenth day of February One thousand eight hundred and fifty eight and made between Henry Morgan of Myrhall Hill in the Forest of Dean Solicitor of the first part Lettice Waite of Rop Herefordshire Spinster of the second part and the said Richard Loveridge of the third part For the considerations therein expressed the piece or parcel of Land and hereditaments hereinafter particularly described and hereby intended to be conveyed to Her Majesty in exchange were duly conveyed and assigned unto and to the use of the said Richard Loveridge his heirs and assigns for ever And whereas by the tenth George fourth Chap: 50 Section 98 it was amongst other things enacted that it should be lawful for the Commissioners for the time being of Her Majesty's Woods Forests and Land Revenues and they were thereby authorized and empowered from time to time to contract and agree with any person or persons Body or Bodies politic Corporate or Collegiate for the sale or exchange of and absolutely to dispose of either by way of sale for such sum or sums of money as to them should appear as sufficient consideration for the same or by way of exchange for any other lands or hereditaments with or without giving or receiving any sum of money for equality of exchange any part or parts of the said Possessions and Land Revenues of the Crown to which the now reciting Act related which should consist of any parcels of land in any of the Royal Forests which were or might be wholly or in part surrounded by, intermixed or with or contiguous to other Lands not the property of the Crown and which parcels of land should not be suited for the growth of Timber or any waste or other lands in any of the Royal Forests which should not exceed in value in any one instance the sum of One thousand pounds

477

and every such sale and Exchange should be carried into effect in such and the like manner as was thereinbefore directed with respect to other parts of the Land Revenues of the Crown to which the now reciting Act related And whereas the said Richard Loveridge lately contracted and agreed with the said James Kenneth Howard as such Commissioner of Her Majesty's Woods Forests and Land Revenues as hereinbefore expressed acting for and on behalf of the Majesty under the powers and authorities of the said Acts of the tenth George fourth Cap: 50 and 11th and 15th Victoria Cap: 42 and with the consent and authority of the Lords Commissioners of Her Majesty's Treasury signified by Warrant in writing under the hands of two of them bearing date the first day of May One thousand eight hundred and sixty eight for the sale by way of Exchange of the piece or parcel of land and hereditaments hereinafter more particularly described and intended to be conveyed to the Queen's Majesty for the two pieces or parcels of Waste land in the said Forest of Dean conveyed or intended to be conveyed by the said James Kenneth Howard as such Commissioner as aforesaid to the said Richard Loveridge and his heirs by Indenture of even date herewith Now this Indenture witnesseth that in pursuance of the said recited Contract and agreement and in consideration of the conveyance to the said Richard Loveridge and his heirs by the said James Kenneth Howard (as such Commissioner as aforesaid) by a Deed Poll under his hand and Seal intended to bear even date herewith of the two pieces or parcels of Waste land in the said Forest of Dean colored Red on the plan annexed to these Presents The said Richard Loveridge at the request and by the direction of the said James Kenneth Howard as such Commissioner as aforesaid Doth by these Presents grant convey and confirm And the said Elizabeth Morgan at the request and by the direction of the said Richard Loveridge testified by his Execution hereof (for the purpose of releasing and discharging the premises hereinafter particularly described and hereby intended to be conveyed from the annuity or annual sum of Twenty pounds payable to her the said Elizabeth Morgan for her life with which the said premises (with others) were made chargeable by the Will of the said William Morgan deceased and all other her estate and interest (if any in the premises) Doth by these Presents release and confirm unto the Queen's Majesty her heirs and successors All that piece or parcel of Arable land formerly in the occupation of William Morgan then of the said Henry Morgan and now of the said Richard Loveridge containing by admeasurement one rood and fifteen perches more or less situate lying and being at Haugbury in Worcester Walk in the Forest of Dean and Township of West Dean in the County of Gloucester which said piece or parcel of land

Little Dean Hill

Bilson Green

From Bilson

To Little Dean

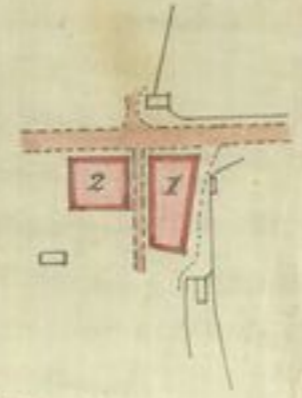

by xxxi. 11

Scale, 3 Chains to an Inch

REFERENCE.

The Two pieces of Land colored Red on this Plan are situate on Little Dean Hill, in the Township of East Dean, and are proposed to be taken in exchange for a certain piece of Land, situate at Hangerberry Inclosure, near Lydbrook

	A. R. P.
N ^o 1	0. 0. 31
N ^o 2	0. 0. 24
Total.	0. 1. 15

Parish of English Bicknor

Worcester Walk

HANGERBERRY INCLOSURE

by xxxi. 5

137 Acres Land belonging to the Crown 457

Open Forest

Scale, 3 Chains to an Inch

The Plot No^d 457 is colored Blue and Contains - 0 - 1 - 15 -

is bounded on the part of the South or South West by Field land now
 belonging to the Crown and in the occupation of John Bennett and late an
 encroachment numbered 1458 on the plan of Encroachments in Worcester Walk
 and on all other parts or sides thereof by open Forest and is with the
 Boundaries and abutments thereof more particularly delineated and described
 on the Map or Plan thereof annexed to these presents and thereon colored Blue
 Together with all houses outhouses edifices buildings ways paths passages
 waters watercourses rights privileges easements and appurtenances whatsoever
 to the said piece or parcel of land and hereditals or any part of the same
 belonging or appertaining or now or at any time heretofore held used occupied
 or enjoyed therewith or with any part thereof And all the estate right title
 interest use trust property claim and demand of him the said Richard
 Lovridge of in to or out of the same To have and to hold that said piece
 or parcel of land and hereditals hereby conveyed or intended so to be with the
 rights members and appurtenances thereto belonging or appertaining Unto and
 To the use of the Queen's Majesty her heirs and successors as part of the
 Popes pions and Land Revenues of the Crown In exchange for the two pieces
 or parcels of Waste land hereinafore mentioned colored Red on the said
 Plan annexed hereto and conveyed or intended to be conveyed by the said
 James Bennett Howard as such Commissioner as aforesaid to the said Richard
 Lovridge and his heirs as hereinafore mentioned And the said Richard
 Lovridge doth hereby for himself his heirs executors admors and assigns
 covenant with the Queen's Majesty her heirs and successors that notwithstanding
 any act deed or thing by him the said Richard Lovridge done executed
 or suffered to the contrary he the said Richard Lovridge is seized of and
 for an estate in fee simple in possession or otherwise well and sufficiently
 entitled to the said Land and premises hereby conveyed or intended to be
 conveyed to the Queen's Majesty and now hath in himself good right and
 full power to grant and convey the same in manner aforesaid free from
 all incumbrances and that it shall be lawful for the Queen's Majesty her
 heirs and successors at all times hereafter quietly to have possess and enjoy
 the said piece or parcel of land and hereditaments and to receive and
 take the rents issues and profits thereof without any lawful denial without
 claim or demand whatsoever from the said Richard Lovridge or any person
 whomsoever claiming by from through under or in trust for him and
 that free and clear of from and against all and all manner of charges
 and incumbrances whatsoever And further that he the said Richard
 Lovridge his heirs and assigns shall and will at all times hereafter
 upon every reasonable request and at the costs and charges of the Queen's
 Majesty her heirs and successors or of the Commissioners of her Majesty's

Woods Forests and Land Revenues, make do and execute or procure to be
made done and executed all such further acts deeds conveyances and assurances
in the Law whatsoever for the further better and more absolutely conveying
and assuring the said piece or parcel of land and hereditaments hereinbefore
described and hereby conveyed in exchange with the appurtenances unto
and to the use of the Queen's Majesty Her Heirs and Successors as by Her
or them or by the Commissioners for the time being of Her Majesty's Woods
Forests and Land Revenues or one of them or by the Law Officers of Her
Majesty Her Heirs or Successors shall be reasonably devised and required
Provided always that it is hereby expressly agreed and declared
by and between the said parties hereto that if at any time hereafter the
Queen's Majesty Her Heirs or Successors or the Commissioners of Her
Majesty's Woods Forests and Land Revenues without Her or their wilful
neglect or default shall be evicted or dispossessed from or otherwise turned
out of the possession of the said Land and premises colored Blue on the
said Plan hereinbefore expressed to be conveyed unto and to the use of
Her Majesty Her Heirs and Successors by any person or persons whomsoever
lawfully or equitably claiming any estate right title or interest in and to
the said Land and premises that then and in such case it shall be lawful
for Her Majesty Her Heirs and Successors or the Commissioners of Her Majesty's
Woods Forests and Land Revenues or one of them again to recede into
and upon and take possession of and have hold and enjoy the said
pieces or parcels of Land and premises colored Red on the said Plan
hereinbefore mentioned to have been conveyed by the said James Kenneth
Howard as such Commissioner as aforesaid to the said Richard Lovridge and
his Heirs together with all erections and buildings which may be then
standing and being thereon and to receive and take the rents issues and
profits thereof as part of the possessions and Land Revenues of the Crown
as fully and effectually to all intents and purposes as if these Presents
had not been made AND the said James Kenneth Howard doth hereby
direct that this Deed shall be deemed to be fully and sufficiently enrolled
by the deposit of a duplicate thereof in the Office of Land Revenue Records
and Inrolments and the filing or making an entry of such deposit by the
Keeper of the said Records and Inrolments In witness whereof the
parties to these Presents have hereunto set their hands and seals the day
and year first above written.

Richard (H.) Lovridge

The mark

X
Elizabeth

and seal of

(H.)

James K Howard (H.)

Morgan

Signed sealed and delivered by the within named Richard

Loveridge in the presence of
M. F. Carter
Solicitor
Newnham

Signed sealed and delivered by the within named Elizabeth Morgan
in the presence of

John Roberts
Brick Manufacturer
Bailey Lane End
East Dean - Gloucestershire

Signed sealed and delivered by the within named James Kenneth
Howard in the presence of

Russell Sowray
Office of Woods P.
Mitchell Place

I certify that a duplicate of this deed has been deposited in the
Office of Land Revenue Records and Involvements and an entry thereof
made or filed by me. -

H. G. Hewlett
Keeper of the Records.

Dated
July 18

Forest of De

The Hon
James
Howard
Commissioner
Her Majesty's
Woods &c

— (6)

Mr Richard
Loveridge

Conveyance

(by way of
Exchange) of
pieces of
at Littledean
in Littledean
Parish
in the
of Dean.

Dated the
July 1868.

Forest of Dean

The Hon^{ble}
James W
Howard a
Commissioner of
Her Majesty's
Woods &c

— (b) —

Mr Richard
Loveridge.

Conveyance

(by way of
Exchange) of two
pieces of Land
at Littledean Hill
in Littledean or
Lahimer Walk
in the Forest
of Dean.

His Indenture made the sixteenth day of July One
 thousand eight hundred and sixty eight Between **The Queen's**
Most Excellent Majesty of the first part **The Honorable**
James Kenneth Howard the Commissioner of Her Majesty's
 Woods Forests and Land Revenues to whom the management and direction
 of certain of the Woods Forests and Land Revenues of the Crown
 including therein the Royal Forest of Dean with the duties and powers
 appertaining thereto have been assigned by order under the hands of
 the Lords Commissioners of Her Majesty's Treasury made in pursuance of
 an Act passed in the fourteenth and fifteenth years of the reign of Her
 present Majesty Chapter 42 of the second part and **Richard Loveridge**
 of Ruardean Hill in the Township of East Dean in the County of Gloucester
 Grocer and Draper of the third part **Witnesseth** that in consideration
 of the conveyance to the Queen's Majesty Her Heirs and Successors by the
 said Richard Loveridge by an Indenture or Deed of Conveyance of even date
 herewith of the piece or parcel of Land and premises colored Blue on the
 Plan annexed to these Presents The said James Kenneth Howard as
 such Commissioner as aforesaid on behalf of Her Majesty and under
 the authority of an Act passed in the tenth year of His late Majesty King
 George the fourth Chapter 50 and also of the said Act of the 14th and
 15th years of the Reign of Her present Majesty Chapter 42 **Doth** by
 these presents (with the consent and approbation of the Lords Commissioners
 of Her Majesty's Treasury signified by Warrant in writing under the
 hands of two of them bearing date the first day of May One thousand
 eight hundred and sixty eight **Grant** unto the said Richard Loveridge
 and his heirs **All** the Estate right and interest of the Queen's Majesty
 Her Heirs and Successors of and in **All these** two pieces or
 parcels of Land part of the open waste Lands of Her Majesty's Forest
 of Dean in the said County of Gloucester situate lying and being on
 Littledean Hill in Little Dean or Lahimer Walk in the said Forest of
 Dean and Township of East Dean containing together by admeasurement as
 now staked out one rood and fifteen perches which said pieces or
 parcels of Land are with the boundaries and abutals thereof more
 particularly delineated and described on the Plan annexed to these
 Presents and thereon colored Red and numbered respectively 1 and 2
Save and except out of this Grant all Mines and Minerals within upon
 or under the said pieces or parcels of Land and every part thereof with
 full power license and authority to Her Majesty Her Heirs Successors
 and assigns and Her and their Heirs Grantees Lessees or Licensees Servants
 Agents and Workmen from time to time and at all times for ever

hereafter to enter upon work use and enjoy the same and every of
 them as fully and effectually to all intents and purposes as if this
 Grant had not been made) To have and to hold the said pieces
 or parcels of Land intended to be hereby granted and conveyed with the
 appurtenances and all benefits and advantages thereto belonging (except
 as aforesaid) unto and to the use of the said Richard Lovridge
 his heirs and assigns for ever In Exchange for the piece or parcel
 of Land and premises tinted Blue on the said Plan and conveyed or
 intended to be conveyed by the said Richard Lovridge to the Queen's
 Majesty Her Heirs and Successors by Indenture of even date herewith
 as hereinbefore mentioned Provided always and it is hereby
 expressly agreed and declared by and between the said parties
 hereto that if at any time hereafter the Queen's Majesty Her Heirs or
 Successors or the Commissioners of Her Majesty's Woods Forests and Land
 Revenues without her or their wilful neglect or default shall be lawfully
 evicted or dispossessed from or otherwise turned out of the possession of
 the said Land and premises colored Blue on the said plan hereinbefore
 expressed to be conveyed to Her Majesty by Deed of even date herewith
 by any person or persons whomsoever lawfully or equitably claiming
 any estate right title or interest in and to the said Land and
 premises so colored Blue that then and in such case it shall be lawful
 for Her Majesty Her Heirs and Successors or the Commissioners of Her
 Majesty's Woods Forests and Land Revenues or one of them again to
 reenter into and upon and take possession of and have hold and enjoy
 the said pieces or parcels of Land colored Red hereby granted to the
 said Richard Lovridge together with all erections and buildings
 which may be then standing and being thereon and to receive and
 take the rents issues and profits thereof as part of the possessions and
 Land Revenues of the crown as fully and effectually to all intents and
 purposes as if these Presents had not been made And the said
 James Kenneth Howard doth hereby direct that this Deed shall be
 deemed to be fully and sufficiently enrolled by the deposit of a
 Duplicate thereof in the Office of Land Revenue Records and Enrolments
 and the filing or making an entry of such deposit by the Keeper of the
 said Records and Enrolments In witness whereof the said parties
 hereto of the second and third parts have hereunto set their hands
 and seals the day and year first above written.

James K (S) Howard Richard (H) Lovridge
 Signed sealed and delivered by the within named James Kenneth

Howard in the presence of
J. Russell Savary
Office of Woods, P
Whitehall Place

Signed sealed and delivered by the within named Richard
Loderidge in the presence of
M. F. Carter
Solicitor
Newnham

I Certify that a Duplicate of this Deed has been deposited in
the Office of Land Revenue Records and Involvements and an entry
H. G. Newlett
Keeper of the Records
17th July 1868.

x^e

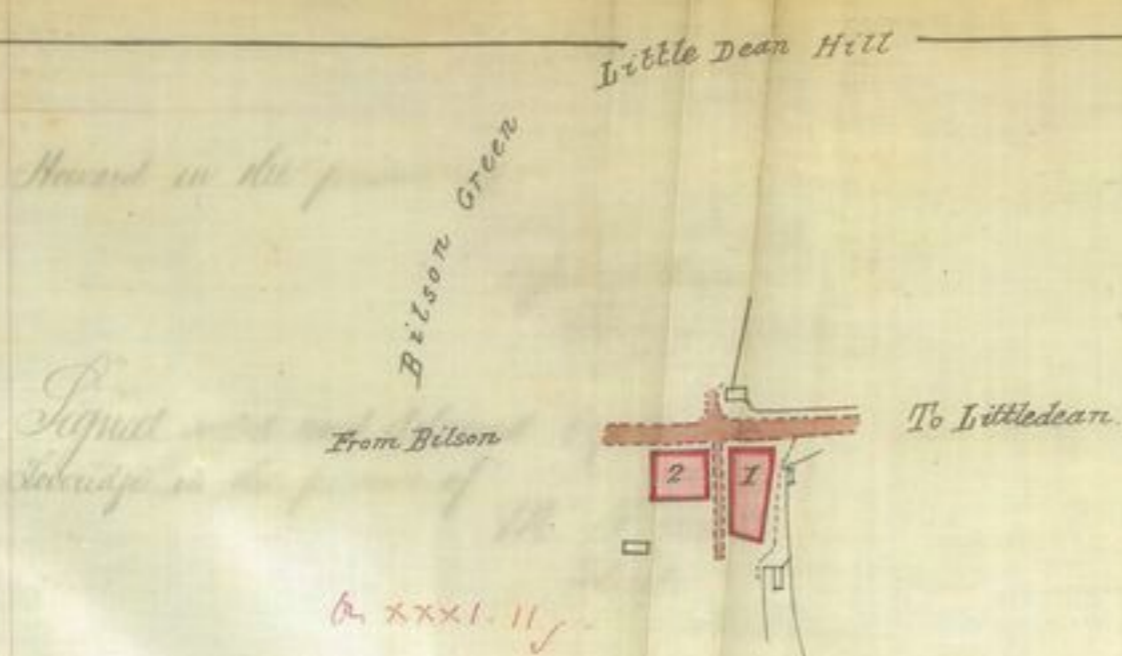

Howard in the
 Signal
 Suburbs in the
 A. XXXI. 11

REFERENCE.

The Two pieces of Land colored Red on this Plan are situate on Little Dean Hill, in the Township of East Dean, and are proposed to be taken in exchange for a certain piece of Land, situate at Hangerberry Inclosure, near Igolbrook

	A.	R.	P.
N ^o 1	0.	0.	31
N ^o 2	0.	0.	24
Total.	0.	7.	75

Scale, 3 Chains to an Inch.

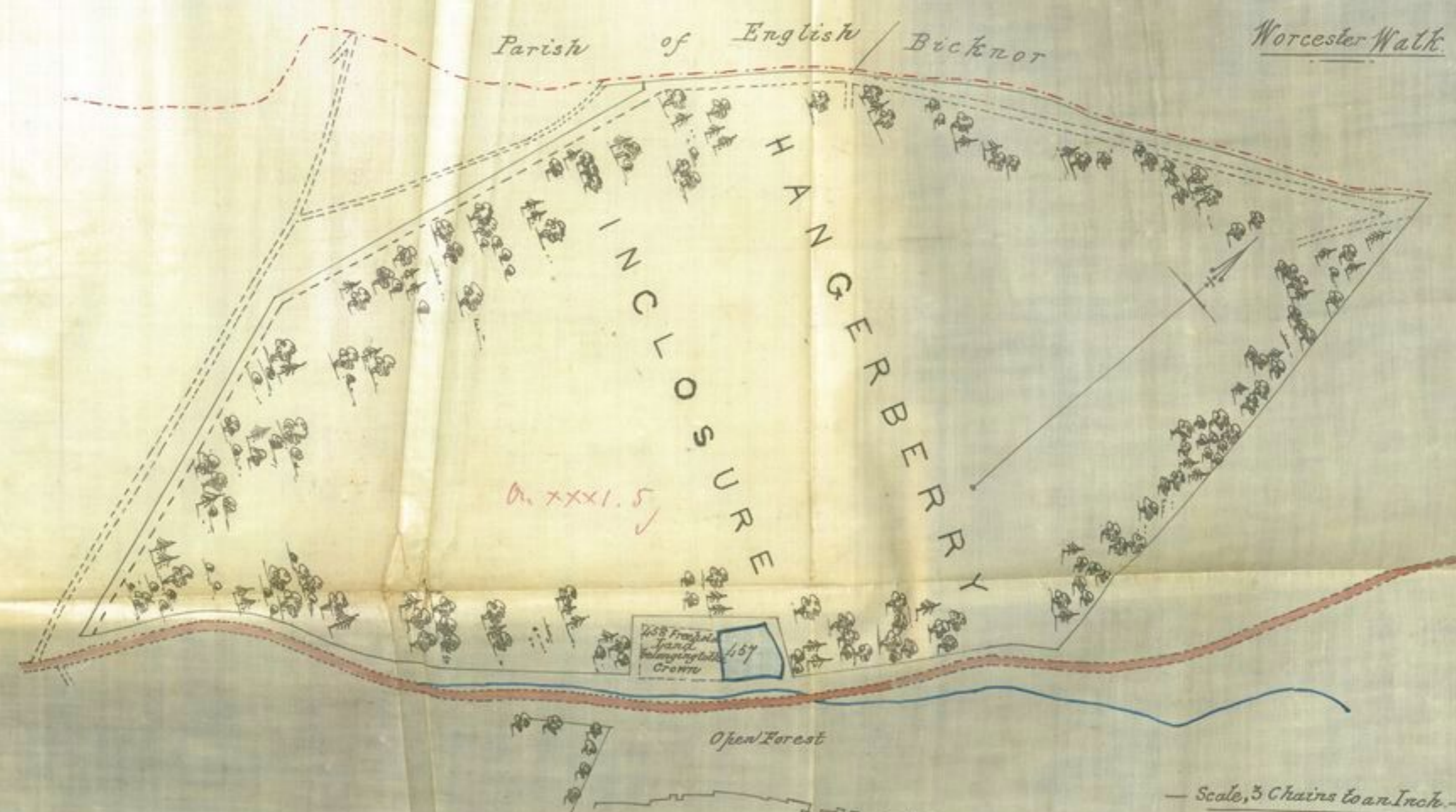

A. XXXI. 5

Scale, 3 Chains to an Inch.

The Patch No^d 157 is colored Blue and Contains - 0 - 1 - 15 -

Dated 9th October 1868.

Dean Forest

New-Bowson Coll^y

License to make and form the Broad Gauge tramway as after mentioned and to have the use and enjoyment thereof as after mentioned. And the Honorable James Kenneth Howard the Commissioner of Her Majesty's Woods and Forests and Land Revenues to whom the management and direction of the Royal Forests with the duties and powers appertaining thereto have been assigned by order under the hands of the Lord Commissioner of Her Majesty's Treasury hath signified his consent of carrying on the works opened or to be opened by virtue of the said Gate.

Whereas The New-Bowson Deep Coal Company

now hold a Gate of a Coal Mine within the Forest of Dean and Hundred of Saint Briavels in the County of Gloucester called the New-Bowson Colliery and part of a Gate called Eastdean Deep Colliery and have requested Thomas Forster Brown the Deputy Gaveler of the said Forest of Dean to grant to them the said New-Bowson Deep Coal Company the License or right to make a broad gauge tramway as after mentioned and to have the use and enjoyment thereof as after mentioned. And the Honorable James Kenneth Howard the Commissioner of Her Majesty's Woods and Forests and Land Revenues to whom the management and direction of the Royal Forests with the duties and powers appertaining thereto have been assigned by order under the hands of the Lord Commissioner of Her Majesty's Treasury hath signified his consent of carrying on the works opened or to be opened by virtue of the said Gate. - Now therefore I the said Thomas Forster Brown as such Deputy Gaveler as aforesaid in pursuance of all powers vested in me in this behalf and with such consent as aforesaid do grant unto the said New-Bowson Deep Coal Company and all other persons or person for the time being Owners or Owner of the said Gate called New-Bowson Colliery and part Owner of the Eastdean Deep Colliery a License to make a broad gauge tramway of 30 feet broad across the open Forest commencing at a point marked A adjoining the South Wales Branch Railway near Churchway and extending in a South Eastwardly direction across the open waste of the Forest to a junction with the South Wales Branch Railway at or near Broadmoor Pit at a point marked B as shown upon the plan drawn in the margin of these presents and thereon colored Red for the purpose of carrying on the work or works opened and to be opened by virtue of the said Gate and to use and occupy the said tramway for the purpose aforesaid but for no other purpose whatsoever; subject nevertheless to the Rules and Regulations set forth in the second Schedule to the Award of the Dean Forest Mining Commissioners relating to the working the Gates Pits Sevels and Works of Coal Mines within the said Hundred. -

Dated this 9th day of October 1868.

T. Forster Brown - Deputy Gaveler

Dated 31 August 1868

Dean Forest

Quarry 25



Records and documents, the

Dated 9th
October 1868.
Dean Forest
New Bowson Coll^y
License

Whereas The New Bowson Deep Coal Company
now hold a Gale of a Coal Mine within the Forest of Dean and Hundred
of Saint Briavels in the County of Gloucester called the New Bowson Colliery
and part of a Gale called Eastdean Deep Colliery and have requested Thomas
Forster Brown the Deputy Gavelor of the said Forest of Dean to grant to
them the said New Bowson Deep Coal Company the License or right to
make and form the Broad Guage tramway as after mentioned and to have

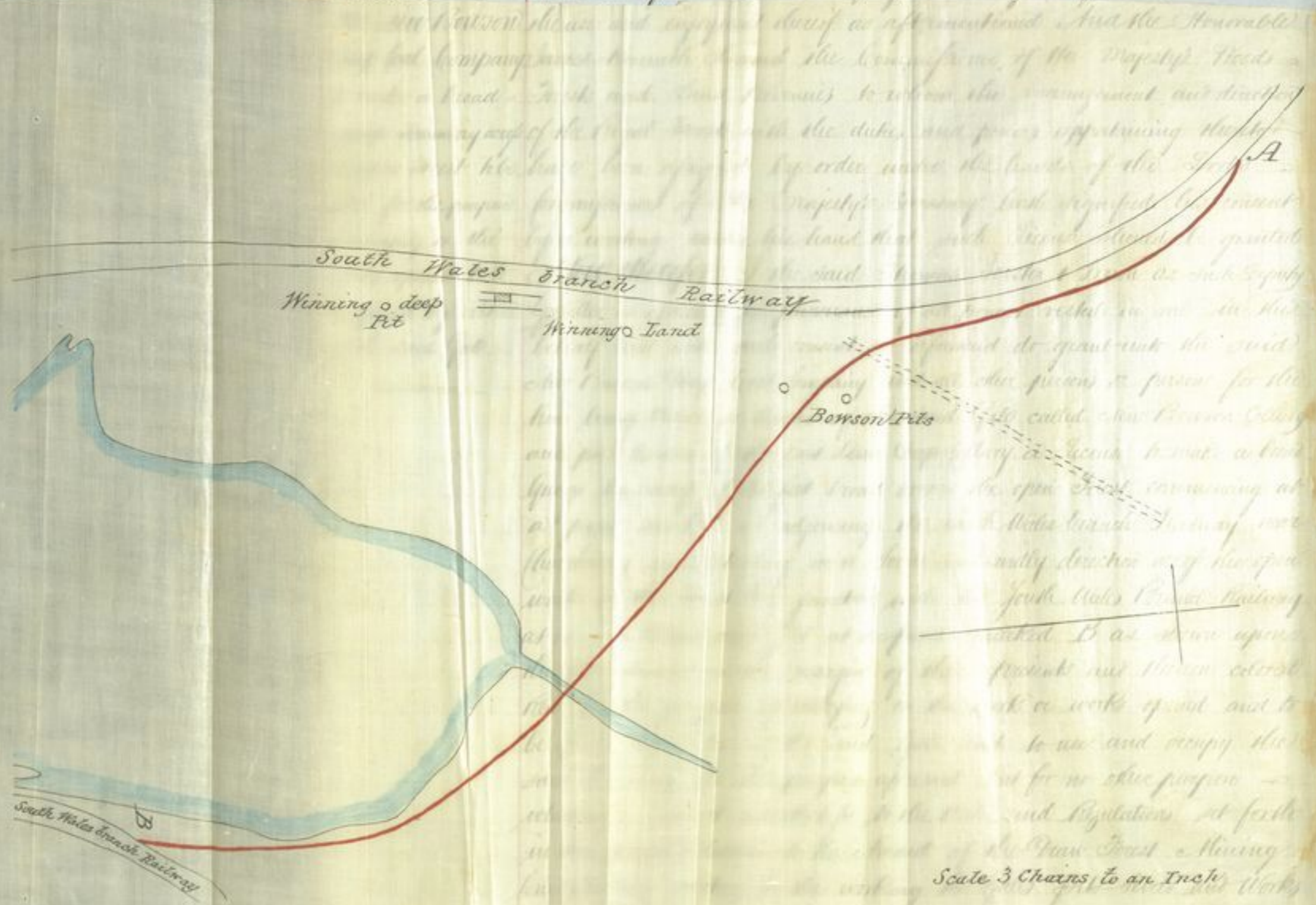

T. Forster Brown - Deputy Gavelor

any Dated 31st
hundred August 1868.
Colliery
Fluoma
ent to
to
to have

Dean Forest
Quarries held under Award
As to Number 259.

Dean Forest
Quarry 259.
Surrender
by Joseph Meek
to the Crown of
Quarry numbered
259 situate on
Harrow or Holly
Bush Hill. —

To all to whom these Presents shall come Joseph Meek of Drybrook near Mitcheldean in the Forest of Dean and County of Gloucester and The Honorable James Kenneth Howard the Commissioner of Her Majesty Woods Forests and Land Revenues leaving the management and direction of the Royal Forest of Dean in the County of Gloucester with the duties and powers appertaining thereto and being also the Gaveller of the said Forest Tend Greeting Whereas the said Joseph Meek as Devisee in fee under the Will of his Father George Meek of Drybrook aforesaid Quarryman deceased is the person now in possession of or entitled to a certain Quarry in the said Forest of Dean in the First Schedule to the Award of the Dean Forest Mining Commissioners made under and in pursuance of the first and second Victoria Chapter 43 and bearing date the twenty fourth day of July One thousand eight hundred and forty one described as follows: "All that Quarry on Harrow or Holly Bush Hill numbered 259 extending in length Forty yards and bounded as shown on Plan V annexed to the said Award And whereas the said Joseph Meek hath requested the said James Kenneth Howard as such Commissioner and Gaveller as aforesaid to accept and take a Surrender of the said Quarry on behalf of Her Majesty as and from the twenty ninth day of May One thousand eight hundred and sixty seven being the day of the death of the said George Meek (the person declared entitled to the said Quarry under the said Award) which he hath agreed to do as hereinafter appears Now know ye and the said Joseph Meek Both hereby in consideration of the premises Surrender and give up unto the Queen's Majesty her heirs and successors All that the said before described Quarry numbered 259 as aforesaid To hold the same with the rights members privileges and appurtenances thereunto belonging or therewith held used or enjoyed Unto and to the use of the Queen's Majesty her heirs and successors for ever as and from the said twenty ninth day of May One thousand eight hundred and sixty seven And the said James Kenneth Howard as such Commissioner and Gaveller as aforesaid Both hereby accept the said Surrender on behalf of the Majesty In witness whereof the said Joseph Meek and James Kenneth Howard have hereunto respectively set their hands & seals this thirty first day of August One thousand eight hundred and sixty eight.

The mark of Joseph X Meek (S)

James K Howard (S)

Witness to the execution by the said Joseph Meek - Marmaduke Laver, Whitmore and witness to the execution by the said James Kenneth Howard - Mr. Fagg, Messenger, Office of Woods.

Entered in the Office of Land Revenue Records and Documents, the 29th day of September 1868. A. G. Stewart, Keeper of the Records.

Dated 30th
September 1868.

New Forest

License by
The Commissioner
of Her Majesty's
Moods, Forests and
Land Revenues and
the within mentioned
persons to Fowl and
Fish in the Forest
during the year 1868 & 69.

To all to whom these Presents shall come I
The Honorable James Kenneth Howard a Commissioner
of Her Majesty's Moods, Forests and Land Revenues Send Greeting Whereas
the several persons whose names are contained in the first second and third
Schedules hereunder written have applied to me as such Commissioner as
aforesaid to grant to them respectively my License under the powers of the
fifth Section of the Crown Lands Act 1866 to fowl and fish on and over
such parts of the New Forest in the County of Southampton as are hereinafter
specified, in consideration as regards the persons whose names are contained
in the first and second Schedules hereof of the payment by them to the Crown
of the several sums set opposite to their respective names and which sums have
been duly paid And whereas I have as such Commissioner as aforesaid
with the approval of the Commissioners of Her Majesty's Treasury determine to
accede to such applications subject to the conditions and provisions hereinafter
contained Now therefore know ye that in consideration of the premises
and with the approval of the Commissioners of Her Majesty's Treasury I the
said James Kenneth Howard as such Commissioner as aforesaid do hereby in
pursuance of the powers of the fifth Section of the Crown Lands Act 1866
grant to each of the several persons mentioned in the first second and third
Schedules hereunder written my License to fowl and fish on and over such
parts of the New Forest in the County of Southampton as are hereinafter specified
and subject to the conditions and provisions hereinafter contained And
further know ye that the parts of the New Forest to which this License
is to extend and the conditions and provisions subject to which the same is
granted are as follows, that is to say,

First. This License as regards Fowling to have effect on and from the first
day of October One thousand eight hundred and sixty eight up to and
including the first day of February One thousand eight hundred and sixty nine
and no longer and as regards Fishing to have effect from the first day of
October One thousand eight hundred and sixty eight up to the thirtieth day of
September One thousand eight hundred and sixty nine.

Second. This License is to extend to such parts of the New Forest the soil and
freehold whereof are for the time being vested in the Crown excepting
therefrom all inclosed Woods and Lands, that is to say, All Woods and Lands
which are the property of Her Majesty free from all rights of Common, and
also excepting all inclosures for the time being made pursuant to or under the
authority of the Acts 9th and 10th William 3rd (cap. 36, 14th George 3rd cap. 72
and 14th & 15th Victoria cap. 76 or any of such Acts or any Commission thereunder.

Third. This License will not authorize the taking or killing of any red or fallow
Deer, Red Grouse, Black Game Hen (or Grey Hen) or Hen Pheasant.

Fourth

Fourth. Each of the persons whose names are included in the second Schedule hereunder written, may, when exercising the privileges conferred by this License be accompanied by a Friend, who shall on each such occasion have the same and no larger or other right to fowl and fish as the Licensee, subject to the condition that such Friend does not reside within twenty miles of any part of the New Forest but has bona fide slept in the same House as the Licensee during the night before such friend exercises the right hereby granted.

Fifth. Each Licensee, whether he is accompanied by a friend under the fourth Article or not, shall be attended by one beater only, when exercising the privileges granted by this License.

Sixth. If any person named in either of the Schedules hereunder written or the Friend of any person named in the second Schedule who may be exercising the privileges conferred by the fourth Article, shall at any time commit any breach of the conditions or provisions herein contained, or shall fowl or fish on any land belonging to Her Majesty in the New Forest to which this License does not extend, then and in every such case such breach or act shall operate as an immediate and absolute forfeiture of the License hereby granted to the person by whom such breach or other act is committed, or in the case of the breach or other act being committed by a friend exercising the privileges conferred by the fourth Article then the same breach or act shall operate as an immediate and absolute forfeiture of the License to the person named in the second Schedule hereto by whom any such friend as aforesaid shall have been accompanied. In the event of any forfeiture taking place, no part of the consideration paid by any Licensee is to be returned to him: Nevertheless the Commissioner of Her Majesty's Woods Forests and Land Revenues for the time being, in charge of the New Forest is to have power to waive any forfeiture, in case, on sufficient cause being shewn, he may think fit to do so.

And I the said James Kenneth Howard do hereby direct that this deed such be deemed to be fully and sufficiently enrolled by the deposit of a duplicate thereof in the Office of Land Revenue Records and Inrolments and the filing or making an entry of such deposit by the Keeper of the said Records and Inrolments In witness whereof the said James Kenneth Howard hath hereunto set his hand and seal this thirteenth day of September One thousand eight hundred and sixty eight.

The First Schedule above referred to.

Names	Residences	£
Bradburne, F. C. Esquire	Bramshaw, Lyndhurst	20
Lumberbath, A. C. Esquire	46 Lancaster Gate, London	20
Leustance, Colonel	Brook Heath, Fordingbridge	20

Dawson

Names	Residences	£
Dawson, John B. Esquire	Landford House, Mudeford, Christchurch	20
Duplessis, J. Esquire	Newtown Park, Lymington	20
Eyre, J. H. D. Esquire	Hill Lawn, Mudeford, Christchurch	20
Lewis, Sir G. C. Baronet	Hinton Admiral Christchurch	20.
Mauguere, R. G. Esquire	Keyshalls, Lyndhurst	20.
Hudleston, W. J. Esq.	Overley House, near Torrington, Devon	20.
Jones, David Esquire	Marbourn, Pilley Lymington	20.
Lovell, J. F. Esquire	Hincheslea, Brockenhurst	20.
Mocus, W. J. C. Esquire	Boldre, Lymington	20.
Nashley, A. R. Esquire	Blighmont Millbrook Southampton	20.
Pepliam, H. Esquire	Howfield, Christchurch	20.
Powell, H. B. Esquire	Lyndhurst	20.
Ricardo, Captain D.	Swire Homage, Christchurch	20.
Selme, J. Esquire	Sibden, Southampton	20.
Shrubbs, G. P. Esquire	Vicars Hill, Lymington	20
Shrubbs, J. L. Esquire	Lymington	20
Smith, R. B. Esquire	Lyndhurst	20
Smith, A. B. V. Esquire	Lyndhurst	20.
Smith, A. B. Esquire	Brockenhurst	20.
Smith, A. B. Esquire	Brockenhurst	20.
Inock, John Esquire	Belmont Castle by Havant	20
Vanner, G. J. Esquire	Landford Lodge, Salisbury	20.
Whitcomb, Henry Esquire	Bowley, Lymington	20
Wilks, M. B. Esquire	Lyndhurst	20.
Wingrove, D. B. Esquire	Langley, Aug	20.
Wingrove, R. F. Esquire	Langley, Aug	20.

The Second Schedule above referred to.

Names	Residences	£
Howes, Captain William H.	Monks Well House, Bromley, Kent	30
Brit, Jacob Esquire	Broomy Lodge, New Forest	20
Marrison, G. Esquire	Stampworth Lodge, Salisbury	30.
Homan J. Esquire	Wick, Christchurch, Hants	30
Ricardo, M. Esquire	Christchurch	30
Ray W. G. Esquire	Deery Pond Farm, New Forest	20.

The Third Schedule above referred to

£	Names	Residences
20	Pratt, Jacob Esquire	Broomy Lodge, New Forest (Crown Lessee).
20	Pickenson, William Esquire	New Park Farm, New Forest (Crown Lessee)
20	Trayson H. E. Esquire	Eyeworth Lodge, New Forest (Crown Lessee).
20	Glyn, St. Leger Esquire	Hamble Hill Lodge, New Forest (Crown Lessee).
20	Mulce, Sir Edward Baronet	Breamore, Salisbury (Verderer)
20	Lawes, Thomas Esquire	Mitley Ridge Lodge, New Forest (Crown Lessee)
20	Mills John Esquire	Bristern, Ringwood (Verderer)
20	Paullet, Sir Henry Baronet	Testwood, Southampton (Verderer)
20	Roy W. G. Esquire	Decoy Pond Farm, New Forest, (Crown Lessee)
20	Stanley W. H. S. Esquire	Paultons, Romsey (Verderer)
20	Cumberbatch, Lawrence Henry Esquire	Quercus House, Lyndhurst (Deputy Surveyor)

James K (H.) Howard

Signed sealed and delivered by the within named James Kenneth Howard in the presence of

Louisa Howard
East Woodhay - Hants

I Certify that a Duplicate of this Deed has been deposited in the Office of Land Revenue Records and Inrolments and an entry thereof made or filed by me.

H. G. Hewlett
Keeper of the Records.

3rd October 1868.

£
30
20
30
30
30
20